



PRIORITY MAIL:

November 2, 2016

PDC Energy, Inc.
1775 Sherman Street
Suite 3000
Denver, Colorado 80203

**RE: COGCC Rule 317.s. Statewide Fracture Stimulation Setback
Wilkinson 1-P Pad: SWSW Section 1, Township 6 North, Range 65 West
Weld County, Colorado**

Ladies and Gentlemen:

Bayswater Exploration and Production, LLC (Bayswater) is applying to the Colorado Oil and Gas Conservation Commission (COGCC) to drill wells on the above referenced pad. COGCC Rule 317.s. stipulates that no portion of a proposed wellbore's treated interval shall be located within 150 feet from an existing (producing, shut-in, or temporarily abandoned) or permitted oil and gas wellbore's treated interval without the signed written consent from the operator of the encroached upon wellbore. As currently planned, the following wells' treated intervals are within 150 feet of the proposed horizontals' treated intervals:

1. Vonfeldt 13-12 (API: 05-123-14039), 128 foot offset from Wilkinson D-12HN
2. Anderson 11-13 (API: 05-123-13936), 103 foot offset from Wilkinson D-12HN
3. Anderson 12-13 (API: 05-123-20671), 111 foot offset from Wilkinson D-12HN
4. Anderson 11-13 (API: 05-123-13936), 128 foot offset from Wilkinson E-12HC
5. Anderson 12-13 (API: 05-123-20671), 142 foot offset from Wilkinson E-12HC
6. J R #1 (API: 05-123-12840), 39 foot offset from the Wilkinson J-12HN
7. J R #1 (API: 05-123-12840), 144 foot offset from the Wilkinson K-12HC

Pursuant to Rule 317.s. the signed written consent shall be attached to the Application for Permit to Drill (APD), Form 2 for the proposed wellbore. The distance between wellbores measurement shall be based upon the directional survey for drilled wellbores and the deviated drilling plan for permitted wellbores, or as otherwise reflected in the COGCC well records. The distance shall be measured from the perforation or mechanical isolation device.

Per COGCC Rule 317.s. Bayswater is requesting operator consent of the encroached upon setback for the existing wells referenced above. Should you find this acceptable, please so indicate by executing the additional copy of the consent and returning to my attention in the self-addressed stamped envelope provided herein.



If you should have any questions or require additional information, please do not hesitate contacting me at 303.928.7128 or via email at regulatory@petro-fs.com. Thank you for your consideration of this matter.

Respectfully,

A handwritten signature in blue ink, appearing to read 'Jeff Annable'.

Jeff Annable
Regulatory Analyst
Agent for Bayswater Exploration and Production, LLC

:ja

Enclosures: Stimulation Setback Consent
Self-addressed stamped envelope
Additional Copy of Stimulation Setback Consent
Multi-Well Plan

PDC ENERGY, INC.

**RE: COGCC Rule 317.s. Statewide Fracture Stimulation Setback
Wilkinson 1-P Pad: SWSW Section 1, Township 6 North, Range 65 West
Weld County, Colorado**

I, ERIK ROACH, acting as self, officer, agent or employee of PDC Energy, Inc., operator of the Vonfeldt 13-12 (API: 05-123-14039), Anderson 12-13 (API: 05-123-20671), Anderson 11-13 (API: 05-123-13936), J R #1 (API: 05-123-12840) with full power to execute the following, do hereby give consent to Bayswater Exploration and Production, LLC to stimulate the Wilkinson D-12HN, Wilkinson E-12HC, and the Wilkinson J-12HN wells within the COGCC Rule 317.s. Statewide Fracture Stimulation Setback.

A handwritten signature in blue ink, appearing to read 'Erik Roach'.

Signature

11/30/16
Date

ERIK ROACH
Printed Name

WILKINSON 1-P PAD MULTI-WELL PLAN

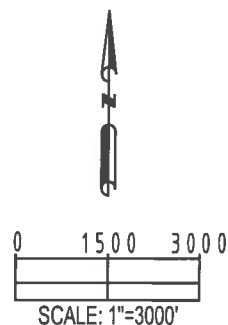
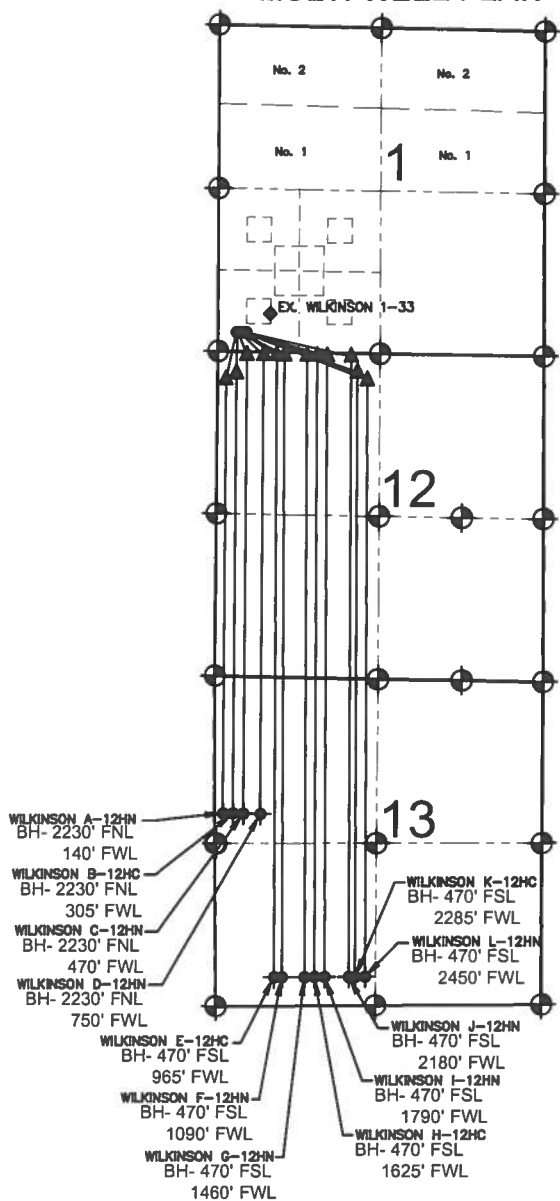

LEGEND

- ⊕ = EXISTING MONUMENT
- ⬤ = CALCULATED POSITION
- = PROPOSED WELL
- ▲ = LANDING POINT
- ⬤ = BOTTOM HOLE
- ⬤ = EXISTING WELL
- LP = LANDING POINT
- BH= BOTTOM HOLE

NOTES:

- THIS FIELD SURVEY CONFORMS TO THE MINIMUM STANDARDS SET BY THE C.O.G.C.C., RULE NO. 215
- BEARINGS ARE BASED UPON THE ASSUMPTION THAT THE SOUTH LINE OF THE SOUTHEAST QUARTER OF SECTION 1, BEARS N 89°07'31" W BETWEEN THE MONUMENTS SHOWN HEREON.
- GRID DISTANCES ARE SHOWN, AS GPS MEASURED IN THE FIELD, WITH TIES TO WELLS MEASURED PERPENDICULAR TO SECTION LINES. TO GET GROUND DISTANCES MULTIPLY THE SHOWN DISTANCE BY 1.000257288.
- FIELD VERIFICATION OF MONUMENTS COMPLETED WITHIN 1 YEAR OF SIGNATURE DATE.

NOTES:

- WILKINSON A-12HN TO BE AT 316' FSL, 300' FWL. BOTTOM HOLE AT 2230' FNL & 140' FWL, SEC 13.
- WILKINSON B-12HC TO BE AT 316' FSL, 315' FWL. BOTTOM HOLE AT 2230' FNL & 305' FWL, SEC 13.
- WILKINSON C-12HN TO BE AT 316' FSL, 330' FWL. BOTTOM HOLE AT 2230' FNL & 470' FWL, SEC 13.
- WILKINSON D-12HN TO BE AT 316' FSL, 345' FWL. BOTTOM HOLE AT 2230' FNL & 750' FWL, SEC 13.
- WILKINSON E-12HC TO BE AT 316' FSL, 360' FWL. BOTTOM HOLE AT 470' FSL & 965' FWL, SEC 13.
- WILKINSON F-12HN TO BE AT 316' FSL, 375' FWL. BOTTOM HOLE AT 470' FSL & 1090' FWL, SEC 13.
- WILKINSON G-12HN TO BE AT 316' FSL, 390' FWL. BOTTOM HOLE AT 470' FSL & 1460' FWL, SEC 13.
- WILKINSON H-12HC TO BE AT 316' FSL, 405' FWL. BOTTOM HOLE AT 470' FSL & 1625' FWL, SEC 13.
- WILKINSON I-12HN TO BE AT 316' FSL, 420' FWL. BOTTOM HOLE AT 470' FSL & 1790' FWL, SEC 13.
- WILKINSON J-12HN TO BE AT 316' FSL, 435' FWL. BOTTOM HOLE AT 470' FSL & 2180' FWL, SEC 13.
- WILKINSON K-12HC TO BE AT 316' FSL, 450' FWL. BOTTOM HOLE AT 470' FSL & 2285' FWL, SEC 13.
- WILKINSON L-12HN TO BE AT 316' FSL, 465' FWL. BOTTOM HOLE AT 470' FSL & 2450' FWL, SEC 13.
- EX. WELL WILKINSON 1-33 IS 625' FSL & 855' FWL.

PREPARED BY



FIELD DATE:

06-23-15

DRAWING DATE:

02-23-16

BY:

KAD

CHECKED BY:

TJN

SITE NAME:

WILKINSON 1-P PAD

SURFACE LOCATION

SW 1/4 SW 1/4 SEC. 1, T6N, R65W, 6TH P.M.
WELD COUNTY, COLORADO

PREPARED FOR:



BAYSWATER
EXPLORATION AND PRODUCTION, LLC