



Lat40°, Inc. 6250 W. 10th Street, Unit 2, Greeley, CO 970-515-5294

# HYDROLOGY MAP

JOHNSON 6N64W16D PAD

SECTION: 16  
TOWNSHIP: 6N  
RANGE: 64W  
6TH. P.M.  
WELD COUNTY, CO

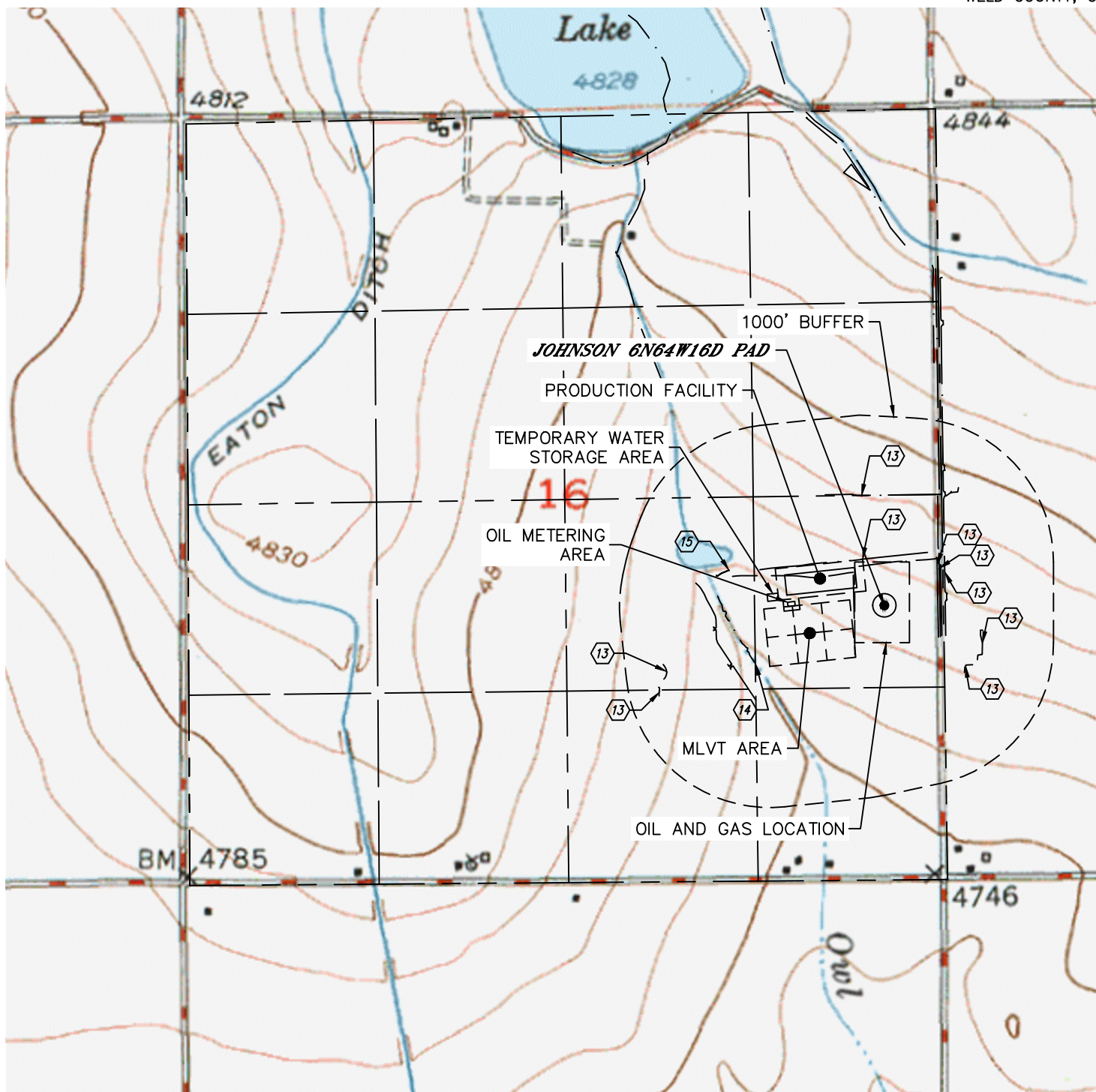

DISTANCES MEASURED FROM THE EDGE OF THE OIL AND GAS LOCATION.

- ⑬ DITCH 2' N, 245' E, 421' SE, 444' N, 507' E, 717' & 799' SW  
BARROW DITCH 217' & 245' E
- ⑭ OWL CREEK 105' SW
- ⑮ POND 271' NW

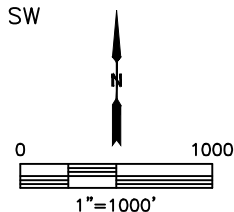

NEAREST DOWN GRADIENT SURFACE WATER: OWL CREEK 105' SW

DATE: 10/12/2016  
PROJECT#: 2016026