

EXTRACTION OIL & GAS

Location: COLORADO Slot: SLOT#18 LAUNER 6(792'FSL & 349'FEL,SEC.26)
Field: WELD COUNTY (NAD83/TRUE NORTH) Well: LAUNER 6
Facility: SEC.26-T07N-R67W Wellbore: LAUNER 6 PWB

Plot reference wellpath is LAUNER 6 (REV-B.0) PWP

True vertical depths are referenced to RIG (RKB)	Grid System: NAD83 / Lambert Colorado SP, Northern Zone (501), US feet
Measured depths are referenced to RIG (RKB)	North Reference: True north
RIG (RKB) to Mean Sea Level: 4955 feet	Scale: True distance
Mean Sea Level to Mud line (At Slot: SLOT#18 LAUNER 6(792'FSL & 349'FEL,SEC.26)): 0 feet	Depths are in feet
Coordinates are in feet referenced to Slot	Created by: painsett on 10/7/2014

Location Information

Facility Name			Grid East (US ft)	Grid North (US ft)	Latitude	Longitude
SEC.26-T07N-R67W			3179860.101	1444245.219	40°33'03.784"N	104°51'09.932"W
Slot	Local N (ft)	Local E (ft)	Grid East (US ft)	Grid North (US ft)	Latitude	Longitude
SLOT#18 LAUNER 6(792'FSL & 349'FEL,SEC.26)	-4001.38	152.84	3180042.135	1440245.188	40°32'24.245"N	104°51'07.952"W
RIG (RKB) to Mud line (At Slot: SLOT#18 LAUNER 6(792'FSL & 349'FEL,SEC.26))			4955ft			
Mean Sea Level to Mud line (At Slot: SLOT#18 LAUNER 6(792'FSL & 349'FEL,SEC.26))			0ft			
RIG (RKB) to Mean Sea Level			4955ft			

Targets

Name	MD (ft)	TVD (ft)	Local N (ft)	Local E (ft)	Grid East (US ft)	Grid North (US ft)	Latitude	Longitude
SEC.26-T07N-R67W		-17.00	4001.34	-152.84	3179860.07	1444245.18	40°33'03.784"N	104°51'09.932"W
SEC.27-T07N-R67W		-17.00	4001.34	-152.84	3179860.07	1444245.18	40°33'03.784"N	104°51'09.932"W
LAUNER 6 BHL ON PLAT REV-1(1554'FSL & 2561'FEL,SEC.27)	14667.50	7035.00	753.83	-7497.59	3172539.49	1440944.20	40°32'31.682"N	104°52'45.066"W
LAUNER 6 DRILLING CORRIDOR(60')		7035.00	0.00	0.00	3180042.13	1440245.19	40°32'24.246"N	104°51'07.952"W
LAUNER 6 LANDING		7035.00	699.86	-110.90	3179926.13	1440944.20	40°32'31.160"N	104°51'09.389"W
LAUNER 6 LANDING REV-1	7411.71	7035.00	699.82	-242.00	3179795.04	1440943.20	40°32'31.160"N	104°51'11.087"W

Survey Program

Start MD (ft)	End MD (ft)	Tool	Model	Log Name/Comment	Wellbore
24.00	15000.00	NaviTrak	NaviTrak (Standard)		LAUNER 6 PWB

Well Profile Data

Design Comment	MD (ft)	Inc (°)	Az (°)	TVD (ft)	Local N (ft)	Local E (ft)	DLS (°/100ft)	VS (ft)
Tie On	24.00	0.000	27.776	24.00	0.00	0.00	0.00	0.00
End of Tangent	850.00	0.000	27.776	850.00	0.00	0.00	0.00	0.00
End of Build	1223.20	7.464	27.776	1222.15	21.48	11.31	2.00	-9.11
End of Tangent	6477.49	7.464	27.776	6431.92	625.38	329.40	0.00	-265.18
End of 3D Arc	7411.71	90.000	270.426	7035.00	699.82	-242.00	10.00	310.79
End of Tangent	14667.50	90.000	270.426	7035.00	753.83	-7497.59	0.00	7535.39

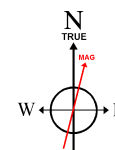
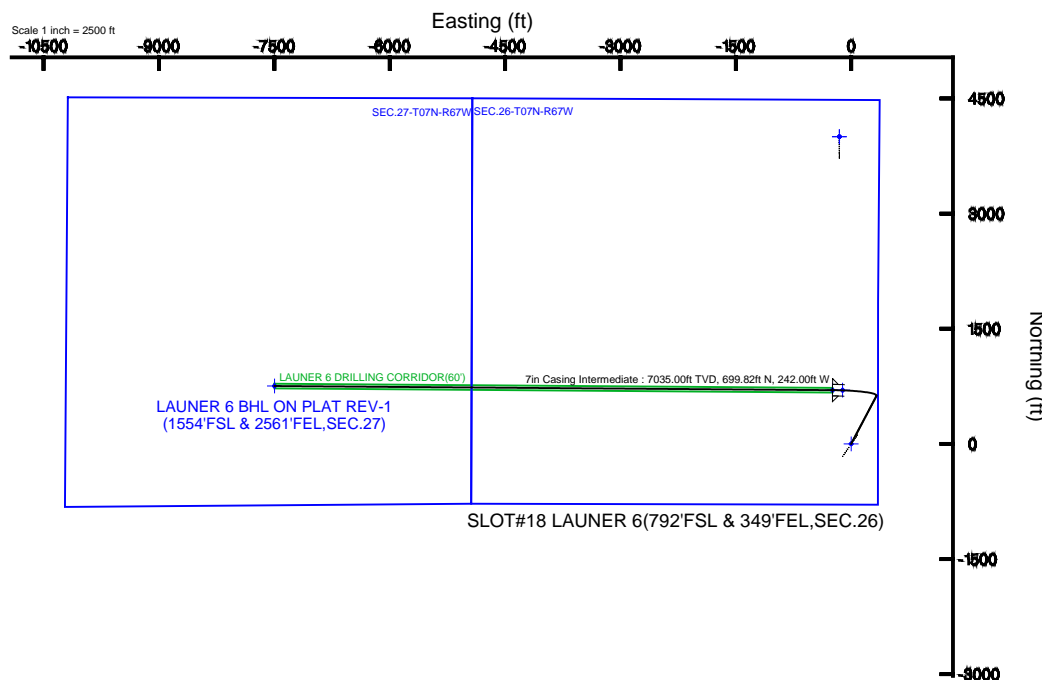

BGGM (1945.0 to 2016.0) Dip: 67.04° Field: 52816.5 nT
Magnetic North is 8.59 degrees East of True North (at 7/24/2014)

To correct azimuth from Magnetic to True add 8.59 degrees

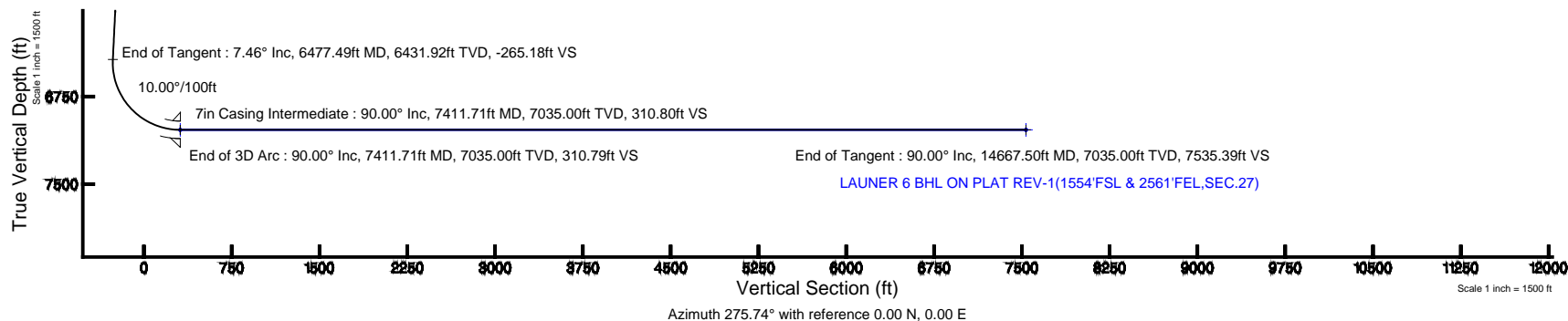



Planned Wellpath Report

LAUNER 6 (REV-B.0) PWP

Page 1 of 8



REFERENCE WELLPATH IDENTIFICATION

Operator	EXTRACTION OIL & GAS	Slot	SLOT#18 LAUNER 6(792'FSL & 349'FEL,SEC.26)
Area	COLORADO	Well	LAUNER 6
Field	WELD COUNTY (NAD83/TRUE NORTH)	Wellbore	LAUNER 6 PWB
Facility	SEC.26-T07N-R67W		

REPORT SETUP INFORMATION

Projection System	NAD83 / Lambert Colorado SP, Northern Zone (501), US feet	Software System	WellArchitect® 4.0.0
North Reference	True	User	Painsetr
Scale	0.99997	Report Generated	10/7/2014 at 1:24:30 PM
Convergence at slot	n/a	Database/Source file	WA_Denver/LAUNER_6_PWB.xml

WELLPATH LOCATION

	Local coordinates		Grid coordinates		Geographic coordinates	
	North[ft]	East[ft]	Easting[US ft]	Northing[US ft]	Latitude	Longitude
Slot Location	-4001.38	152.84	3180042.14	1440245.19	40°32'24.245"N	104°51'07.952"W
Facility Reference Pt			3179860.10	1444245.22	40°33'03.784"N	104°51'09.932"W
Field Reference Pt			3185481.27	1419166.81	40°28'55.560"N	104°49'59.556"W

WELLPATH DATUM

Calculation method	Minimum curvature	RIG (RKB) to Facility Vertical Datum	4955.00ft
Horizontal Reference Pt	Slot	RIG (RKB) to Mean Sea Level	4955.00ft
Vertical Reference Pt	RIG (RKB)	RIG (RKB) to Mud Line at Slot (SLOT#18 LAUNER 6(792'FSL & 349'FEL,SEC.26))	4955.00ft
MD Reference Pt	RIG (RKB)	Section Origin	N 0.00, E 0.00 ft
Field Vertical Reference	Mean Sea Level	Section Azimuth	275.74°



Planned Wellpath Report

LAUNER 6 (REV-B.0) PWP

Page 2 of 8



REFERENCE WELLPATH IDENTIFICATION

Operator	EXTRACTION OIL & GAS	Slot	SLOT#18 LAUNER 6(792'FSL & 349'FEL,SEC.26)
Area	COLORADO	Well	LAUNER 6
Field	WELD COUNTY (NAD83/TRUE NORTH)	Wellbore	LAUNER 6 PWB
Facility	SEC.26-T07N-R67W		

WELLPATH DATA (153 stations) † = interpolated/extrapolated station

MD [ft]	Inclination [°]	Azimuth [°]	TVD [ft]	Vert Sect [ft]	North [ft]	East [ft]	DLS [°/100ft]	Comments
0.00†	0.000	27.776	0.00	0.00	0.00	0.00	0.00	
24.00	0.000	27.776	24.00	0.00	0.00	0.00	0.00	Tie On
124.00†	0.000	27.776	124.00	0.00	0.00	0.00	0.00	
224.00†	0.000	27.776	224.00	0.00	0.00	0.00	0.00	
324.00†	0.000	27.776	324.00	0.00	0.00	0.00	0.00	
424.00†	0.000	27.776	424.00	0.00	0.00	0.00	0.00	
524.00†	0.000	27.776	524.00	0.00	0.00	0.00	0.00	
624.00†	0.000	27.776	624.00	0.00	0.00	0.00	0.00	
724.00†	0.000	27.776	724.00	0.00	0.00	0.00	0.00	
824.00†	0.000	27.776	824.00	0.00	0.00	0.00	0.00	
850.00	0.000	27.776	850.00	0.00	0.00	0.00	0.00	End of Tangent
924.00†	1.480	27.776	923.99	-0.36	0.85	0.45	2.00	
1024.00†	3.480	27.776	1023.89	-1.98	4.67	2.46	2.00	
1124.00†	5.480	27.776	1123.58	-4.91	11.58	6.10	2.00	
1223.20	7.464	27.776	1222.15	-9.11	21.48	11.31	2.00	End of Build
1224.00†	7.464	27.776	1222.94	-9.15	21.57	11.36	0.00	
1324.00†	7.464	27.776	1322.09	-14.02	33.06	17.41	0.00	
1424.00†	7.464	27.776	1421.24	-18.89	44.56	23.47	0.00	
1524.00†	7.464	27.776	1520.40	-23.77	56.05	29.52	0.00	
1624.00†	7.464	27.776	1619.55	-28.64	67.54	35.58	0.00	
1724.00†	7.464	27.776	1718.70	-33.51	79.04	41.63	0.00	
1824.00†	7.464	27.776	1817.85	-38.39	90.53	47.68	0.00	
1924.00†	7.464	27.776	1917.01	-43.26	102.02	53.74	0.00	
2024.00†	7.464	27.776	2016.16	-48.14	113.52	59.79	0.00	
2124.00†	7.464	27.776	2115.31	-53.01	125.01	65.85	0.00	
2224.00†	7.464	27.776	2214.47	-57.88	136.51	71.90	0.00	
2324.00†	7.464	27.776	2313.62	-62.76	148.00	77.95	0.00	
2424.00†	7.464	27.776	2412.77	-67.63	159.49	84.01	0.00	
2524.00†	7.464	27.776	2511.92	-72.50	170.99	90.06	0.00	
2624.00†	7.464	27.776	2611.08	-77.38	182.48	96.11	0.00	



Planned Wellpath Report

LAUNER 6 (REV-B.0) PWP

Page 3 of 8



REFERENCE WELLPATH IDENTIFICATION

Operator	EXTRACTION OIL & GAS	Slot	SLOT#18 LAUNER 6(792'FSL & 349'FEL,SEC.26)
Area	COLORADO	Well	LAUNER 6
Field	WELD COUNTY (NAD83/TRUE NORTH)	Wellbore	LAUNER 6 PWB
Facility	SEC.26-T07N-R67W		

WELLPATH DATA (153 stations) † = interpolated/extrapolated station

MD [ft]	Inclination [°]	Azimuth [°]	TVD [ft]	Vert Sect [ft]	North [ft]	East [ft]	DLS [°/100ft]	Comments
2724.00†	7.464	27.776	2710.23	-82.25	193.97	102.17	0.00	
2824.00†	7.464	27.776	2809.38	-87.12	205.47	108.22	0.00	
2924.00†	7.464	27.776	2908.53	-92.00	216.96	114.28	0.00	
3024.00†	7.464	27.776	3007.69	-96.87	228.45	120.33	0.00	
3124.00†	7.464	27.776	3106.84	-101.75	239.95	126.38	0.00	
3224.00†	7.464	27.776	3205.99	-106.62	251.44	132.44	0.00	
3324.00†	7.464	27.776	3305.14	-111.49	262.93	138.49	0.00	
3424.00†	7.464	27.776	3404.30	-116.37	274.43	144.54	0.00	
3524.00†	7.464	27.776	3503.45	-121.24	285.92	150.60	0.00	
3624.00†	7.464	27.776	3602.60	-126.11	297.42	156.65	0.00	
3724.00†	7.464	27.776	3701.75	-130.99	308.91	162.71	0.00	
3824.00†	7.464	27.776	3800.91	-135.86	320.40	168.76	0.00	
3924.00†	7.464	27.776	3900.06	-140.73	331.90	174.81	0.00	
4024.00†	7.464	27.776	3999.21	-145.61	343.39	180.87	0.00	
4124.00†	7.464	27.776	4098.37	-150.48	354.88	186.92	0.00	
4224.00†	7.464	27.776	4197.52	-155.36	366.38	192.98	0.00	
4324.00†	7.464	27.776	4296.67	-160.23	377.87	199.03	0.00	
4424.00†	7.464	27.776	4395.82	-165.10	389.36	205.08	0.00	
4524.00†	7.464	27.776	4494.98	-169.98	400.86	211.14	0.00	
4624.00†	7.464	27.776	4594.13	-174.85	412.35	217.19	0.00	
4724.00†	7.464	27.776	4693.28	-179.72	423.85	223.24	0.00	
4824.00†	7.464	27.776	4792.43	-184.60	435.34	229.30	0.00	
4924.00†	7.464	27.776	4891.59	-189.47	446.83	235.35	0.00	
5024.00†	7.464	27.776	4990.74	-194.35	458.33	241.41	0.00	
5124.00†	7.464	27.776	5089.89	-199.22	469.82	247.46	0.00	
5224.00†	7.464	27.776	5189.04	-204.09	481.31	253.51	0.00	
5324.00†	7.464	27.776	5288.20	-208.97	492.81	259.57	0.00	
5424.00†	7.464	27.776	5387.35	-213.84	504.30	265.62	0.00	
5524.00†	7.464	27.776	5486.50	-218.71	515.79	271.68	0.00	
5624.00†	7.464	27.776	5585.66	-223.59	527.29	277.73	0.00	



Planned Wellpath Report

LAUNER 6 (REV-B.0) PWP

Page 4 of 8



REFERENCE WELLPATH IDENTIFICATION

Operator	EXTRACTION OIL & GAS	Slot	SLOT#18 LAUNER 6(792'FSL & 349'FEL,SEC.26)
Area	COLORADO	Well	LAUNER 6
Field	WELD COUNTY (NAD83/TRUE NORTH)	Wellbore	LAUNER 6 PWB
Facility	SEC.26-T07N-R67W		

WELLPATH DATA (153 stations) † = interpolated/extrapolated station

MD [ft]	Inclination [°]	Azimuth [°]	TVD [ft]	Vert Sect [ft]	North [ft]	East [ft]	DLS [°/100ft]	Comments
5724.00†	7.464	27.776	5684.81	-228.46	538.78	283.78	0.00	
5824.00†	7.464	27.776	5783.96	-233.33	550.27	289.84	0.00	
5924.00†	7.464	27.776	5883.11	-238.21	561.77	295.89	0.00	
6024.00†	7.464	27.776	5982.27	-243.08	573.26	301.94	0.00	
6124.00†	7.464	27.776	6081.42	-247.96	584.76	308.00	0.00	
6224.00†	7.464	27.776	6180.57	-252.83	596.25	314.05	0.00	
6324.00†	7.464	27.776	6279.72	-257.70	607.74	320.11	0.00	
6424.00†	7.464	27.776	6378.88	-262.58	619.24	326.16	0.00	
6477.49	7.464	27.776	6431.92	-265.18	625.38	329.40	0.00	End of Tangent
6524.00†	6.750	349.911	6478.09	-265.57	630.75	330.33	10.00	
6624.00†	13.022	300.635	6576.71	-253.72	642.31	319.58	10.00	
6724.00†	22.197	286.997	6671.96	-224.90	653.60	291.75	10.00	
6824.00†	31.857	281.220	6760.95	-179.99	664.28	247.69	10.00	
6924.00†	41.665	277.941	6840.97	-120.35	674.03	188.73	10.00	
7024.00†	51.537	275.731	6909.60	-47.81	682.56	116.67	10.00	
7124.00†	61.440	274.058	6964.74	35.45	689.59	33.70	10.00	
7224.00†	71.360	272.676	7004.73	126.89	694.93	-57.66	10.00	
7324.00†	81.288	271.448	7028.34	223.73	698.40	-154.64	10.00	
7411.71	90.000	270.426	7035.00 ¹	310.79	699.82	-242.00	10.00	End of 3D Arc
7424.00†	90.000	270.426	7035.00	323.03	699.91	-254.29	0.00	
7524.00†	90.000	270.426	7035.00	422.60	700.66	-354.29	0.00	
7624.00†	90.000	270.426	7035.00	522.17	701.40	-454.29	0.00	
7724.00†	90.000	270.426	7035.00	621.74	702.14	-554.28	0.00	
7824.00†	90.000	270.426	7035.00	721.31	702.89	-654.28	0.00	
7924.00†	90.000	270.426	7035.00	820.88	703.63	-754.28	0.00	
8024.00†	90.000	270.426	7035.00	920.45	704.38	-854.27	0.00	
8124.00†	90.000	270.426	7035.00	1020.02	705.12	-954.27	0.00	
8224.00†	90.000	270.426	7035.00	1119.59	705.87	-1054.27	0.00	
8324.00†	90.000	270.426	7035.00	1219.16	706.61	-1154.27	0.00	
8424.00†	90.000	270.426	7035.00	1318.73	707.36	-1254.26	0.00	



Planned Wellpath Report

LAUNER 6 (REV-B.0) PWP

Page 5 of 8



REFERENCE WELLPATH IDENTIFICATION

Operator	EXTRACTION OIL & GAS	Slot	SLOT#18 LAUNER 6(792'FSL & 349'FEL,SEC.26)
Area	COLORADO	Well	LAUNER 6
Field	WELD COUNTY (NAD83/TRUE NORTH)	Wellbore	LAUNER 6 PWB
Facility	SEC.26-T07N-R67W		

WELLPATH DATA (153 stations) † = interpolated/extrapolated station

MD [ft]	Inclination [°]	Azimuth [°]	TVD [ft]	Vert Sect [ft]	North [ft]	East [ft]	DLS [°/100ft]	Comments
8524.00†	90.000	270.426	7035.00	1418.30	708.10	-1354.26	0.00	
8624.00†	90.000	270.426	7035.00	1517.87	708.84	-1454.26	0.00	
8724.00†	90.000	270.426	7035.00	1617.44	709.59	-1554.25	0.00	
8824.00†	90.000	270.426	7035.00	1717.01	710.33	-1654.25	0.00	
8924.00†	90.000	270.426	7035.00	1816.58	711.08	-1754.25	0.00	
9024.00†	90.000	270.426	7035.00	1916.15	711.82	-1854.25	0.00	
9124.00†	90.000	270.426	7035.00	2015.72	712.57	-1954.24	0.00	
9224.00†	90.000	270.426	7035.00	2115.29	713.31	-2054.24	0.00	
9324.00†	90.000	270.426	7035.00	2214.86	714.05	-2154.24	0.00	
9424.00†	90.000	270.426	7035.00	2314.43	714.80	-2254.24	0.00	
9524.00†	90.000	270.426	7035.00	2414.00	715.54	-2354.23	0.00	
9624.00†	90.000	270.426	7035.00	2513.57	716.29	-2454.23	0.00	
9724.00†	90.000	270.426	7035.00	2613.14	717.03	-2554.23	0.00	
9824.00†	90.000	270.426	7035.00	2712.71	717.78	-2654.22	0.00	
9924.00†	90.000	270.426	7035.00	2812.28	718.52	-2754.22	0.00	
10024.00†	90.000	270.426	7035.00	2911.85	719.26	-2854.22	0.00	
10124.00†	90.000	270.426	7035.00	3011.42	720.01	-2954.22	0.00	
10224.00†	90.000	270.426	7035.00	3110.99	720.75	-3054.21	0.00	
10324.00†	90.000	270.426	7035.00	3210.56	721.50	-3154.21	0.00	
10424.00†	90.000	270.426	7035.00	3310.13	722.24	-3254.21	0.00	
10524.00†	90.000	270.426	7035.00	3409.70	722.99	-3354.20	0.00	
10624.00†	90.000	270.426	7035.00	3509.28	723.73	-3454.20	0.00	
10724.00†	90.000	270.426	7035.00	3608.85	724.47	-3554.20	0.00	
10824.00†	90.000	270.426	7035.00	3708.42	725.22	-3654.20	0.00	
10924.00†	90.000	270.426	7035.00	3807.99	725.96	-3754.19	0.00	
11024.00†	90.000	270.426	7035.00	3907.56	726.71	-3854.19	0.00	
11124.00†	90.000	270.426	7035.00	4007.13	727.45	-3954.19	0.00	
11224.00†	90.000	270.426	7035.00	4106.70	728.20	-4054.19	0.00	
11324.00†	90.000	270.426	7035.00	4206.27	728.94	-4154.18	0.00	
11424.00†	90.000	270.426	7035.00	4305.84	729.69	-4254.18	0.00	



Planned Wellpath Report

LAUNER 6 (REV-B.0) PWP

Page 6 of 8



REFERENCE WELLPATH IDENTIFICATION

Operator	EXTRACTION OIL & GAS	Slot	SLOT#18 LAUNER 6(792'FSL & 349'FEL,SEC.26)
Area	COLORADO	Well	LAUNER 6
Field	WELD COUNTY (NAD83/TRUE NORTH)	Wellbore	LAUNER 6 PWB
Facility	SEC.26-T07N-R67W		

WELLPATH DATA (153 stations) † = interpolated/extrapolated station

MD [ft]	Inclination [°]	Azimuth [°]	TVD [ft]	Vert Sect [ft]	North [ft]	East [ft]	DLS [°/100ft]	Comments
11524.00†	90.000	270.426	7035.00	4405.41	730.43	-4354.18	0.00	
11624.00†	90.000	270.426	7035.00	4504.98	731.17	-4454.17	0.00	
11724.00†	90.000	270.426	7035.00	4604.55	731.92	-4554.17	0.00	
11824.00†	90.000	270.426	7035.00	4704.12	732.66	-4654.17	0.00	
11924.00†	90.000	270.426	7035.00	4803.69	733.41	-4754.17	0.00	
12024.00†	90.000	270.426	7035.00	4903.26	734.15	-4854.16	0.00	
12124.00†	90.000	270.426	7035.00	5002.83	734.90	-4954.16	0.00	
12224.00†	90.000	270.426	7035.00	5102.40	735.64	-5054.16	0.00	
12324.00†	90.000	270.426	7035.00	5201.97	736.38	-5154.15	0.00	
12424.00†	90.000	270.426	7035.00	5301.54	737.13	-5254.15	0.00	
12524.00†	90.000	270.426	7035.00	5401.11	737.87	-5354.15	0.00	
12624.00†	90.000	270.426	7035.00	5500.68	738.62	-5454.15	0.00	
12724.00†	90.000	270.426	7035.00	5600.25	739.36	-5554.14	0.00	
12824.00†	90.000	270.426	7035.00	5699.82	740.11	-5654.14	0.00	
12924.00†	90.000	270.426	7035.00	5799.39	740.85	-5754.14	0.00	
13024.00†	90.000	270.426	7035.00	5898.96	741.59	-5854.14	0.00	
13124.00†	90.000	270.426	7035.00	5998.53	742.34	-5954.13	0.00	
13224.00†	90.000	270.426	7035.00	6098.10	743.08	-6054.13	0.00	
13324.00†	90.000	270.426	7035.00	6197.67	743.83	-6154.13	0.00	
13424.00†	90.000	270.426	7035.00	6297.24	744.57	-6254.12	0.00	
13524.00†	90.000	270.426	7035.00	6396.81	745.32	-6354.12	0.00	
13624.00†	90.000	270.426	7035.00	6496.38	746.06	-6454.12	0.00	
13724.00†	90.000	270.426	7035.00	6595.95	746.80	-6554.12	0.00	
13824.00†	90.000	270.426	7035.00	6695.52	747.55	-6654.11	0.00	
13924.00†	90.000	270.426	7035.00	6795.09	748.29	-6754.11	0.00	
14024.00†	90.000	270.426	7035.00	6894.66	749.04	-6854.11	0.00	
14124.00†	90.000	270.426	7035.00	6994.23	749.78	-6954.10	0.00	
14224.00†	90.000	270.426	7035.00	7093.80	750.53	-7054.10	0.00	
14324.00†	90.000	270.426	7035.00	7193.37	751.27	-7154.10	0.00	
14424.00†	90.000	270.426	7035.00	7292.94	752.02	-7254.10	0.00	



Planned Wellpath Report

LAUNER 6 (REV-B.0) PWP

Page 7 of 8



REFERENCE WELLPATH IDENTIFICATION

Operator	EXTRACTION OIL & GAS	Slot	SLOT#18 LAUNER 6(792'FSL & 349'FEL,SEC.26)
Area	COLORADO	Well	LAUNER 6
Field	WELD COUNTY (NAD83/TRUE NORTH)	Wellbore	LAUNER 6 PWB
Facility	SEC.26-T07N-R67W		

WELLPATH DATA (153 stations) † = interpolated/extrapolated station

MD [ft]	Inclination [°]	Azimuth [°]	TVD [ft]	Vert Sect [ft]	North [ft]	East [ft]	DLS [°/100ft]	Comments
14524.00†	90.000	270.426	7035.00	7392.51	752.76	-7354.09	0.00	
14624.00†	90.000	270.426	7035.00	7492.08	753.50	-7454.09	0.00	
14667.50	90.000	270.426	7035.00 ²	7535.39	753.83	-7497.59	0.00	End of Tangent

HOLE & CASING SECTIONS - Ref Wellbore: LAUNER 6 PWB Ref Wellpath: LAUNER 6 (REV-B.0) PWP

String/Diameter	Start MD [ft]	End MD [ft]	Interval [ft]	Start TVD [ft]	End TVD [ft]	Start N/S [ft]	Start E/W [ft]	End N/S [ft]	End E/W [ft]
7in Casing Intermediate	24.00	7411.71	7387.71	24.00	7035.00	0.00	0.00	699.82	-242.00



Planned Wellpath Report

LAUNER 6 (REV-B.0) PWP

Page 8 of 8



REFERENCE WELLPATH IDENTIFICATION

Operator	EXTRACTION OIL & GAS	Slot	SLOT#18 LAUNER 6(792'FSL & 349'FEL,SEC.26)
Area	COLORADO	Well	LAUNER 6
Field	WELD COUNTY (NAD83/TRUE NORTH)	Wellbore	LAUNER 6 PWB
Facility	SEC.26-T07N-R67W		

TARGETS

Name	MD [ft]	TVD [ft]	North [ft]	East [ft]	Grid East [US ft]	Grid North [US ft]	Latitude	Longitude	Shape
SEC.26-T07N-R67W		-17.00	4001.34	-152.84	3179860.07	1444245.18	40°33'03.784"N	104°51'09.932"W	polygon
SEC.27-T07N-R67W		-17.00	4001.34	-152.84	3179860.07	1444245.18	40°33'03.784"N	104°51'09.932"W	polygon
2) LAUNER 6 BHL ON PLAT REV-1(1554'FSL & 2561'FEL,SEC.27)	14667.50	7035.00	753.83	-7497.59	3172539.49	1440944.20	40°32'31.682"N	104°52'45.066"W	point
LAUNER 6 DRILLING CORRIDOR(60')		7035.00	0.00	0.00	3180042.13	1440245.19	40°32'24.245"N	104°51'07.952"W	polygon
LAUNER 6 LANDING		7035.00	699.86	-110.90	3179926.13	1440944.20	40°32'31.160"N	104°51'09.389"W	point
1) LAUNER 6 LANDING REV-1	7411.71	7035.00	699.82	-242.00	3179795.04	1440943.20	40°32'31.160"N	104°51'11.087"W	point

SURVEY PROGRAM - Ref Wellbore: LAUNER 6 PWB Ref Wellpath: LAUNER 6 (REV-B.0) PWP

Start MD [ft]	End MD [ft]	Positional Uncertainty Model	Log Name/Comment	Wellbore
24.00	15000.00	NaviTrak (Standard)		LAUNER 6 PWB