

LEGEND:

 PROPOSED LOCATION

REV: 1 11-02-16 K.B. (TEMPLATE UPDATE)



BILL BARRETT CORPORATION

WILL TRUST 6-62-10 11 CW2 PAD
SW 1/4 NW 1/4, SECTION 10, T6N, R62W, 6th P.M.
WELD COUNTY, COLORADO



UELS, LLC
 Corporate Office * 85 South 200 East
 Vernal, UT 84078 * (435) 789-1017

SURVEYED BY	D.S.	10-28-16	SCALE
DRAWN BY	C.D.L.	03-21-16	1 : 100,000
ACCESS ROAD MAP			TOPO A

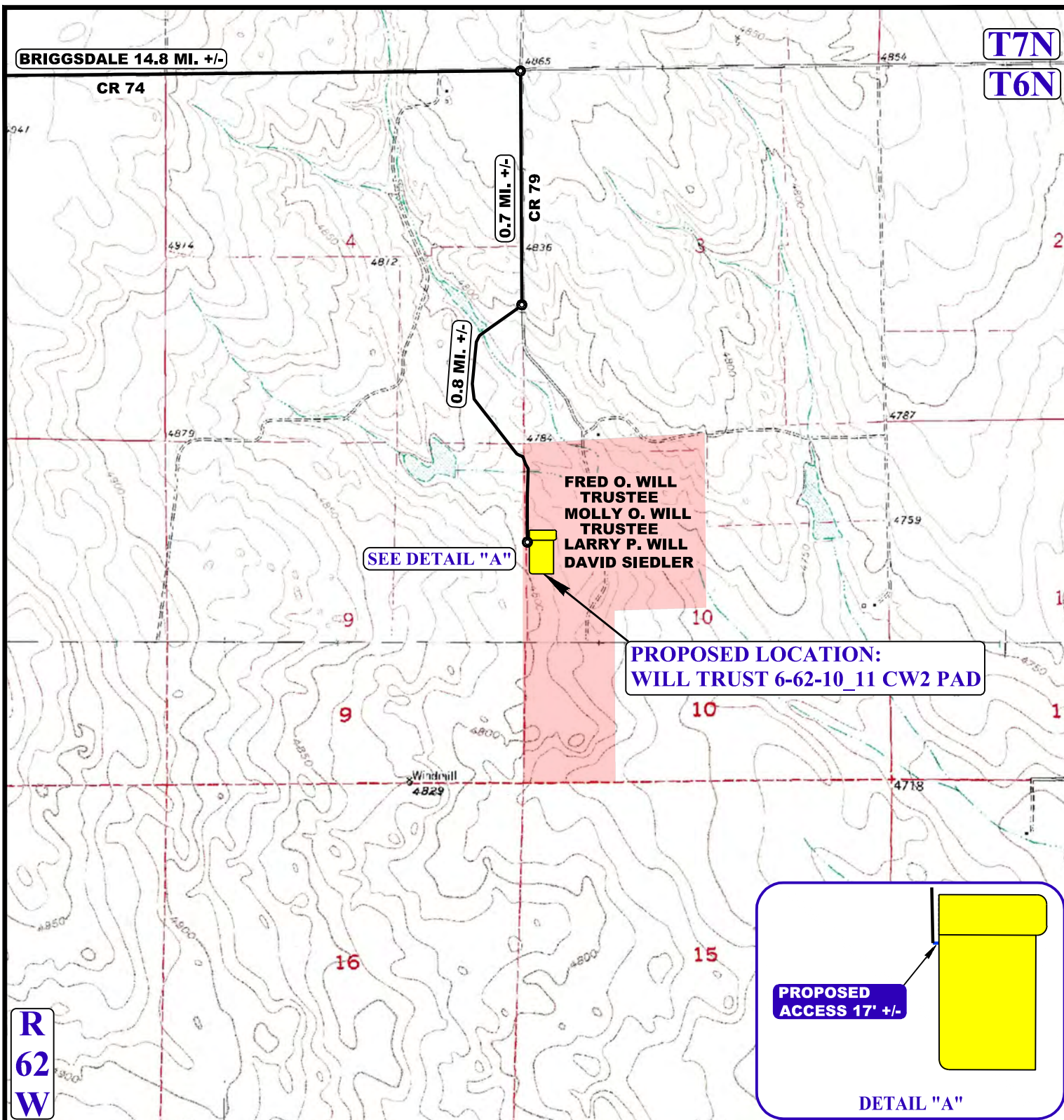

NOTE: PARCEL DATA SHOWN HAS BEEN OBTAINED FROM VARIOUS SOURCES AND SHOULD BE USED FOR MAPPING, GRAPHIC AND PLANNING PURPOSES ONLY. NO WARRANTY IS MADE BY UINTAH ENGINEERING AND LAND SURVEYING (UELS) FOR ACCURACY OF THE PARCEL DATA.

LEGEND:

— EXISTING ROAD
- - - PROPOSED ROAD

REV: 1 11-02-16 K.B. (PAD CHANGE)



BILL BARRETT CORPORATION

WILL TRUST 6-62-10_11 CW2 PAD
SW 1/4 NW 1/4, SECTION 10, T6N, R62W, 6th P.M.
WELD COUNTY, COLORADO

SURVEYED BY	D.S.	10-28-16	SCALE
DRAWN BY	C.D.L.	03-21-16	1 : 24,000
ACCESS ROAD MAP			TOPO B



UELS, LLC
Corporate Office * 85 South 200 East
Vernal, UT 84078 * (435) 789-1017