

## **FIGURES**

**Figure 1: Topographic Site Location Map**

**Figure 2: Aerial Site Location Map**

**Figure 3: Soil Analytical Map**

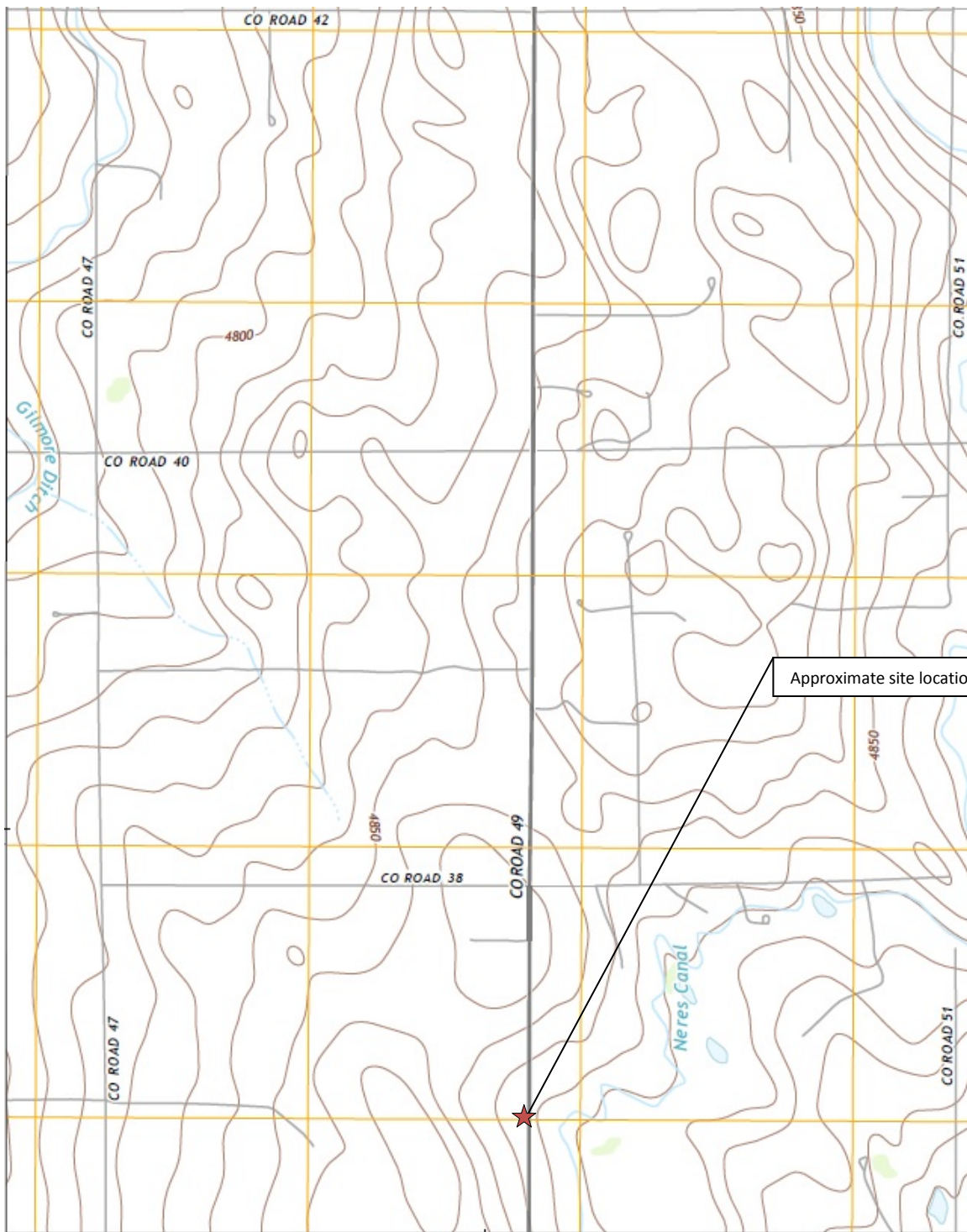

Approximate site location



**Topographic Site Location Map**  
Houndskeeper PC #H01-21D, H #1-22  
Water Vault Removal  
40.254936 / -104.602840  
SE¼ NE¼ SEC.1 T3N R65W 6PM  
Weld County, Colorado  
API # 05-123-31965, 05-123-27129



**EAGLE**  
ENVIRONMENTAL  
CONSULTING, INC.

Source: USGS 7.5 Minute Topographic  
Map, Valley View School, CO  
Quadrangle 2013

**Figure 1**



# LEGEND

- HOUNDSKEEPER PC #H01-21D, H #1-22 TANK BATTERY
- HOUNDSKEEPER PC #H01-21D WELL HEAD
- HOUNDSKEEPER H #1-22 WELL HEAD
- APPROXIMATE LOCATION OF WATER VAULT REMOVALS

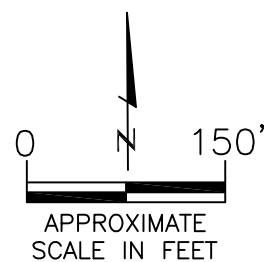

AERIAL SITE LOCATION MAP  
HOUNDSKEEPER PC #H01-21D, H #1-22  
WATER VAULT REMOVAL  
40.254936 / -104.602840  
SE1/4 NE1/4 SEC.1 T3N R65W 6PM  
WELD COUNTY, COLORADO  
API # 05-123-31965, 05-123-27129

DATE:  
03/24/16

FIG. NO.  
2

DRAWN BY:  
AMN



**EAGLE**  
ENVIRONMENTAL  
CONSULTING, INC.  
4101 INCA STREET, DENVER, CO 80211  
Ph: 303-433-0479 • F: 303-325-5449

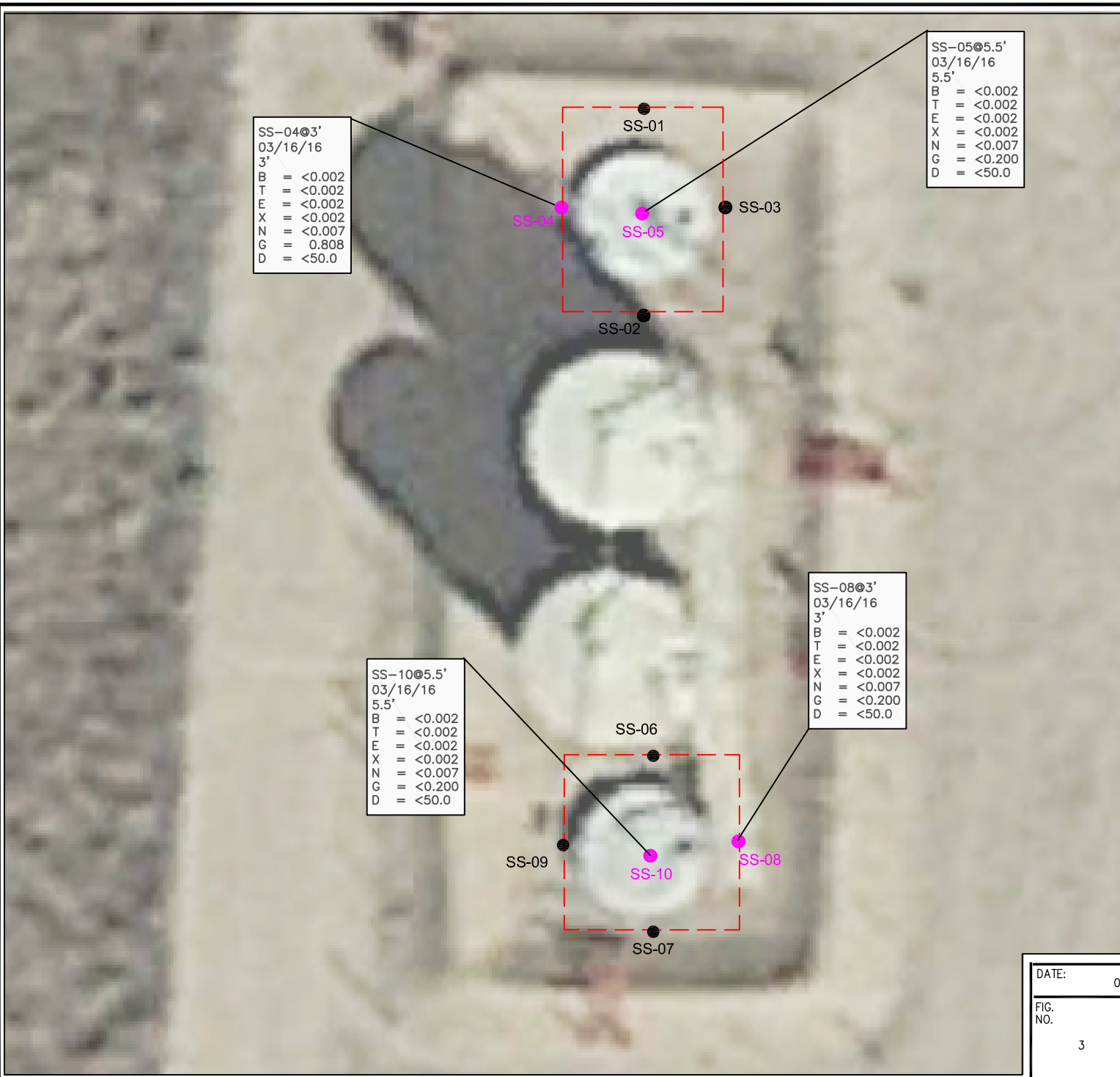

LEGEND

— APPROXIMATE EXCAVATION BOUNDARIES

● SS-01 APPROXIMATE LOCATION OF SOIL SAMPLES  
FIELD ANALYZED WITH PHOTOIONIZATION  
DETECTOR (PID)

● SS-02 APPROXIMATE LOCATION OF SOIL SAMPLES  
SUBMITTED FOR LABORATORY ANALYSIS

PARAMETERS

SAMPLE LOCATION	
DATE	
DEPTH (FEET)	
B	= BENZENE (mg/kg)
T	= TOLUENE (mg/kg)
E	= ETHYLBENZENE (mg/kg)
X	= TOTAL XYLENES (mg/kg)
N	= NAPHTHALENE (mg/kg)
G	= TPH-GRO (mg/kg)
D	= TPH-DRO (mg/kg)

mg/kg = MILLIGRAMS PER KILOGRAM

TPH-GRO = TOTAL PETROLEUM HYDROCARBONS - GASOLINE  
RANGE ORGANICS

TPH-DRO = TOTAL PETROLEUM HYDROCARBONS - DIESEL  
RANGE ORGANICS

NOTE: VALUES PRESENTED WITH A LESS THAN SYMBOL (<)  
DID NOT CONTAIN CONCENTRATIONS AT OR ABOVE  
LABORATORY DETECTION LIMITS

NOTE: AERIAL IMAGE DOES NOT REFLECT CURRENT SITE  
CONDITIONS. SITE OBSERVED BEING DECOMMISSIONED DURING  
TIME OF ASSESSMENT.

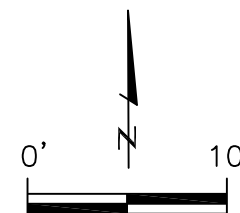

APPROXIMATE  
SCALE IN FEET

SOIL ANALYTICAL MAP  
HOUNDSKEEPER PC #H01-21D, H #1-22  
WATER VAULT REMOVAL  
40.254936/-104.602840  
SE1/4 NE1/4 SEC.1 T3N R65W 6PM  
WELD COUNTY, COLORADO  
API # 05-123-31965, 05-123-27129

DATE: 03/17/16

FIG.  
NO. 3

DRAWN BY:  
amn

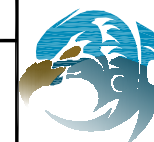

**EAGLE**  
ENVIRONMENTAL  
CONSULTING, INC.  
4101 INCA STREET, DENVER, CO 80211  
Ph: 303-433-0479 • F: 303-325-5449

## **TABLE**

**Table 1:     Soil Analytical Results Summary**



TABLE 1  
SOIL ANALYTICAL RESULTS SUMMARY  
HOUNDSKEEPER PC #H01-21D, H #1-22  
WATER VAULT REMOVAL  
40.254936 / -104.602840  
SE¼ NE¼ SEC.1 T3N R65W 6PM  
WELD COUNTY, COLORADO  
API # 05-123-31965, 05-123-27129

Sample Location (Latitude/Longitude)	Date	Approximate Depth (feet)	Benzene (mg/kg)	Toluene (mg/kg)	Ethylbenzene (mg/kg)	Total Xylenes (mg/kg)	Naphthalene (mg/kg)	TPH-GRO (mg/kg)	TPH-DRO (mg/kg)	Specific Conductance (mmhos/cm)	pH (pH units)	SAR
<b>COGCC Table 910-1 Regulatory Limits (mg/kg)</b>			<b>0.17</b>	<b>85</b>	<b>100</b>	<b>175</b>	<b>23</b>	<b>500</b>		<b>&lt;4</b>	<b>6 to 9</b>	<b>&lt;12<sup>^</sup>5</b>
SS-04 @ 3' (40.255005 / -104.602858)	03/16/16	3	<0.002	<0.002	<0.002	<0.002	<0.007	0.808	<50.0	0.0559	8.52	0.48
SS-05 @ 5.5' (40.255003 / -104.602837)	03/16/16	5.5	<0.002	<0.002	<0.002	<0.002	<0.007	<0.200	<50.0	NA	NA	NA
SS-08 @ 3' (40.254883 / -104.602820)	03/16/16	3	<0.002	<0.002	<0.002	<0.002	<0.007	<0.200	<50.0	0.0192	8.16	0.44
SS-10 @ 5.5' (40.254884 / -104.602839)	03/16/16	5.5	<0.002	<0.002	<0.002	<0.002	<0.007	<0.200	<50.0	NA	NA	NA
COGCC = Colorado Oil and Gas Conservation Commission mg/kg = milligrams per kilogram mmhos/cm = millimhos per centimeter NA = Not Analyzed TPH-GRO = Total Petroleum Hydrocarbons - Gasoline Range Organics TPH-DRO = Total Petroleum Hydrocarbons - Diesel Range Organics SAR = Sodium Adsorption Ratio Note: Values presented with a less than symbol (<) did not contain concentrations at or above the laboratory reporting limit.												



## **ATTACHMENT A**

### **Laboratory Analytical Report**



March 22, 2016

Eagle Environmental Consulting, Inc.

Martin C Eckert III

4101 Inca Street

Denver

CO 80211

**Project Name - Noble - Houndskeeper PC  
H01-21D, H01-22**

**Project Number - [none]**

Attached are your analytical results for Noble - Houndskeeper PC H01-21D, H01-22 received by Origins Laboratory, Inc. March 16, 2016. This project is associated with Origins project number X603212-01.

The analytical results in the following report were analyzed under the guidelines of EPA Methods. These methods are identified as follows; "SW" are defined in SW-846, "EPA" are defined in 40CFR part 136 and "SM" are defined in the most current revision of Standard Methods For the Examination of Water and Wastewater.

The analytical results apply specifically to the samples and analyses specified per the attached Chain of Custody. As such, this report shall not be reproduced except in full, without the written approval of Origin's laboratory.

Unless otherwise noted, the analytical results for all soil samples are reported on a wet weight basis. All analytical analyses were performed under NELAP guidelines unless noted by a data qualifier.

Any holding time exceedances, deviations from the method specifications or deviations from Origins Laboratory's Standard Operating Procedures are outlined in the case narrative.

Thank you for selecting Origins for your analytical needs. Please contact us with any questions concerning this report, or if we can help with anything at all.

Origins Laboratory, Inc.  
303.433.1322  
o-squad@oelabinc.com



1725 Elk Place, Denver, CO 80211 | Phone: 303.433.1322 | Fax: 303.265.9645



Eagle Environmental Consulting, Inc.

4101 Inca Street

Denver CO 80211

Martin C Eckert III

Project Number: [none]

Project: Noble - Houndskeeper PC H01-21D,  
H01-22

## CROSS REFERENCE REPORT

Sample ID	Laboratory ID	Matrix	Date Sampled	Date Received
SS-04 @ 3'	X603212-01	Soil	March 16, 2016 11:30	03/16/2016 14:51
SS-05 @ 5.5'	X603212-02	Soil	March 16, 2016 11:32	03/16/2016 14:51
SS-08 @ 3'	X603212-03	Soil	March 16, 2016 11:40	03/16/2016 14:51
SS-10 @ 5.5'	X603212-04	Soil	March 16, 2016 11:37	03/16/2016 14:51

Origins Laboratory, Inc.



*The results in this report apply to the samples analyzed in accordance with the chain of custody document. This analytical report must be reproduced in its entirety.*

Project: Noble - Houndskeeper PC H01-21D,  
H01-22

  
 www.originslaboratory.com

Client: Early Env Consulting, Inc  
 Address: 4101 Inco Street  
Denver, CO, 80211  
 Telephone Number: (303) 433-0179  
 Email Address: Mice3@early-env.com

Project Manager: Martin Cellert III  
 Project Name: Hewittskeeper PC H 01-21D, H 01-22  
 Project Number: -  
 Samples Collected By: A. Neuberg

page 1 of 1

Sample ID Description	Date Sampled	Time Sampled	# of Containers	Preservative	Matrix	Analysis	Sample Instructions
SS - 04 @ 3'	3/16/16	1130	2	Unpreserved	Soil	X BTEX X GC X DCO X MS/MS X CC, S&H	1
SS - 05 @ 5.5'	↓	1132	↓	↓	↓	↓	2
SS - 08 @ 3'	↓	1140	↓	↓	↓	↓	3
SS - 10 @ 5.5'	↓	1137	↓	↓	↓	↓	4
							5
							6
							7
							8
							9
							10

Relinquished By: Ad Nbg Date: 3/16/16 Time: 1451  
 Relinquished By: \_\_\_\_\_ Date: \_\_\_\_\_ Time: \_\_\_\_\_  
 Received By: Jay Ann Date: 3/16/16 Time: 1451  
 Received By: \_\_\_\_\_ Date: \_\_\_\_\_ Time: \_\_\_\_\_  
 Turnaround Time: Same Day ☒ 24 Hr ☐ 48 Hr ☐ 72 Hr ☐ Standard

Bill to Howard  
 Temp Received: 43  
 Date Results Needed: BNB

Origins Laboratory, Inc.

Jose Pellegrini

*The results in this report apply to the samples analyzed in accordance with the chain of custody document. This analytical report must be reproduced in its entirety.*

Eagle Environmental Consulting, Inc.

4101 Inca Street

Denver CO 80211

Martin C Eckert III

Project Number: [none]

Project: Noble - Houndskeeper PC H01-21D, H01-22

Origins Laboratory

F-012207-01-R1  
Effective Date: 01/09/12

## Sample Receipt Checklist

Origins Work Order: X603212

Client: Eagle

Client Project ID: Houndskeeper PC H 01-21D, H01-22

Checklist Completed by: Jeff Smith

Shipped Via: AD

(UPS, FedEx, Hand Delivered, Pick-up, etc.)

Date/time completed: 3/16/16

Airbill #: NK

Matrix(s) Received: (Check all that apply): ☒ Soil/Solid ☐ Water ☐ Other: \_\_\_\_\_

Cooler Number/Temperature: 1 / 4.3 °C 1 / \_\_\_\_\_ °C 1 / \_\_\_\_\_ °C (Describe)

Thermometer ID: T003

Requirement Description	Yes	No	N/A	Comments (if any)
If samples require cooling, was the temperature between 0°C to ≤ 6°C <sup>(1)</sup> ?	<input checked="" type="checkbox"/>			
Is there ice present (document if blue ice is used)	<input checked="" type="checkbox"/>			
Are custody seals present on cooler? (if so, document in comments if they are signed and dated, broken or intact)		<input checked="" type="checkbox"/>		
Are custody seals present on each sample container? (if so, document in comments if they are signed and dated, broken or intact)		<input checked="" type="checkbox"/>		
Were all samples received intact <sup>(1)</sup> ?	<input checked="" type="checkbox"/>			
Was adequate sample volume provided <sup>(1)</sup> ?	<input checked="" type="checkbox"/>			
Are short holding time analytes or samples with HTs due within 48 hours present <sup>(1)</sup> ?	<input checked="" type="checkbox"/>			Ph
Is a chain-of-custody (COC) present and filled out completely <sup>(1)</sup> ?	<input checked="" type="checkbox"/>			
Does the COC agree with the number and type of sample bottles received <sup>(1)</sup> ?	<input checked="" type="checkbox"/>			
Do the sample IDs on the bottle labels match the COC <sup>(1)</sup> ?	<input checked="" type="checkbox"/>			
Is the COC properly relinquished by the client with date and time recorded <sup>(1)</sup> ?	<input checked="" type="checkbox"/>			
For volatiles in water – is there headspace (> ¼ inch bubble) present? If yes, contact client and note in narrative.			<input checked="" type="checkbox"/>	
Are samples preserved that require preservation and was it checked <sup>(1)</sup> ? (note ID of confirmation instrument used in comments) / (preservation is not confirmed for subcontracted analyses in order to insure sample integrity)/(pH <2 for samples preserved with HNO <sub>3</sub> , HCL, H <sub>2</sub> SO <sub>4</sub> ) / (pH >10 for samples preserved with NaAsO <sub>2</sub> +NaOH, ZnAc+NaOH)			<input checked="" type="checkbox"/>	
Additional Comments (if any):				

<sup>(1)</sup> If NO, then contact the client before proceeding with analysis and note date/time and person contacted as well as the corrective action to in the additional comments (above) and the case narrative.

Jeff Smith  
Reviewed by (Project Manager)

3/16/16  
Date/Time Reviewed

Origins Laboratory, Inc.

*Jeff Pellegrini*

The results in this report apply to the samples analyzed in accordance with the chain of custody document. This analytical report must be reproduced in its entirety.

Eagle Environmental Consulting, Inc.

4101 Inca Street

Denver CO 80211

Martin C Eckert III

Project Number: [none]

Project: Noble - Houndskeeper PC H01-21D,  
H01-22

SS-04 @ 3'

3/16/2016 11:30:00AM

Analyte	Result	Reporting Limit	Units	Dilution	Batch	Prepared	Analyzed	Notes
---------	--------	--------------------	-------	----------	-------	----------	----------	-------

Origins Laboratory, Inc.

X603212-01 (Soil)

## Diesel Range Organics (DRO/TEPH) by EPA 8015C

Diesel (C10-C28)	ND	50.0	mg/kg	1	B6C1604	03/16/2016	03/16/2016	U
Surrogate: o-Terphenyl	93.4 %	59-131			"	"	"	

## GBTEX + Napthalene by 8260C

Gasoline Range Hydrocarbons	0.808	0.200	mg/kg	1	B6C1603	03/16/2016	03/16/2016	
Benzene	ND	0.002	"	"	"	"	"	U
Toluene	ND	0.002	"	"	"	"	"	U
Ethylbenzene	ND	0.002	"	"	"	"	"	U
Xylenes, total	ND	0.002	"	"	"	"	"	U
Napthalene	ND	0.007	"	"	"	"	"	U
Surrogate: 1,2-Dichloroethane-d4	106 %	70-130			"	"	"	
Surrogate: Toluene-d8	97.8 %	70-130			"	"	"	
Surrogate: 4-Bromofluorobenzene	98.3 %	70-130			"	"	"	

## Metals by 6010

Calcium	1.39		me/L	1	'[none]'	03/17/2016	03/21/2016	
Magnesium	1.07		"	"	"	"	"	
Sodium	0.53		"	"	"	"	"	

## pH in Soil by EPA 9045D

Origins Laboratory, Inc.



The results in this report apply to the samples analyzed in accordance with the chain of custody document. This analytical report must be reproduced in its entirety.

Eagle Environmental Consulting, Inc.

4101 Inca Street

Denver CO 80211

Martin C Eckert III

Project Number: [none]

Project: Noble - Houndskeeper PC H01-21D,  
H01-22

SS-04 @ 3'

3/16/2016 11:30:00AM

Analyte	Result	Reporting Limit	Units	Dilution	Batch	Prepared	Analyzed	Notes
---------	--------	--------------------	-------	----------	-------	----------	----------	-------

**Origins Laboratory, Inc.**  
**X603212-01 (Soil)**

**pH in Soil by EPA 9045D**

pH	8.52	pH Units	1	B6C1605	03/16/2016	03/16/2016
----	------	----------	---	---------	------------	------------

**SAR by 20B Saturated Paste**

SAR	0.48		1	'[none]'	03/17/2016	03/21/2016
-----	------	--	---	----------	------------	------------

**Specific Conductance by Modified 9050A**

Specific Conductance (EC)	0.0559	mmhos/cm	1	B6C1606	03/16/2016	03/16/2016
---------------------------	--------	----------	---	---------	------------	------------

Origins Laboratory, Inc.



*The results in this report apply to the samples analyzed in  
accordance with the chain of custody document. This  
analytical report must be reproduced in its entirety.*

Eagle Environmental Consulting, Inc.  
4101 Inca Street  
Denver CO 80211

Martin C Eckert III  
Project Number: [none]  
Project: Noble - Houndskeeper PC H01-21D,  
H01-22

SS-05 @ 5.5'

3/16/2016 11:32:00AM

Analyte	Result	Reporting Limit	Units	Dilution	Batch	Prepared	Analyzed	Notes
---------	--------	--------------------	-------	----------	-------	----------	----------	-------

Origins Laboratory, Inc.  
X603212-02 (Soil)

## Diesel Range Organics (DRO/TEPH) by EPA 8015C

Diesel (C10-C28)	ND	50.0	mg/kg	1	B6C1604	03/16/2016	03/16/2016	U
Surrogate: o-Terphenyl	90.2 %	59-131			"	"	"	

## GBTEX + Napthalene by 8260C

Gasoline Range Hydrocarbons	ND	0.200	mg/kg	1	B6C1603	03/16/2016	03/16/2016	U
Benzene	ND	0.002	"	"	"	"	"	U
Toluene	ND	0.002	"	"	"	"	"	U
Ethylbenzene	ND	0.002	"	"	"	"	"	U
Xylenes, total	ND	0.002	"	"	"	"	"	U
Napthalene	ND	0.007	"	"	"	"	"	U
Surrogate: 1,2-Dichloroethane-d4	108 %	70-130			"	"	"	
Surrogate: Toluene-d8	98.1 %	70-130			"	"	"	
Surrogate: 4-Bromofluorobenzene	102 %	70-130			"	"	"	

Origins Laboratory, Inc.



The results in this report apply to the samples analyzed in accordance with the chain of custody document. This analytical report must be reproduced in its entirety.



Eagle Environmental Consulting, Inc.

4101 Inca Street

Denver CO 80211

Martin C Eckert III

Project Number: [none]

Project: Noble - Houndskeeper PC H01-21D,  
H01-22

SS-08 @ 3'

3/16/2016 11:40:00AM

Analyte	Result	Reporting Limit	Units	Dilution	Batch	Prepared	Analyzed	Notes
---------	--------	--------------------	-------	----------	-------	----------	----------	-------

Origins Laboratory, Inc.  
X603212-03 (Soil)

## Diesel Range Organics (DRO/TEPH) by EPA 8015C

Diesel (C10-C28)	ND	50.0	mg/kg	1	B6C1604	03/16/2016	03/16/2016	U
Surrogate: o-Terphenyl	82.4 %	59-131			"	"	"	

## GBTEX + Napthalene by 8260C

Gasoline Range Hydrocarbons	ND	0.200	mg/kg	1	B6C1603	03/16/2016	03/16/2016	U
Benzene	ND	0.002	"	"	"	"	"	U
Toluene	ND	0.002	"	"	"	"	"	U
Ethylbenzene	ND	0.002	"	"	"	"	"	U
Xylenes, total	ND	0.002	"	"	"	"	"	U
Naphthalene	ND	0.007	"	"	"	"	"	U
Surrogate: 1,2-Dichloroethane-d4	104 %	70-130			"	"	"	
Surrogate: Toluene-d8	98.4 %	70-130			"	"	"	
Surrogate: 4-Bromofluorobenzene	100 %	70-130			"	"	"	

## Metals by 6010

Calcium	1.37		me/L	1	'[none]'	03/17/2016	03/21/2016	
Magnesium	0.75		"	"	"	"	"	
Sodium	0.45		"	"	"	"	"	

## pH in Soil by EPA 9045D

Origins Laboratory, Inc.



The results in this report apply to the samples analyzed in accordance with the chain of custody document. This analytical report must be reproduced in its entirety.

Eagle Environmental Consulting, Inc.

4101 Inca Street

Denver CO 80211

Martin C Eckert III

Project Number: [none]

Project: Noble - Houndskeeper PC H01-21D,  
H01-22

SS-08 @ 3'

3/16/2016 11:40:00AM

Analyte	Result	Reporting Limit	Units	Dilution	Batch	Prepared	Analyzed	Notes
---------	--------	--------------------	-------	----------	-------	----------	----------	-------

**Origins Laboratory, Inc.**  
**X603212-03 (Soil)**

**pH in Soil by EPA 9045D**

pH	8.16	pH Units	1	B6C1605	03/16/2016	03/16/2016
----	------	----------	---	---------	------------	------------

**SAR by 20B Saturated Paste**

SAR	0.44		1	'[none]'	03/17/2016	03/21/2016
-----	------	--	---	----------	------------	------------

**Specific Conductance by Modified 9050A**

Specific Conductance (EC)	0.0192	mmhos/cm	1	B6C1606	03/16/2016	03/16/2016
---------------------------	--------	----------	---	---------	------------	------------

Origins Laboratory, Inc.



*The results in this report apply to the samples analyzed in  
accordance with the chain of custody document. This  
analytical report must be reproduced in its entirety.*

Eagle Environmental Consulting, Inc.

4101 Inca Street

Denver CO 80211

Martin C Eckert III

Project Number: [none]

Project: Noble - Houndskeeper PC H01-21D,  
H01-22

SS-10 @ 5.5'

3/16/2016 11:37:00AM

Analyte	Result	Reporting Limit	Units	Dilution	Batch	Prepared	Analyzed	Notes
---------	--------	--------------------	-------	----------	-------	----------	----------	-------

Origins Laboratory, Inc.

X603212-04 (Soil)

## Diesel Range Organics (DRO/TEPH) by EPA 8015C

Diesel (C10-C28)	ND	50.0	mg/kg	1	B6C1604	03/16/2016	03/16/2016	U
Surrogate: o-Terphenyl	90.8 %	59-131			"	"	"	

## GBTEX + Napthalene by 8260C

Gasoline Range Hydrocarbons	ND	0.200	mg/kg	1	B6C1603	03/16/2016	03/16/2016	U
Benzene	ND	0.002	"	"	"	"	"	U
Toluene	ND	0.002	"	"	"	"	"	U
Ethylbenzene	ND	0.002	"	"	"	"	"	U
Xylenes, total	ND	0.002	"	"	"	"	"	U
Naphthalene	ND	0.007	"	"	"	"	"	U
Surrogate: 1,2-Dichloroethane-d4	110 %	70-130			"	"	"	
Surrogate: Toluene-d8	97.4 %	70-130			"	"	"	
Surrogate: 4-Bromofluorobenzene	100 %	70-130			"	"	"	

Origins Laboratory, Inc.



The results in this report apply to the samples analyzed in accordance with the chain of custody document. This analytical report must be reproduced in its entirety.

Eagle Environmental Consulting, Inc.

4101 Inca Street

Denver CO 80211

Martin C Eckert III

Project Number: [none]

Project: Noble - Houndskeeper PC H01-21D,  
H01-22

**Volatile Organic Compounds by GC/MS SW846 8260C - Quality Control**  
**Origins Laboratory, Inc.**

Analyte	Result	Reporting Limit	Units	Spike Level	Source Result	%REC	%REC Limits	RPD	RPD Limit	Notes
<b>Batch B6C1603 - EPA 5030 (soil)</b>										
<b>Blank (B6C1603-BLK1)</b>					Prepared: 03/16/2016 Analyzed: 03/16/2016					
Gasoline Range Hydrocarbons	ND	0.200	mg/kg							U
Benzene	ND	0.002	"							U
Toluene	ND	0.002	"							U
Ethylbenzene	ND	0.002	"							U
Xylenes, total	ND	0.002	"							U
Naphthalene	ND	0.007	"							U
Surrogate: 1,2-Dichloroethane-d4	67		ug/kg	62.5		108	70-130			
Surrogate: Toluene-d8	61		"	62.5		97.8	70-130			
Surrogate: 4-Bromofluorobenzene	61		"	62.5		97.3	70-130			

Origins Laboratory, Inc.



The results in this report apply to the samples analyzed in accordance with the chain of custody document. This analytical report must be reproduced in its entirety.

Eagle Environmental Consulting, Inc.

4101 Inca Street

Denver CO 80211

Martin C Eckert III

Project Number: [none]

Project: Noble - Houndskeeper PC H01-21D,  
H01-22

**Volatile Organic Compounds by GC/MS SW846 8260C - Quality Control**  
**Origins Laboratory, Inc.**

Analyte	Result	Reporting Limit	Units	Spike Level	Source Result	%REC	%REC Limits	RPD	RPD Limit	Notes
<b>Batch B6C1603 - EPA 5030 (soil)</b>										
<b>LCS (B6C1603-BS1)</b>					Prepared: 03/16/2016 Analyzed: 03/16/2016					
Benzene	0.099	0.002	mg/kg	0.100		99.1	70-130			
Toluene	0.106	0.002	"	0.100		106	70-130			
Ethylbenzene	0.089	0.002	"	0.100		89.2	70-130			
m,p-Xylene	0.191	0.004	"	0.200		95.6	70-130			
o-Xylene	0.087	0.002	"	0.100		87.1	70-130			
Naphthalene	0.106	0.007	"	0.100		106	70-130			
Surrogate: 1,2-Dichloroethane-d4	62		ug/kg	62.5		99.7	70-130			
Surrogate: Toluene-d8	61		"	62.5		97.4	70-130			
Surrogate: 4-Bromofluorobenzene	61		"	62.5		98.0	70-130			

Origins Laboratory, Inc.



The results in this report apply to the samples analyzed in accordance with the chain of custody document. This analytical report must be reproduced in its entirety.

Eagle Environmental Consulting, Inc.

4101 Inca Street

Denver CO 80211

Martin C Eckert III

Project Number: [none]

Project: Noble - Houndskeeper PC H01-21D,  
H01-22

**Volatile Organic Compounds by GC/MS SW846 8260C - Quality Control**  
**Origins Laboratory, Inc.**

Analyte	Result	Reporting Limit	Units	Spike Level	Source Result	%REC	%REC Limits	RPD	RPD Limit	Notes
---------	--------	-----------------	-------	-------------	---------------	------	-------------	-----	-----------	-------

**Batch B6C1603 - EPA 5030 (soil)**

Matrix Spike (B6C1603-MS1)		Source: X603208-02			Prepared: 03/16/2016 Analyzed: 03/16/2016					
Benzene	0.108	0.002	mg/kg	0.100	0.004	104	70-130			
Toluene	0.108	0.002	"	0.100	ND	108	70-130			
Ethylbenzene	0.092	0.002	"	0.100	0.002	89.2	70-130			
m,p-Xylene	0.192	0.004	"	0.200	ND	95.8	70-130			
o-Xylene	0.089	0.002	"	0.100	ND	88.6	70-130			
Naphthalene	0.112	0.007	"	0.100	0.001	111	70-130			
Surrogate: 1,2-Dichloroethane-d4	68		ug/kg	62.5		109	70-130			
Surrogate: Toluene-d8	60		"	62.5		96.4	70-130			
Surrogate: 4-Bromofluorobenzene	62		"	62.5		98.6	70-130			

Origins Laboratory, Inc.



The results in this report apply to the samples analyzed in accordance with the chain of custody document. This analytical report must be reproduced in its entirety.



Eagle Environmental Consulting, Inc.

4101 Inca Street

Denver CO 80211

Martin C Eckert III

Project Number: [none]

Project: Noble - Houndskeeper PC H01-21D,  
H01-22

**Volatile Organic Compounds by GC/MS SW846 8260C - Quality Control**  
**Origins Laboratory, Inc.**

Analyte	Result	Reporting Limit	Units	Spike Level	Source Result	%REC	%REC Limits	RPD	RPD Limit	Notes
---------	--------	-----------------	-------	-------------	---------------	------	-------------	-----	-----------	-------

**Batch B6C1603 - EPA 5030 (soil)**

Matrix Spike Dup (B6C1603-MSD1)		Source: X603208-02			Prepared: 03/16/2016 Analyzed: 03/16/2016					
Benzene	0.104	0.002	mg/kg	0.100	0.004	101	70-130	3.40	20	
Toluene	0.110	0.002	"	0.100	ND	110	70-130	2.18	20	
Ethylbenzene	0.093	0.002	"	0.100	0.002	90.2	70-130	1.06	20	
m,p-Xylene	0.198	0.004	"	0.200	ND	99.2	70-130	3.46	20	
o-Xylene	0.091	0.002	"	0.100	ND	90.9	70-130	2.52	20	
Naphthalene	0.104	0.007	"	0.100	0.001	103	70-130	7.41	20	
Surrogate: 1,2-Dichloroethane-d4	64		ug/kg	62.5		103	70-130			
Surrogate: Toluene-d8	61		"	62.5		97.4	70-130			
Surrogate: 4-Bromofluorobenzene	62		"	62.5		98.6	70-130			

Origins Laboratory, Inc.



The results in this report apply to the samples analyzed in accordance with the chain of custody document. This analytical report must be reproduced in its entirety.

Eagle Environmental Consulting, Inc.  
4101 Inca Street  
Denver CO 80211

Martin C Eckert III  
Project Number: [none]  
Project: Noble - Houndskeeper PC H01-21D,  
H01-22

**Volatile Organic Compounds by GC/MS SW846 8260C - Quality Control**  
**Origins Laboratory, Inc.**

Analyte	Result	Reporting Limit	Units	Spike Level	Source Result	%REC	%REC Limits	RPD	RPD Limit	Notes
---------	--------	-----------------	-------	-------------	---------------	------	-------------	-----	-----------	-------

**Extractable Petroleum Hydrocarbons by 8015C - Quality Control**  
**Origins Laboratory, Inc.**

Analyte	Result	Reporting Limit	Units	Spike Level	Source Result	%REC	%REC Limits	RPD	RPD Limit	Notes
---------	--------	-----------------	-------	-------------	---------------	------	-------------	-----	-----------	-------

**Batch B6C1604 - EPA 3580**

**Blank (B6C1604-BLK1)**

Prepared: 03/16/2016 Analyzed: 03/16/2016

Diesel (C10-C28)	ND	50.0	mg/kg							U
------------------	----	------	-------	--	--	--	--	--	--	---

Surrogate: o-Terphenyl

44	"	50.0	87.2	59-131
----	---	------	------	--------

**Blank (B6C1604-BLK2)**

Prepared: 03/16/2016 Analyzed: 03/16/2016

Diesel (C10-C28)	ND	50.0	mg/kg							U
------------------	----	------	-------	--	--	--	--	--	--	---

Surrogate: o-Terphenyl

49	"	50.0	97.2	59-131
----	---	------	------	--------

**LCS (B6C1604-BS1)**

Prepared: 03/16/2016 Analyzed: 03/16/2016

Diesel (C10-C28)	981	50.0	mg/kg	1000	98.1	64-121
------------------	-----	------	-------	------	------	--------

Surrogate: o-Terphenyl

43	"	50.0	86.9	59-131
----	---	------	------	--------

**LCS (B6C1604-BS2)**

Prepared: 03/16/2016 Analyzed: 03/16/2016

Diesel (C10-C28)	1100	50.0	mg/kg	1000	110	64-121
------------------	------	------	-------	------	-----	--------

Surrogate: o-Terphenyl

50	"	50.0	100	59-131
----	---	------	-----	--------

**Matrix Spike (B6C1604-MS1)**

Source: X603208-01

Prepared: 03/16/2016 Analyzed: 03/16/2016

Diesel (C10-C28)	2620	50.0	mg/kg	1000	1830	79.0	53-125
------------------	------	------	-------	------	------	------	--------

Surrogate: o-Terphenyl

69	"	50.0	137	59-131
----	---	------	-----	--------

**Matrix Spike (B6C1604-MS2)**

Source: X603210-01

Prepared: 03/16/2016 Analyzed: 03/16/2016

Diesel (C10-C28)	828	50.0	mg/kg	1000	ND	82.8	53-125
------------------	-----	------	-------	------	----	------	--------

Surrogate: o-Terphenyl

44	"	50.0	87.0	59-131
----	---	------	------	--------

Origins Laboratory, Inc.



The results in this report apply to the samples analyzed in accordance with the chain of custody document. This analytical report must be reproduced in its entirety.

Eagle Environmental Consulting, Inc.

4101 Inca Street

Denver CO 80211

Martin C Eckert III

Project Number: [none]

Project: Noble - Houndskeeper PC H01-21D,  
H01-22

## Extractable Petroleum Hydrocarbons by 8015C - Quality Control

### Origins Laboratory, Inc.

Analyte	Result	Reporting Limit	Units	Spike Level	Source Result	%REC	%REC Limits	RPD	RPD Limit	Notes
---------	--------	-----------------	-------	-------------	---------------	------	-------------	-----	-----------	-------

#### Batch B6C1604 - EPA 3580

<b>Matrix Spike Dup (B6C1604-MSD1)</b>		<b>Source: X603208-01</b>			Prepared: 03/16/2016 Analyzed: 03/16/2016					
Diesel (C10-C28)	2520	50.0	mg/kg	1000	1830	68.5	53-125	4.10	20	
Surrogate: o-Terphenyl	66		"	50.0		132	59-131			
<b>Matrix Spike Dup (B6C1604-MSD2)</b>		<b>Source: X603210-01</b>			Prepared: 03/16/2016 Analyzed: 03/16/2016					
Diesel (C10-C28)	933	50.0	mg/kg	1000	ND	93.3	53-125	12.0	20	
Surrogate: o-Terphenyl	50		"	50.0		101	59-131			

Origins Laboratory, Inc.



The results in this report apply to the samples analyzed in accordance with the chain of custody document. This analytical report must be reproduced in its entirety.

Eagle Environmental Consulting, Inc.

4101 Inca Street

Denver CO 80211

Martin C Eckert III

Project Number: [none]

Project: Noble - Houndskeeper PC H01-21D,  
H01-22

**Classical Chemistry Parameters - Quality Control**  
**Origins Laboratory, Inc.**

Analyte	Result	Reporting Limit	Units	Spike Level	Source Result	%REC	%REC Limits	RPD	RPD Limit	Notes
<b>Batch B6C1605 - NO PREP</b>										
<b>Duplicate (B6C1605-DUP1)</b>		<b>Source: X603210-03</b>			Prepared: 03/16/2016 Analyzed: 03/16/2016					
pH	8.23		pH Units		8.00			2.83	25	
<b>Batch B6C1606 - NO PREP</b>										
<b>Blank (B6C1606-BLK1)</b>		Prepared: 03/16/2016 Analyzed: 03/16/2016								
Specific Conductance (EC)	0.00360		mmhos/cm							
<b>Duplicate (B6C1606-DUP1)</b>		<b>Source: X603210-03</b>			Prepared: 03/16/2016 Analyzed: 03/16/2016					
Specific Conductance (EC)	0.0225		mmhos/cm		0.0191			16.3	25	

Origins Laboratory, Inc.



*The results in this report apply to the samples analyzed in accordance with the chain of custody document. This analytical report must be reproduced in its entirety.*

Eagle Environmental Consulting, Inc.

4101 Inca Street

Denver CO 80211

Martin C Eckert III

Project Number: [none]

Project: Noble - Houndskeeper PC H01-21D,  
H01-22

### Notes and Definitions

U Sample is Non-Detect.

ND Analyte NOT DETECTED at or above the reporting limit

RPD Relative Percent Difference

All soil results are reported at a wet weight basis.

Origins Laboratory, Inc.



*The results in this report apply to the samples analyzed in accordance with the chain of custody document. This analytical report must be reproduced in its entirety.*

Jen Pellegrini For Noelle Doyle Mathis, President