

T6S

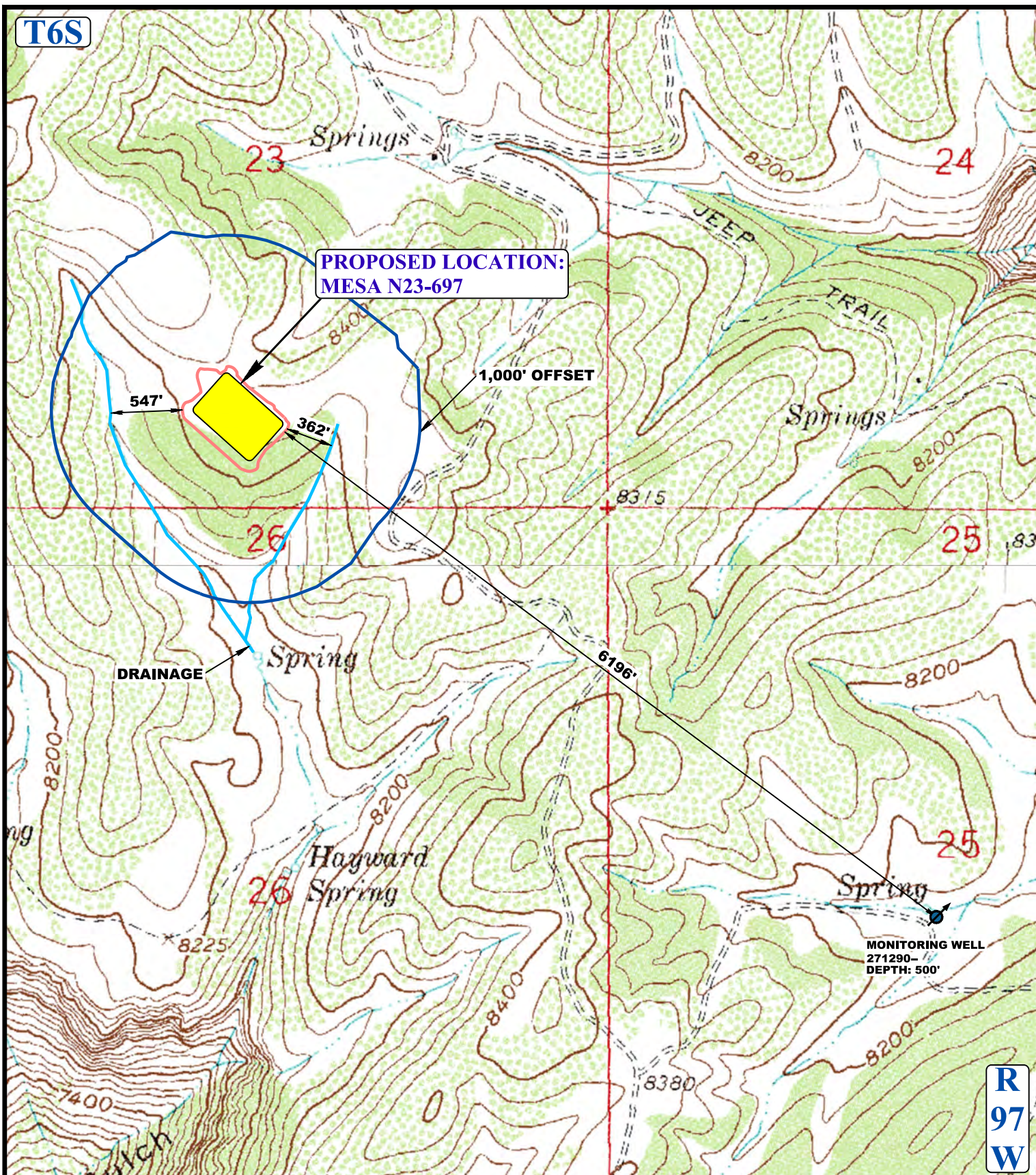

LEGEND:

- EXISTING DRAINAGE
- 1000' OFFSET BOUNDARY
- EDGE OF DISTURBANCE



UELS, LLC
Corporate Office * 85 South 200 East
Vernal, UT 84078 * (435) 789-1017



Caerus Oil & Gas LLC

MESA N23-697
SE 1/4 SW 1/4, SECTION 23, T6S, R97W, 6th P.M.
GARFIELD COUNTY, COLORADO

SURVEYED BY	B.H., C.R.	09-06-16	SCALE
DRAWN BY	C.D.L.	09-07-16	1 : 12,000
HYDROLOGY MAP			TOPO W