



Lat40°, Inc. 6250 W. 10th Street, Unit 2, Greeley, CO 970-515-5294

# PROPOSED SCALED FACILITY DRAWING

POPHAM 4N64W3Q PAD

SECTION: 3  
TOWNSHIP: 4N  
RANGE: 64W  
6TH. P.M.  
WELD COUNTY, CO

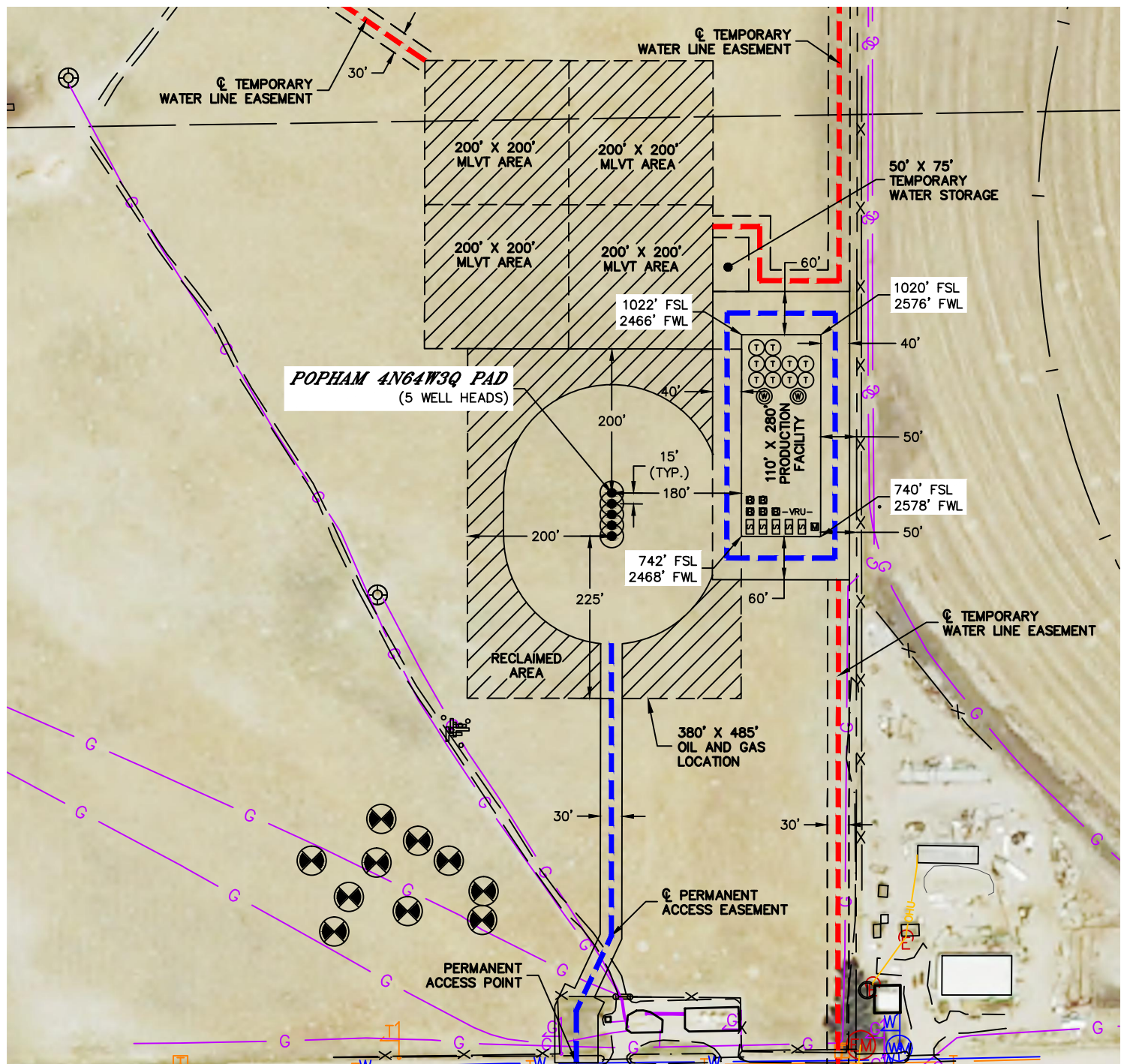

## LEGEND

- PROPOSED WELL HEAD
- T TANK BATTERY
- W WATER TANK
- W WATER VAULT
- S SEPARATOR
- ECD ECD
- M METER
- VRU- VAPOR RECOVERY UNIT

**TOTAL DISTURBED AREA OF LOCATION: ±13.6 ACRES**  
**TOTAL SIZE OF LOCATION AFTER RECLAMATION: ±4.2 ACRES**

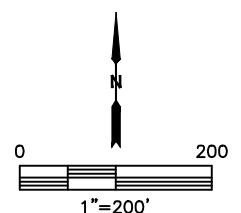

DATE: 8/23/2016  
PROJECT#: 2015075