

SandRidge Exploration & Production, LLC

CONSTRUCTION LAYOUT
 RABBIT EARS 0681 S23 PAD
 SW1/4NE1/4 of SECTION 23,
 T6N, R81W, 6th P.M.

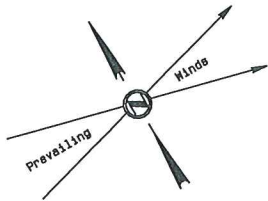

Existing
 Access Road
 (12' Wide)
 (to be widened
 to 22')

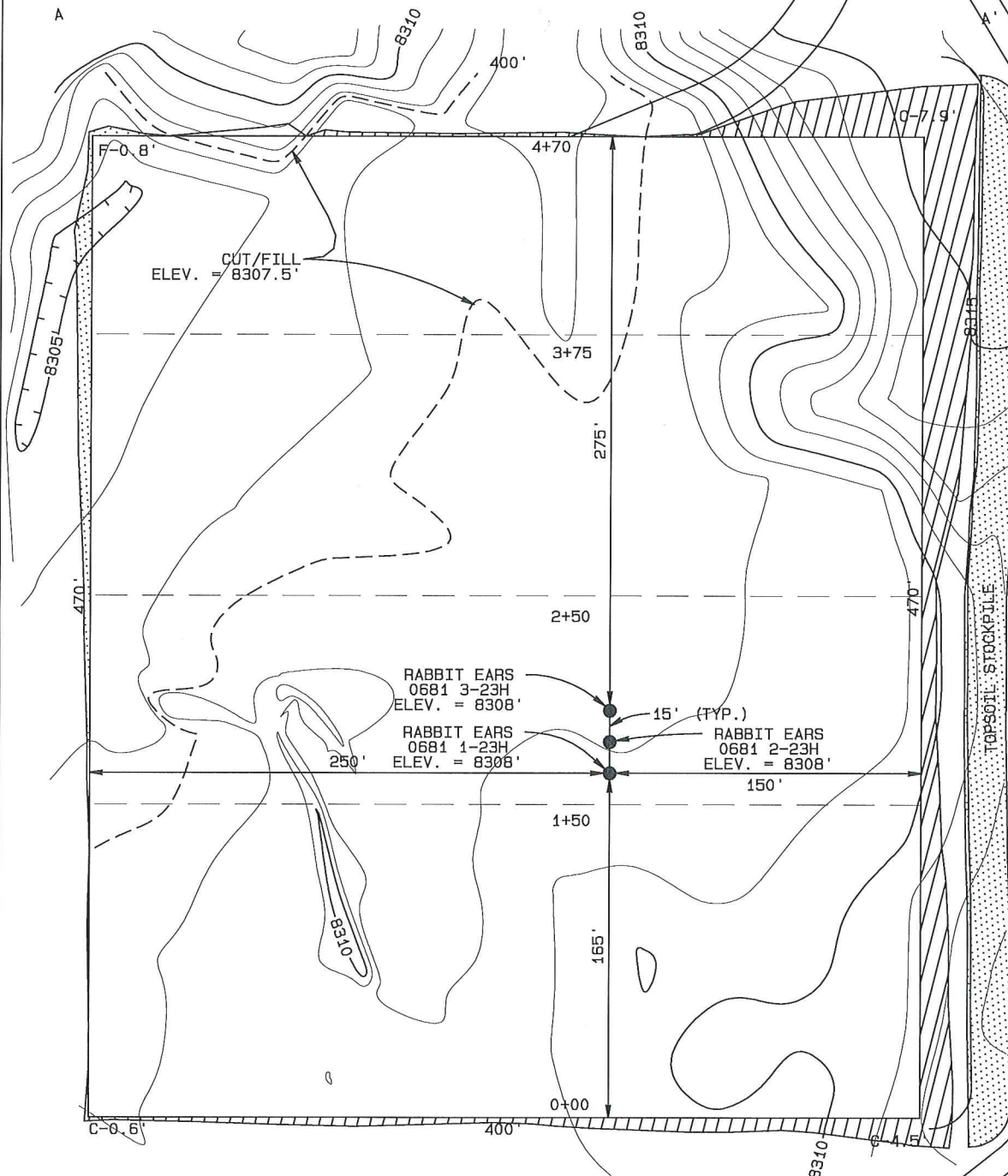

Final Pad Elevation = 8307.5'
 Elev. for Surface Locations
 are at Ungraded Ground

Earthwork:
 Total Excavation - 7700 Cu. Yd.
 Pad Fill/Borrow - 1460 Cu. Yd.
 Topsoil Stockpile - 6240 Cu. Yd.
 Total Pad = 4.59 acres



New Gravel Pit
 Access Road
 (12' Wide)

BASIS OF ELEVATION

SPOT ELEVATION AT THE NW CORNER OF SECTION 23,
 T6N, R81W, 6TH PM, TAKEN FROM THE SPICER PEAK
 QUADRANGLE, USGS 7.5 MIN QUAD (TOPOGRAPHIC MAP)
 WITH SAID ELEVATION MARKED AS BEING 8313 FEET.

GRAPHIC SCALE 1"=60'

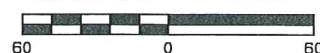

NORTH PARK ENGINEERING & CONSULTING, INC.
 PO Box 395 Malden, CO 80480 970-723-3725

SandRidge Exploration & Production, LLC

CONSTRUCTION LAYOUT CROSS SECTION
RABBIT EARS 0681 S23 PAD
SW1/4NE1/4 of SECTION 23,
T6N, R81W, 6th P.M.

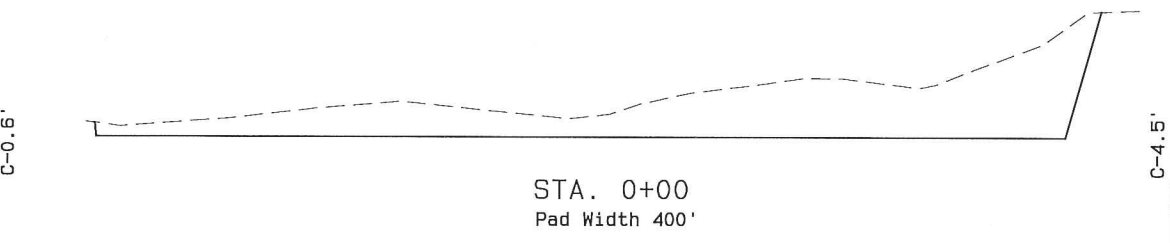
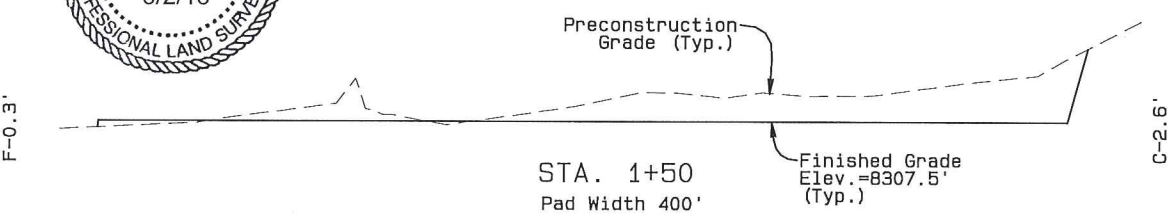
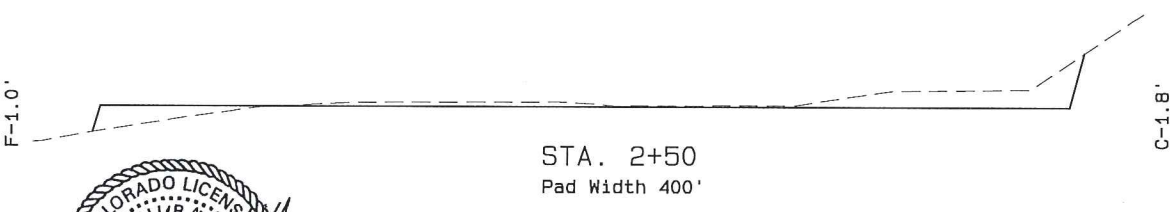
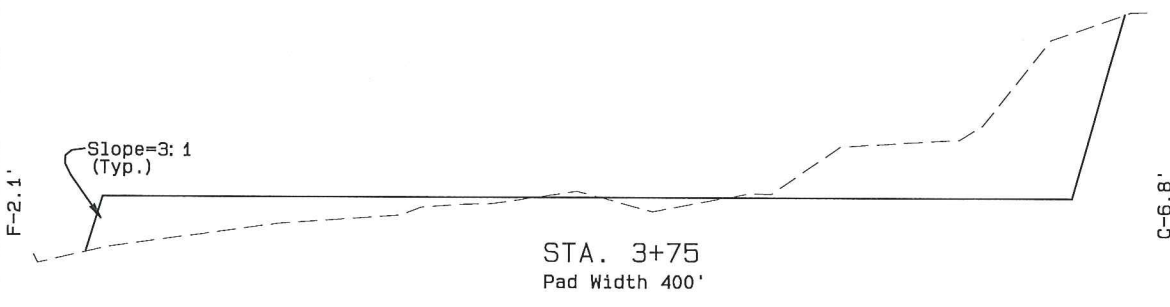
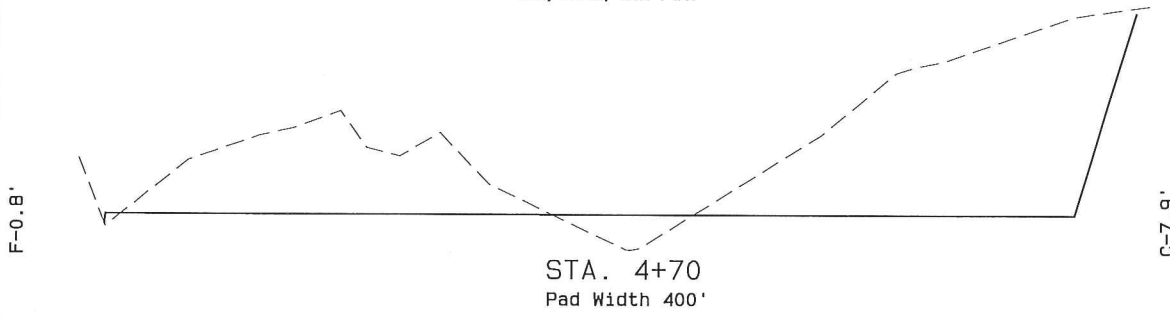

BASIS OF ELEVATION

SPOT ELEVATION AT THE NW CORNER OF SECTION 23,
T6N, R81W, 6TH PM, TAKEN FROM THE SPICER PEAK
QUADRANGLE, USGS 7.5 MIN QUAD (TOPOGRAPHIC MAP)
WITH SAID ELEVATION MARKED AS BEING 8313 FEET.

Vertical Exaggeration = 10 Times
GRAPHIC SCALE 1"=60'

