

K:\SYNERGY RESOURCES\2016\_45\_KAWATA\_FARMS\_T4N\_R66W\_SEC\_16\GIS\Maps\_ABC\Kawata 21-16 Hydro.mxd 6/30/2016 1:16:45 AM

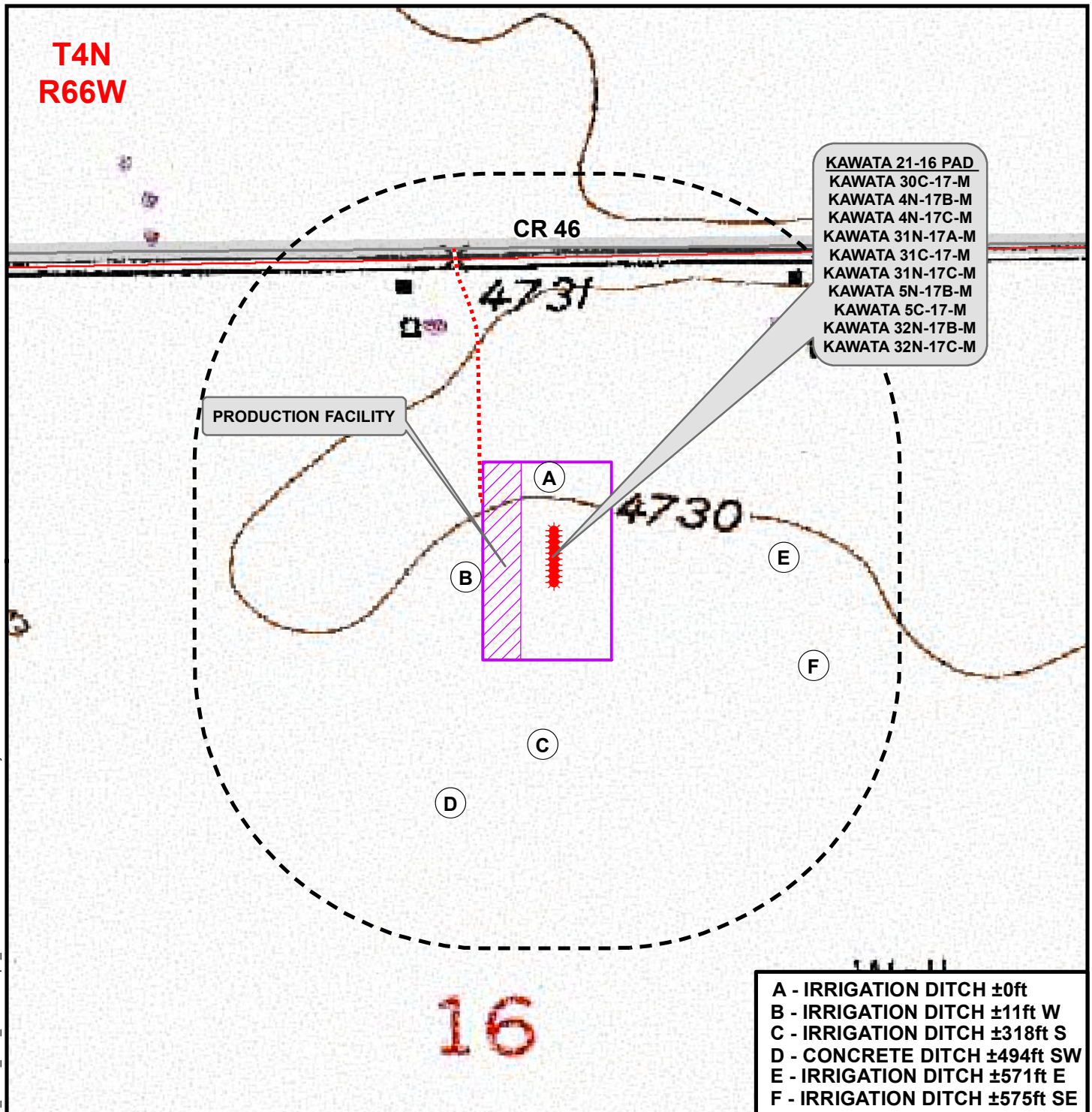

### Legend

- Well - Fee - Proposed
- Access Road
- Disturbance Area
- Production Facility
- 1,000ft Disturbance Buffer

- Road - Primitive - Existing
- Road - Improved - Existing
- Road - County - Existing
- Road - Highway - Existing

\* All distances measured from edge of Disturbance.

### PAD - KAWATA 21-16

**HYDROLOGY MAP**  
KAWATA 30C-17-M, KAWATA 4N-17B-M,  
KAWATA 4N-17C-M, KAWATA 31N-17A-M,  
KAWATA 31C-17-M, KAWATA 31N-17C-M,  
KAWATA 5N-17B-M, KAWATA 5C-17-M,  
KAWATA 32N-17B-M & KAWATA 32N-17C-M  
LOCATED IN SECTION 16, T4N, R66W, 6th P.M.  
WELD COUNTY, COLORADO



**1625 Broadway, Suite 300**  
**Denver, Colorado 80202**



### CONSULTING, LLC

**SHERIDAN OFFICE**  
1095 Saberton Avenue  
Sheridan, Wyoming 82801  
Phone 307-674-0609

**LOVELAND OFFICE**  
1635 Foxtail Drive, Suite 204  
Loveland, Colorado 80538  
Phone 970-776-4331

**SCALE:** 1" = 500ft

**DRAWN:** DP

**REVISED:**

**NAD83 CO-Nft**

**DATE:** 24 Jun 2016

**DATE:**