

LEGEND:

 PROPOSED LOCATION



ConocoPhillips Company

STATE LA PLATA #5-65 13-17 4DH, 4CH,
 STATE LA PLATA #5-65 13-15 4DH, 4CH, 4BH, 4AH & 3DH
 E 1/2 SW 1/4, SECTION 13, T5S, R65W, 6th P.M.
 ARAPAHOE COUNTY, COLORADO

SURVEYED BY	DATE	REVISED BY	DATE
D.N., C.M.	02-10-16		
DRAWN BY	DATE		
J.M.C.	03-17-16		
SCALE	1 : 100,000		

ACCESS ROAD MAP

TOPO A



UELS, LLC
 Corporate Office * 85 South 200 East
 Vernal, UT 84078 * (435) 789-1017

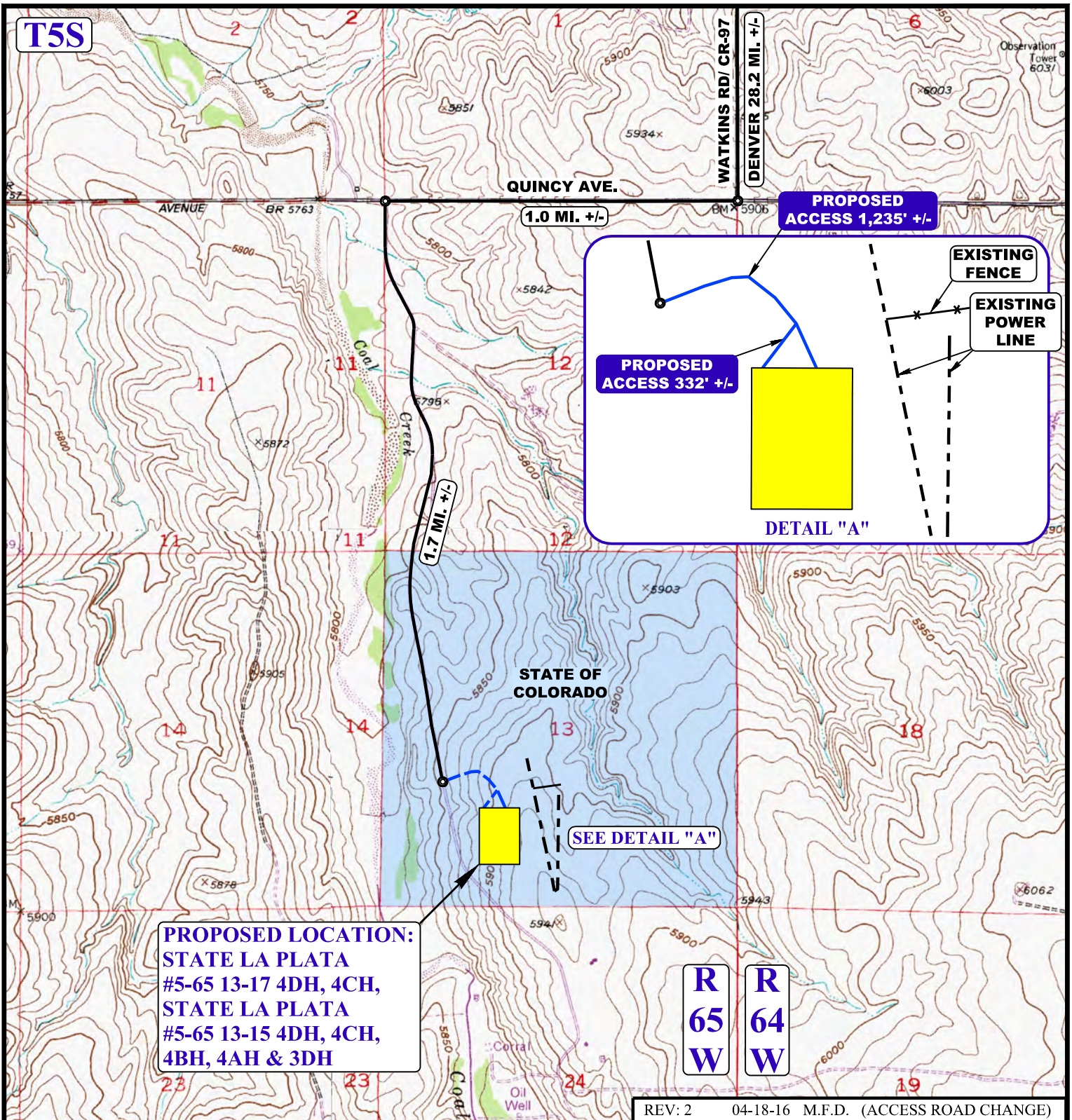

PROPOSED LOCATION:
 STATE LA PLATA
 #5-65 13-17 4DH, 4CH,
 STATE LA PLATA
 #5-65 13-15 4DH, 4CH,
 4BH, 4AH & 3DH

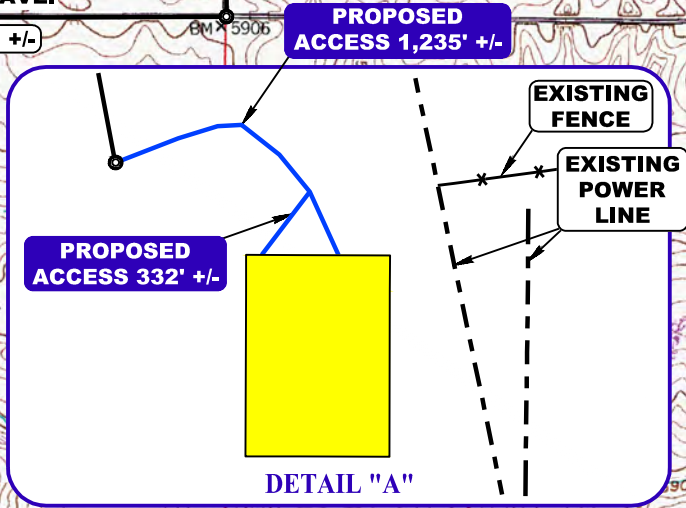

NOTE: PARCEL DATA SHOWN HAS BEEN OBTAINED FROM VARIOUS SOURCES AND SHOULD BE USED FOR MAPPING, GRAPHIC AND PLANNING PURPOSES ONLY. NO WARRANTY IS MADE BY UINTAH ENGINEERING AND LAND SURVEYING (UELS) FOR ACCURACY OF THE PARCEL DATA.

LEGEND:
 ——— EXISTING ROAD
 - - - - - PROPOSED ROAD

ConocoPhillips Company

STATE LA PLATA #5-65 13-17 4DH, 4CH,
 STATE LA PLATA #5-65 13-15 4DH, 4CH, 4BH, 4AH & 3DH
 E 1/2 SW 1/4, SECTION 13, T5S, R65W, 6th P.M.
 ARAPAHOE COUNTY, COLORADO

SURVEYED BY	DATE		
D.N., C.M.	02-10-16		
DRAWN BY	DATE		
J.M.C.	03-17-16		
SCALE	1 : 24,000		

ACCESS ROAD MAP **TOPO B**



UELS, LLC
 Corporate Office * 85 South 200 East
 Vernal, UT 84078 * (435) 789-1017

