



PRINT PAGE

COGCC GIS OnLine

Load Map Save Map Add / Remove Map Layers Print Layer Info Help

- MISSION
- KIDS' PAGE
- GENERAL
- CONTACTS
- LIBRARY
- HEARINGS
- RULES
- POLICIES
- ORDERS
- FORMS
- STAFF RPT
- PERMITS
- NEWS/MEDIA
- DATABASE
- LOCAL GOV
- STATISTICS
- TOOLS
- IMAGES
- MAPS
- HELP

- COUNTY BOUNDARIES
- SPECIAL USE LAND
 - Wilderness Area
 - Wilderness Study
 - National Monument
 - National Conservation
- LAND OWNERSHIP
 - LandManager
 - Federal Land
 - State Land
 - Indian Land
- SOILS_NRCS
- GEOLOGY 1:500K
- GEOLOGY 1:250K
- INDEX_TOPO24K
- SECTION-TOWNSHIP
- TOPO24K (1:24K)
 - NW Colorado T
 - NE Colorado T
 - SE Colorado T
 - SW Colorado T
- Base_KLF
- SUIT_SURFACE_0
- SUIT_MNRLS_041
- BLMPLATS
- AERIALS 1989-200
- AERIALS 2005
- AERIALS2009

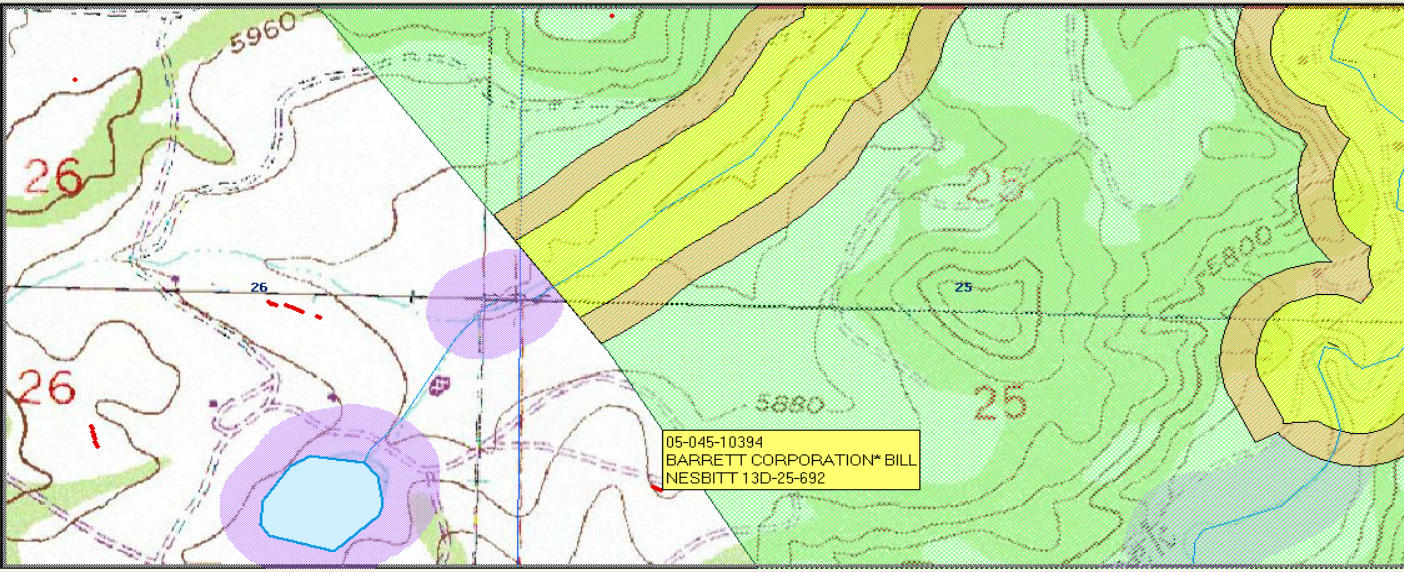

autodesk

Oil and Gas Wells : 05-045-10394-BARRETT CORPORATION* BILL-NESBITT 13D-25-692 0 feature(s) selected 1 : 8,000 7,833 x 3,493 (ft)

Select by Radius Selection Results Create Redline Edit Redline Delete Redline

Spill 1631841
Location ID 335387
API 045-10392
Document 2526690