



July 21, 2016

Mr. Matt Lepore, Director
Colorado Oil and Gas Conservation Commission
1120 Lincoln Street, Suite 801
Denver, Colorado 80203

**RE: COGCC Rule 318A.e.: Proposed Spacing Unit
Thornton L-29-30HN Well: SWNW Section 28, Township 7 North, Range 66 West
Weld County, Colorado**

Dear Mr. Lepore:

Bayswater Exploration & Production, LLC (Bayswater) is planning to drill the above referenced well in accordance with the provisions set out in Colorado Oil and Gas Conservation Commission (COGCC) Rule 318A.e. Bayswater's Proposed Spacing Unit consists of:

S½N½ & N½S½ of Section 29 & 30, Township 7 North, Range 66 West
Containing 640.00 acres, more or less

Bayswater is not the only owner within the Proposed Spacing Unit and has provided notice to the remaining owners, as required by COGCC Rule 318A.e.(6). Copies of the required notification letters are on file at Bayswater's office. The required thirty (30) day notice period has elapsed absent the receipt by Bayswater of any objection to their proposal by the owners within the Proposed Spacing Unit for the subject well.

Enclosed is the Proposed Spacing Unit Exhibit to assist in your review and approval of Bayswater's proposed Application for Permit to Drill for the Thornton L-29-30HN Well. Many thanks for your attention to this matter.

Respectfully,

A handwritten signature in blue ink, appearing to read 'Jeff Annable', written in a cursive style.

Jeff Annable
Regulatory Analyst
Agent for Bayswater Exploration & Production, LLC

:ja

Enclosure: Proposed Spacing Unit Exhibit

THORNTON 28-H PAD
PROPOSED 318A.e. SPACING UNIT
SEC. 29 & 30: S2N2 & N2S2

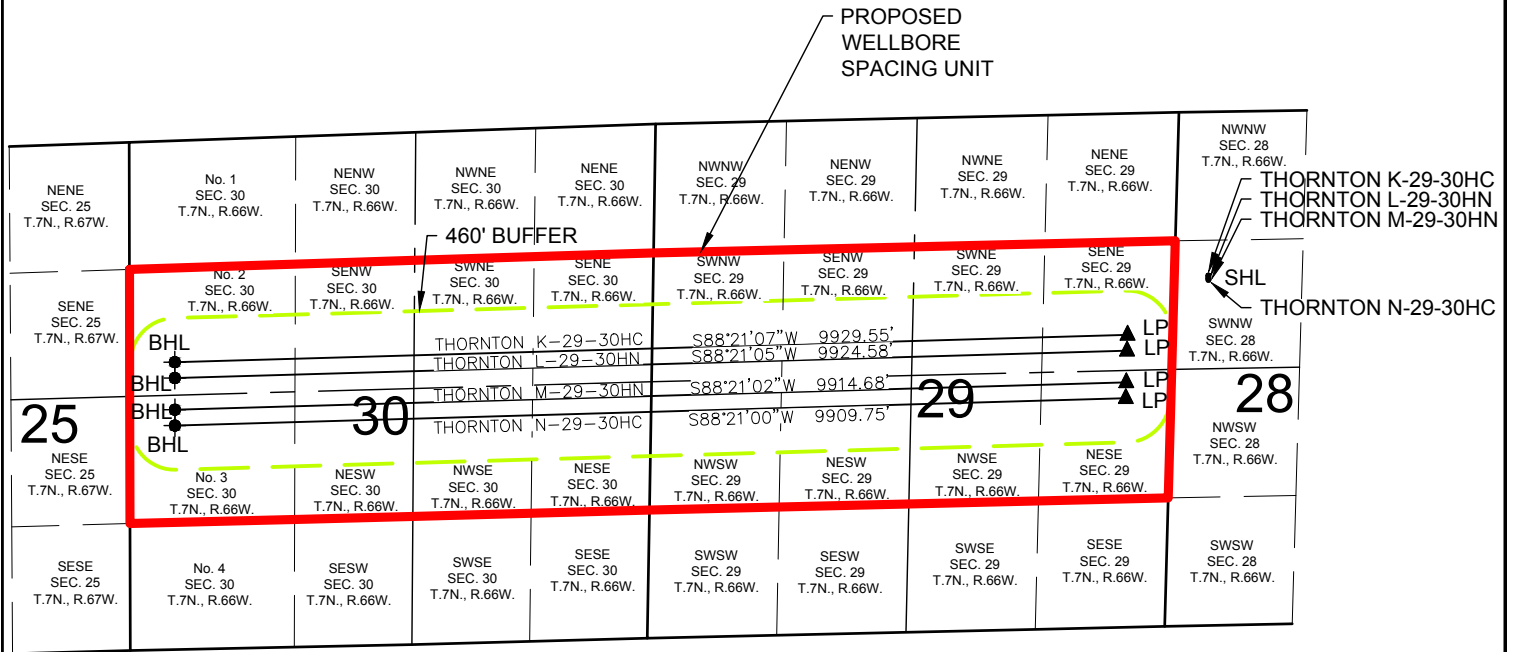

WELL **THORNTON K-29-30HC** TO BE LOCATED 1704' FNL AND 355' FWL, SEC. 28, T7N, R66W
WELL **THORNTON L-29-30HN** TO BE LOCATED 1719' FNL AND 355' FWL, SEC. 28, T7N, R66W
WELL **THORNTON M-29-30HN** TO BE LOCATED 1734' FNL AND 355' FWL, SEC. 28, T7N, R66W
WELL **THORNTON N-29-30HC** TO BE LOCATED 1749' FNL AND 355' FWL, SEC. 28, T7N, R66W

LEGEND

- = PROPOSED WELL
- = BOTTOM HOLE
- ▲ = LANDING POINT
- SHL = SURFACE HOLE
- LP = LANDING POINT
- BHL = BOTTOM HOLE

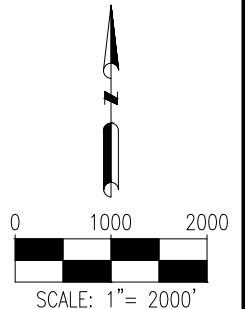

PREPARED BY:



FIELD DATE:

01-06-16

DRAWING DATE:

01-20-16

BY:

KAD

CHECKED BY:

TJN

SITE NAME:

THORNTON 28-H PAD

SURFACE LOCATION:

SW 1/4 NW 1/4 SEC. 28, T7N, R66W, 6TH P.M.
WELD COUNTY, COLORADO

PREPARED FOR:

