

**LEGEND:**

 PROPOSED LOCATION



**UELS, LLC**  
Corporate Office \* 85 South 200 East  
Vernal, UT 84078 \* (435) 789-1017



**Caerus Oil & Gas LLC**

**MESA C23-697**  
NW 1/4 NE 1/4, SECTION 23, T6S, R97W, 6th P.M.  
GARFIELD COUNTY, COLORADO

SURVEYED BY	B.B., J.L.	06-07-16	SCALE
DRAWN BY	C.D.L.	06-09-16	1 : 100,000
<b>ACCESS ROAD MAP</b>			<b>TOPO A</b>



T6S

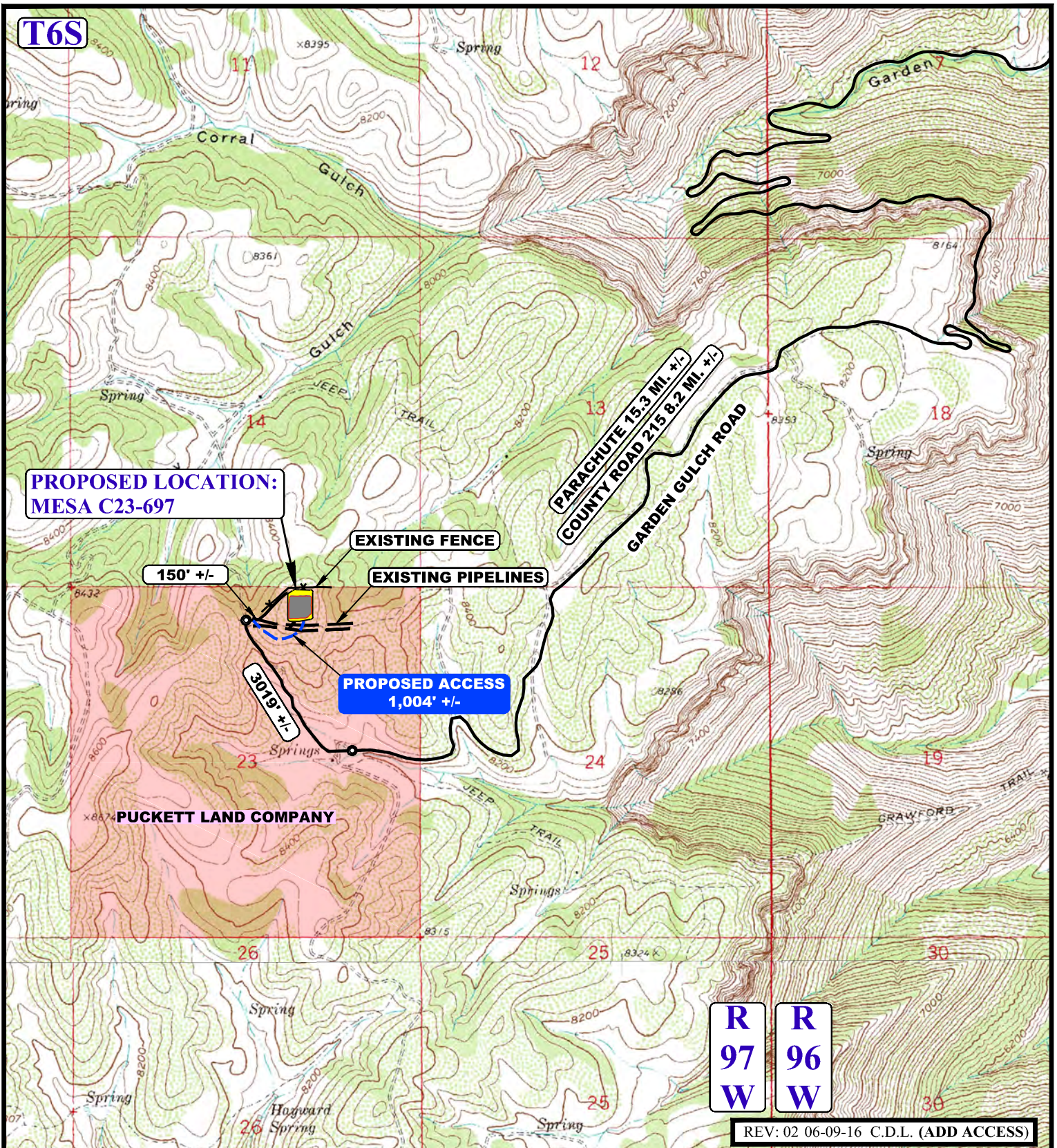

R  
97  
W

R  
96  
W

REV: 02 06-09-16 C.D.L. (ADD ACCESS)

NOTE: PARCEL DATA SHOWN HAS BEEN OBTAINED FROM VARIOUS SOURCES AND SHOULD BE USED FOR MAPPING, GRAPHIC AND PLANNING PURPOSES ONLY. NO WARRANTY IS MADE BY UTAH ENGINEERING AND LAND SURVEYING (UELS) FOR ACCURACY OF THE PARCEL DATA.

**LEGEND:**

- EXISTING ROAD
- PROPOSED ROAD
- EXISTING FENCE



**Caerus Oil & Gas LLC**

**MESA C23-697**  
**NW 1/4 NE 1/4, SECTION 23, T6S, R97W, 6th P.M.**  
**GARFIELD COUNTY, COLORADO**

SURVEYED BY	B.B., J.L.	06-07-16	SCALE
DRAWN BY	S.S.	05-16-16	1 : 24,000
ACCESS ROAD MAP			TOPO B



**UELS, LLC**  
Corporate Office \* 85 South 200 East  
Vernal, UT 84078 \* (435) 789-1017