

Project: Wattenberg Field
Site: A (Sec.13-T06N-R63W) Weld County, CO
Well: Lapp A15-625
Wellbore: Original Drilling
Design: APD - Rev 2

Northern Region Drilling - Working

Geodetic System: US State Plane 1983
Datum: North American Datum 1983
Ellipsoid: GRS 1980
Zone: Colorado Northern Zone
System Datum: Mean Sea Level

SECTION DETAILS

Sec	MD	Inc	Azi	TVD	+N/-S	+E/-W	Dleg	TFace	VSec	Target
1	0.0	0.00	0.00	0.0	0.0	0.0	0.00	0.00	0.0	
2	2500.0	0.00	0.00	2500.0	0.0	0.0	0.00	0.00	0.0	
3	2900.6	8.01	63.43	2899.3	12.5	25.0	2.00	63.43	-25.1	
4	4103.8	8.01	63.43	4090.7	87.5	175.0	0.00	0.00	-175.3	
5	4504.4	0.00	0.00	4490.0	100.0	200.0	2.00	180.00	-200.4	
6	6151.7	0.00	0.00	6137.4	100.0	200.0	0.00	0.00	-200.4	
7	7151.7	90.00	269.24	6774.0	91.5	-436.6	9.00	269.24	436.2	
8	17117.6	90.00	269.24	6774.0	-41.5	-10401.6	0.00	0.00	10401.6	Lapp A15-625 BHL 1000'FSL, 535'FWL

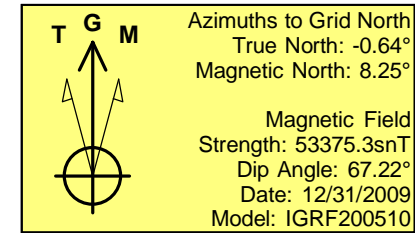
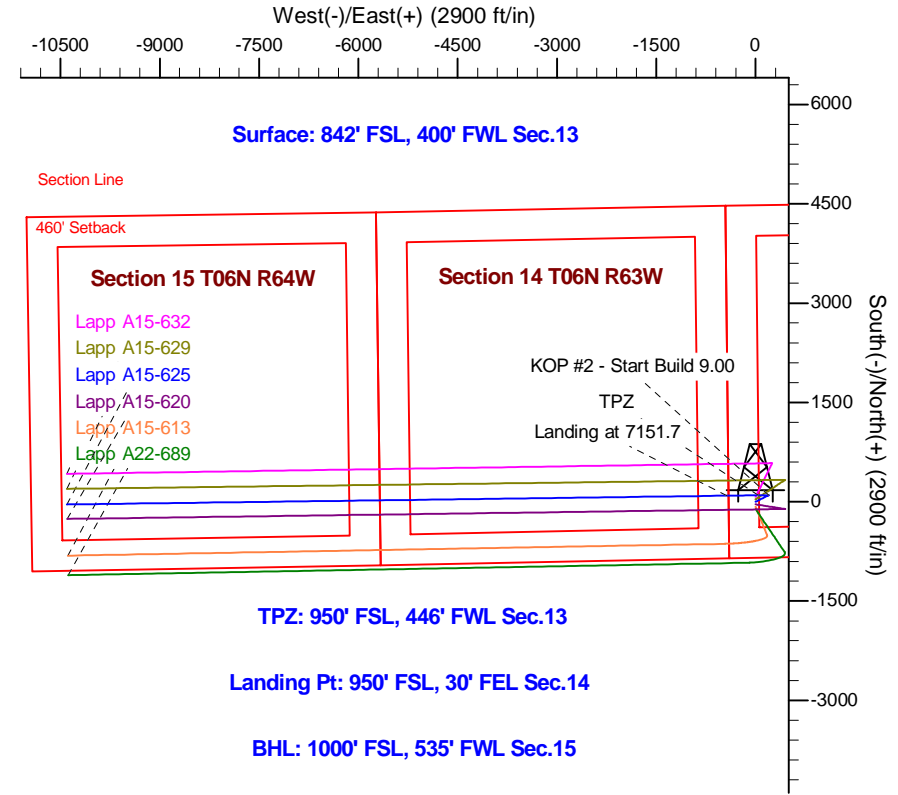
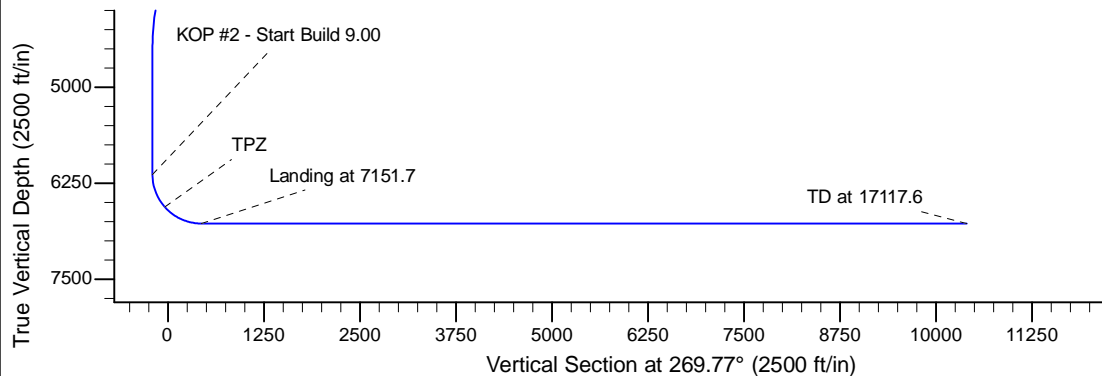
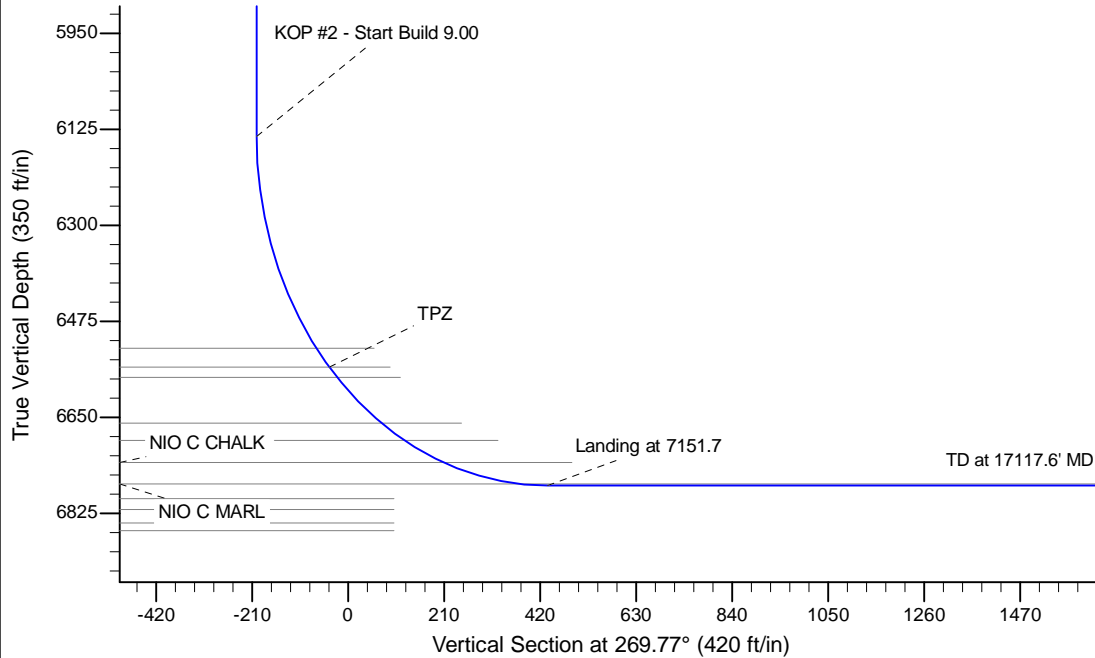

WELL DETAILS: Lapp A15-625				
Ground Level: 4664.0				
0.0	0.0	Northing	Easting	Latitude
1419708.30	3276393.23	40.481250	-104.506390	
Plan: APD - Rev 2 (Lapp A15-625/Original Drilling)				
Created By: Shailey Jewell		Date: 10:02, May 25 2016		
Checked: _____		Date: _____		
Reviewed: _____		Date: _____		
Approved: _____		Date: _____		