

PROCEED IN AN EASTERLY, THEN SOUTHEASTERLY DIRECTION FROM GREELEY, COLORADO ALONG U.S. HIGHWAY 34 APPROXIMATELY 19.7 MILES TO THE BEGINNING OF THE PROPOSED ACCESS ROAD FOR THE ANSCHUTZ EQUUS FARMS 4-62-20\_21 NWNW PAD TO THE SOUTH; FOLLOW ROAD FLAGS IN A SOUTHERLY, THEN WESTERLY, THEN NORTHERLY DIRECTION APPROXIMATELY 4,701' TO THE BEGINNING OF THE PROPOSED ACCESS ROAD TO THE EAST; FOLLOW ROAD FLAGS IN AN EASTERLY DIRECTION APPROXIMATELY 50' TO THE PROPOSED LOCATION.

TOTAL DISTANCE FROM GREELEY, COLORADO TO THE PROPOSED LOCATION IS APPROXIMATELY 20.6 MILES.

REV: 3 06-27-16 M.F.D. (ROAD CHANGE)

### BILL BARRETT CORPORATION

ANSCHUTZ EQUUS FARMS 4-62-20 21 SWNW PAD  
#4-62-20-3225B2, 3225C2, 1724B2, 1724D2 & 1724C2  
SW 1/4 NW 1/4, SECTION 20, T4N, R62W, 6th P.M.  
WELD COUNTY, COLORADO



UELS, LLC  
Corporate Office \* 85 South 200 East  
Vernal, UT 84078 \* (435) 789-1017

DRAWN BY: J.L.G.

DATE DRAWN: 10-20-14

**ROAD DESCRIPTION**

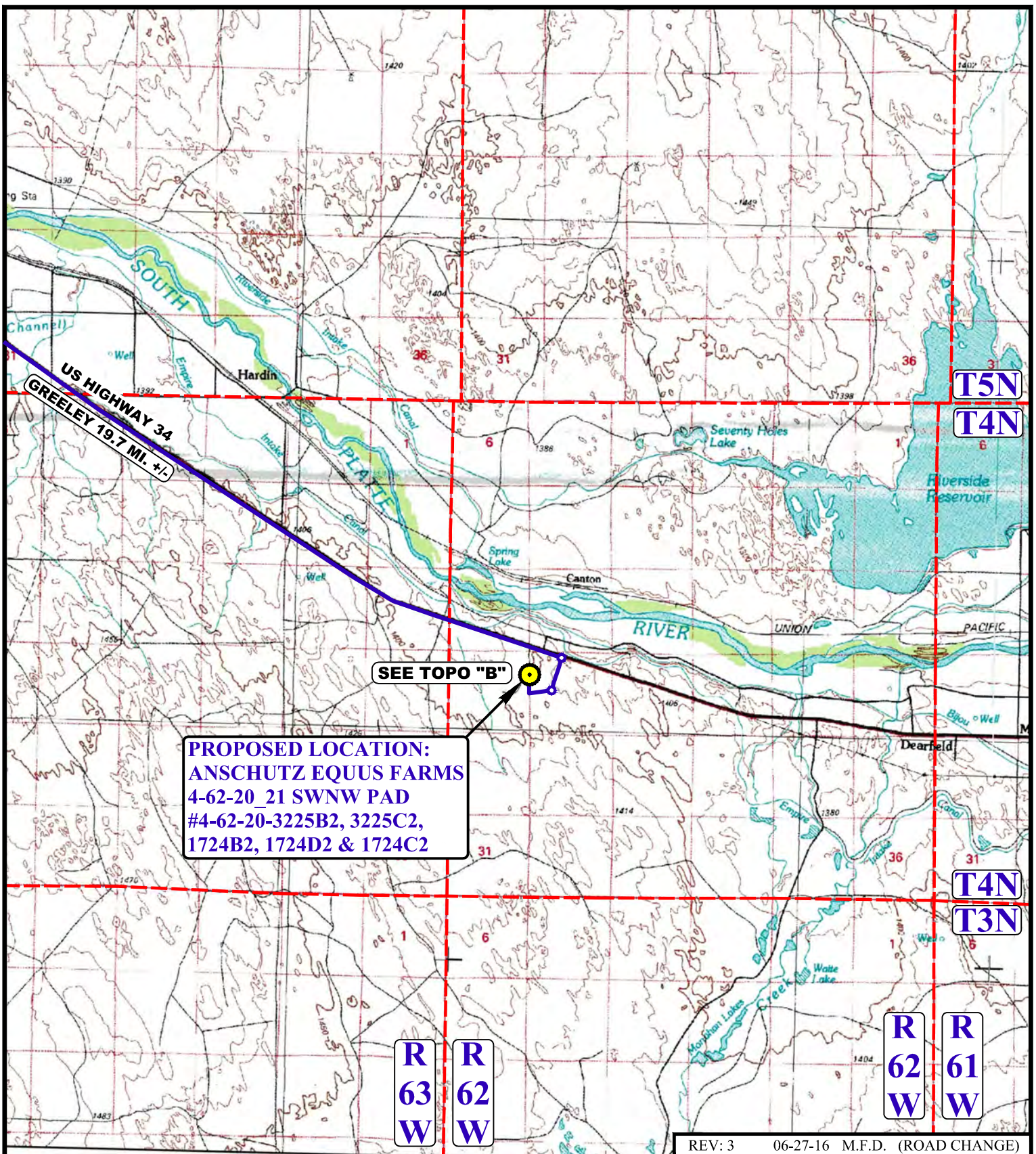

SEE TOPO "B"

**PROPOSED LOCATION:**  
**ANSCHUTZ EQUUS FARMS**  
**4-62-20\_21 SWNW PAD**  
**#4-62-20-3225B2, 3225C2,**  
**1724B2, 1724D2 & 1724C2**

**R**  
**63**  
**W**

**R**  
**62**  
**W**

**R**  
**62**  
**W**

**R**  
**61**  
**W**

REV: 3 06-27-16 M.F.D. (ROAD CHANGE)

**LEGEND:**

 PROPOSED LOCATION



**BILL BARRETT CORPORATION**

**ANSCHUTZ EQUUS FARMS 4-62-20\_21 SWNW PAD**  
**#4-62-20-3225B2, 3225C2, 1724B2, 1724D2 & 1724C2**  
**SW 1/4 NW 1/4, SECTION 20, T4N, R62W, 6th P.M.**  
**WELD COUNTY, COLORADO**

DRAWN BY: J.L.G.

DATE DRAWN: 10-20-14

SCALE: 1:100,000

**ACCESS ROAD MAP**

**TOPO A**



**UELS, LLC**  
 Corporate Office \* 85 South 200 East  
 Vernal, UT 84078 \* (435) 789-1017



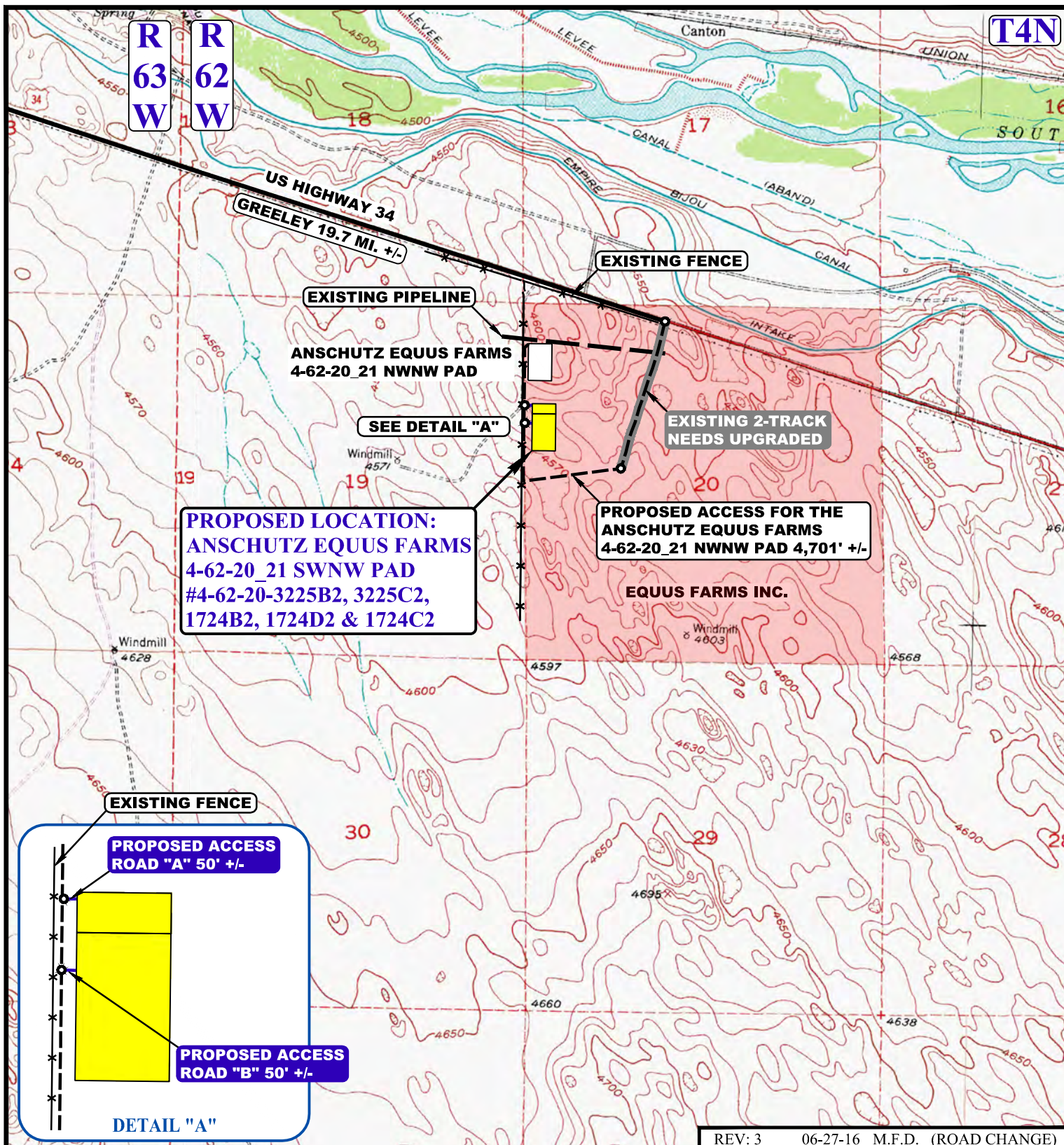

REV: 3 06-27-16 M.F.D. (ROAD CHANGE)

NOTE: PARCEL DATA SHOWN HAS BEEN OBTAINED FROM VARIOUS SOURCES AND SHOULD BE USED FOR MAPPING, GRAPHIC AND PLANNING PURPOSES ONLY. NO WARRANTY IS MADE BY UINTAH ENGINEERING AND LAND SURVEYING (UELS) FOR ACCURACY OF THE PARCEL DATA.

#### LEGEND:

	EXISTING ROAD		EXISTING 2-TRACK
	PROPOSED ROAD		EXISTING CATTLE GUARD
	EXISTING FENCE		
	EXISTING PIPELINE		
	PROPOSED ROAD (SERVICING OTHER WELLS)		

#### BILL BARRETT CORPORATION

**ANSCHUTZ EQUUS FARMS 4-62-20 21 SWNW PAD**  
**#4-62-20-3225B2, 3225C2, 1724B2, 1724D2 & 1724C2**  
**SW 1/4 NW 1/4, SECTION 20, T4N, R62W, 6th P.M.**  
**WELD COUNTY, COLORADO**

DRAWN BY: J.L.G.

DATE DRAWN: 10-20-14

SCALE: 1"=2000'

**ACCESS ROAD MAP**

**TOPO B**



**UELS, LLC**  
Corporate Office \* 85 South 200 East  
Vernal, UT 84078 \* (435) 789-1017