

WARD 20-M PAD HYDROLOGY MAP

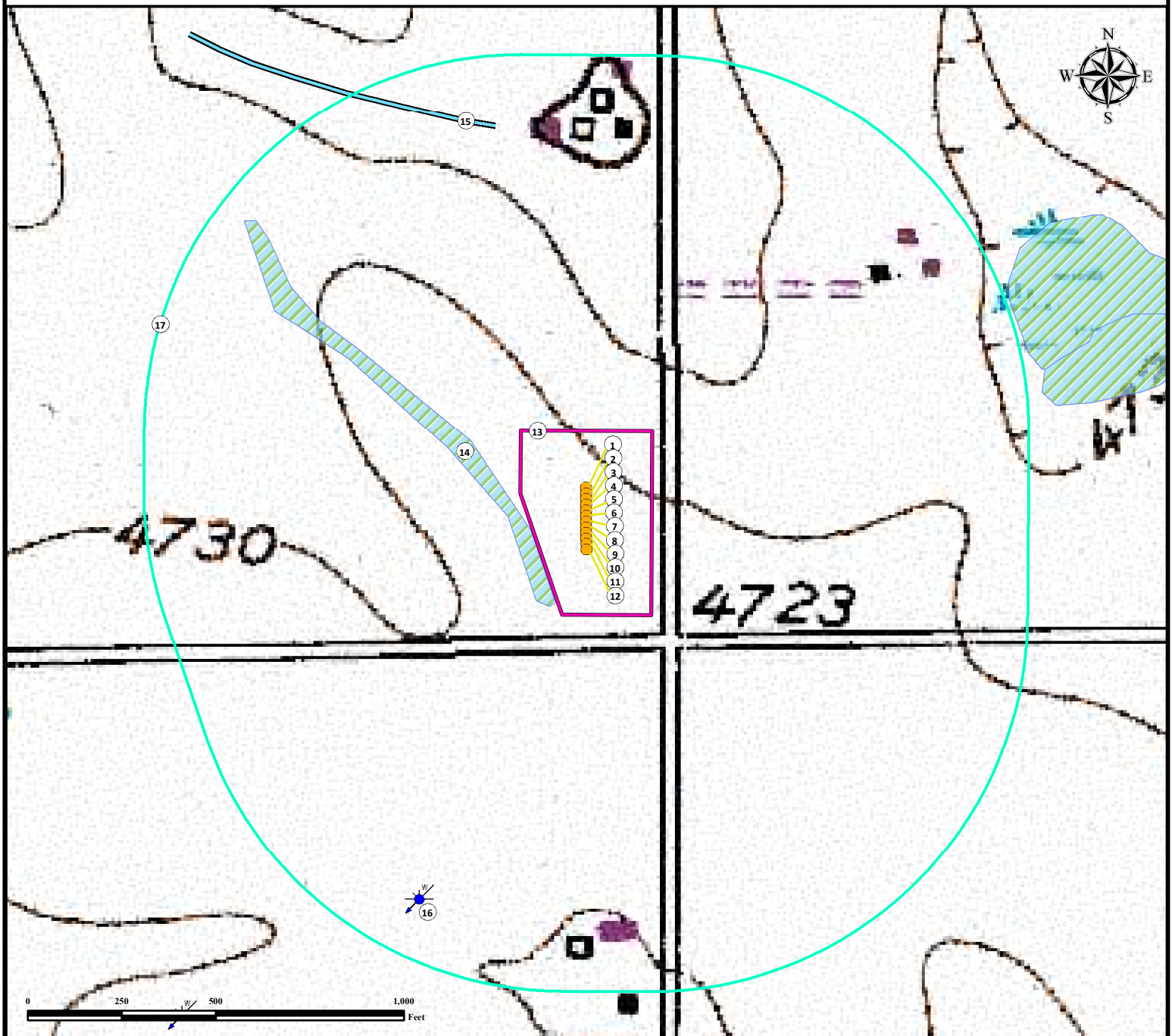

Measurements are made from the nearest edge of the disturbance area.

1. Proposed Well WARD M-20-19HN.
2. Proposed Well WARD N-20-19HC.
3. Proposed Well WARD O-20-19HN.
4. Proposed Well WARD P-20-19HN.
5. Proposed Well WARD Q-20-19HC.
6. Proposed Well WARD R-20-19HN.
7. Proposed Well WARD S-20-19HN.
8. Proposed Well WARD T-20-19HC.
9. Proposed Well WARD U-20-19HN.
10. Proposed Well WARD V-20-19HN.
11. Proposed Well WARD W-20-19HC.
12. Proposed Well WARD X-20-19HN.
13. Operational Disturbance Area.
14. Wetland is $\pm 5'$ SW.
15. Ditch is $\pm 812'$ NW.
16. Water Well (Permit #35) is $\pm 846'$ SW.
17. 1000' Radius.

Legend

- Proposed Well
- Water Well
- Disturbance Area
- 1000' Radius
- Wetland
- Ditch



FIELD DATE:

10-19-15

DRAWING DATE:

11-04-15

BY:

CSG

CHECKED BY:

KAD

SITE NAME:

WARD 20-M PAD

SURFACE LOCATION:

SE1/4 SE1/4 SEC. 20, T6N, R66W, 6TH P.M.

WELD COUNTY, COLORADO

PREPARED FOR:



BAYSWATER
EXPLORATION AND PRODUCTION, LLC