

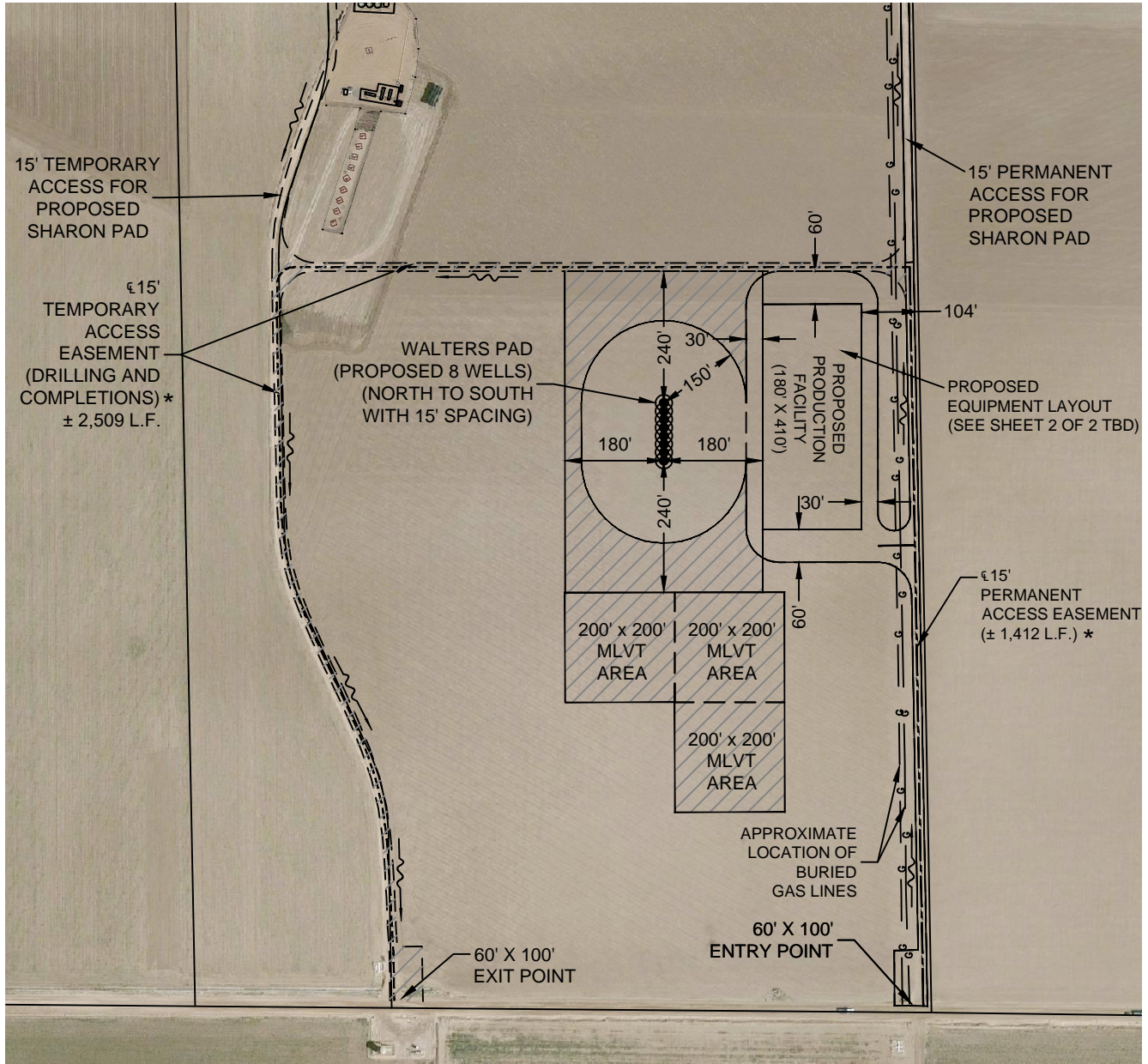

Washburn Land Surveying
www.WashburnSurveying.com
970-232-9645

SCALED FACILITY WALTERS 4N67W21P PAD

SECTION: 21
TOWNSHIP: 4N
RANGE: 67W
6TH P.M.
WELD COUNTY, CO



TOTAL DISTURBED AREA OF LOCATION: ± 11.8 ACRES
TOTAL SIZE OF LOCATION AFTER RECLAMATION: ± 5.9 ACRES

RECLAIMED AREA(S)

APPROXIMATE $\frac{1}{2}$ PERMANENT ACCESS EASEMENT
 APPROXIMATE $\frac{1}{2}$ TEMPORARY ACCESS EASEMENT

NOTES:

- * - ACCESSES WITHIN THE EASEMENTS ARE TO BE CONSTRUCTED AND/OR IMPROVED TO BE 15' WIDE.
- ONE-WAY TRAFFIC FLOW FOR DRILLING AND COMPLETIONS.
- WATER SOURCE TO MLVT AREA NOT YET DETERMINED.
- ADDITIONAL TEMPORARY ABOVE GROUND FRAC WATER LINE MAY BE REQUIRED ON PROPERTY BUT NOT DEPICTED.

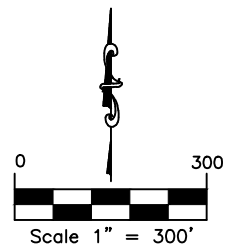



Washburn Land Surveying
 www.WashburnSurveying.com
 970-232-9645

SCALED FACILITY WALTERS 4N67W21P PAD

SECTION: 21
 TOWNSHIP: 4N
 RANGE: 67W
 6TH P.M.
 WELD COUNTY, CO

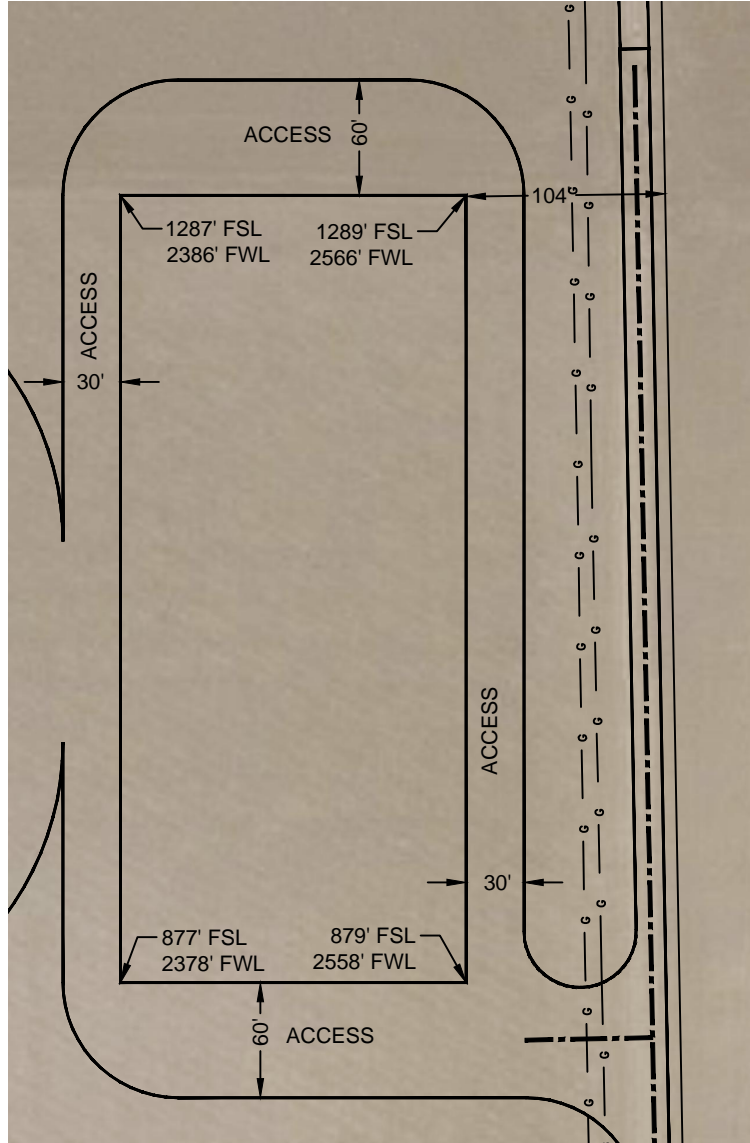

LEGEND:

- TANK BATTERY
- WATER VAULT
- METER
- BURNER/ECD
- VAPOR RECOVERY UNIT
- SEPARATOR

