

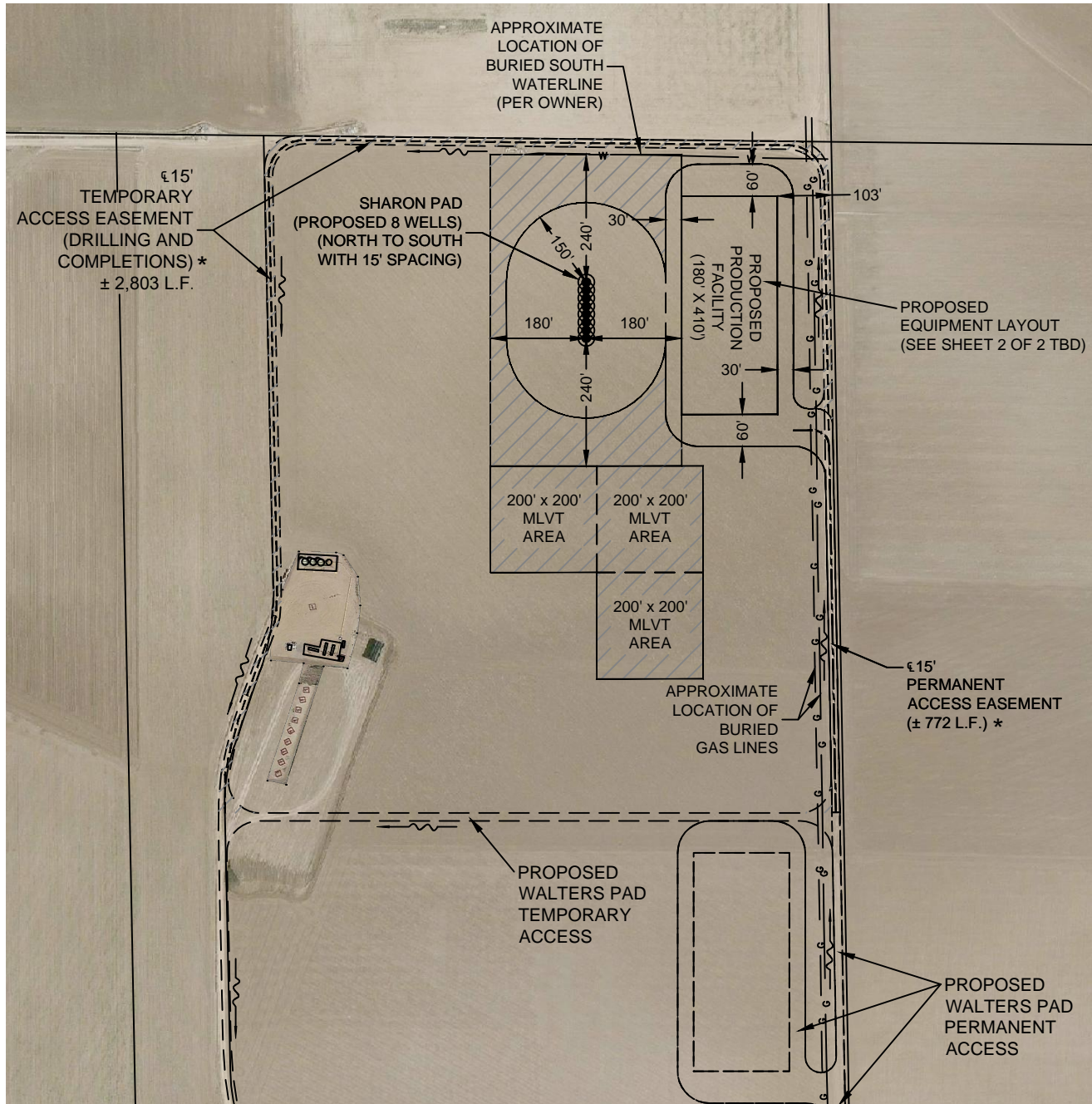

Washburn Land Surveying
www.WashburnSurveying.com
970-232-9645

SCALED FACILITY SHARON 4N67W210 PAD

SECTION: 21
TOWNSHIP: 4N
RANGE: 67W
6TH P.M.
WELD COUNTY, CO



TOTAL DISTURBED AREA OF LOCATION: ± 11.5 ACRES
TOTAL SIZE OF LOCATION AFTER RECLAMATION: ± 5.6 ACRES

/// RECLAIMED AREA(S)

----- APPROXIMATE PERMANENT ACCESS EASEMENT
----- APPROXIMATE TEMPORARY ACCESS EASEMENT

NOTES:

- * - ACCESSES WITHIN THE EASEMENTS ARE TO BE CONSTRUCTED AND/OR IMPROVED TO BE 15' WIDE.
- ONE-WAY TRAFFIC FLOW FOR DRILLING AND COMPLETIONS.
- WATER SOURCE TO MLVT AREA NOT YET DETERMINED.
- ADDITIONAL TEMPORARY ABOVE GROUND FRAC WATER LINE MAY BE REQUIRED ON PROPERTY BUT NOT DEPICTED.

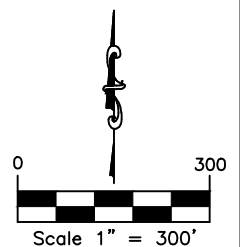

DATE: 3/7/2016 SHEET 1 OF 2



Washburn Land Surveying
www.WashburnSurveying.com
970-232-9645

SCALED FACILITY SHARON 4N67W210 PAD

SECTION: 21
TOWNSHIP: 4N
RANGE: 67W
6TH P.M.
WELD COUNTY, CO

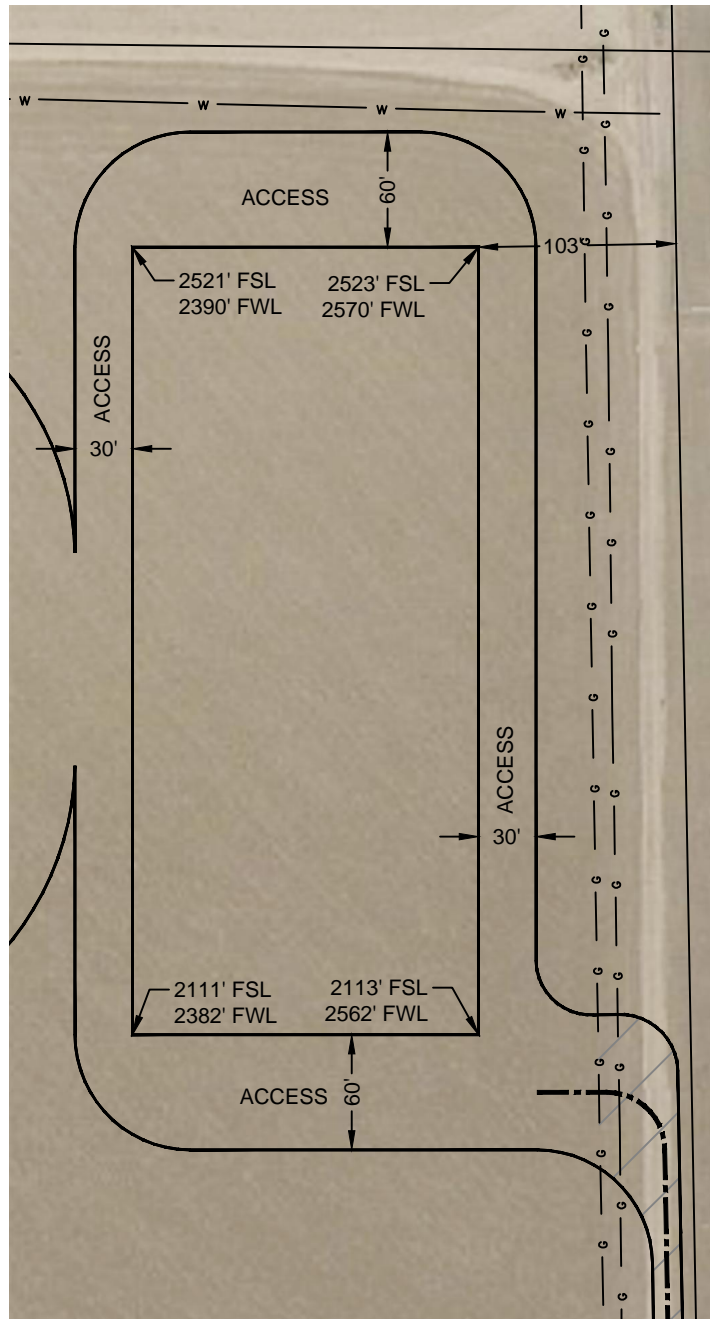

LEGEND:

Ⓣ TANK BATTERY

Ⓦ WATER VAULT

Ⓜ METER

ⓑ BURNER/ECD

ⓋⓇⓊ VAPOR RECOVERY UNIT

ⓈⓔⓅ SEPARATOR

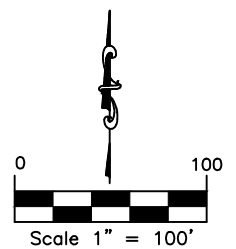

DATE: 3/7/2016

PAGE 2 OF 2