



June 1, 2016

VIA ELECTRONIC TRANSMITTAL

Director Matt Lepore
Colorado Oil and Gas Conservation Commission
1120 Lincoln Street Suite 801
Denver, Colorado 80203

RE: Rule 318.A.e.
VT-Alles 1-16-18

Surface Location: SWNW, Section 15, Township 5 North, Range 65 West, Weld County, CO

Dear Mr. Lepore,

Extraction Oil and Gas is planning to drill the captioned horizontal wells in accordance with the provision of COGCC Rule 318A.e.

The proposed wellbore spacing unit consists of:

Section 18-5N-66W: S/2 N/2, N/2 S/2
Section 17-5N-66W: S/2 N/2, N/2 S/2
Section 16-5N-66W: S/2 NW/4, N/2 SW/4

The spacing unit is an 800-acre wellbore spacing unit for the Niobrara formation.

Extraction Oil and Gas hereby certifies to the Director that all Owners within the proposed spacing unit above were notified and 30 days have passed without objection.

If you have any questions or issues regarding this permit, please contact the undersigned at 720-481-2379.

Respectfully,

Alyssa Andrews
Regulatory Analyst
Extraction Oil and Gas

NAME: ALLES

SPACING UNIT: S/2 N/2 & N/2 S/2 SEC 18, S/2 N/2 & N/2 S/2 SEC 17, S/2 NW/4 & N/2 SW/4 SEC 16, T5N, 65W UNIT ACREAGE: 800

WELL NAME	SURFACE LOCATION				LANDING POINT\BEGIN HORIZONTAL COMPLETION ZONE				BOTTOM HOLE\END HORIZONTAL COMPLETION ZONE				COMPLETION ZONE BEARING	COMPLETION ZONE LENGTH
	DIST.	DIR.	DIST.	DIR.	DIST.	DIR.	DIST.	DIR.	DIST.	DIR.	DIST.	DIR.		
VT-ALLES 1-16-18	2006'	FNL	472'	FWL	2372'	FNL	2189'	FWL	2332'	FNL	460'	FWL	S89°48'42"W	12294.75'

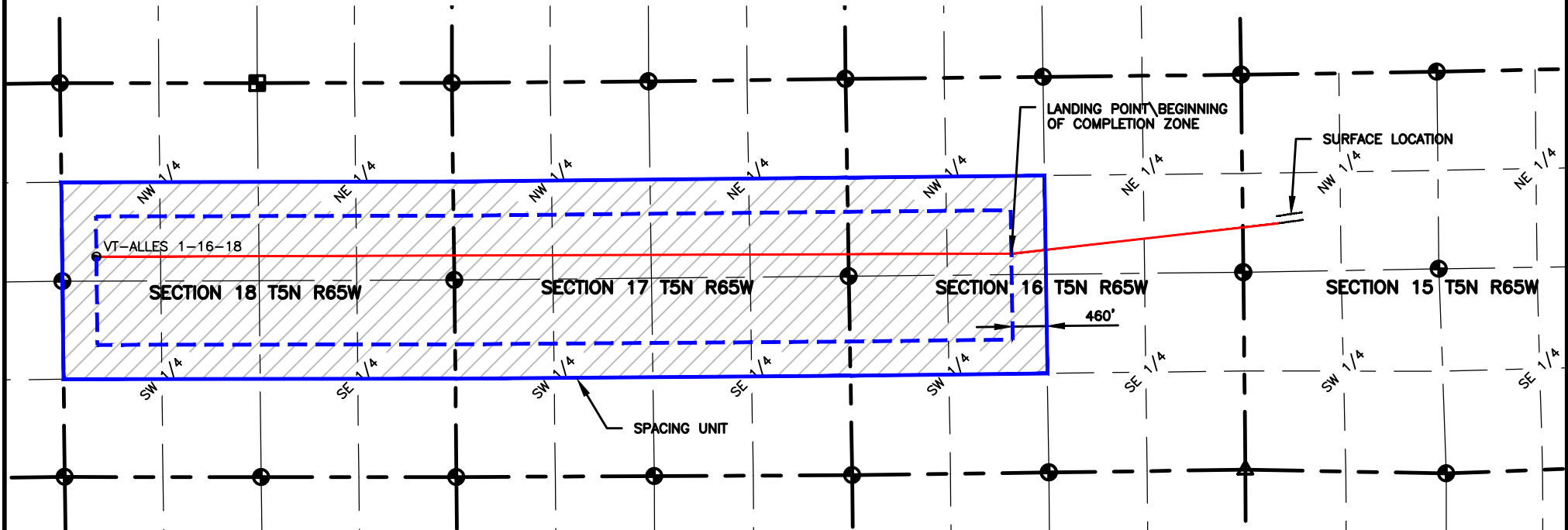
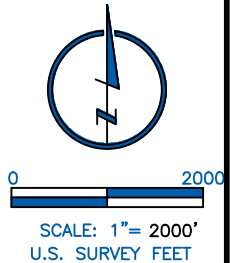

LAMP RYNEARSON
& ASSOCIATES

4715 Innovation Drive 970.226.0342 | P
Fort Collins, CO 80525 970.226.0879 | F
www.LRA-Inc.com

PLANNED SPACING UNIT EXHIBIT
VETTING 15-H
ALLES SPACING UNIT

LEGEND

- ⊕ ALIQUOT CORNER
- ⊕ BOTTOM HOLE
- △ COMPUTED ALIQUOT CORNER FROM MONUMENT ACCESSORIES
- ⊕ COMPUTED FROM GLO RECORDS
- SECTION LINE
- SIXTEENTH LINE
- QUARTER SECTION LINE

DRAWN BY KJW DATE 10/30/15 COGCC ID PROJECT - TASK NUMBER 0215036.00 BOOK AND PAGE MRI-04 PG-6

SURFACE - LOCATION
SW /4, NW /4, SEC 15 T5N R65W

P:_Engineering\0215036 Vetting 15 H\DRAWINGS\EXHIBITS\0215036PSU-ALLES.dwg