

ITEM	CUT	FILL	TOPSOIL	EXCESS
PAD	NONE	NONE	NONE	NONE
PIT	NONE			NONE
TOTALS	NONE	NONE	NONE	NONE

PRE-CONSTRUCTION ELEVATION: 8308.4'  
 EXISTING APPROX. AREA OF DISTURBANCE:  
 3.6± ACRES  
 DRAINS TO BOWDISH GULCH

## PRE-CONSTRUCTION CONTOURS

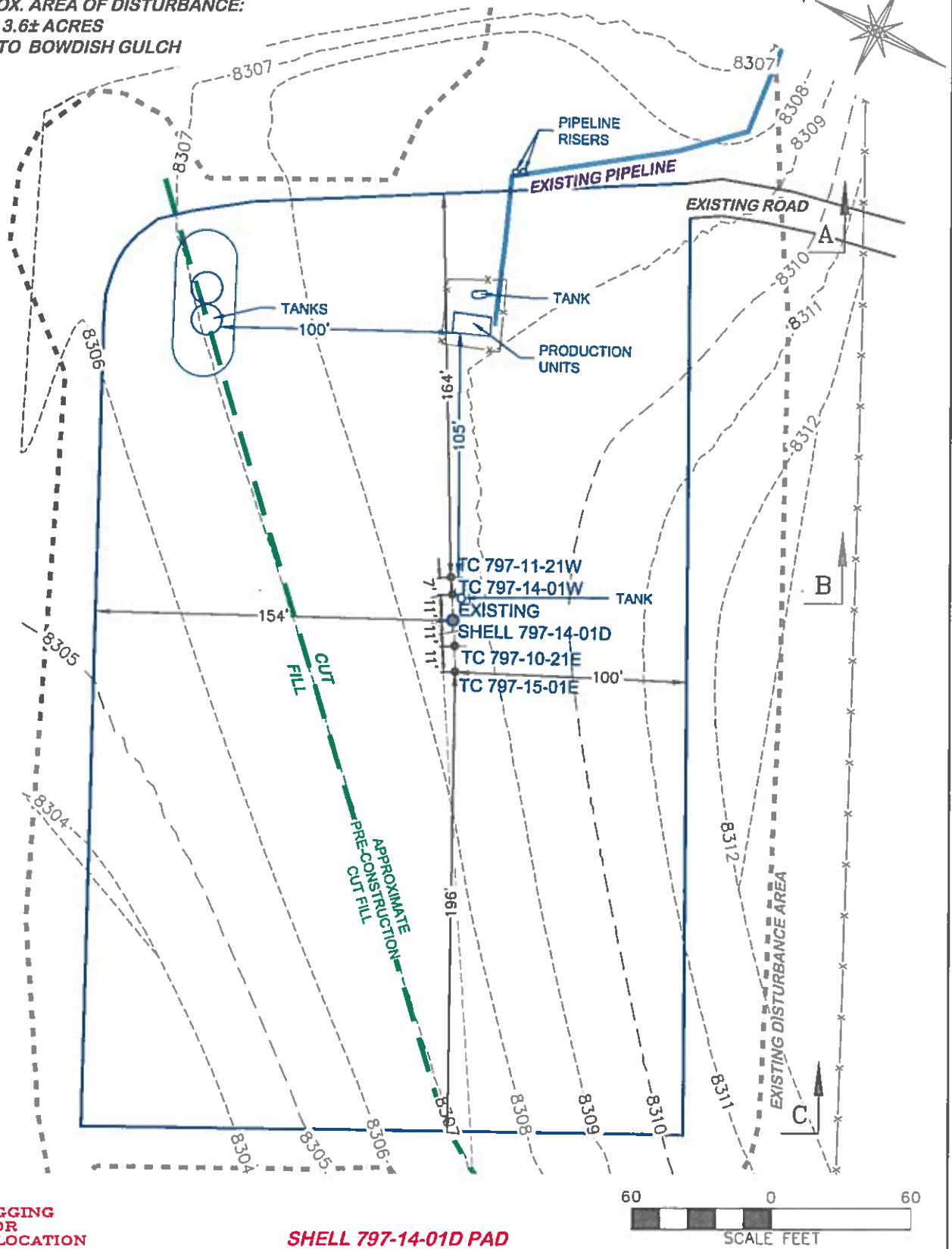

**BEFORE DIGGING  
 CALL FOR  
 UTILITY LINE LOCATION**

**SHELL 797-14-01D PAD**



**DRIFIN & ASSOCIATES, INC.**  
 1414 ELK ST., ROCK SPRINGS, WY 82901

(307) 362-5028

DRAWN: 2/9/2016 - TCM

SCALE: 1" = 60'

REVISED: 4/27/2016 - DEH

DRG JOB No. 20991

NAME CHANGE/MISC.

EXHIBIT 2B

### CONSTRUCTION LAYOUT DRAWING 3 OF 5

**PRE-CONSTRUCTION CONTOURS**  
**LARAMIE ENERGY, LLC**  
**SHELL 797-14-01D, TC 797-11-21W, 15-01E, 10-21E,**  
**14-01W**  
**NWNW, SECTION 14, T. 7 S., R. 97 W., 6th P.M.,**  
**GARFIELD COUNTY, COLORADO**

EXISTING ELEVATION: 8307.0'  
 EXISTING APPROX. AREA OF DISTURBANCE: 3.6± ACRES  
 DRAINS TO BOWDISH GULCH

# PROPOSED RECLAMATION

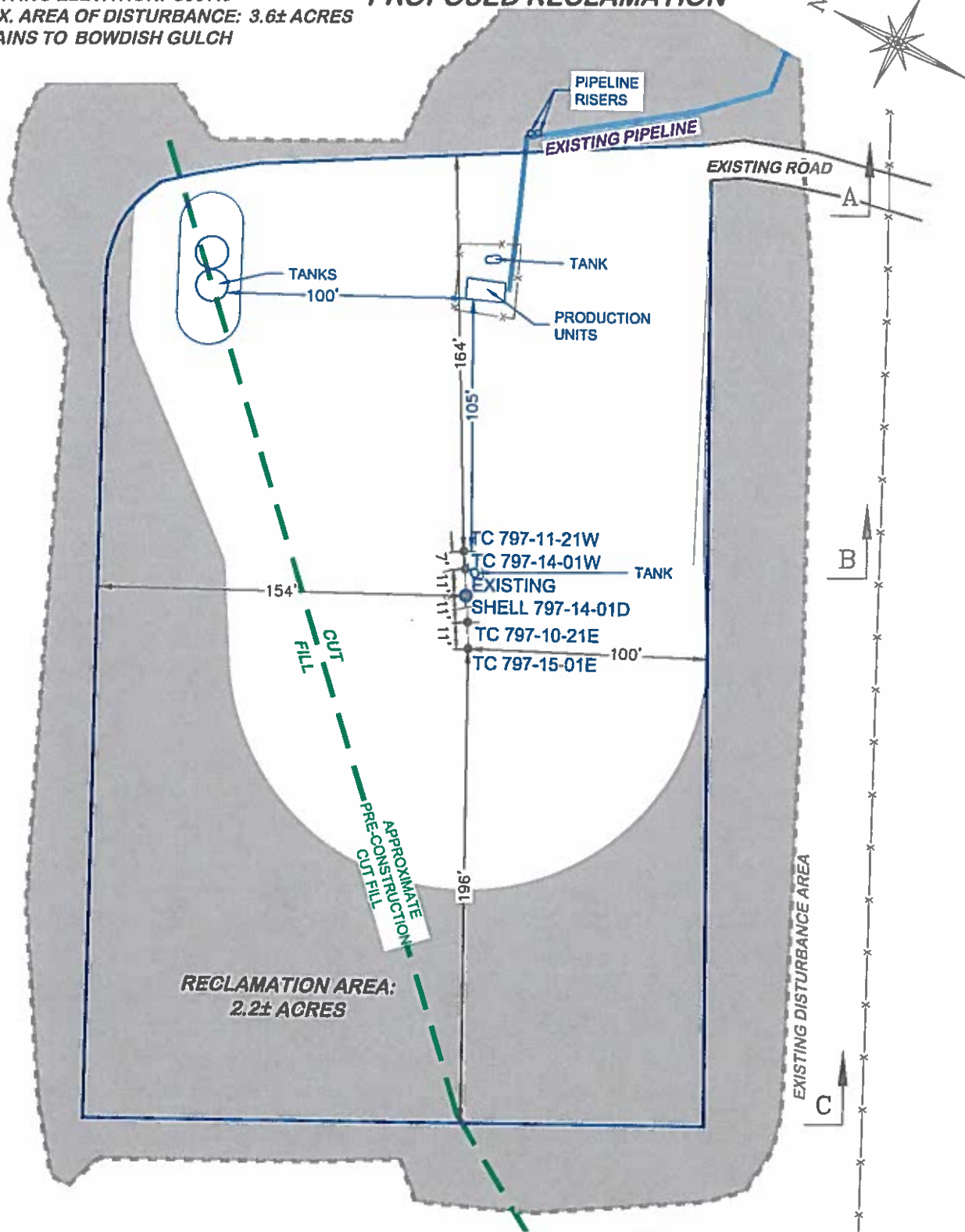

BEFORE DIGGING  
 CALL FOR  
 UTILITY LINE LOCATION

SHELL 797-14-01D PAD



<b>DRG</b> RIFFIN & ASSOCIATES, INC. (307) 382-5028 1414 ELK ST., ROCK SPRINGS, WY 82901	
DRAWN: 2/9/2016 - TCM	SCALE: 1" = 60'
REVISED: 4/27/2016 - DEH	DRG JOB No. 20991
NAME CHANGE/MISC.	EXHIBIT 2C

## CONSTRUCTION LAYOUT DRAWING 4 OF 5

**PROPOSED RECLAMATION**  
**LARAMIE ENERGY, LLC**  
**SHELL 797-14-01D, TC 797-11-21W, 15-01E, 10-21E,**  
**14-01W**  
**NWNW, SECTION 14, T. 7 S., R. 97 W., 6th P.M.,**  
**GARFIELD COUNTY, COLORADO**

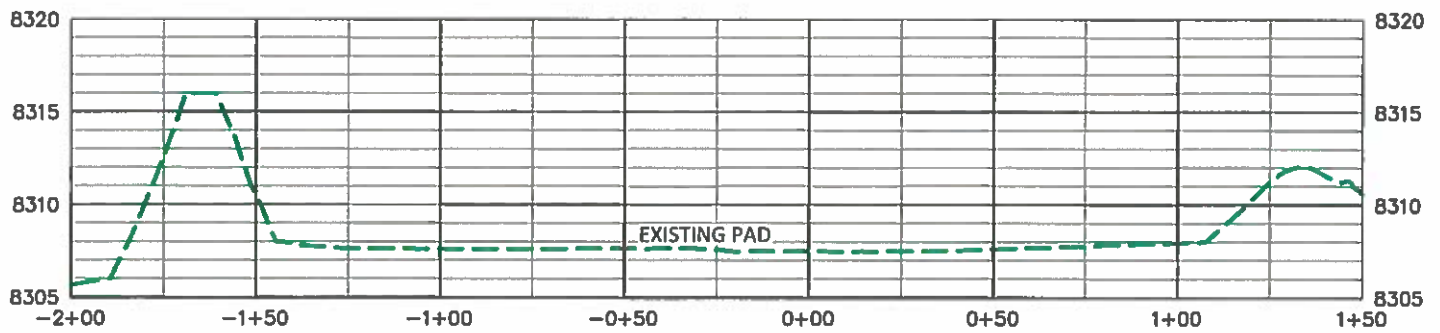

**A**

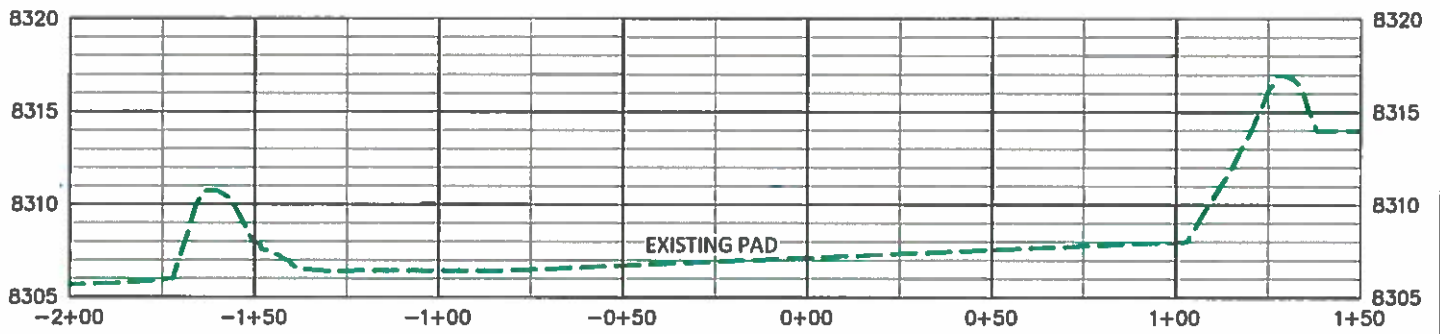

**B**

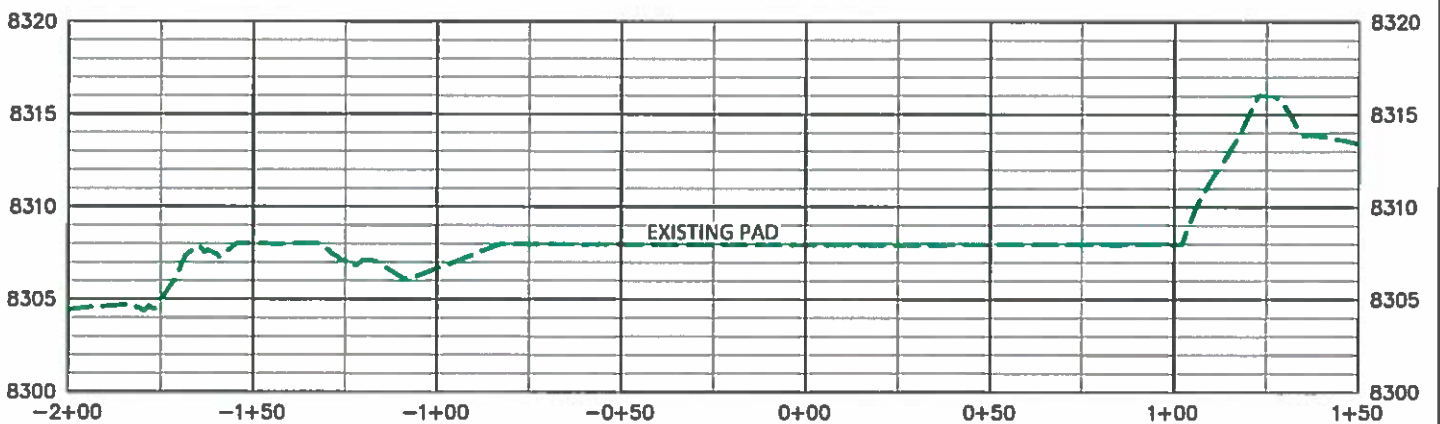

**C**

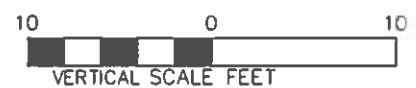

**SHELL 797-14-01D PAD**



(307) 362-5028

**RIFFIN & ASSOCIATES, INC.**  
1414 ELK ST., ROCK SPRINGS, WY 82901

DRAWN: 2/9/2016 - TCM

SCALE: HORT. 1"=50' VERT. 1"=10'

REVISED: 4/27/2016 - DEH

DRG JOB No. 20991

NAME CHANGE/MISC.

EXHIBIT 3

**CONSTRUCTION LAYOUT DRAWING 5 OF 5**

**LARAMIE ENERGY, LLC**  
**SHELL 797-14-01D, TC 797-11-21W, 15-01E, 10-21E,**  
**14-01W**  
**NWNW, SECTION 14, T. 7 S., R. 97 W., 6th P.M.,**  
**GARFIELD COUNTY, COLORADO**