

10

T 7 S.

11

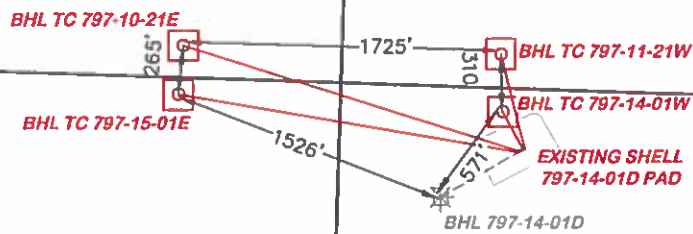
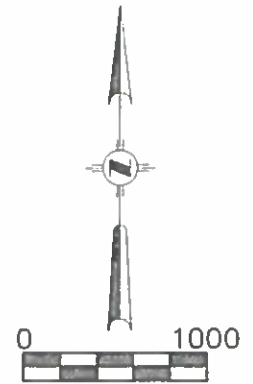

R 97 W.

15

14

LEGEND:

EXISTING APPROX. BOTTOM HOLE LOCATION
FOR SHELL 797-14-01D PAD

PROPOSED APPROX. BOTTOM HOLE LOCATION
FOR SHELL 797-14-01D PAD

SHELL 797-14-01D PAD

(307) 362-5028

RIFFIN & ASSOCIATES, INC.
1414 ELK ST., ROCK SPRINGS, WY 82901

DRAWN: 2/9/2016 - TCM

SCALE: 1" = 1000'

REVISED: 4/27/2016 - DEH

DRG JOB No. 20991

NAME CHANGE/MISC.

EXHIBIT 7

MULTI-WELL PLAN**LARAMIE ENERGY, LLC**

**SHELL 797-14-01D, TC 797-11-21W, 15-01E, 10-21E,
14-01W**

**SECTION 14, T. 7 S., R. 97 W., 6th P.M.,
GARFIELD COUNTY, COLORADO**

**PAD LOCATED IN NWNW OF
SECTION 14, T. 7 S., R. 97 W., 6th P.M.,
GARFIELD COUNTY, COLORADO**