

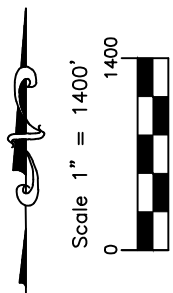

Washburn Land Surveying  
 www.WashburnSurveying.com  
 970-232-9645

# ACCESS ROAD MAP WACKER 5N64W10G PAD

SECTION: 10  
 TOWNSHIP: 5N  
 RANGE: 64W  
 6TH P.M.  
 WELD COUNTY, CO

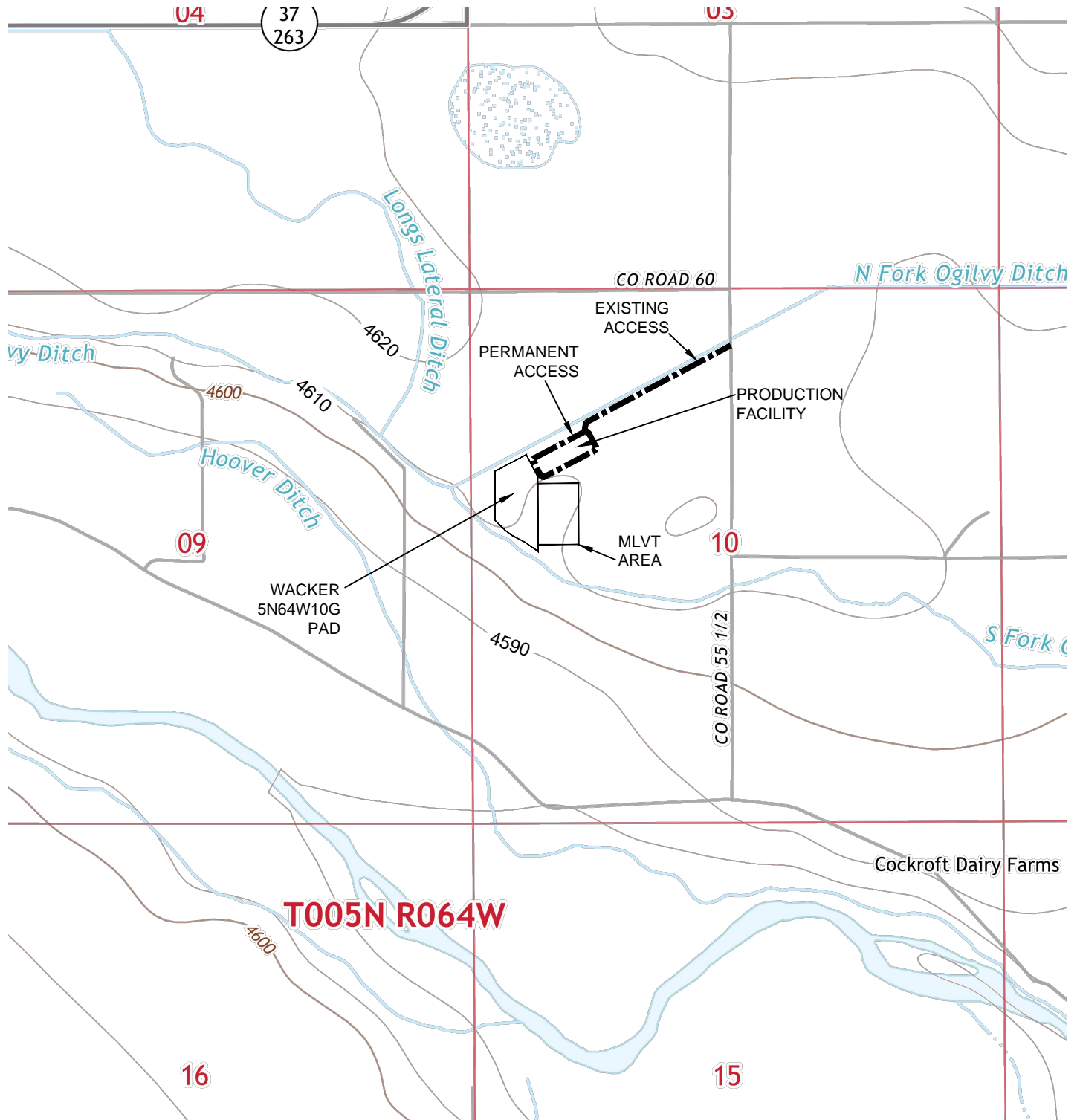



Washburn Land Surveying  
www.WashburnSurveying.com  
970-232-9645

# ACCESS ROAD MAP WACKER 5N64W10G PAD

SECTION: 10  
TOWNSHIP: 5N  
RANGE: 64W  
6TH P.M.  
WELD COUNTY, CO



### DIRECTIONS:

FROM THE INTERSECTION OF WELD COUNTY ROAD 60 AND WELD COUNTY ROAD 55 ½ ,  
THENCE SOUTH ON WELD COUNTY ROAD 55 ½ FOR 588 FEET TO AN ACCESS TO THE  
SOUTHWEST, THENCE SOUTHWEST FOR 1655 FEET TO AN ACCESS TO THE SOUTH, THENCE  
SOUTH FOR 50 FEET TO THE PROPOSED PRODUCTION FACILITY OF THE WELL PAD.

