



Washburn Land Surveying  
www.WashburnSurveying.com  
970-232-9645

# HYDROLOGY MAP

## OTTENHOFF 5N64W29CR PAD

SECTION: 29  
TOWNSHIP: 5N  
RANGE: 64W  
6TH P.M.  
WELD COUNTY, CO

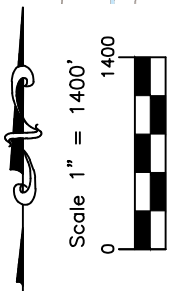
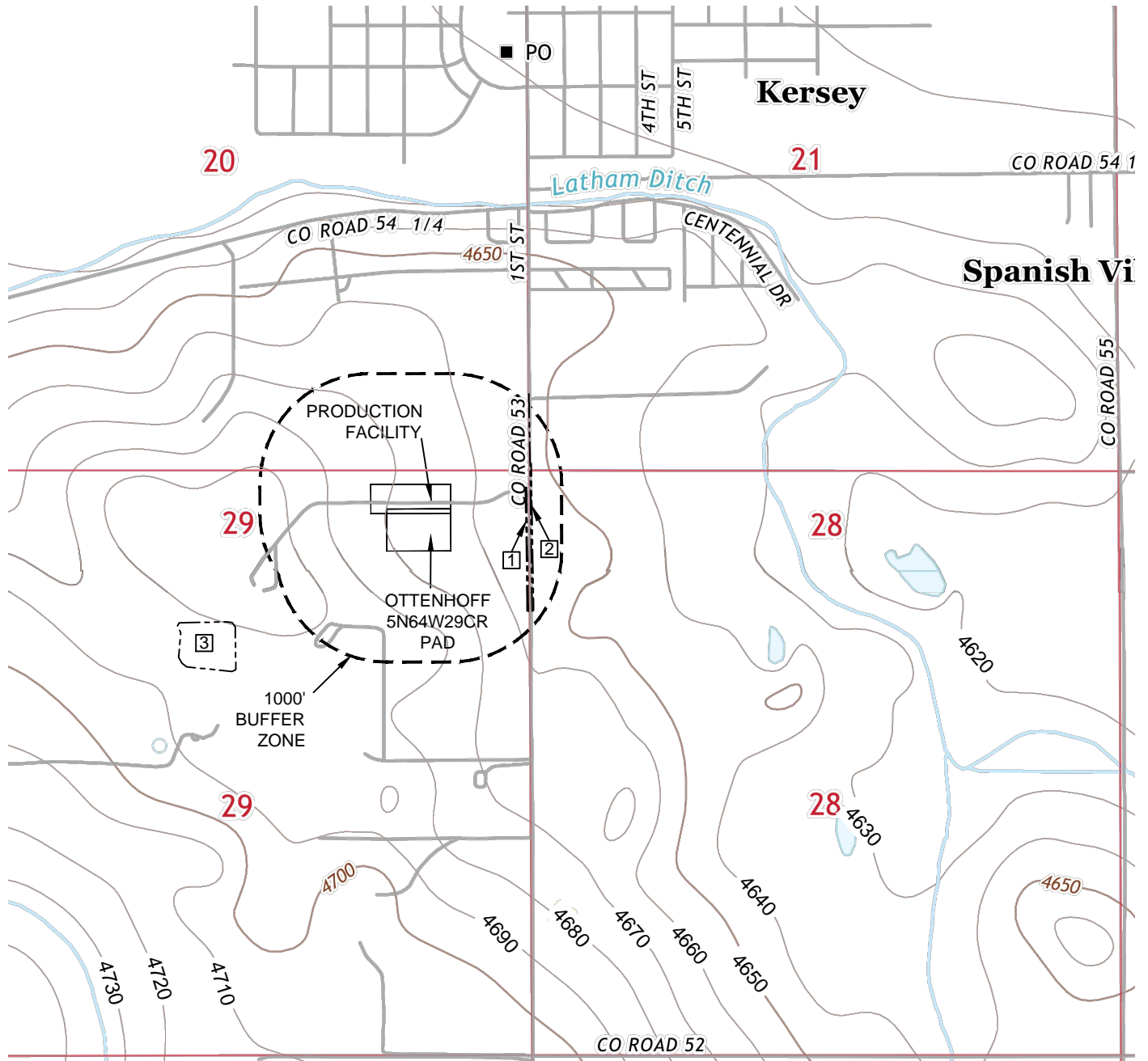

DISTANCES BELOW MEASURED FROM THE PROPOSED EDGE OF  
DISTURBANCE OF THE OIL AND GAS LOCATION

- 1 BORROW DITCH: 673' E (NEAREST DOWN GRADIENT WATER FEATURE)
- 2 BORROW DITCH: 719' E
- 3 HOLDING POND: 1537' SW