



Washburn Land Surveying  
www.WashburnSurveying.com  
970-232-9645

# ACCESS ROAD MAP

## OTTENHOFF 5N64W29CR PAD

SECTION: 29  
TOWNSHIP: 5N  
RANGE: 64W  
6TH P.M.  
WELD COUNTY, CO

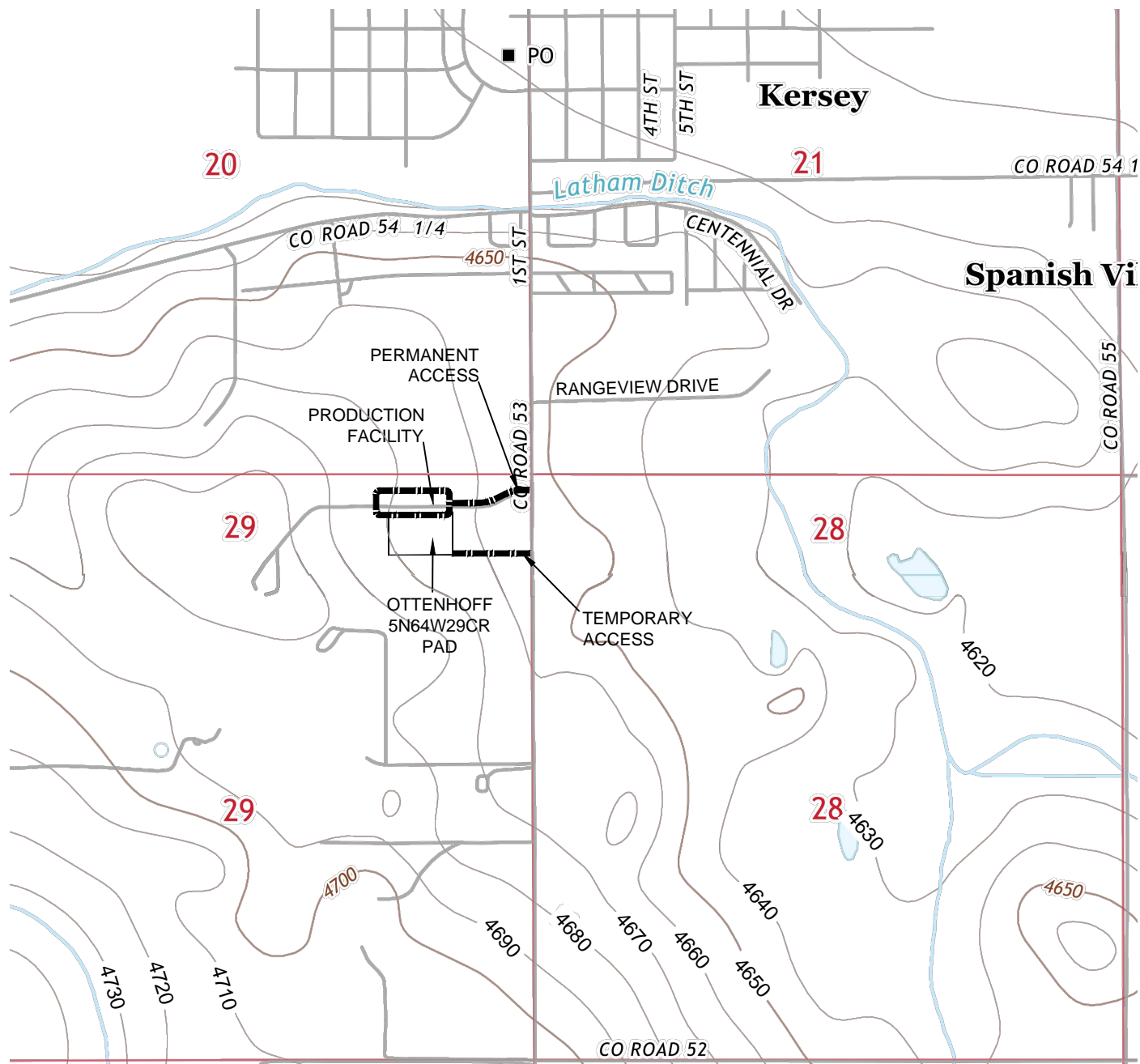



Washburn Land Surveying  
www.WashburnSurveying.com  
970-232-9645

# ACCESS ROAD MAP OTTENHOFF 5N64W29CR PAD

SECTION: 29  
TOWNSHIP: 5N  
RANGE: 64W  
6TH P.M.  
WELD COUNTY, CO

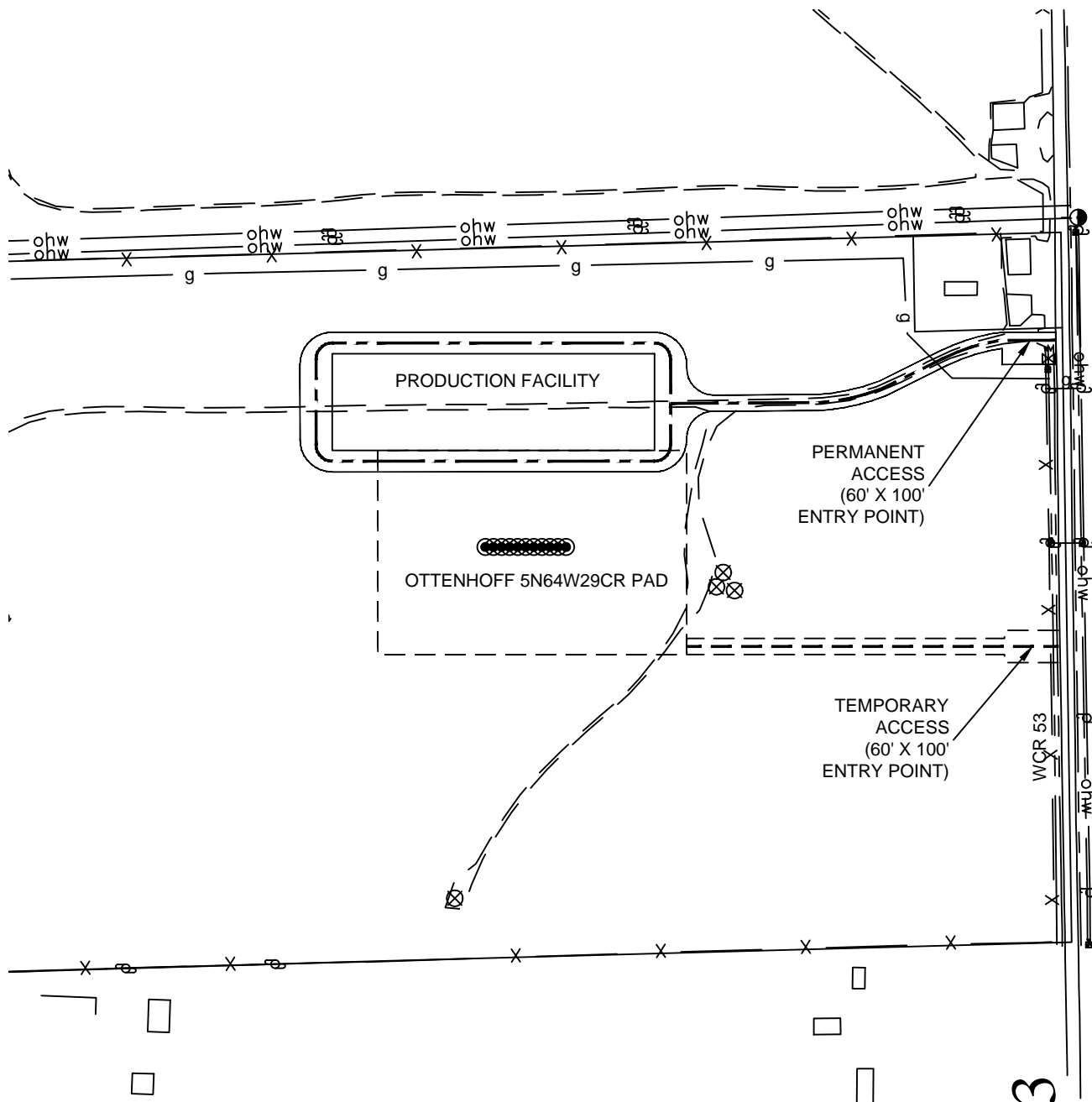

## DIRECTIONS:

FROM THE INTERSECTION OF RANGEVIEW DRIVE AND WELD COUNTY ROAD 53 (1ST STREET),  
THENCE SOUTH ON WELD COUNTY ROAD 53 (1ST STREET) FOR 810 FEET TO AN ACCESS TO THE  
WEST, THENCE WEST FOR 710 FEET TO PROPOSED PRODUCTION FACILITY OF THE WELL PAD.

Scale 1" = 300'

