

SCALE: 1" = 80'

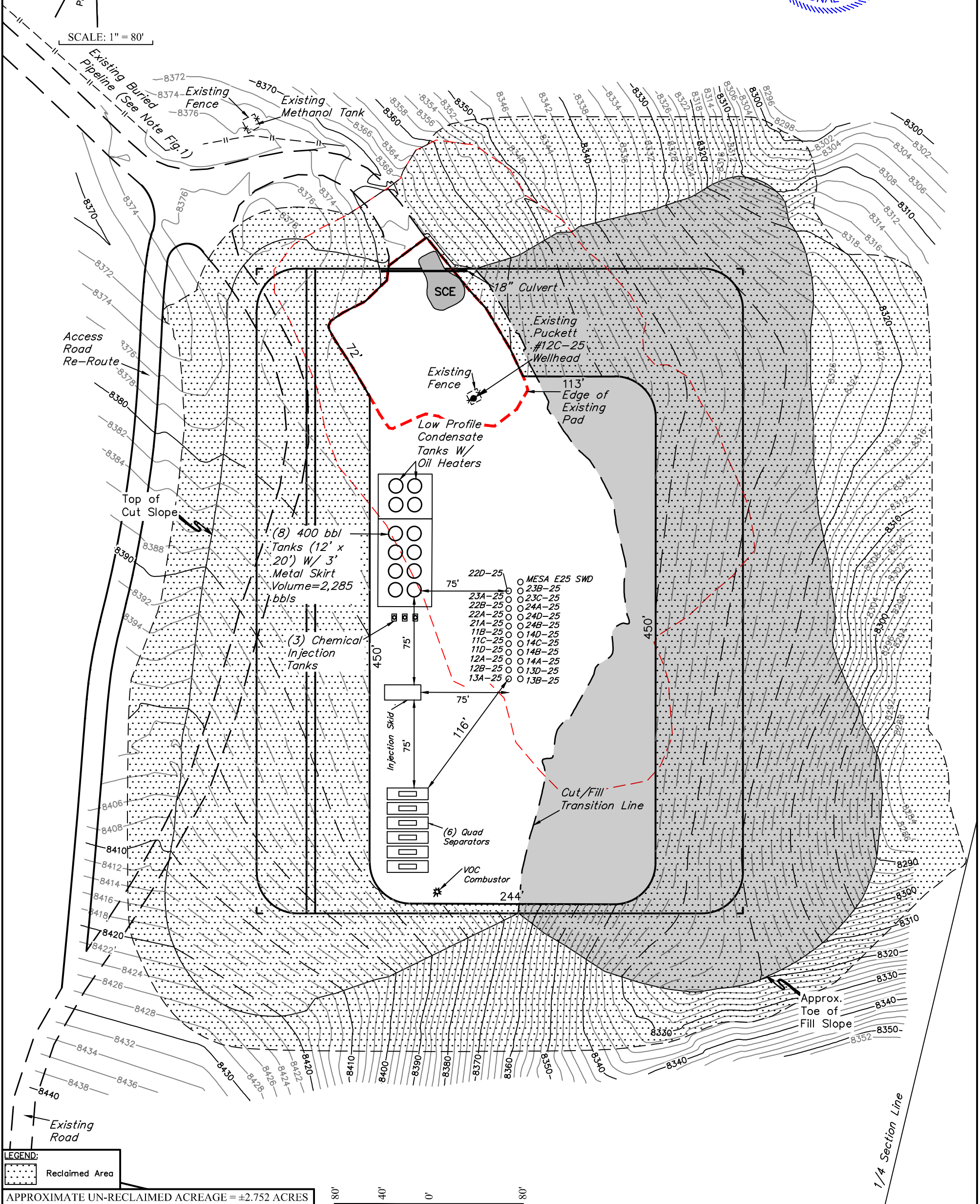

LEGEND:  
Reclaimed Area

APPROXIMATE UN-RECLAIMED ACREAGE = ±2.752 ACRES  
APPROXIMATE RECLAIMED ACREAGE = ±8.356 ACRES  
TOTAL ACREAGE = ±11.108 ACRES

NOTES:  
• Contours shown at 2' intervals.



REV: 2 05-09-16 C.D.L. (REMOVE FLARE PIT)

Caerus Oil & Gas LLC

MESA E25-697 ON EXISTING PUCKETT 12C-25 PAD  
SW 1/4 NW 1/4, SECTION 25, T6S, R97W, 6th P.M.  
GARFIELD COUNTY, COLORADO

SURVEYED BY	DATE		
BRADEN BOX, B.B.	12-14-15		
DRAWN BY	DATE		
C.D.L.	01-04-16		

INTERIM RECLAMATION PLAN

FIGURE #4



UELS, LLC  
Corporate Office \* 85 South 200 East  
Vernal, UT 84078 \* (435) 789-1017