

| | | | |
|----------------------|---------------------------------|------------------------------------|------------------------------------------|
| Borehole: | Well: | Field: | Structure: |
| Original Hole | Shull Fed-9-59-31-4441CE | CO, Weld County (NAD 83 NZ) | 31-09N-59W (Anderson-Shull Pad 3) |

| | | | | | | | | | | | | | | | | |
|-------------------------------|-----------|------|------------|-------------|----------------------------|------|---------------|-----------|----------------------------------------------------|-------------|------------|-------|-----------------------------------------|----------|---------------------------|--|
| Gravity & Magnetic Parameters | | | | | Surface Location | | | | NAD83 Colorado State Plane, Northern Zone, US Feet | | | | Miscellaneous | | | |
| Model: | HDGM 2015 | Dip: | 67.138° | Date: | 13-Apr-2016 | Lat: | N 40 42 16.89 | Northing: | 1502969.26ftUS | Grid Conv: | 0.9538° | Slot: | Shull Fed-9-59-31-4441CE | TVD Ref: | Unknown(4880ft above MSL) | |
| MagDec: | 8.042° | FS: | 52760.62nT | Gravity FS: | 999.083mgn (9.80665 Based) | Lon: | W 104 1 26.02 | Easting: | 3409244.07ftUS | Scale Fact: | 0.99998818 | Plan: | Shull Fed-9-59-31-4441CE R0 mdv 13Apr16 | | | |

| Northing: 1502969.261 | | Easting: 3409244.071 | | Surface Location | | Longitude: W 104 1 26.02 | | VSec Azimuth: 91.171 | |
|---------------------------------------------|---------------|----------------------|------------|------------------|---------|--------------------------|-----------|----------------------|-----|
| Target Description | | Grid Coord | | Local Coord | | | | | |
| Target Name | Latitude | Longitude | Northing | Easting | TVD | VSec | N(+)/S(-) | E(+)/W(-) | DLS |
| Anderson-Shull Pad Sec 31-32 - 460' Setback | N 40 42 41.43 | W 104 1 22.06 | 1505457.62 | 3409507.95 | 4880.00 | 212.97 | 2488.39 | 263.88 | |
| Anderson-Shull Pad Sec 31-8N-59W | N 40 42 41.43 | W 104 1 22.06 | 1505457.62 | 3409507.95 | 4880.00 | 212.97 | 2488.39 | 263.88 | |
| Anderson-Shull Pad Sec 32-9N-59W | N 40 42 41.43 | W 104 1 22.06 | 1505457.62 | 3409507.95 | 4880.00 | 212.97 | 2488.39 | 263.88 | |
| Pad 3 | N 40 42 41.43 | W 104 1 22.06 | 1505457.62 | 3409507.95 | 4880.00 | 212.97 | 2488.39 | 263.88 | |
| Shull Fed-9-59-31-4441CE BHL | N 40 42 13.85 | W 103 59 38.78 | 1502800.29 | 3417507.44 | 6206.00 | 8265.21 | -168.97 | 8263.49 | |
| Shull Fed-9-59-31-4441CE LP | N 40 42 13.62 | W 104 1 8.23 | 1502660.95 | 3410619.13 | 6236.00 | 8263.00 | -308.32 | 1375.07 | |
| Critical Points | | | | | | | | | |
| Critical Point | MD | INCL | AZIM | TVD | VSEC | N(+)/S(-) | E(+)/W(-) | DLS | |
| Surface | 0.00 | 0.00 | 0.00 | 0.00 | 0.00 | 0.00 | 0.00 | 0.00 | |
| KOP, Build 1.5 DLS | 1500.00 | 0.00 | 114.12 | 1500.00 | 0.00 | 0.00 | 0.00 | 0.00 | |
| Hold | 2175.41 | 10.13 | 114.12 | 2171.90 | 54.85 | -24.34 | 54.36 | 1.50 | |
| KOP, Build/Turn 10 DLS | 5730.03 | 10.13 | 114.12 | 5671.09 | 630.63 | -279.84 | 625.04 | 0.00 | |
| Hold 200' @ 65° INC | 6287.69 | 65.00 | 90.93 | 6097.63 | 954.48 | -306.09 | 948.42 | 10.00 | |
| KOP, Build 10 DLS to Landing | 6487.69 | 65.00 | 90.93 | 6182.15 | 1135.74 | -309.03 | 1129.66 | 0.00 | |
| Landing Point, Hold to TD | 6741.00 | 90.25 | 88.84 | 6236.00 | 1381.09 | -308.32 | 1375.07 | 10.00 | |
| 7" Casing Point | 6742.00 | 90.25 | 88.84 | 6236.00 | 1382.09 | -308.30 | 1376.07 | 0.00 | |
| Shull Fed-9-59-31-4441CE BHL | 13630.89 | 90.25 | 88.84 | 6206.00 | 8265.21 | -168.97 | 8263.49 | 0.00 | |

Proposal
Rev 0



Grid
True
Mag

Grid North
Tot Corr (M->G 7.088°)
Mag Dec (8.042°)
Grid Conv (0.954°)

EW (ft) Scale = 1:2000.00(ft)

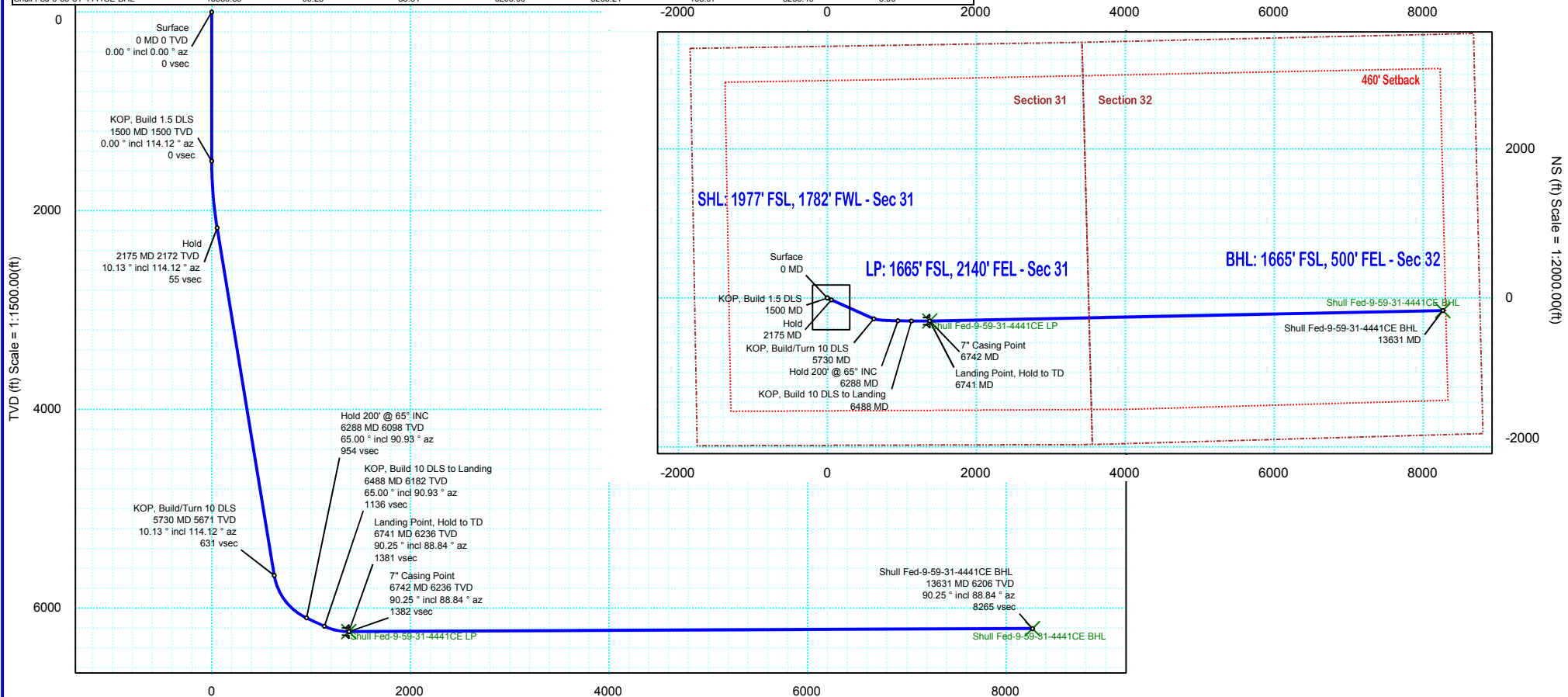

Vertical Section (ft) Azim = 91.171° Scale = 1:1500.00(ft) Origin = 0N/-S, 0E/-W