

FEATURE	BEARING - DISTANCE
FLOOD PLAIN	S68°04'E - 213'

DISTANCES FROM CORNER OF PRONGHORN F-18 PAD TO CLOSEST POINT OF FEATURE.

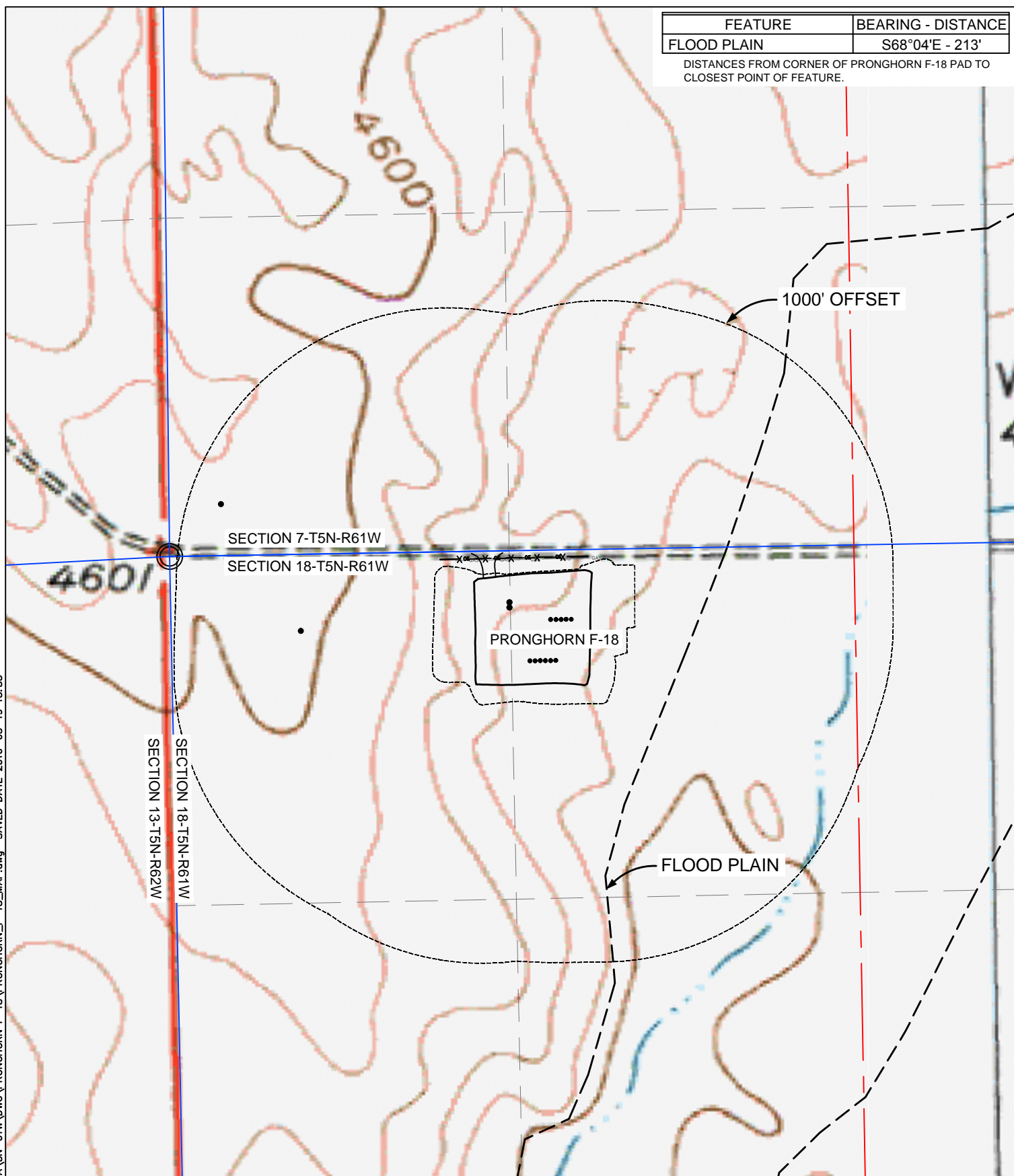

WILLIAM H. SMITH & ASSOCIATES, Inc.
 155 N. 1st Street
 Lander, WY 82520
 Phone: 307-335-5646

Drawn By: MAM
 Checked By: DAF
 Job No.:
 Date: 03/18/16
 Revision:

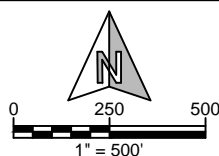

IF BAR LENGTH DOES NOT EQUAL
 1" (ONE INCH), THIS PAGE WAS NOT
 PLOTTED TO THE INTENDED SCALE.

HYDROLOGY MAP

**PRONGHORN
 F-18 PAD**
 NW¼, SECTION 18,
 T.5N., R.61W., 6th PM
 WELD COUNTY, COLORADO



410 17th Street
 Denver, CO 80202
 (720) 440-6100

SHEET
 1
 OF
 1