

NAD 83 (NORTHWEST CORNER)	NAD 83 (NORTHEAST CORNER)
LATITUDE = 40°00'15.58" (40.004328)	LATITUDE = 40°00'15.61" (40.004336)
LONGITUDE = 104°52'10.15" (104.869486)	LONGITUDE = 104°52'03.73" (104.867703)
NAD 83 (SOUTHWEST CORNER)	NAD 83 (SOUTHEAST CORNER)
LATITUDE = 40°00'13.11" (40.003642)	LATITUDE = 40°00'13.14" (40.003650)
LONGITUDE = 104°52'10.13" (104.869481)	LONGITUDE = 104°52'03.71" (104.867697)

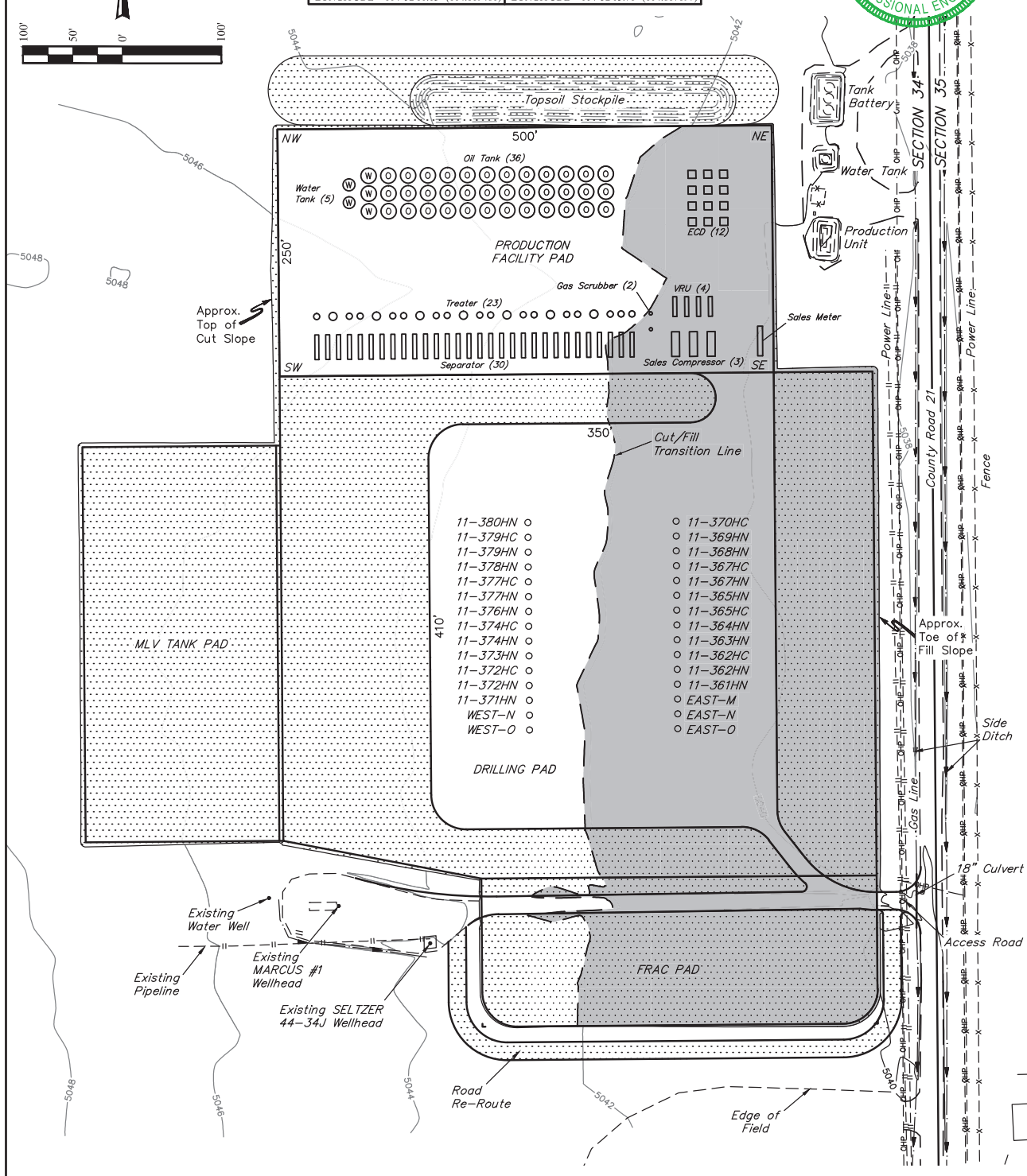

LEGEND:	REV: 4 05-03-16 C.C. (PRODUCTION EQUIPMENT CHANGE)
Reclaimed Area	

APPROXIMATE UN-RECLAIMED ACREAGE = ±6.435 ACRES
 APPROXIMATE RECLAIMED ACREAGE = ±7.652 ACRES
 RECLAIMED 30' WIDE ROAD R-O-W DISTURBANCE = ±0.455 ACRES
TOTAL ACREAGE = ±14.542 ACRES

NOTES:
 • Contours shown at 2' intervals.

GREAT WESTERN OPERATING COMPANY

MARCUS LD PAD
 SE 1/4 SE 1/4, SECTION 34, T1N, R67W, 6th P.M.
 WELD COUNTY, COLORADO



UELS, LLC
 Corporate Office * 85 South 200 East
 Vernal, UT 84078 * (435) 789-1017

DRAWN BY: J.W.	DATE DRAWN: 12-02-14
SCALE: 1" = 100'	
PRODUCTION FACILITY LAYOUT FIGURE #3	