

NOTE:
1. EXISTING UTILITIES DISPLAYED ON THE GRADING PLAN ARE FOR REFERENCE PURPOSES ONLY. PRIOR TO CONSTRUCTION OR EARTHWORK, CONTRACTOR WILL BE RESPONSIBLE TO CALL FOR LOCATES: (800) 922-1987

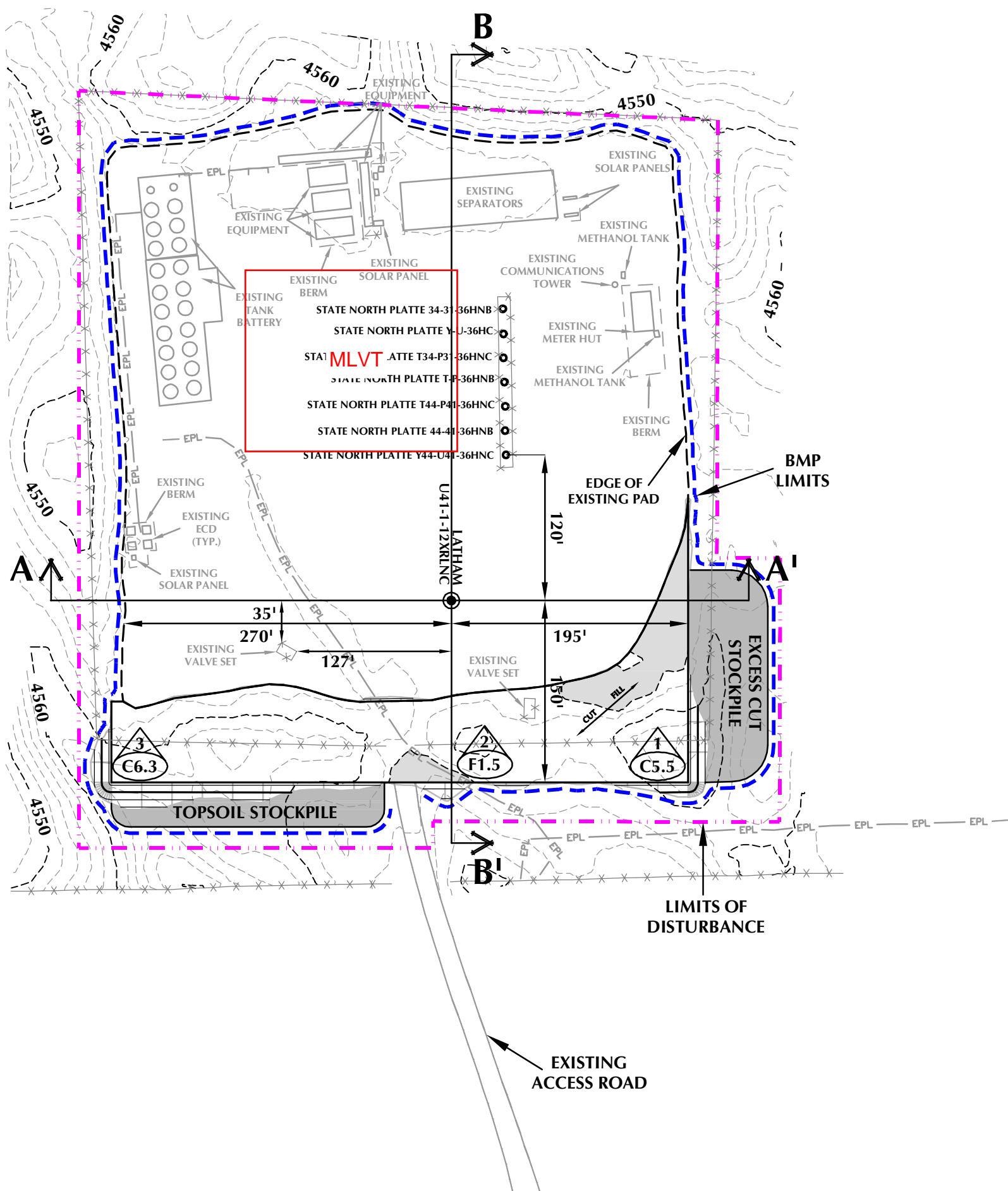

WELL PAD - STATE NORTH PLATTE T-36

WELL PAD QUANTITIES AND DESIGN PARAMETERS

FINISHED GRADE ELEVATION = 4557.3'
CUT SLOPES = 3:1
FILL SLOPES = 4:1
SHRINKAGE FACTOR = 1.10
SWELL FACTOR = 1.00
ADDITIONAL GRADED WELL
PAD SURFACE AREA = 0.90 ACRES
ADDITIONAL WELL PAD AREA = 1.05 ACRES
TOTAL DISTURBANCE AREA = 7.53 ACRES

WELL PAD QUANTITIES

TOTAL CUT FOR WELL PAD = 2,877 C.Y.
TOTAL FILL FOR WELL PAD = 215 C.Y.
TOPSOIL @ 6" DEPTH = 850 C.Y.
EXCESS MATERIAL = 2,662 C.Y.
PLATING @ 4" DEPTH = 490 C.Y.

INTERIM RECLAMATION

WELL PAD AREA AFTER
INTERIM RECLAMATION = TBD

WELL PAD LEGEND

- EXISTING WELL LOCATION
- PROPOSED WELL LOCATION
- EXISTING CONTOURS (2' INTERVAL)
- PROPOSED CONTOURS (2' INTERVAL)
- EPL EXISTING PIPELINE
- PPL PROPOSED PIPELINE
- EXISTING FENCE



HORIZONTAL 0 50' 100' 1" = 100'
2' CONTOURS

SCALE: 1"=100' DATE: 7/21/15 SHEET NO:

REVISED: SJM 9/17/15 1 1 OF 1

WELL PAD - STATE NORTH PLATTE T-36

WELL PAD - GRADING PLAN
LATHAM U41-1-12XRLNC
LOCATED IN SECTION 36
T5N, R63W, 6TH P.M.
WELD COUNTY, COLORADO



410 17th Street, Suite 1400
Denver, Colorado 80202



CONSULTING, LLC

LOVELAND OFFICE
1635 Foxtrail Drive, Suite 204
Loveland, Colorado 80538
Phone 970-776-4331

SHERIDAN OFFICE
1095 Saberton Avenue
Sheridan, Wyoming 82801
Phone 307-674-0609

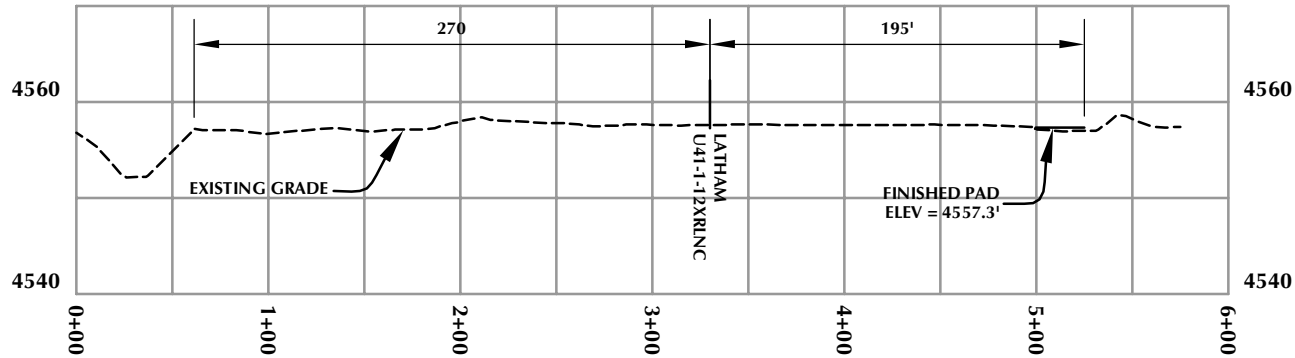

CROSS SECTION A-A'

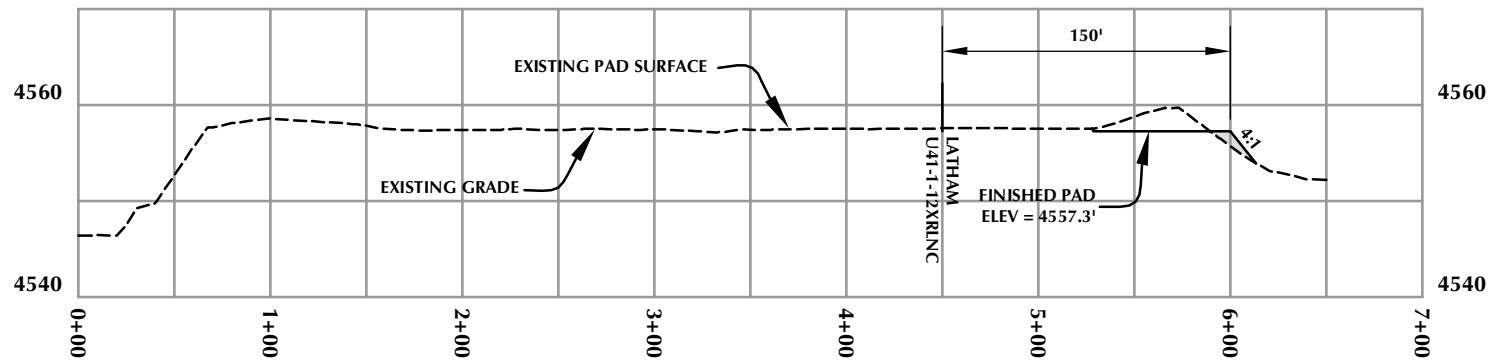

CROSS SECTION B-B'

WELL PAD - STATE NORTH PLATTE T-36

WELL PAD - CROSS SECTIONS
LATHAM U41-1-12XRLNC
LOCATED IN SECTION 36
T5N, R63W, 6TH P.M.
WELD COUNTY, COLORADO

BONANZA CREEK
410 17th Street, Suite 1400
Denver, Colorado 80202



LOVELAND OFFICE
1635 Foxtrail Drive, Suite 204
Loveland, Colorado 80538
Phone 970-776-4331

SHERIDAN OFFICE
1095 Saberton Avenue
Sheridan, Wyoming 82801
Phone 307-674-0609

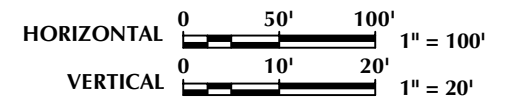

SCALE: 1"=100'	DATE: 9/21/15	SHEET NO:
REVISED:		2 2 OF 2