

BRENIMAN 16-B PAD HYDROLOGY MAP

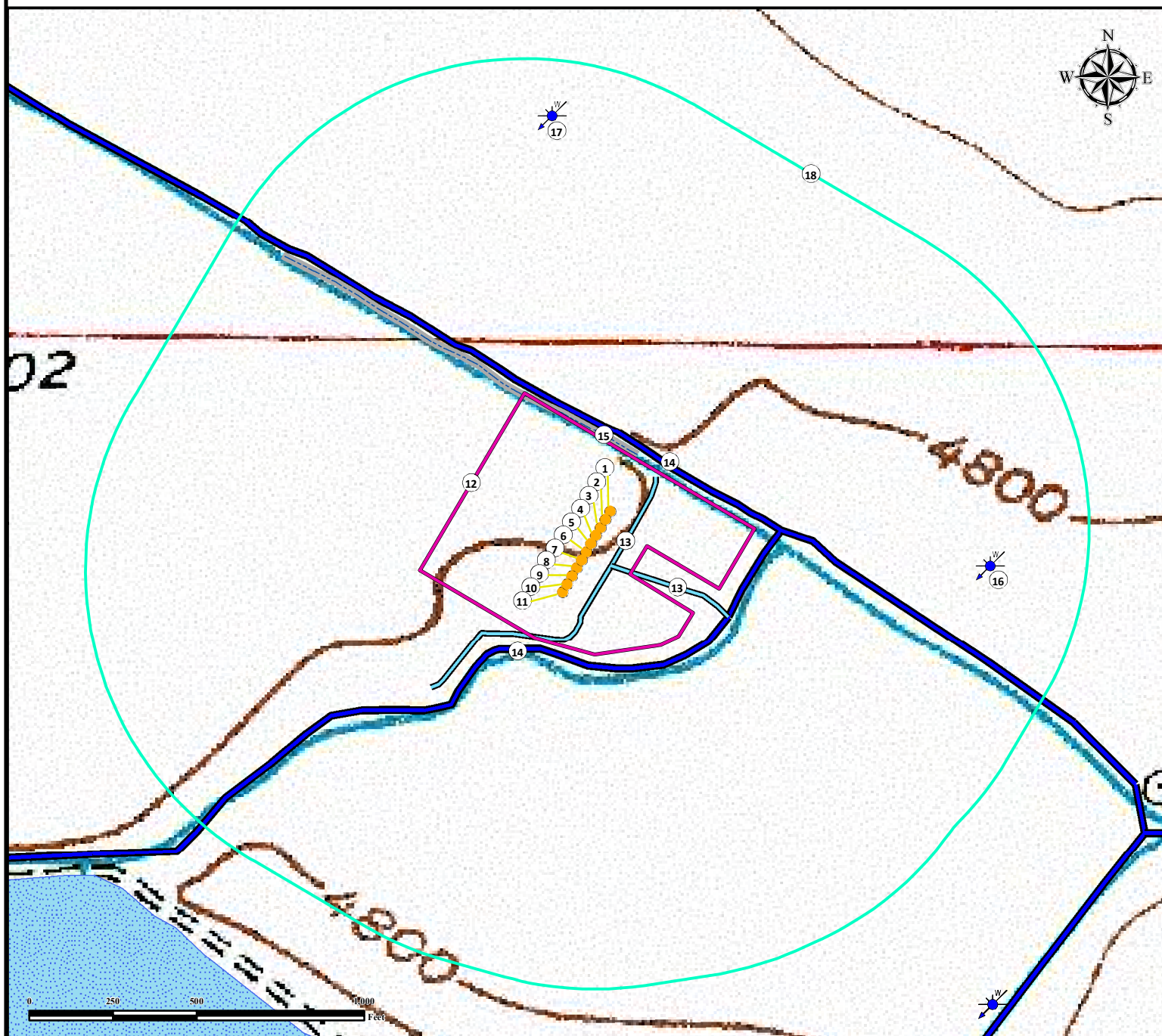

Measurements are made from the nearest edge of the disturbance area.

- | | |
|--------------------------------|---|
| 1. Proposed Well BRENIMAN 1. | 12. Operational Disturbance Area. |
| 2. Proposed Well BRENIMAN 2. | 13. Ditches are $\pm 0'$, and $\pm 0'$. |
| 3. Proposed Well BRENIMAN 3. | 14. Canals are $\pm 23'$ NE, and $\pm 27'$ SW. |
| 4. Proposed Well BRENIMAN 4. | 15. Concrete Ditch is $\pm 0'$. |
| 5. Proposed Well BRENIMAN 5. | 16. Water Well (Permit #42533) is $\pm 712'$ E. |
| 6. Proposed Well BRENIMAN 6. | 17. Water Well (Permit #24228) is $\pm 833'$ N. |
| 7. Proposed Well BRENIMAN 7. | 18. 1000' Radius. |
| 8. Proposed Well BRENIMAN 8. | |
| 9. Proposed Well BRENIMAN 9. | |
| 10. Proposed Well BRENIMAN 10. | |
| 11. Proposed Well BRENIMAN 11. | |

Legend

- | | | | | | |
|--|---------------|--|----------------|--|------------------|
| | Proposed Well | | Canal | | Lake/Pond |
| | Water Well | | Ditch | | Disturbance Area |
| | | | Concrete Ditch | | 1000' Radius |



FIELD DATE:
07-08-14

DRAWING DATE:
04-28-16

BY:
CSG

CHECKED BY:
KLA

SITE NAME:
BRENIMAN 16-B PAD

SURFACE LOCATION:
NE1/4 NW1/4 SEC. 16, T6N, R67W, 6TH P.M.
WELD COUNTY, COLORADO

PREPARED FOR:

