



NOBLE ENERGY, INC

Location: COLORADO Slot: SLOT#29 MOSER H22-735 (345'FNL & 1913'FEL, SEC.27)
 Field: WELD COUNTY (NOBLE NAD 83 GRID) Well: MOSER H22-735
 Facility: SEC.27-T03N-R65W Wellbore: MOSER H22-735 PWB

API # 05-123-40884

Plot reference wellpath is MOSER H22-735 (REV-B.0) PWP	
True vertical depths are referenced to H&P 321 (RKB)	Grid System: NAD83 / Lambert Colorado SP, Northern Zone (501), US feet
Measured depths are referenced to H&P 321 (RKB)	North Reference: Grid north
H&P 321 (RKB) to Mean Sea Level: 4841 feet	Scale: True distance
Mean Sea Level to Mud line (At Slot: SLOT#29 MOSER H22-735 (345'FNL & 1913'FEL, SEC.27)): 0 feet	Depths are in feet
Coordinates are in feet referenced to Slot	Created by: adamkat on 2/1/2016

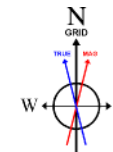

BGGM (1945.0 to 2017.0) Dip: 66.82° Field: 52488.9 nT
 Magnetic North is 8.44 degrees East of True North (at 12/14/2015)
 Grid North is 0.55 degrees East of True North
 To correct azimuth from True to Grid subtract 0.55 degrees
 To correct azimuth from Magnetic to Grid add 7.89 degrees

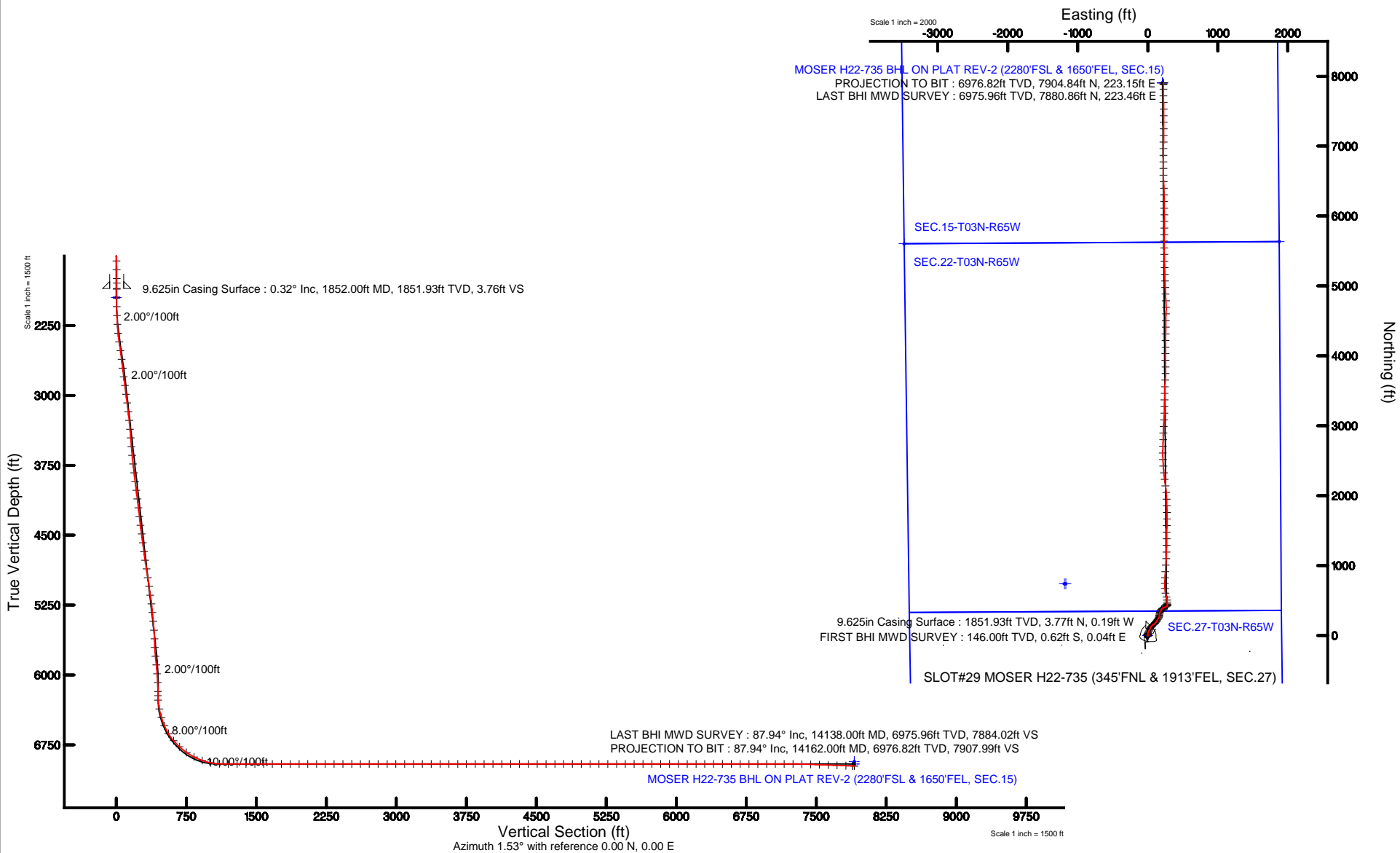

Actual Wellpath Report

MOSER H22-735 AWP

Page 1 of 7

REFERENCE WELLPATH IDENTIFICATION			
Operator	NOBLE ENERGY, INC	Slot	SLOT#29 MOSER H22-735 (345'FNL & 1913'FEL, SEC.27)
Area	COLORADO	Well	MOSER H22-735
Field	WELD COUNTY (NOBLE NAD 83 GRID)	Wellbore	MOSER H22-735 AWB
Facility	SEC.27-T03N-R65W		

REPORT SETUP INFORMATION			
Projection System	NAD83 / Lambert Colorado SP, Northern Zone (501), US feet	Software System	WellArchitect® 4.1.1
North Reference	Grid	User	Adamkat
Scale	0.999957	Report Generated	2/1/2016 at 8:52:44 AM
Convergence at slot	0.55° East	Database/Source file	WA_DEN_Denver_Defn/MOSER_H22-735_AWB.xml

WELLPATH LOCATION						
	Local coordinates		Grid coordinates		Geographic coordinates	
	North[ft]	East[ft]	Easting[US ft]	Northing[US ft]	Latitude	Longitude
Slot Location	228.92	-1456.76	3238231.91	1317831.74	40°12'09.720"N	104°38'49.524"W
Facility Reference Pt			3239688.60	1317602.82	40°12'07.319"N	104°38'30.779"W
Field Reference Pt			3000000.00	4454105.15	48°46'34.315"N	105°30'00.000"W

WELLPATH DATUM			
Calculation method	Minimum curvature	H&P 321 (RKB) to Facility Vertical Datum	4841.00ft
Horizontal Reference Pt	Slot	H&P 321 (RKB) to Mean Sea Level	4841.00ft
Vertical Reference Pt	H&P 321 (RKB)	H&P 321 (RKB) to Mud Line at Slot (SLOT#29 MOSER H22-735 (345'FNL & 1913'FEL, SEC.27))	4841.00ft
MD Reference Pt	H&P 321 (RKB)	Section Origin	N 0.00, E 0.00 ft
Field Vertical Reference	Mean Sea Level	Section Azimuth	1.53°



Actual Wellpath Report

MOSER H22-735 AWP

Page 2 of 7



REFERENCE WELLPATH IDENTIFICATION			
Operator	NOBLE ENERGY, INC	Slot	SLOT#29 MOSER H22-735 (345'FNL & 1913'FEL, SEC.27)
Area	COLORADO	Well	MOSER H22-735
Field	WELD COUNTY (NOBLE NAD 83 GRID)	Wellbore	MOSER H22-735 AWB
Facility	SEC.27-T03N-R65W		

WELLPATH DATA (153 stations)										
MD [ft]	Inclination [°]	Azimuth [°]	TVD [ft]	Vert Sect [ft]	North [ft]	East [ft]	Latitude	Longitude	DLS [°/100ft]	Comments
0.00	0.000	176.720	0.00	0.00	0.00	0.00	40°12'09.720"N	104°38'49.524"W	0.00	
146.00	0.490	176.720	146.00	-0.62	-0.62	0.04	40°12'09.714"N	104°38'49.524"W	0.34	FIRST BHI MWD SURVEY
235.00	0.650	178.870	234.99	-1.51	-1.51	0.07	40°12'09.705"N	104°38'49.523"W	0.18	
327.00	0.970	163.250	326.98	-2.77	-2.78	0.30	40°12'09.693"N	104°38'49.520"W	0.42	
422.00	0.110	224.260	421.98	-3.60	-3.61	0.47	40°12'09.684"N	104°38'49.518"W	0.97	
517.00	0.190	255.120	516.98	-3.71	-3.72	0.25	40°12'09.683"N	104°38'49.521"W	0.12	
612.00	0.340	209.410	611.98	-4.00	-4.00	-0.04	40°12'09.680"N	104°38'49.525"W	0.26	
706.00	0.180	234.790	705.98	-4.34	-4.33	-0.29	40°12'09.677"N	104°38'49.528"W	0.21	
801.00	0.570	46.210	800.98	-4.09	-4.09	-0.07	40°12'09.680"N	104°38'49.525"W	0.79	
896.00	0.490	32.290	895.97	-3.41	-3.42	0.48	40°12'09.686"N	104°38'49.518"W	0.16	
990.00	0.310	40.410	989.97	-2.86	-2.89	0.86	40°12'09.691"N	104°38'49.513"W	0.20	
1085.00	0.390	22.490	1084.97	-2.36	-2.39	1.15	40°12'09.696"N	104°38'49.509"W	0.14	
1179.00	0.460	13.650	1178.97	-1.69	-1.73	1.36	40°12'09.703"N	104°38'49.507"W	0.10	
1274.00	0.610	8.900	1273.96	-0.82	-0.86	1.53	40°12'09.711"N	104°38'49.504"W	0.16	
1369.00	0.490	3.610	1368.96	0.09	0.05	1.64	40°12'09.720"N	104°38'49.503"W	0.14	
1463.00	0.660	11.040	1462.95	1.03	0.98	1.77	40°12'09.730"N	104°38'49.501"W	0.20	
1558.00	0.520	347.330	1557.95	1.98	1.94	1.78	40°12'09.739"N	104°38'49.501"W	0.29	
1653.00	0.630	331.830	1652.94	2.85	2.82	1.43	40°12'09.748"N	104°38'49.505"W	0.20	
1747.00	0.770	304.310	1746.94	3.65	3.63	0.67	40°12'09.756"N	104°38'49.515"W	0.38	
1794.00	0.480	267.850	1793.93	3.80	3.80	0.21	40°12'09.758"N	104°38'49.521"W	1.02	
1859.00	0.300	260.020	1858.93	3.75	3.76	-0.23	40°12'09.757"N	104°38'49.526"W	0.29	
1954.00	0.130	258.540	1953.93	3.68	3.70	-0.58	40°12'09.757"N	104°38'49.531"W	0.18	
2049.00	0.870	11.060	2048.93	4.37	4.38	-0.55	40°12'09.763"N	104°38'49.530"W	0.98	
2143.00	1.760	356.940	2142.90	6.51	6.52	-0.49	40°12'09.785"N	104°38'49.529"W	1.00	
2238.00	3.680	2.180	2237.79	11.01	11.03	-0.45	40°12'09.829"N	104°38'49.528"W	2.04	
2333.00	5.890	5.380	2332.45	18.92	18.93	0.13	40°12'09.907"N	104°38'49.520"W	2.34	
2427.00	8.200	12.700	2425.74	30.31	30.27	2.05	40°12'10.019"N	104°38'49.494"W	2.63	
2522.00	7.980	15.910	2519.79	43.35	43.22	5.35	40°12'10.147"N	104°38'49.450"W	0.53	
2617.00	7.890	29.840	2613.89	55.48	55.22	10.40	40°12'10.265"N	104°38'49.383"W	2.02	
2711.00	8.760	34.160	2706.90	67.19	66.74	17.63	40°12'10.378"N	104°38'49.289"W	1.14	
2806.00	8.450	27.870	2800.84	79.54	78.90	24.96	40°12'10.497"N	104°38'49.193"W	1.04	
2900.00	8.030	22.320	2893.87	91.86	91.08	30.68	40°12'10.617"N	104°38'49.117"W	0.96	
2995.00	7.870	23.230	2987.95	104.11	103.19	35.76	40°12'10.736"N	104°38'49.050"W	0.21	
3089.00	7.830	26.860	3081.07	115.88	114.82	41.19	40°12'10.851"N	104°38'48.979"W	0.53	
3184.00	7.750	33.080	3175.20	127.19	125.96	47.61	40°12'10.960"N	104°38'48.895"W	0.89	
3278.00	7.720	41.470	3268.35	137.43	136.00	55.26	40°12'11.059"N	104°38'48.795"W	1.20	
3373.00	7.670	51.080	3362.49	146.44	144.76	64.41	40°12'11.144"N	104°38'48.676"W	1.35	
3468.00	8.220	58.880	3456.59	154.21	152.26	75.16	40°12'11.217"N	104°38'48.537"W	1.27	
3562.00	7.890	57.260	3549.66	161.47	159.22	86.34	40°12'11.285"N	104°38'48.392"W	0.43	
3657.00	8.170	51.090	3643.73	169.52	166.99	97.08	40°12'11.361"N	104°38'48.252"W	0.95	
3751.00	8.510	40.480	3736.74	179.27	176.47	106.79	40°12'11.454"N	104°38'48.126"W	1.67	
3846.00	8.110	36.980	3830.74	190.19	187.17	115.38	40°12'11.559"N	104°38'48.014"W	0.68	
3941.00	7.970	34.820	3924.81	201.16	197.93	123.18	40°12'11.664"N	104°38'47.912"W	0.35	
4036.00	8.120	28.290	4018.88	212.65	209.25	130.12	40°12'11.775"N	104°38'47.821"W	0.97	
4130.00	8.120	28.920	4111.93	224.48	220.90	136.47	40°12'11.890"N	104°38'47.738"W	0.09	



Actual Wellpath Report

MOSER H22-735 AWP

Page 3 of 7



REFERENCE WELLPATH IDENTIFICATION			
Operator	NOBLE ENERGY, INC	Slot	SLOT#29 MOSER H22-735 (345'FNL & 1913'FEL, SEC.27)
Area	COLORADO	Well	MOSER H22-735
Field	WELD COUNTY (NOBLE NAD 83 GRID)	Wellbore	MOSER H22-735 AWP
Facility	SEC.27-T03N-R65W		

WELLPATH DATA (153 stations)										
MD [ft]	Inclination [°]	Azimuth [°]	TVD [ft]	Vert Sect [ft]	North [ft]	East [ft]	Latitude	Longitude	DLS [°/100ft]	Comments
4225.00	8.220	35.930	4205.97	236.04	232.27	143.70	40°12'12.002"N	104°38'47.643"W	1.05	
4320.00	8.020	33.980	4300.02	247.23	243.27	151.39	40°12'12.109"N	104°38'47.543"W	0.36	
4414.00	7.750	29.010	4393.13	258.39	254.25	158.13	40°12'12.217"N	104°38'47.455"W	0.78	
4509.00	7.680	15.830	4487.28	270.23	265.96	162.97	40°12'12.333"N	104°38'47.391"W	1.86	
4604.00	7.740	2.050	4581.43	282.78	278.46	164.93	40°12'12.456"N	104°38'47.364"W	1.94	
4699.00	7.590	4.010	4675.58	295.44	291.11	165.60	40°12'12.581"N	104°38'47.354"W	0.32	
4793.00	8.450	13.120	4768.66	308.41	304.03	167.60	40°12'12.708"N	104°38'47.326"W	1.63	
4888.00	8.960	13.910	4862.57	322.47	318.01	170.96	40°12'12.846"N	104°38'47.281"W	0.55	
4983.00	9.010	20.460	4956.41	336.74	332.16	175.34	40°12'12.986"N	104°38'47.223"W	1.08	
5077.00	9.230	29.730	5049.22	350.34	345.61	181.65	40°12'13.118"N	104°38'47.140"W	1.58	
5172.00	8.990	30.820	5143.02	363.53	358.60	189.23	40°12'13.245"N	104°38'47.041"W	0.31	
5267.00	8.050	32.500	5236.97	375.71	370.58	196.61	40°12'13.363"N	104°38'46.944"W	1.02	
5361.00	7.750	36.390	5330.08	386.55	381.23	203.91	40°12'13.468"N	104°38'46.849"W	0.65	
5456.00	8.120	54.920	5424.19	395.81	390.25	213.20	40°12'13.556"N	104°38'46.728"W	2.71	
5551.00	8.450	62.230	5518.20	403.23	397.36	224.87	40°12'13.625"N	104°38'46.577"W	1.16	
5646.00	8.380	77.770	5612.19	408.30	402.07	237.81	40°12'13.670"N	104°38'46.409"W	2.39	
5740.00	9.870	77.550	5705.00	411.87	405.26	252.37	40°12'13.701"N	104°38'46.221"W	1.59	
5835.00	8.850	46.750	5798.79	418.99	412.03	265.65	40°12'13.766"N	104°38'46.049"W	5.31	
5930.00	7.610	47.430	5892.81	428.52	421.29	275.61	40°12'13.857"N	104°38'45.920"W	1.31	
6024.00	5.090	29.070	5986.23	436.55	429.15	282.22	40°12'13.934"N	104°38'45.834"W	3.41	
6119.00	4.190	313.430	6081.00	442.61	435.22	281.75	40°12'13.994"N	104°38'45.839"W	6.03	
6214.00	1.960	285.580	6175.86	445.32	438.05	277.66	40°12'14.022"N	104°38'45.891"W	2.76	
6261.00	0.290	117.380	6222.85	445.46	438.21	276.99	40°12'14.024"N	104°38'45.900"W	4.78	
6308.00	3.860	2.070	6269.82	446.99	439.73	277.16	40°12'14.039"N	104°38'45.898"W	8.49	
6403.00	12.230	2.950	6363.80	460.28	453.00	277.79	40°12'14.170"N	104°38'45.888"W	8.81	
6497.00	15.900	359.690	6454.97	483.11	475.83	278.23	40°12'14.395"N	104°38'45.879"W	3.99	
6592.00	22.780	354.040	6544.56	514.39	507.18	276.25	40°12'14.705"N	104°38'45.901"W	7.50	
6687.00	32.400	344.490	6628.70	557.08	550.11	267.51	40°12'15.131"N	104°38'46.008"W	11.12	
6782.00	42.310	348.050	6704.13	612.65	606.07	254.05	40°12'15.685"N	104°38'46.175"W	10.67	
6876.00	47.310	357.950	6770.88	678.02	671.67	246.25	40°12'16.334"N	104°38'46.267"W	9.12	
6971.00	53.970	0.620	6831.10	751.36	745.06	245.41	40°12'17.059"N	104°38'46.269"W	7.34	
7066.00	63.960	2.570	6880.02	832.65	826.32	247.75	40°12'17.862"N	104°38'46.229"W	10.66	
7161.00	70.090	3.330	6917.08	920.05	913.62	252.26	40°12'18.724"N	104°38'46.160"W	6.49	
7256.00	78.850	4.250	6942.49	1011.42	1004.86	258.32	40°12'19.625"N	104°38'46.070"W	9.27	
7350.00	88.370	3.410	6952.94	1104.65	1097.96	264.55	40°12'20.544"N	104°38'45.978"W	10.17	
7445.00	89.850	1.320	6954.42	1199.62	1192.86	268.47	40°12'21.482"N	104°38'45.916"W	2.70	
7540.00	89.880	0.140	6954.64	1294.61	1287.85	269.68	40°12'22.420"N	104°38'45.889"W	1.24	
7634.00	89.940	0.760	6954.79	1388.59	1381.85	270.41	40°12'23.349"N	104°38'45.868"W	0.66	
7729.00	89.820	1.030	6954.99	1483.59	1476.84	271.90	40°12'24.288"N	104°38'45.837"W	0.31	
7824.00	89.910	0.650	6955.21	1578.58	1571.83	273.29	40°12'25.226"N	104°38'45.807"W	0.41	
7918.00	89.780	0.560	6955.47	1672.57	1665.82	274.28	40°12'26.155"N	104°38'45.782"W	0.17	
8013.00	90.250	359.470	6955.44	1767.53	1760.82	274.31	40°12'27.093"N	104°38'45.770"W	1.25	
8108.00	90.220	358.690	6955.05	1862.44	1855.81	272.78	40°12'28.032"N	104°38'45.778"W	0.82	
8203.00	90.400	357.580	6954.54	1957.27	1950.75	269.69	40°12'28.971"N	104°38'45.806"W	1.18	
8298.00	90.000	354.760	6954.21	2051.85	2045.53	263.35	40°12'29.908"N	104°38'45.876"W	3.00	



Actual Wellpath Report

MOSER H22-735 AWP

Page 4 of 7



REFERENCE WELLPATH IDENTIFICATION			
Operator	NOBLE ENERGY, INC	Slot	SLOT#29 MOSER H22-735 (345'FNL & 1913'FEL, SEC.27)
Area	COLORADO	Well	MOSER H22-735
Field	WELD COUNTY (NOBLE NAD 83 GRID)	Wellbore	MOSER H22-735 AWB
Facility	SEC.27-T03N-R65W		

WELLPATH DATA (153 stations)										
MD [ft]	Inclination [°]	Azimuth [°]	TVD [ft]	Vert Sect [ft]	North [ft]	East [ft]	Latitude	Longitude	DLS [°/100ft]	Comments
8392.00	90.000	352.940	6954.21	2145.00	2138.99	253.28	40°12'30.832"N	104°38'45.995"W	1.94	
8487.00	90.150	352.440	6954.08	2238.87	2233.21	241.19	40°12'31.765"N	104°38'46.139"W	0.55	
8582.00	90.030	354.560	6953.93	2332.93	2327.60	230.44	40°12'32.698"N	104°38'46.265"W	2.24	
8677.00	90.000	356.190	6953.91	2427.38	2422.28	222.78	40°12'33.635"N	104°38'46.352"W	1.72	
8772.00	90.090	357.360	6953.83	2522.05	2517.13	217.43	40°12'34.572"N	104°38'46.410"W	1.24	
8866.00	89.720	0.510	6953.99	2615.94	2611.10	215.68	40°12'35.501"N	104°38'46.420"W	3.37	
8961.00	89.910	1.890	6954.30	2710.94	2706.08	217.67	40°12'36.439"N	104°38'46.383"W	1.47	
9056.00	90.000	1.220	6954.37	2805.94	2801.04	220.25	40°12'37.378"N	104°38'46.338"W	0.71	
9151.00	90.000	1.970	6954.37	2900.93	2896.01	222.90	40°12'38.316"N	104°38'46.292"W	0.79	
9245.00	89.970	3.060	6954.40	2994.92	2989.91	227.02	40°12'39.243"N	104°38'46.227"W	1.16	
9340.00	89.850	3.670	6954.55	3089.87	3084.75	232.60	40°12'40.180"N	104°38'46.144"W	0.65	
9435.00	90.030	1.750	6954.65	3184.85	3179.64	237.09	40°12'41.117"N	104°38'46.074"W	2.03	
9529.00	89.850	0.440	6954.74	3278.84	3273.62	238.88	40°12'42.046"N	104°38'46.039"W	1.41	
9624.00	89.940	0.710	6954.92	3373.83	3368.62	239.84	40°12'42.984"N	104°38'46.015"W	0.30	
9718.00	90.000	0.010	6954.97	3467.81	3462.61	240.43	40°12'43.913"N	104°38'45.996"W	0.75	
9813.00	89.910	3.780	6955.04	3562.79	3557.54	243.57	40°12'44.851"N	104°38'45.944"W	3.97	
9908.00	89.820	4.400	6955.27	3657.69	3652.30	250.35	40°12'45.786"N	104°38'45.844"W	0.66	
10002.00	89.910	1.100	6955.49	3751.66	3746.18	254.85	40°12'46.714"N	104°38'45.775"W	3.51	
10097.00	90.090	359.040	6955.49	3846.62	3841.17	254.97	40°12'47.652"N	104°38'45.761"W	2.18	
10192.00	90.000	358.240	6955.41	3941.50	3936.15	252.72	40°12'48.591"N	104°38'45.779"W	0.85	
10287.00	90.030	1.900	6955.39	4036.45	4031.13	252.83	40°12'49.530"N	104°38'45.765"W	3.85	
10381.00	90.030	0.460	6955.34	4130.45	4125.11	254.77	40°12'50.458"N	104°38'45.729"W	1.53	
10476.00	90.000	0.260	6955.31	4225.43	4220.11	255.36	40°12'51.397"N	104°38'45.709"W	0.21	
10571.00	89.940	0.600	6955.36	4320.41	4315.10	256.08	40°12'52.335"N	104°38'45.688"W	0.36	
10665.00	90.000	0.540	6955.41	4414.40	4409.10	257.01	40°12'53.264"N	104°38'45.665"W	0.09	
10760.00	90.000	0.310	6955.41	4509.38	4504.10	257.72	40°12'54.203"N	104°38'45.644"W	0.24	
10855.00	89.850	3.500	6955.54	4604.37	4599.03	260.88	40°12'55.141"N	104°38'45.591"W	3.36	
10949.00	90.220	358.860	6955.48	4698.34	4692.99	262.81	40°12'56.069"N	104°38'45.555"W	4.95	
11044.00	89.940	356.810	6955.35	4793.13	4787.91	259.22	40°12'57.007"N	104°38'45.589"W	2.18	
11139.00	90.000	356.880	6955.40	4887.82	4882.77	253.99	40°12'57.945"N	104°38'45.645"W	0.10	
11233.00	89.970	357.870	6955.42	4981.57	4976.67	249.69	40°12'58.873"N	104°38'45.689"W	1.05	
11328.00	89.970	358.750	6955.47	5076.42	5071.63	246.89	40°12'59.812"N	104°38'45.713"W	0.93	
11422.00	90.060	358.170	6955.45	5170.28	5165.59	244.36	40°13'00.741"N	104°38'45.734"W	0.62	
11517.00	90.120	357.990	6955.30	5265.11	5260.54	241.18	40°13'01.679"N	104°38'45.763"W	0.20	
11612.00	90.030	358.550	6955.17	5359.95	5355.49	238.31	40°13'02.618"N	104°38'45.788"W	0.60	
11706.00	89.940	359.200	6955.20	5453.85	5449.48	236.46	40°13'03.547"N	104°38'45.800"W	0.70	
11801.00	90.000	359.310	6955.25	5548.78	5544.47	235.23	40°13'04.485"N	104°38'45.804"W	0.13	
11896.00	90.090	0.690	6955.17	5643.74	5639.47	235.23	40°13'05.424"N	104°38'45.793"W	1.46	
11990.00	89.910	1.060	6955.17	5737.73	5733.45	236.66	40°13'06.353"N	104°38'45.762"W	0.44	
12085.00	90.150	0.000	6955.12	5832.72	5828.45	237.54	40°13'07.291"N	104°38'45.739"W	1.14	
12180.00	90.120	0.040	6954.90	5927.69	5923.45	237.58	40°13'08.230"N	104°38'45.727"W	0.05	
12274.00	90.120	359.230	6954.70	6021.63	6017.45	236.98	40°13'09.159"N	104°38'45.723"W	0.86	
12369.00	90.060	358.680	6954.55	6116.54	6112.43	235.24	40°13'10.098"N	104°38'45.734"W	0.58	
12464.00	90.030	359.720	6954.48	6211.46	6207.42	233.92	40°13'11.036"N	104°38'45.739"W	1.10	
12558.00	90.000	359.280	6954.45	6305.40	6301.42	233.10	40°13'11.965"N	104°38'45.738"W	0.47	

Actual Wellpath Report

MOSER H22-735 AWP

Page 5 of 7

REFERENCE WELLPATH IDENTIFICATION

Operator	NOBLE ENERGY, INC	Slot	SLOT#29 MOSER H22-735 (345'FNL & 1913'FEL, SEC.27)
Area	COLORADO	Well	MOSER H22-735
Field	WELD COUNTY (NOBLE NAD 83 GRID)	Wellbore	MOSER H22-735 AWB
Facility	SEC.27-T03N-R65W		

WELLPATH DATA (153 stations)

MD [ft]	Inclination [°]	Azimuth [°]	TVD [ft]	Vert Sect [ft]	North [ft]	East [ft]	Latitude	Longitude	DLS [°/100ft]	Comments
12653.00	90.060	357.940	6954.40	6400.27	6396.38	230.79	40°13'12.904"N	104°38'45.756"W	1.41	
12747.00	89.780	357.670	6954.53	6494.07	6490.32	227.19	40°13'13.832"N	104°38'45.791"W	0.41	
12842.00	89.970	359.100	6954.74	6588.93	6585.28	224.52	40°13'14.771"N	104°38'45.813"W	1.52	
12937.00	89.750	0.000	6954.97	6683.87	6680.27	223.77	40°13'15.710"N	104°38'45.811"W	0.98	
13032.00	90.060	0.050	6955.13	6778.83	6775.27	223.81	40°13'16.649"N	104°38'45.799"W	0.33	
13126.00	89.880	0.570	6955.18	6872.81	6869.27	224.32	40°13'17.577"N	104°38'45.781"W	0.59	
13221.00	89.940	0.770	6955.33	6967.80	6964.26	225.43	40°13'18.516"N	104°38'45.754"W	0.22	
13315.00	89.850	0.520	6955.50	7061.79	7058.26	226.49	40°13'19.445"N	104°38'45.729"W	0.28	
13410.00	90.090	0.250	6955.55	7156.77	7153.25	227.13	40°13'20.383"N	104°38'45.709"W	0.38	
13504.00	90.120	0.550	6955.38	7250.75	7247.25	227.78	40°13'21.312"N	104°38'45.689"W	0.32	
13599.00	88.520	0.050	6956.51	7345.72	7342.24	228.28	40°13'22.251"N	104°38'45.671"W	1.76	
13693.00	87.720	359.730	6959.59	7439.63	7436.19	228.10	40°13'23.179"N	104°38'45.661"W	0.92	
13787.00	87.910	359.370	6963.17	7533.50	7530.12	227.36	40°13'24.107"N	104°38'45.659"W	0.43	
13882.00	87.940	359.390	6966.61	7628.37	7625.05	226.34	40°13'25.045"N	104°38'45.661"W	0.04	
13977.00	87.880	359.330	6970.08	7723.24	7719.98	225.28	40°13'25.984"N	104°38'45.663"W	0.09	
14071.00	87.910	359.400	6973.53	7817.11	7813.91	224.23	40°13'26.912"N	104°38'45.664"W	0.08	
14138.00	87.940	359.270	6975.96	7884.02	7880.86	223.46	40°13'27.573"N	104°38'45.666"W	0.20	LAST BHI MWD SURVEY
14162.00	87.940	359.270	6976.82	7907.99	7904.84	223.15	40°13'27.811"N	104°38'45.667"W	0.00	PROJECTION TO BIT

HOLE & CASING SECTIONS - Ref Wellbore: MOSER H22-735 AWB Ref Wellpath: MOSER H22-735 AWP

String/Diameter	Start MD [ft]	End MD [ft]	Interval [ft]	Start TVD [ft]	End TVD [ft]	Start N/S [ft]	Start E/W [ft]	End N/S [ft]	End E/W [ft]
13.5in Open Hole	130.00	1860.00	1730.00	130.00	1859.93	-0.49	0.03	3.76	-0.23
9.625in Casing Surface	0.00	1852.00	1852.00	0.00	1851.93	0.00	0.00	3.77	-0.19
8.5in Open Hole	1860.00	14162.00	12302.00	1859.93	6976.82	3.76	-0.23	7904.84	223.15



Actual Wellpath Report

MOSER H22-735 AWP

Page 6 of 7



REFERENCE WELLPATH IDENTIFICATION			
Operator	NOBLE ENERGY, INC	Slot	SLOT#29 MOSER H22-735 (345'FNL & 1913'FEL, SEC.27)
Area	COLORADO	Well	MOSER H22-735
Field	WELD COUNTY (NOBLE NAD 83 GRID)	Wellbore	MOSER H22-735 AWB
Facility	SEC.27-T03N-R65W		

TARGETS								
Name	TVD [ft]	North [ft]	East [ft]	Grid East [US ft]	Grid North [US ft]	Latitude	Longitude	Shape
SEC.15-T03N-R65W	0.00	0.00	0.00	3238231.91	1317831.74	40°12'09.720"N	104°38'49.524"W	polygon
SEC.15-T03N-R65W NE CORNER	0.00	10914.46	1835.62	3240067.45	1328745.71	40°13'57.396"N	104°38'24.504"W	point
SEC.15-T03N-R65W NW CORNER	0.00	10862.88	-3544.52	3234687.55	1328694.13	40°13'57.396"N	104°39'33.876"W	point
SEC.15-T03N-R65W SE CORNER	0.00	5635.91	1878.43	3240110.25	1323467.40	40°13'05.232"N	104°38'24.612"W	point
SEC.15-T03N-R65W SW CORNER	0.00	5602.74	-3480.69	3234751.38	1323434.23	40°13'05.412"N	104°39'33.696"W	point
SEC.22-T03N-R65W	1.00	739.27	-1169.16	3237062.81	1318570.98	40°12'17.136"N	104°39'04.500"W	polygon
SEC.27-T03N-R65W	1.00	739.06	-1191.50	3237040.46	1318570.76	40°12'17.136"N	104°39'04.788"W	polygon
MOSER H22-735 KOP (35' RADII)	1950.00	0.00	0.00	3238231.91	1317831.74	40°12'09.720"N	104°38'49.524"W	circle
MOSER H22-735 BHL ON PLAT REV-1 (2280'FSL & 1650'FEL, SEC.15)	6930.00	7904.08	211.61	3238443.51	1325735.46	40°13'27.804"N	104°38'45.816"W	point
MOSER H22-735 BHL ON PLAT REV-2 (2280'FSL & 1650'FEL, SEC.15)	6955.00	7904.08	211.61	3238443.51	1325735.46	40°13'27.804"N	104°38'45.816"W	point
MOSER H22-735 DRILLING COORIDOR (35'L/R & 8'U/D)	6955.00	7904.08	211.61	3238443.51	1325735.46	40°13'27.804"N	104°38'45.816"W	polygon

WELLPATH COMPOSITION - Ref Wellbore: MOSER H22-735 AWB Ref Wellpath: MOSER H22-735 AWP					
Start MD [ft]	End MD [ft]	Positional Uncertainty Model	Log Name/Comment	Wellbore	
0.00	1794.00	NaviTrak (MagCorr)	BHI MWD NAVITRAK (MAGCORR) SURFACE SURVEYS 13 1/2" HOLE <0 - 1794>	MOSER H22-735 AWB	
1794.00	14138.00	NaviTrak (MagCAD+IFR1)(for 3rd party service for surveys/Halliburton)	BHI MWD NAVITRAK (MAGCAD+IFR) <1794 - 14138>	MOSER H22-735 AWB	
14138.00	14162.00	Blind Drilling (std)	Projection to bit	MOSER H22-735 AWB	



Actual Wellpath Report

MOSER H22-735 AWP

Page 7 of 7



REFERENCE WELLPATH IDENTIFICATION

Operator	NOBLE ENERGY, INC	Slot	SLOT#29 MOSER H22-735 (345'FNL & 1913'FEL, SEC.27)
Area	COLORADO	Well	MOSER H22-735
Field	WELD COUNTY (NOBLE NAD 83 GRID)	Wellbore	MOSER H22-735 AWB
Facility	SEC.27-T03N-R65W		

WELLPATH COMMENTS

MD [ft]	Inclination [°]	Azimuth [°]	TVD [ft]	Comment
146.00	0.490	176.720	146.00	FIRST BHI MWD SURVEY
14138.00	87.940	359.270	6975.96	LAST BHI MWD SURVEY
14162.00	87.940	359.270	6976.82	PROJECTION TO BIT