



Project: Weld County, CO NAD 83  
 Site: Johnson Trust  
 Well: Johnson Trust 1  
 Wellbore: OH  
 Design: Plan 3



**T M**  
 Azimuths to True North  
 Magnetic North: 8.60°  
 Magnetic Field  
 Strength: 52403.3snT  
 Dip Angle: 66.70°  
 Date: 12/29/2015  
 Model: BGGM2015

Plan: Plan 3 (Johnson Trust 1/OH)  
 Created By: Seth Burstad Date: 1-15-2016

### WELL DETAILS: Johnson Trust 1

GL 4928' & KB 24.5' @ 4952.50ft (Patterson 346) 4928.00  
 Northing Easting Latitude Longitude  
 1293440.39 3151083.23 40° 8' 15.446 N 104° 57' 34.628 W

### PROJECT DETAILS: Weld County, CO NAD 83

Geodetic System: US State Plane 1983  
 Datum: North American Datum 1983  
 Ellipsoid: GRS 1980  
 Zone: Colorado Northern Zone  
 System Datum: Mean Sea Level  
 Local North: True

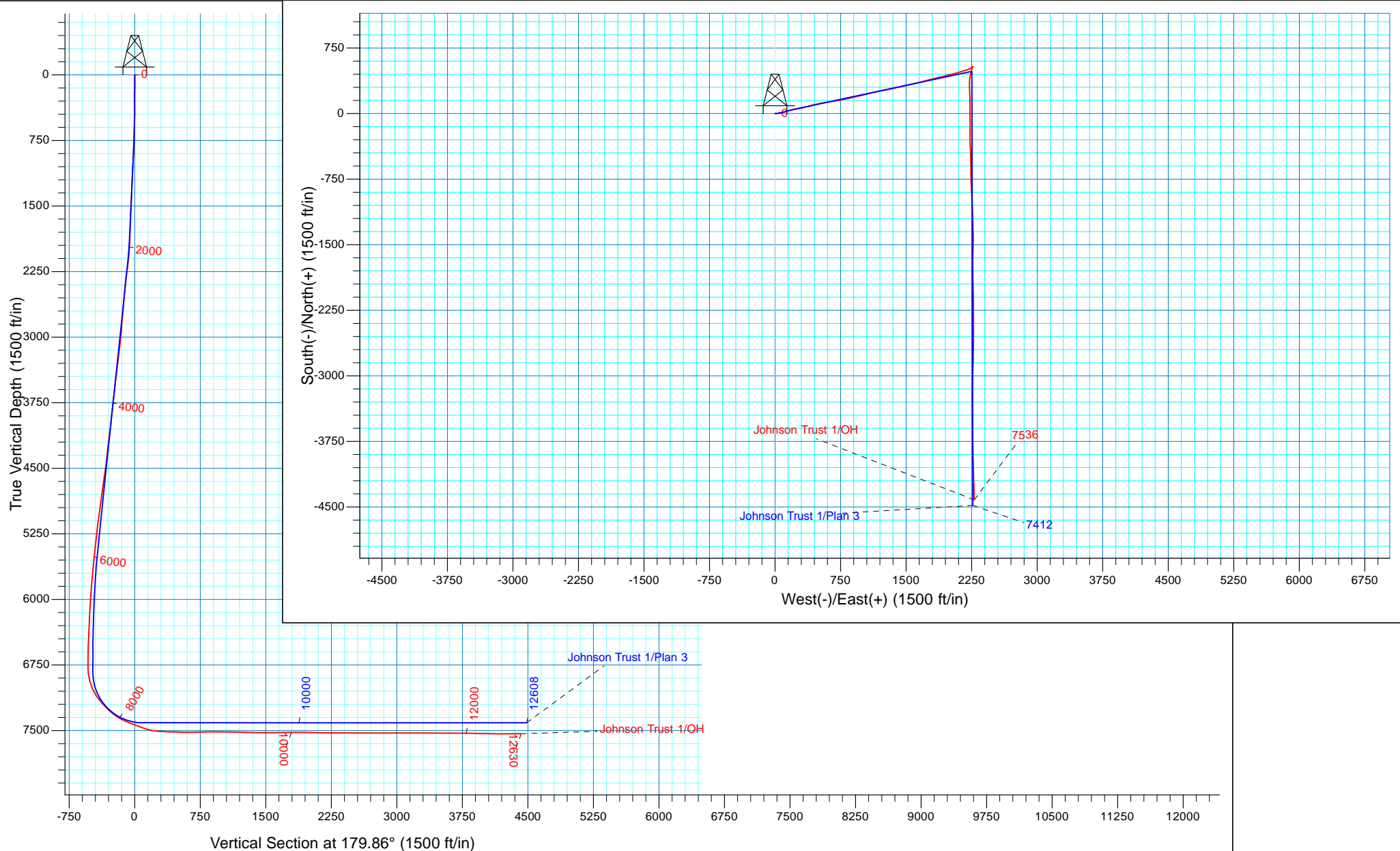



## **Extraction Oil & Gas**

**Weld County, CO NAD 83**

**Johnson Trust**

**Johnson Trust 1**

**OH**

**Design: OH**

## **Standard Survey Report**

**15 January, 2016**



<b>Company:</b>	Extraction Oil & Gas	<b>Local Co-ordinate Reference:</b>	Well Johnson Trust 1
<b>Project:</b>	Weld County, CO NAD 83	<b>TVD Reference:</b>	GL 4928' & KB 24.5' @ 4952.50ft (Patterson 346)
<b>Site:</b>	Johnson Trust	<b>MD Reference:</b>	GL 4928' & KB 24.5' @ 4952.50ft (Patterson 346)
<b>Well:</b>	Johnson Trust 1	<b>North Reference:</b>	True
<b>Wellbore:</b>	OH	<b>Survey Calculation Method:</b>	Minimum Curvature
<b>Design:</b>	OH	<b>Database:</b>	Casper District

<b>Project</b>	Weld County, CO NAD 83		
<b>Map System:</b>	US State Plane 1983	<b>System Datum:</b>	Mean Sea Level
<b>Geo Datum:</b>	North American Datum 1983		
<b>Map Zone:</b>	Colorado Northern Zone		

Site	Johnson Trust, Site Center : Johnson Trust 1				
Site Position:		Northing:	1,293,448.40 usft	Latitude:	40° 8' 15.526 N
From:	Lat/Long	Easting:	3,151,083.18 usft	Longitude:	104° 57' 34.628 W
Position Uncertainty:	0.00 ft	Slot Radius:	13.200 in	Grid Convergence:	0.35 °

Well	Johnson Trust 1, 2257' FSL 389' FWL Sec 13 T2N R68W					
Well Position	+N/-S	0.00 ft	Northing:	1,293,440.40 usft	Latitude:	40° 8' 15.446 N
	+E/-W	0.00 ft	Easting:	3,151,083.23 usft	Longitude:	104° 57' 34.628 W
Position Uncertainty		0.00 ft	Wellhead Elevation:	0.00 ft	Ground Level:	4,928.00 ft

<b>Wellbore</b>	OH				
<b>Magnetics</b>	<b>Model Name</b>	<b>Sample Date</b>	<b>Declination (°)</b>	<b>Dip Angle (°)</b>	<b>Field Strength (nT)</b>
	BGGM2015	12/29/2015	8.60	66.70	52,403

<b>Design</b>	OH				
<b>Audit Notes:</b>					
<b>Version:</b>	1.0	<b>Phase:</b>	ACTUAL	<b>Tie On Depth:</b>	0.00
<b>Vertical Section:</b>	<b>Depth From (TVD) (ft)</b>	<b>+N/-S (ft)</b>	<b>+E/-W (ft)</b>	<b>Direction (°)</b>	
	0.00	0.00	0.00	77.47	

<b>Survey Program</b>	<b>Date</b>	1/15/2016			
<b>From (ft)</b>	<b>To (ft)</b>	<b>Survey (Wellbore)</b>	<b>Tool Name</b>	<b>Description</b>	
142.00	1,476.00	Survey #1 - Surface (OH)	NS-GYRO-MS	North sensing gyrocompassing m/s	
1,664.00	12,630.00	Survey #2 - Vertical / Curve / Lateral (OH)	SDI MWD	SDI MWD - Standard ver 1.0.1	

<b>Survey</b>										
<b>Measured Depth (ft)</b>	<b>Inclination (°)</b>	<b>Azimuth (°)</b>	<b>Vertical Depth (ft)</b>	<b>+N/-S (ft)</b>	<b>+E/-W (ft)</b>	<b>Vertical Section (ft)</b>	<b>Dogleg Rate (°/100ft)</b>	<b>Build Rate (°/100ft)</b>	<b>Turn Rate (°/100ft)</b>	
0.00	0.00	0.00	0.00	0.00	0.00	0.00	0.00	0.00	0.00	
142.00	0.40	0.80	142.00	0.50	0.01	0.11	0.28	0.28	0.00	
237.00	1.10	81.50	236.99	0.96	0.91	1.10	1.17	0.74	84.95	
333.00	3.20	86.10	332.92	1.28	4.50	4.67	2.19	2.19	4.79	
428.00	5.60	90.10	427.63	1.45	11.78	11.81	2.55	2.53	4.21	
523.00	8.10	82.70	521.95	2.30	23.06	23.00	2.79	2.63	-7.79	
618.00	10.60	80.80	615.68	4.54	38.32	38.39	2.65	2.63	-2.00	
714.00	9.80	78.90	710.16	7.53	55.06	55.38	0.90	-0.83	-1.98	

<b>Company:</b>	Extraction Oil & Gas	<b>Local Co-ordinate Reference:</b>	Well Johnson Trust 1
<b>Project:</b>	Weld County, CO NAD 83	<b>TVD Reference:</b>	GL 4928' & KB 24.5' @ 4952.50ft (Patterson 346)
<b>Site:</b>	Johnson Trust	<b>MD Reference:</b>	GL 4928' & KB 24.5' @ 4952.50ft (Patterson 346)
<b>Well:</b>	Johnson Trust 1	<b>North Reference:</b>	True
<b>Wellbore:</b>	OH	<b>Survey Calculation Method:</b>	Minimum Curvature
<b>Design:</b>	OH	<b>Database:</b>	Casper District

Survey									
Measured Depth (ft)	Inclination (°)	Azimuth (°)	Vertical Depth (ft)	+N/-S (ft)	+E/-W (ft)	Vertical Section (ft)	Dogleg Rate (°/100ft)	Build Rate (°/100ft)	Turn Rate (°/100ft)
809.00	9.00	77.90	803.89	10.64	70.26	70.89	0.86	-0.84	-1.05
904.00	11.30	74.90	897.39	14.62	86.51	87.62	2.48	2.42	-3.16
1,000.00	10.40	74.40	991.68	19.41	103.94	105.67	0.94	-0.94	-0.52
1,095.00	9.90	70.20	1,085.19	24.48	119.88	122.33	0.94	-0.53	-4.42
1,190.00	10.00	76.20	1,178.76	29.21	135.57	138.68	1.10	0.11	6.32
1,285.00	10.60	76.70	1,272.23	33.19	152.09	155.67	0.64	0.63	0.53
1,381.00	10.90	79.20	1,366.55	36.92	169.60	173.57	0.58	0.31	2.60
1,476.00	9.90	75.00	1,459.99	40.72	186.31	190.70	1.32	-1.05	-4.42
1,664.00	7.43	67.47	1,645.83	49.56	213.15	218.83	1.44	-1.31	-4.01
First SDI MWD Survey									
1,758.00	10.33	77.09	1,738.70	53.77	226.98	233.24	3.46	3.09	10.23
1,853.00	12.38	86.64	1,831.85	56.27	245.46	251.82	2.92	2.16	10.05
1,948.00	17.46	84.31	1,923.61	58.28	269.82	276.04	5.38	5.35	-2.45
2,042.00	20.84	77.37	2,012.41	63.34	300.18	306.77	4.33	3.60	-7.38
2,137.00	26.05	76.10	2,099.54	72.05	336.95	344.55	5.51	5.48	-1.34
2,231.00	28.84	75.32	2,182.95	82.76	378.92	387.85	2.99	2.97	-0.83
2,326.00	26.58	72.66	2,267.05	94.90	421.38	431.93	2.71	-2.38	-2.80
2,422.00	25.73	77.04	2,353.23	105.98	462.19	474.18	2.20	-0.89	4.56
2,517.00	26.98	80.79	2,438.36	114.05	503.57	516.32	2.19	1.32	3.95
2,612.00	26.89	80.74	2,523.05	120.96	546.04	559.28	0.10	-0.09	-0.05
2,707.00	28.04	79.67	2,607.35	128.42	589.21	603.04	1.32	1.21	-1.13
2,801.00	25.29	78.99	2,691.34	136.22	630.67	645.20	2.94	-2.93	-0.72
2,896.00	26.09	80.48	2,776.95	143.55	671.19	686.34	1.08	0.84	1.57
2,991.00	27.33	81.99	2,861.81	150.04	713.39	728.95	1.49	1.31	1.59
3,085.00	27.98	80.26	2,945.08	156.78	756.49	772.48	1.10	0.69	-1.84
3,180.00	28.42	78.07	3,028.80	165.22	800.57	817.35	1.18	0.46	-2.31
3,275.00	27.58	76.54	3,112.68	175.02	844.08	861.95	1.16	-0.88	-1.61
3,370.00	26.70	75.69	3,197.22	185.41	886.15	905.27	1.01	-0.93	-0.89
3,465.00	27.36	76.39	3,281.84	195.82	928.05	948.43	0.77	0.69	0.74
3,560.00	27.59	79.30	3,366.13	205.04	970.88	992.24	1.43	0.24	3.06
3,654.00	27.86	75.79	3,449.35	214.48	1,013.57	1,035.96	1.76	0.29	-3.73
3,748.00	27.97	75.01	3,532.41	225.57	1,056.15	1,079.94	0.41	0.12	-0.83
3,844.00	27.02	76.62	3,617.57	236.44	1,099.12	1,124.23	1.26	-0.99	1.68
3,939.00	27.93	77.95	3,701.85	246.08	1,141.87	1,168.06	1.16	0.96	1.40
4,033.00	30.05	78.95	3,784.07	255.19	1,186.50	1,213.61	2.31	2.26	1.06
4,128.00	27.31	79.27	3,867.41	263.81	1,231.27	1,259.17	2.89	-2.88	0.34
4,223.00	28.00	78.91	3,951.55	272.15	1,274.56	1,303.25	0.75	0.73	-0.38
4,317.00	30.23	76.72	4,033.67	281.83	1,319.25	1,348.98	2.63	2.37	-2.33
4,412.00	31.03	76.86	4,115.42	292.89	1,366.38	1,397.37	0.85	0.84	0.15
4,507.00	27.78	76.84	4,198.17	303.50	1,411.79	1,444.01	3.42	-3.42	-0.02
4,602.00	25.85	76.50	4,282.95	313.38	1,453.49	1,486.86	2.04	-2.03	-0.36
4,697.00	27.25	79.18	4,367.93	322.30	1,494.99	1,529.31	1.94	1.47	2.82

<b>Company:</b>	Extraction Oil & Gas	<b>Local Co-ordinate Reference:</b>	Well Johnson Trust 1
<b>Project:</b>	Weld County, CO NAD 83	<b>TVD Reference:</b>	GL 4928' & KB 24.5' @ 4952.50ft (Patterson 346)
<b>Site:</b>	Johnson Trust	<b>MD Reference:</b>	GL 4928' & KB 24.5' @ 4952.50ft (Patterson 346)
<b>Well:</b>	Johnson Trust 1	<b>North Reference:</b>	True
<b>Wellbore:</b>	OH	<b>Survey Calculation Method:</b>	Minimum Curvature
<b>Design:</b>	OH	<b>Database:</b>	Casper District

Survey										
Measured Depth (ft)	Inclination (°)	Azimuth (°)	Vertical Depth (ft)	+N/-S (ft)	+E/-W (ft)	Vertical Section (ft)	Dogleg Rate (°/100ft)	Build Rate (°/100ft)	Turn Rate (°/100ft)	
4,791.00	29.95	78.62	4,450.45	330.97	1,539.14	1,574.29	2.89	2.87	-0.60	
4,886.00	31.74	75.43	4,532.02	341.94	1,586.58	1,622.98	2.55	1.88	-3.36	
4,980.00	31.39	75.39	4,612.11	354.33	1,634.20	1,672.15	0.37	-0.37	-0.04	
5,075.00	29.90	75.39	4,693.84	366.55	1,681.06	1,720.54	1.57	-1.57	0.00	
5,169.00	30.47	77.25	4,775.10	377.71	1,726.98	1,767.79	1.17	0.61	1.98	
5,264.00	29.50	75.95	4,857.38	388.71	1,773.16	1,815.26	1.23	-1.02	-1.37	
5,358.00	30.44	76.16	4,938.81	400.02	1,818.73	1,862.20	1.01	1.00	0.22	
5,453.00	29.88	76.00	5,020.95	411.51	1,865.06	1,909.92	0.60	-0.59	-0.17	
5,548.00	26.74	75.76	5,104.58	422.49	1,908.75	1,954.95	3.31	-3.31	-0.25	
5,642.00	26.21	75.49	5,188.72	432.89	1,949.34	1,996.83	0.58	-0.56	-0.29	
5,737.00	24.56	77.08	5,274.55	442.57	1,988.90	2,037.54	1.88	-1.74	1.67	
5,832.00	24.63	76.37	5,360.93	451.64	2,027.38	2,077.08	0.32	0.07	-0.75	
5,927.00	23.17	74.67	5,447.78	461.25	2,064.65	2,115.54	1.70	-1.54	-1.79	
6,021.00	21.76	73.32	5,534.64	471.14	2,099.17	2,151.39	1.60	-1.50	-1.44	
6,117.00	19.11	71.78	5,624.60	481.16	2,131.15	2,184.78	2.82	-2.76	-1.60	
6,211.00	17.09	74.20	5,713.94	489.74	2,159.06	2,213.89	2.29	-2.15	2.57	
6,306.00	14.37	72.43	5,805.38	497.10	2,183.74	2,239.57	2.91	-2.86	-1.86	
6,401.00	11.98	70.58	5,897.87	503.94	2,204.28	2,261.11	2.55	-2.52	-1.95	
6,495.00	9.59	67.56	5,990.20	510.17	2,220.72	2,278.51	2.61	-2.54	-3.21	
6,590.00	7.64	62.38	6,084.13	516.12	2,233.63	2,292.40	2.21	-2.05	-5.45	
6,684.00	5.82	59.64	6,177.48	521.42	2,243.28	2,302.97	1.97	-1.94	-2.91	
6,779.00	4.43	51.44	6,272.09	526.15	2,250.30	2,310.86	1.65	-1.46	-8.63	
6,874.00	3.76	51.23	6,366.85	530.38	2,255.60	2,316.95	0.71	-0.71	-0.22	
6,969.00	2.75	35.34	6,461.70	534.19	2,259.35	2,321.43	1.42	-1.06	-16.73	
7,064.00	1.71	34.79	6,556.63	537.22	2,261.47	2,324.16	1.09	-1.09	-0.58	
7,160.00	1.73	33.26	6,652.58	539.61	2,263.09	2,326.26	0.05	0.02	-1.59	
7,255.00	1.18	41.85	6,747.55	541.53	2,264.53	2,328.08	0.62	-0.58	9.04	
7,351.00	7.34	216.54	6,843.32	537.33	2,261.53	2,324.24	8.87	6.42	181.97	
7,447.00	15.60	194.53	6,937.37	519.87	2,254.62	2,313.71	9.59	8.60	-22.93	
7,541.00	26.11	195.73	7,025.08	487.64	2,245.82	2,298.12	11.19	11.18	1.28	
7,636.00	34.29	192.64	7,107.13	441.32	2,234.28	2,276.80	8.76	8.61	-3.25	
7,732.00	41.13	184.85	7,183.07	383.38	2,225.67	2,255.83	8.67	7.13	-8.11	
7,826.00	45.23	177.82	7,251.64	319.16	2,224.33	2,240.58	6.72	4.36	-7.48	
7,921.00	52.00	176.86	7,314.41	248.01	2,227.67	2,228.39	7.17	7.13	-1.01	
8,016.00	61.41	179.68	7,366.51	168.74	2,229.95	2,213.42	10.21	9.91	2.97	
8,110.00	69.40	179.95	7,405.60	83.33	2,230.22	2,195.15	8.50	8.50	0.29	
8,205.00	68.85	179.44	7,439.45	-5.43	2,230.70	2,176.35	0.77	-0.58	-0.54	
8,299.00	71.09	179.17	7,471.65	-93.73	2,231.77	2,158.23	2.40	2.38	-0.29	
8,394.00	78.96	182.27	7,496.18	-185.41	2,230.57	2,137.16	8.86	8.28	3.26	
8,489.00	85.23	178.01	7,509.25	-279.44	2,230.37	2,116.56	7.95	6.60	-4.48	
8,583.00	88.46	177.84	7,514.42	-373.22	2,233.77	2,099.52	3.44	3.44	-0.18	
8,678.00	88.73	178.26	7,516.75	-468.14	2,237.00	2,082.07	0.53	0.28	0.44	

<b>Company:</b>	Extraction Oil & Gas	<b>Local Co-ordinate Reference:</b>	Well Johnson Trust 1
<b>Project:</b>	Weld County, CO NAD 83	<b>TVD Reference:</b>	GL 4928' & KB 24.5' @ 4952.50ft (Patterson 346)
<b>Site:</b>	Johnson Trust	<b>MD Reference:</b>	GL 4928' & KB 24.5' @ 4952.50ft (Patterson 346)
<b>Well:</b>	Johnson Trust 1	<b>North Reference:</b>	True
<b>Wellbore:</b>	OH	<b>Survey Calculation Method:</b>	Minimum Curvature
<b>Design:</b>	OH	<b>Database:</b>	Casper District

Survey										
Measured Depth (ft)	Inclination (°)	Azimuth (°)	Vertical Depth (ft)	+N/-S (ft)	+E/-W (ft)	Vertical Section (ft)	Dogleg Rate (°/100ft)	Build Rate (°/100ft)	Turn Rate (°/100ft)	
8,773.00	88.76	178.91	7,518.83	-563.09	2,239.34	2,063.76	0.68	0.03	0.68	
8,868.00	90.81	179.11	7,519.19	-658.07	2,240.98	2,044.74	2.17	2.16	0.21	
8,963.00	91.37	178.90	7,517.38	-753.03	2,242.63	2,025.74	0.63	0.59	-0.22	
9,058.00	90.94	177.73	7,515.46	-847.97	2,245.43	2,007.87	1.31	-0.45	-1.23	
9,153.00	89.13	177.85	7,515.41	-942.90	2,249.09	1,990.84	1.91	-1.91	0.13	
9,249.00	89.26	176.90	7,516.76	-1,038.79	2,253.49	1,974.32	1.00	0.14	-0.99	
9,344.00	89.33	177.20	7,517.92	-1,133.65	2,258.37	1,958.50	0.32	0.07	0.32	
9,440.00	88.39	177.33	7,519.83	-1,229.52	2,262.95	1,942.17	0.99	-0.98	0.14	
9,535.00	89.06	179.36	7,521.95	-1,324.46	2,265.70	1,924.24	2.25	0.71	2.14	
9,630.00	89.33	180.03	7,523.28	-1,419.44	2,266.20	1,904.12	0.76	0.28	0.71	
9,725.00	90.10	180.85	7,523.76	-1,514.44	2,265.47	1,882.79	1.18	0.81	0.86	
9,820.00	90.44	180.46	7,523.31	-1,609.43	2,264.39	1,861.11	0.54	0.36	-0.41	
9,915.00	90.57	180.23	7,522.47	-1,704.43	2,263.81	1,839.94	0.28	0.14	-0.24	
10,010.00	90.77	180.03	7,521.36	-1,799.42	2,263.60	1,819.11	0.30	0.21	-0.21	
10,105.00	89.70	179.13	7,520.97	-1,894.41	2,264.30	1,799.17	1.47	-1.13	-0.95	
10,199.00	89.13	178.81	7,521.93	-1,988.39	2,265.99	1,780.42	0.70	-0.61	-0.34	
10,294.00	89.46	179.77	7,523.10	-2,083.38	2,267.16	1,760.96	1.07	0.35	1.01	
10,389.00	89.53	179.08	7,523.94	-2,178.37	2,268.12	1,741.27	0.73	0.07	-0.73	
10,483.00	89.16	178.42	7,525.01	-2,272.34	2,270.17	1,722.88	0.80	-0.39	-0.70	
10,578.00	89.19	179.57	7,526.38	-2,367.31	2,271.83	1,703.89	1.21	0.03	1.21	
10,673.00	88.83	179.85	7,528.02	-2,462.30	2,272.31	1,683.75	0.48	-0.38	0.29	
10,768.00	88.66	181.16	7,530.10	-2,557.27	2,271.48	1,662.32	1.39	-0.18	1.38	
10,864.00	90.67	181.18	7,530.66	-2,653.24	2,269.52	1,639.58	2.09	2.09	0.02	
10,958.00	91.84	181.46	7,528.60	-2,747.19	2,267.35	1,617.07	1.28	1.24	0.30	
11,053.00	89.66	181.25	7,527.36	-2,842.15	2,265.11	1,594.27	2.31	-2.29	-0.22	
11,147.00	90.03	181.71	7,527.61	-2,936.12	2,262.68	1,571.51	0.63	0.39	0.49	
11,242.00	90.47	182.25	7,527.20	-3,031.06	2,259.39	1,547.70	0.73	0.46	0.57	
11,338.00	90.10	180.26	7,526.72	-3,127.03	2,257.29	1,524.81	2.11	-0.39	-2.07	
11,434.00	89.00	180.38	7,527.48	-3,223.03	2,256.76	1,503.46	1.15	-1.15	0.13	
11,529.00	89.30	180.02	7,528.89	-3,318.01	2,256.42	1,482.52	0.49	0.32	-0.38	
11,623.00	89.73	179.34	7,529.68	-3,412.01	2,256.95	1,462.63	0.86	0.46	-0.72	
11,719.00	90.67	180.21	7,529.35	-3,508.01	2,257.33	1,442.16	1.33	0.98	0.91	
11,813.00	89.60	179.30	7,529.12	-3,602.00	2,257.73	1,422.16	1.49	-1.14	-0.97	
11,908.00	89.60	178.29	7,529.79	-3,696.98	2,259.73	1,403.49	1.06	0.00	-1.06	
12,003.00	89.80	178.00	7,530.28	-3,791.93	2,262.80	1,385.89	0.37	0.21	-0.31	
12,098.00	88.76	179.05	7,531.48	-3,886.89	2,265.25	1,367.67	1.56	-1.09	1.11	
12,192.00	88.55	179.01	7,533.68	-3,980.85	2,266.84	1,348.83	0.23	-0.22	-0.04	
12,287.00	88.89	178.20	7,535.81	-4,075.79	2,269.15	1,330.48	0.92	0.36	-0.85	
12,381.00	89.53	178.38	7,537.10	-4,169.74	2,271.95	1,312.82	0.71	0.68	0.19	
12,476.00	90.17	178.54	7,537.35	-4,264.71	2,274.51	1,294.71	0.69	0.67	0.17	
12,571.00	90.75	178.14	7,536.59	-4,359.66	2,277.26	1,276.78	0.74	0.61	-0.42	
Last SDI MWD Survey										

<b>Company:</b>	Extraction Oil & Gas	<b>Local Co-ordinate Reference:</b>	Well Johnson Trust 1
<b>Project:</b>	Weld County, CO NAD 83	<b>TVD Reference:</b>	GL 4928' & KB 24.5' @ 4952.50ft (Patterson 346)
<b>Site:</b>	Johnson Trust	<b>MD Reference:</b>	GL 4928' & KB 24.5' @ 4952.50ft (Patterson 346)
<b>Well:</b>	Johnson Trust 1	<b>North Reference:</b>	True
<b>Wellbore:</b>	OH	<b>Survey Calculation Method:</b>	Minimum Curvature
<b>Design:</b>	OH	<b>Database:</b>	Casper District

Survey									
Measured Depth (ft)	Inclination (°)	Azimuth (°)	Vertical Depth (ft)	+N/-S (ft)	+E/-W (ft)	Vertical Section (ft)	Dogleg Rate (°/100ft)	Build Rate (°/100ft)	Turn Rate (°/100ft)
12,630.00	90.75	178.14	7,535.82	-4,418.63	2,279.17	1,265.85	0.00	0.00	0.00
Projection to TD									

Design Annotations				
Measured Depth (ft)	Vertical Depth (ft)	Local Coordinates		Comment
		+N/-S (ft)	+E/-W (ft)	
1,664.00	1,645.83	49.56	213.15	First SDI MWD Survey
12,571.00	7,536.59	-4,359.66	2,277.26	Last SDI MWD Survey
12,630.00	7,535.82	-4,418.63	2,279.17	Projection to TD

Checked By: _____	Approved By: _____	Date: _____
-------------------	--------------------	-------------