

PROJECT DETAILS: Weld County, CO NAD 83

Geodetic System: US State Plane 1983  
 Datum: North American Datum 1983  
 Ellipsoid: GRS 1980  
 Zone: Colorado Northern Zone  
 System Datum: Mean Sea Level  
 Local North: True

Project: Weld County, CO NAD 83  
 Site: SRC Smith  
 Well: SRC Smith 33-23-26C  
 Wellbore: OH  
 Design: Plan 1

Plan: Plan 1 (SRC Smith 33-23-26C/OH)

Created By: Seth Burstad Date: 11-17-2015



Azimuths to True North  
 Magnetic North: 8.19°

Magnetic Field  
 Strength: 52862.5nT  
 Dip Angle: 67.40°  
 Date: 11/17/2015  
 Model: BGGM2015

SECTION DETAILS

| MD       | Inc   | Azi    | TVD     | +N/-S    | +E/-W    | Dleg | TFace  | VSect   |
|----------|-------|--------|---------|----------|----------|------|--------|---------|
| 0.00     | 0.00  | 0.00   | 0.00    | 0.00     | 0.00     | 0.00 | 0.00   | 0.00    |
| 250.00   | 0.00  | 0.00   | 250.00  | 0.00     | 0.00     | 0.00 | 0.00   | 0.00    |
| 1137.97  | 17.76 | 276.15 | 1123.82 | 14.62    | -135.74  | 2.00 | 276.15 | -13.29  |
| 5543.66  | 17.76 | 276.15 | 5319.56 | 158.51   | -1471.84 | 0.00 | 0.00   | -144.12 |
| 6431.63  | 0.00  | 0.00   | 6193.38 | 173.13   | -1607.58 | 2.00 | 180.00 | -157.41 |
| 7431.63  | 90.00 | 180.56 | 6830.00 | -463.46  | -1613.76 | 9.00 | 180.56 | 479.21  |
| 14109.84 | 90.00 | 180.56 | 6830.00 | -7141.35 | -1678.66 | 0.00 | 0.00   | 7157.42 |

WELL DETAILS: SRC Smith 33-23-26C

|       |       | GL 5075' & KB13' @ 5088.00ft |            | 5075.00         |                  |  |
|-------|-------|------------------------------|------------|-----------------|------------------|--|
| +N/-S | +E/-W | Northing                     | Easting    | Latitude        | Longitude        |  |
| 0.00  | 0.00  | 1544076.73                   | 3369266.52 | 40° 49' 9.285 N | 104° 9' 57.010 W |  |

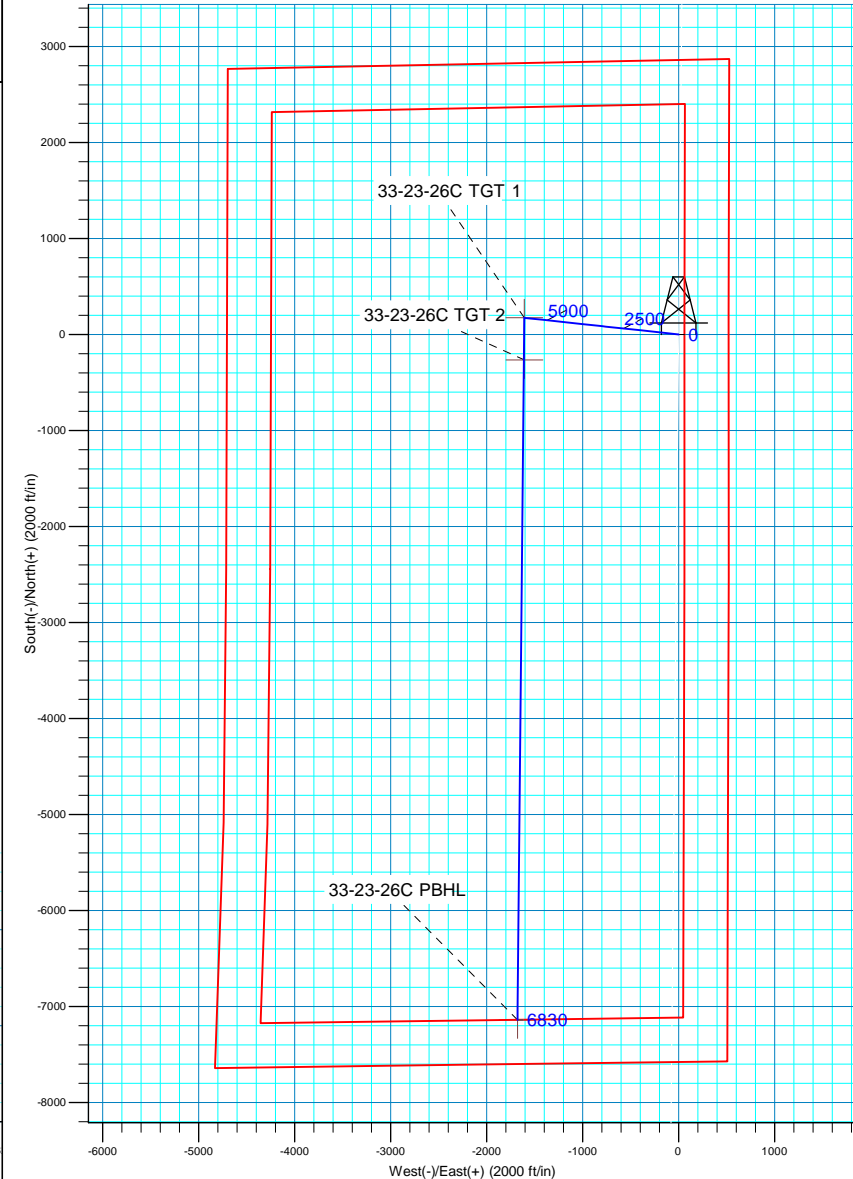
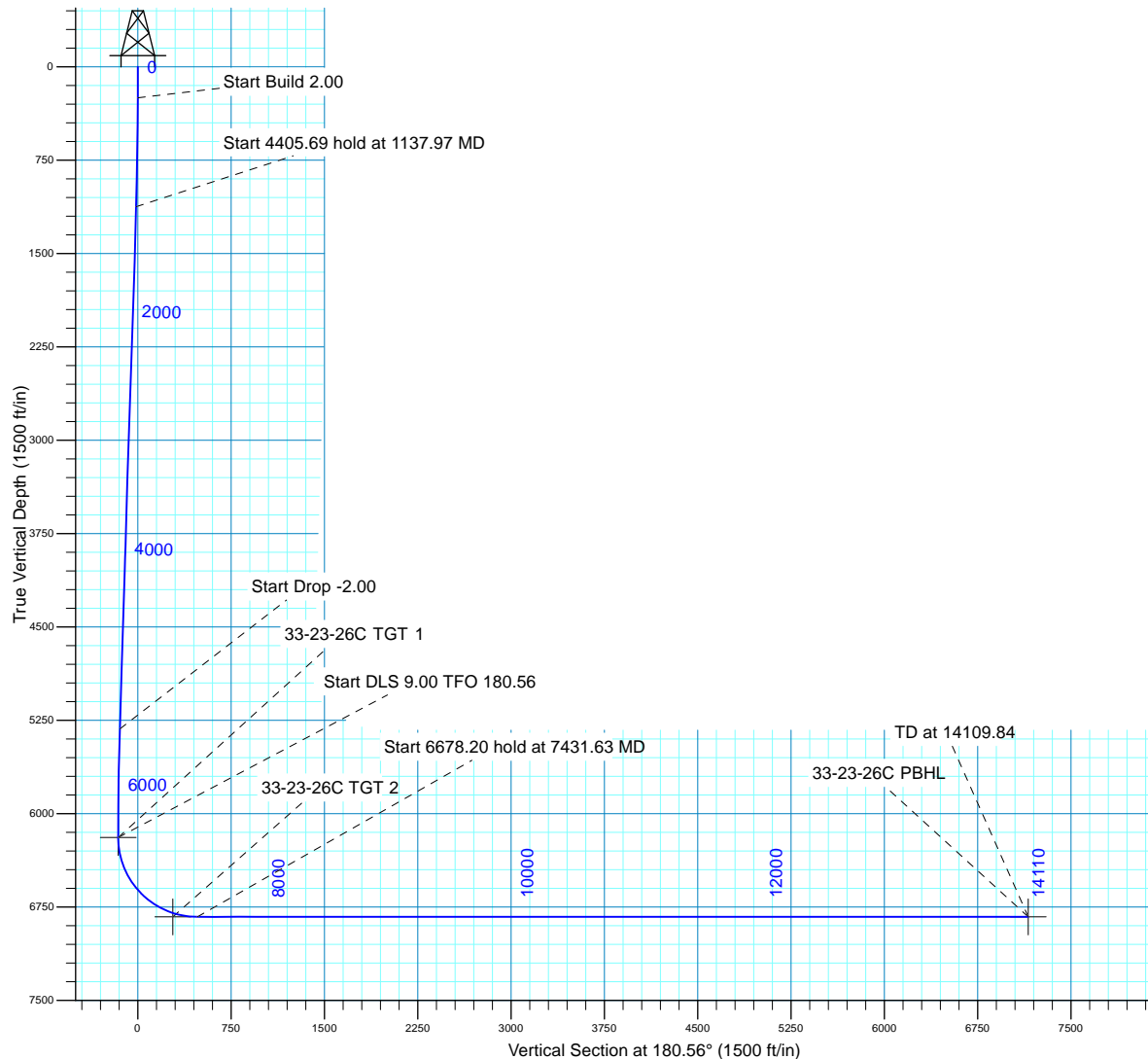



## **Synergy Resources Corp.**

**Weld County, CO NAD 83**

**SRC Smith**

**SRC Smith 33-23-26C**

**OH**

**Plan: Plan 1**

## **Standard Planning Report**

**17 November, 2015**



|                  |                         |                                     |                              |
|------------------|-------------------------|-------------------------------------|------------------------------|
| <b>Database:</b> | Casper District         | <b>Local Co-ordinate Reference:</b> | Well SRC Smith 33-23-26C     |
| <b>Company:</b>  | Synergy Resources Corp. | <b>TVD Reference:</b>               | GL 5075' & KB13' @ 5088.00ft |
| <b>Project:</b>  | Weld County, CO NAD 83  | <b>MD Reference:</b>                | GL 5075' & KB13' @ 5088.00ft |
| <b>Site:</b>     | SRC Smith               | <b>North Reference:</b>             | True                         |
| <b>Well:</b>     | SRC Smith 33-23-26C     | <b>Survey Calculation Method:</b>   | Minimum Curvature            |
| <b>Wellbore:</b> | OH                      |                                     |                              |
| <b>Design:</b>   | Plan 1                  |                                     |                              |

|                    |                           |                      |                |
|--------------------|---------------------------|----------------------|----------------|
| <b>Project</b>     | Weld County, CO NAD 83    |                      |                |
| <b>Map System:</b> | US State Plane 1983       | <b>System Datum:</b> | Mean Sea Level |
| <b>Geo Datum:</b>  | North American Datum 1983 |                      |                |
| <b>Map Zone:</b>   | Colorado Northern Zone    |                      |                |

|                              |                                    |                     |                   |                                    |
|------------------------------|------------------------------------|---------------------|-------------------|------------------------------------|
| <b>Site</b>                  | SRC Smith, Site Center : 44-23-26C |                     |                   |                                    |
| <b>Site Position:</b>        |                                    | <b>Northing:</b>    | 1,544,079.71 usft | <b>Latitude:</b> 40° 49' 9.300 N   |
| <b>From:</b>                 | Lat/Long                           | <b>Easting:</b>     | 3,369,366.68 usft | <b>Longitude:</b> 104° 9' 55.706 W |
| <b>Position Uncertainty:</b> | 0.00 ft                            | <b>Slot Radius:</b> | 13.200 in         | <b>Grid Convergence:</b> 0.86 °    |

|                             |  |                            |                  |                                  |
|-----------------------------|--|----------------------------|------------------|----------------------------------|
| <b>Well</b>                 | SRC Smith 33-23-26C, 2521' FSL 520' FEL Sec 23 T10N R61W |                            |                  |                                  |
| <b>Well Position</b>        | <b>+N/-S</b>   | -1.47 ft                   | <b>Northing:</b> | 1,544,076.74 usft                |
|                             | <b>+E/-W</b>   | -100.20 ft                 | <b>Easting:</b>  | 3,369,266.52 usft                |
| <b>Position Uncertainty</b> | 0.00 ft  | <b>Wellhead Elevation:</b> | 0.00 ft          | <b>Ground Level:</b> 5,075.00 ft |

|                  |                   |                    |                        |                      |                            |
|------------------|-------------------|--------------------|------------------------|----------------------|----------------------------|
| <b>Wellbore</b>  | OH                |                    |                        |                      |                            |
| <b>Magnetics</b> | <b>Model Name</b> | <b>Sample Date</b> | <b>Declination (°)</b> | <b>Dip Angle (°)</b> | <b>Field Strength (nT)</b> |
|                  | BGGM2015          | 11/17/2015         | 8.19                   | 67.40                | 52,863                     |

|                          |                              |                   |                      |                      |
|--------------------------|------------------------------|-------------------|----------------------|----------------------|
| <b>Design</b>            | Plan 1                       |                   |                      |                      |
| <b>Audit Notes:</b>      |                              |                   |                      |                      |
| <b>Version:</b>          | <b>Phase:</b>                | PLAN              | <b>Tie On Depth:</b> | 0.00                 |
| <b>Vertical Section:</b> | <b>Depth From (TVD) (ft)</b> | <b>+N/-S (ft)</b> | <b>+E/-W (ft)</b>    | <b>Direction (°)</b> |
|                          | 0.00                         | 0.00              | 0.00                 | 180.56               |

| <b>Plan Sections</b> |                 |             |                     |            |            |                       |                      |                     |         |                 |
|----------------------|-----------------|-------------|---------------------|------------|------------|-----------------------|----------------------|---------------------|---------|-----------------|
| Measured Depth (ft)  | Inclination (°) | Azimuth (°) | Vertical Depth (ft) | +N/-S (ft) | +E/-W (ft) | Dogleg Rate (°/100ft) | Build Rate (°/100ft) | Turn Rate (°/100ft) | TFO (°) | Target          |
| 0.00                 | 0.00            | 0.00        | 0.00                | 0.00       | 0.00       | 0.00                  | 0.00                 | 0.00                | 0.00    |                 |
| 250.00               | 0.00            | 0.00        | 250.00              | 0.00       | 0.00       | 0.00                  | 0.00                 | 0.00                | 0.00    |                 |
| 1,137.97             | 17.76           | 276.15      | 1,123.82            | 14.62      | -135.74    | 2.00                  | 2.00                 | 0.00                | 276.15  |                 |
| 5,543.66             | 17.76           | 276.15      | 5,319.56            | 158.51     | -1,471.84  | 0.00                  | 0.00                 | 0.00                | 0.00    |                 |
| 6,431.63             | 0.00            | 0.00        | 6,193.38            | 173.13     | -1,607.58  | 2.00                  | -2.00                | 0.00                | 180.00  | 33-23-26C TGT 1 |
| 7,431.63             | 90.00           | 180.56      | 6,830.00            | -463.46    | -1,613.76  | 9.00                  | 9.00                 | -17.94              | 180.56  |                 |
| 14,109.84            | 90.00           | 180.56      | 6,830.00            | -7,141.35  | -1,678.66  | 0.00                  | 0.00                 | 0.00                | 0.00    | 33-23-26C PBHL  |

|                  |                         |                                     |                              |
|------------------|-------------------------|-------------------------------------|------------------------------|
| <b>Database:</b> | Casper District         | <b>Local Co-ordinate Reference:</b> | Well SRC Smith 33-23-26C     |
| <b>Company:</b>  | Synergy Resources Corp. | <b>TVD Reference:</b>               | GL 5075' & KB13' @ 5088.00ft |
| <b>Project:</b>  | Weld County, CO NAD 83  | <b>MD Reference:</b>                | GL 5075' & KB13' @ 5088.00ft |
| <b>Site:</b>     | SRC Smith               | <b>North Reference:</b>             | True                         |
| <b>Well:</b>     | SRC Smith 33-23-26C     | <b>Survey Calculation Method:</b>   | Minimum Curvature            |
| <b>Wellbore:</b> | OH                      |                                     |                              |
| <b>Design:</b>   | Plan 1                  |                                     |                              |

| Planned Survey                   |                 |             |                     |            |            |                       |                       |                      |                     |
|----------------------------------|-----------------|-------------|---------------------|------------|------------|-----------------------|-----------------------|----------------------|---------------------|
| Measured Depth (ft)              | Inclination (°) | Azimuth (°) | Vertical Depth (ft) | +N/-S (ft) | +E/-W (ft) | Vertical Section (ft) | Dogleg Rate (°/100ft) | Build Rate (°/100ft) | Turn Rate (°/100ft) |
| 0.00                             | 0.00            | 0.00        | 0.00                | 0.00       | 0.00       | 0.00                  | 0.00                  | 0.00                 | 0.00                |
| 100.00                           | 0.00            | 0.00        | 100.00              | 0.00       | 0.00       | 0.00                  | 0.00                  | 0.00                 | 0.00                |
| 200.00                           | 0.00            | 0.00        | 200.00              | 0.00       | 0.00       | 0.00                  | 0.00                  | 0.00                 | 0.00                |
| 250.00                           | 0.00            | 0.00        | 250.00              | 0.00       | 0.00       | 0.00                  | 0.00                  | 0.00                 | 0.00                |
| Start Build 2.00                 |                 |             |                     |            |            |                       |                       |                      |                     |
| 300.00                           | 1.00            | 276.15      | 300.00              | 0.05       | -0.43      | -0.04                 | 2.00                  | 2.00                 | 0.00                |
| 400.00                           | 3.00            | 276.15      | 399.93              | 0.42       | -3.90      | -0.38                 | 2.00                  | 2.00                 | 0.00                |
| 500.00                           | 5.00            | 276.15      | 499.68              | 1.17       | -10.84     | -1.06                 | 2.00                  | 2.00                 | 0.00                |
| 600.00                           | 7.00            | 276.15      | 599.13              | 2.29       | -21.23     | -2.08                 | 2.00                  | 2.00                 | 0.00                |
| 700.00                           | 9.00            | 276.15      | 698.15              | 3.78       | -35.07     | -3.43                 | 2.00                  | 2.00                 | 0.00                |
| 800.00                           | 11.00           | 276.15      | 796.63              | 5.64       | -52.33     | -5.12                 | 2.00                  | 2.00                 | 0.00                |
| 900.00                           | 13.00           | 276.15      | 894.44              | 7.86       | -73.00     | -7.15                 | 2.00                  | 2.00                 | 0.00                |
| 1,000.00                         | 15.00           | 276.15      | 991.46              | 10.45      | -97.05     | -9.50                 | 2.00                  | 2.00                 | 0.00                |
| 1,100.00                         | 17.00           | 276.15      | 1,087.58            | 13.40      | -124.46    | -12.19                | 2.00                  | 2.00                 | 0.00                |
| 1,137.97                         | 17.76           | 276.15      | 1,123.82            | 14.62      | -135.74    | -13.29                | 2.00                  | 2.00                 | 0.00                |
| Start 4405.69 hold at 1137.97 MD |                 |             |                     |            |            |                       |                       |                      |                     |
| 1,200.00                         | 17.76           | 276.15      | 1,182.89            | 16.64      | -154.55    | -15.13                | 0.00                  | 0.00                 | 0.00                |
| 1,300.00                         | 17.76           | 276.15      | 1,278.13            | 19.91      | -184.87    | -18.10                | 0.00                  | 0.00                 | 0.00                |
| 1,400.00                         | 17.76           | 276.15      | 1,373.36            | 23.18      | -215.20    | -21.07                | 0.00                  | 0.00                 | 0.00                |
| 1,500.00                         | 17.76           | 276.15      | 1,468.60            | 26.44      | -245.53    | -24.04                | 0.00                  | 0.00                 | 0.00                |
| 1,600.00                         | 17.76           | 276.15      | 1,563.83            | 29.71      | -275.85    | -27.01                | 0.00                  | 0.00                 | 0.00                |
| 1,700.00                         | 17.76           | 276.15      | 1,659.07            | 32.97      | -306.18    | -29.98                | 0.00                  | 0.00                 | 0.00                |
| 1,800.00                         | 17.76           | 276.15      | 1,754.30            | 36.24      | -336.51    | -32.95                | 0.00                  | 0.00                 | 0.00                |
| 1,900.00                         | 17.76           | 276.15      | 1,849.54            | 39.51      | -366.83    | -35.92                | 0.00                  | 0.00                 | 0.00                |
| 2,000.00                         | 17.76           | 276.15      | 1,944.77            | 42.77      | -397.16    | -38.89                | 0.00                  | 0.00                 | 0.00                |
| 2,100.00                         | 17.76           | 276.15      | 2,040.00            | 46.04      | -427.49    | -41.86                | 0.00                  | 0.00                 | 0.00                |
| 2,200.00                         | 17.76           | 276.15      | 2,135.24            | 49.30      | -457.81    | -44.83                | 0.00                  | 0.00                 | 0.00                |
| 2,300.00                         | 17.76           | 276.15      | 2,230.47            | 52.57      | -488.14    | -47.80                | 0.00                  | 0.00                 | 0.00                |
| 2,400.00                         | 17.76           | 276.15      | 2,325.71            | 55.84      | -518.47    | -50.77                | 0.00                  | 0.00                 | 0.00                |
| 2,500.00                         | 17.76           | 276.15      | 2,420.94            | 59.10      | -548.80    | -53.74                | 0.00                  | 0.00                 | 0.00                |
| 2,600.00                         | 17.76           | 276.15      | 2,516.18            | 62.37      | -579.12    | -56.70                | 0.00                  | 0.00                 | 0.00                |
| 2,700.00                         | 17.76           | 276.15      | 2,611.41            | 65.63      | -609.45    | -59.67                | 0.00                  | 0.00                 | 0.00                |
| 2,800.00                         | 17.76           | 276.15      | 2,706.65            | 68.90      | -639.78    | -62.64                | 0.00                  | 0.00                 | 0.00                |
| 2,900.00                         | 17.76           | 276.15      | 2,801.88            | 72.17      | -670.10    | -65.61                | 0.00                  | 0.00                 | 0.00                |
| 3,000.00                         | 17.76           | 276.15      | 2,897.12            | 75.43      | -700.43    | -68.58                | 0.00                  | 0.00                 | 0.00                |
| 3,100.00                         | 17.76           | 276.15      | 2,992.35            | 78.70      | -730.76    | -71.55                | 0.00                  | 0.00                 | 0.00                |
| 3,200.00                         | 17.76           | 276.15      | 3,087.58            | 81.96      | -761.08    | -74.52                | 0.00                  | 0.00                 | 0.00                |
| 3,300.00                         | 17.76           | 276.15      | 3,182.82            | 85.23      | -791.41    | -77.49                | 0.00                  | 0.00                 | 0.00                |
| 3,400.00                         | 17.76           | 276.15      | 3,278.05            | 88.50      | -821.74    | -80.46                | 0.00                  | 0.00                 | 0.00                |
| 3,500.00                         | 17.76           | 276.15      | 3,373.29            | 91.76      | -852.06    | -83.43                | 0.00                  | 0.00                 | 0.00                |
| 3,600.00                         | 17.76           | 276.15      | 3,468.52            | 95.03      | -882.39    | -86.40                | 0.00                  | 0.00                 | 0.00                |
| 3,700.00                         | 17.76           | 276.15      | 3,563.76            | 98.29      | -912.72    | -89.37                | 0.00                  | 0.00                 | 0.00                |
| 3,800.00                         | 17.76           | 276.15      | 3,658.99            | 101.56     | -943.04    | -92.34                | 0.00                  | 0.00                 | 0.00                |
| 3,900.00                         | 17.76           | 276.15      | 3,754.23            | 104.83     | -973.37    | -95.31                | 0.00                  | 0.00                 | 0.00                |
| 4,000.00                         | 17.76           | 276.15      | 3,849.46            | 108.09     | -1,003.70  | -98.28                | 0.00                  | 0.00                 | 0.00                |
| 4,100.00                         | 17.76           | 276.15      | 3,944.70            | 111.36     | -1,034.02  | -101.25               | 0.00                  | 0.00                 | 0.00                |
| 4,200.00                         | 17.76           | 276.15      | 4,039.93            | 114.62     | -1,064.35  | -104.22               | 0.00                  | 0.00                 | 0.00                |
| 4,300.00                         | 17.76           | 276.15      | 4,135.16            | 117.89     | -1,094.68  | -107.19               | 0.00                  | 0.00                 | 0.00                |
| 4,400.00                         | 17.76           | 276.15      | 4,230.40            | 121.16     | -1,125.00  | -110.16               | 0.00                  | 0.00                 | 0.00                |
| 4,500.00                         | 17.76           | 276.15      | 4,325.63            | 124.42     | -1,155.33  | -113.12               | 0.00                  | 0.00                 | 0.00                |
| 4,600.00                         | 17.76           | 276.15      | 4,420.87            | 127.69     | -1,185.66  | -116.09               | 0.00                  | 0.00                 | 0.00                |
| 4,700.00                         | 17.76           | 276.15      | 4,516.10            | 130.95     | -1,215.99  | -119.06               | 0.00                  | 0.00                 | 0.00                |
| 4,800.00                         | 17.76           | 276.15      | 4,611.34            | 134.22     | -1,246.31  | -122.03               | 0.00                  | 0.00                 | 0.00                |
| 4,900.00                         | 17.76           | 276.15      | 4,706.57            | 137.49     | -1,276.64  | -125.00               | 0.00                  | 0.00                 | 0.00                |

|                  |                         |                                     |                              |
|------------------|-------------------------|-------------------------------------|------------------------------|
| <b>Database:</b> | Casper District         | <b>Local Co-ordinate Reference:</b> | Well SRC Smith 33-23-26C     |
| <b>Company:</b>  | Synergy Resources Corp. | <b>TVD Reference:</b>               | GL 5075' & KB13' @ 5088.00ft |
| <b>Project:</b>  | Weld County, CO NAD 83  | <b>MD Reference:</b>                | GL 5075' & KB13' @ 5088.00ft |
| <b>Site:</b>     | SRC Smith               | <b>North Reference:</b>             | True                         |
| <b>Well:</b>     | SRC Smith 33-23-26C     | <b>Survey Calculation Method:</b>   | Minimum Curvature            |
| <b>Wellbore:</b> | OH                      |                                     |                              |
| <b>Design:</b>   | Plan 1                  |                                     |                              |

| Planned Survey                          |                 |             |                     |            |            |                       |                       |                      |                     |
|---|-----------------|-------------|---------------------|------------|------------|-----------------------|-----------------------|----------------------|---------------------|
| Measured Depth (ft)                     | Inclination (°) | Azimuth (°) | Vertical Depth (ft) | +N/-S (ft) | +E/-W (ft) | Vertical Section (ft) | Dogleg Rate (°/100ft) | Build Rate (°/100ft) | Turn Rate (°/100ft) |
| 5,000.00                                | 17.76           | 276.15      | 4,801.81            | 140.75     | -1,306.97  | -127.97               | 0.00                  | 0.00                 | 0.00                |
| 5,100.00                                | 17.76           | 276.15      | 4,897.04            | 144.02     | -1,337.29  | -130.94               | 0.00                  | 0.00                 | 0.00                |
| 5,200.00                                | 17.76           | 276.15      | 4,992.27            | 147.28     | -1,367.62  | -133.91               | 0.00                  | 0.00                 | 0.00                |
| 5,300.00                                | 17.76           | 276.15      | 5,087.51            | 150.55     | -1,397.95  | -136.88               | 0.00                  | 0.00                 | 0.00                |
| 5,400.00                                | 17.76           | 276.15      | 5,182.74            | 153.82     | -1,428.27  | -139.85               | 0.00                  | 0.00                 | 0.00                |
| 5,500.00                                | 17.76           | 276.15      | 5,277.98            | 157.08     | -1,458.60  | -142.82               | 0.00                  | 0.00                 | 0.00                |
| 5,543.66                                | 17.76           | 276.15      | 5,319.56            | 158.51     | -1,471.84  | -144.12               | 0.00                  | 0.00                 | 0.00                |
| <b>Start Drop -2.00</b>                 |                 |             |                     |            |            |                       |                       |                      |                     |
| 5,600.00                                | 16.63           | 276.15      | 5,373.38            | 160.29     | -1,488.40  | -145.74               | 2.00                  | -2.00                | 0.00                |
| 5,700.00                                | 14.63           | 276.15      | 5,469.67            | 163.18     | -1,515.19  | -148.36               | 2.00                  | -2.00                | 0.00                |
| 5,800.00                                | 12.63           | 276.15      | 5,566.85            | 165.70     | -1,538.62  | -150.65               | 2.00                  | -2.00                | 0.00                |
| 5,900.00                                | 10.63           | 276.15      | 5,664.79            | 167.86     | -1,558.67  | -152.62               | 2.00                  | -2.00                | 0.00                |
| 6,000.00                                | 8.63            | 276.15      | 5,763.38            | 169.65     | -1,575.31  | -154.25               | 2.00                  | -2.00                | 0.00                |
| 6,100.00                                | 6.63            | 276.15      | 5,862.49            | 171.07     | -1,588.51  | -155.54               | 2.00                  | -2.00                | 0.00                |
| 6,200.00                                | 4.63            | 276.15      | 5,962.00            | 172.12     | -1,598.27  | -156.50               | 2.00                  | -2.00                | 0.00                |
| 6,300.00                                | 2.63            | 276.15      | 6,061.79            | 172.80     | -1,604.57  | -157.11               | 2.00                  | -2.00                | 0.00                |
| 6,400.00                                | 0.63            | 276.15      | 6,161.75            | 173.11     | -1,607.40  | -157.39               | 2.00                  | -2.00                | 0.00                |
| 6,431.63                                | 0.00            | 0.00        | 6,193.38            | 173.13     | -1,607.58  | -157.41               | 2.00                  | -2.00                | 265.08              |
| <b>Start DLS 9.00 TFO 180.56</b>        |                 |             |                     |            |            |                       |                       |                      |                     |
| 6,500.00                                | 6.15            | 180.56      | 6,261.62            | 169.46     | -1,607.61  | -153.74               | 9.00                  | 9.00                 | -262.47             |
| 6,600.00                                | 15.15           | 180.56      | 6,359.79            | 150.99     | -1,607.79  | -135.27               | 9.00                  | 9.00                 | 0.00                |
| 6,700.00                                | 24.15           | 180.56      | 6,453.87            | 117.40     | -1,608.12  | -101.67               | 9.00                  | 9.00                 | 0.00                |
| 6,800.00                                | 33.15           | 180.56      | 6,541.53            | 69.50      | -1,608.58  | -53.77                | 9.00                  | 9.00                 | 0.00                |
| 6,900.00                                | 42.15           | 180.56      | 6,620.62            | 8.48       | -1,609.18  | 7.25                  | 9.00                  | 9.00                 | 0.00                |
| 7,000.00                                | 51.15           | 180.56      | 6,689.19            | -64.17     | -1,609.88  | 79.90                 | 9.00                  | 9.00                 | 0.00                |
| 7,100.00                                | 60.15           | 180.56      | 6,745.56            | -146.64    | -1,610.68  | 162.38                | 9.00                  | 9.00                 | 0.00                |
| 7,200.00                                | 69.15           | 180.56      | 6,788.32            | -236.92    | -1,611.56  | 252.66                | 9.00                  | 9.00                 | 0.00                |
| 7,300.00                                | 78.15           | 180.56      | 6,816.44            | -332.77    | -1,612.49  | 348.52                | 9.00                  | 9.00                 | 0.00                |
| 7,400.00                                | 87.15           | 180.56      | 6,829.21            | -431.84    | -1,613.46  | 447.59                | 9.00                  | 9.00                 | 0.00                |
| 7,431.63                                | 90.00           | 180.56      | 6,830.00            | -463.46    | -1,613.76  | 479.21                | 9.00                  | 9.00                 | 0.00                |
| <b>Start 6678.20 hold at 7431.63 MD</b> |                 |             |                     |            |            |                       |                       |                      |                     |
| 7,500.00                                | 90.00           | 180.56      | 6,830.00            | -531.83    | -1,614.43  | 547.58                | 0.00                  | 0.00                 | 0.00                |
| 7,600.00                                | 90.00           | 180.56      | 6,830.00            | -631.82    | -1,615.40  | 647.58                | 0.00                  | 0.00                 | 0.00                |
| 7,700.00                                | 90.00           | 180.56      | 6,830.00            | -731.82    | -1,616.37  | 747.58                | 0.00                  | 0.00                 | 0.00                |
| 7,800.00                                | 90.00           | 180.56      | 6,830.00            | -831.81    | -1,617.34  | 847.58                | 0.00                  | 0.00                 | 0.00                |
| 7,900.00                                | 90.00           | 180.56      | 6,830.00            | -931.81    | -1,618.31  | 947.58                | 0.00                  | 0.00                 | 0.00                |
| 8,000.00                                | 90.00           | 180.56      | 6,830.00            | -1,031.80  | -1,619.29  | 1,047.58              | 0.00                  | 0.00                 | 0.00                |
| 8,100.00                                | 90.00           | 180.56      | 6,830.00            | -1,131.80  | -1,620.26  | 1,147.58              | 0.00                  | 0.00                 | 0.00                |
| 8,200.00                                | 90.00           | 180.56      | 6,830.00            | -1,231.79  | -1,621.23  | 1,247.58              | 0.00                  | 0.00                 | 0.00                |
| 8,300.00                                | 90.00           | 180.56      | 6,830.00            | -1,331.79  | -1,622.20  | 1,347.58              | 0.00                  | 0.00                 | 0.00                |
| 8,400.00                                | 90.00           | 180.56      | 6,830.00            | -1,431.78  | -1,623.17  | 1,447.58              | 0.00                  | 0.00                 | 0.00                |
| 8,500.00                                | 90.00           | 180.56      | 6,830.00            | -1,531.78  | -1,624.14  | 1,547.58              | 0.00                  | 0.00                 | 0.00                |
| 8,600.00                                | 90.00           | 180.56      | 6,830.00            | -1,631.78  | -1,625.12  | 1,647.58              | 0.00                  | 0.00                 | 0.00                |
| 8,700.00                                | 90.00           | 180.56      | 6,830.00            | -1,731.77  | -1,626.09  | 1,747.58              | 0.00                  | 0.00                 | 0.00                |
| 8,800.00                                | 90.00           | 180.56      | 6,830.00            | -1,831.77  | -1,627.06  | 1,847.58              | 0.00                  | 0.00                 | 0.00                |
| 8,900.00                                | 90.00           | 180.56      | 6,830.00            | -1,931.76  | -1,628.03  | 1,947.58              | 0.00                  | 0.00                 | 0.00                |
| 9,000.00                                | 90.00           | 180.56      | 6,830.00            | -2,031.76  | -1,629.00  | 2,047.58              | 0.00                  | 0.00                 | 0.00                |
| 9,100.00                                | 90.00           | 180.56      | 6,830.00            | -2,131.75  | -1,629.97  | 2,147.58              | 0.00                  | 0.00                 | 0.00                |
| 9,200.00                                | 90.00           | 180.56      | 6,830.00            | -2,231.75  | -1,630.95  | 2,247.58              | 0.00                  | 0.00                 | 0.00                |
| 9,300.00                                | 90.00           | 180.56      | 6,830.00            | -2,331.74  | -1,631.92  | 2,347.58              | 0.00                  | 0.00                 | 0.00                |
| 9,400.00                                | 90.00           | 180.56      | 6,830.00            | -2,431.74  | -1,632.89  | 2,447.58              | 0.00                  | 0.00                 | 0.00                |
| 9,500.00                                | 90.00           | 180.56      | 6,830.00            | -2,531.73  | -1,633.86  | 2,547.58              | 0.00                  | 0.00                 | 0.00                |
| 9,600.00                                | 90.00           | 180.56      | 6,830.00            | -2,631.73  | -1,634.83  | 2,647.58              | 0.00                  | 0.00                 | 0.00                |

|                  |                         |                                     |                              |
|------------------|-------------------------|-------------------------------------|------------------------------|
| <b>Database:</b> | Casper District         | <b>Local Co-ordinate Reference:</b> | Well SRC Smith 33-23-26C     |
| <b>Company:</b>  | Synergy Resources Corp. | <b>TVD Reference:</b>               | GL 5075' & KB13' @ 5088.00ft |
| <b>Project:</b>  | Weld County, CO NAD 83  | <b>MD Reference:</b>                | GL 5075' & KB13' @ 5088.00ft |
| <b>Site:</b>     | SRC Smith               | <b>North Reference:</b>             | True                         |
| <b>Well:</b>     | SRC Smith 33-23-26C     | <b>Survey Calculation Method:</b>   | Minimum Curvature            |
| <b>Wellbore:</b> | OH                      |                                     |                              |
| <b>Design:</b>   | Plan 1                  |                                     |                              |

| Planned Survey      |                 |             |                     |            |            |                       |                       |                      |                     |
|---------------------|-----------------|-------------|---------------------|------------|------------|-----------------------|-----------------------|----------------------|---------------------|
| Measured Depth (ft) | Inclination (°) | Azimuth (°) | Vertical Depth (ft) | +N/-S (ft) | +E/-W (ft) | Vertical Section (ft) | Dogleg Rate (°/100ft) | Build Rate (°/100ft) | Turn Rate (°/100ft) |
| 9,700.00            | 90.00           | 180.56      | 6,830.00            | -2,731.72  | -1,635.80  | 2,747.58              | 0.00                  | 0.00                 | 0.00                |
| 9,800.00            | 90.00           | 180.56      | 6,830.00            | -2,831.72  | -1,636.78  | 2,847.58              | 0.00                  | 0.00                 | 0.00                |
| 9,900.00            | 90.00           | 180.56      | 6,830.00            | -2,931.71  | -1,637.75  | 2,947.58              | 0.00                  | 0.00                 | 0.00                |
| 10,000.00           | 90.00           | 180.56      | 6,830.00            | -3,031.71  | -1,638.72  | 3,047.58              | 0.00                  | 0.00                 | 0.00                |
| 10,100.00           | 90.00           | 180.56      | 6,830.00            | -3,131.70  | -1,639.69  | 3,147.58              | 0.00                  | 0.00                 | 0.00                |
| 10,200.00           | 90.00           | 180.56      | 6,830.00            | -3,231.70  | -1,640.66  | 3,247.58              | 0.00                  | 0.00                 | 0.00                |
| 10,300.00           | 90.00           | 180.56      | 6,830.00            | -3,331.70  | -1,641.64  | 3,347.58              | 0.00                  | 0.00                 | 0.00                |
| 10,400.00           | 90.00           | 180.56      | 6,830.00            | -3,431.69  | -1,642.61  | 3,447.58              | 0.00                  | 0.00                 | 0.00                |
| 10,500.00           | 90.00           | 180.56      | 6,830.00            | -3,531.69  | -1,643.58  | 3,547.58              | 0.00                  | 0.00                 | 0.00                |
| 10,600.00           | 90.00           | 180.56      | 6,830.00            | -3,631.68  | -1,644.55  | 3,647.58              | 0.00                  | 0.00                 | 0.00                |
| 10,700.00           | 90.00           | 180.56      | 6,830.00            | -3,731.68  | -1,645.52  | 3,747.58              | 0.00                  | 0.00                 | 0.00                |
| 10,800.00           | 90.00           | 180.56      | 6,830.00            | -3,831.67  | -1,646.49  | 3,847.58              | 0.00                  | 0.00                 | 0.00                |
| 10,900.00           | 90.00           | 180.56      | 6,830.00            | -3,931.67  | -1,647.47  | 3,947.58              | 0.00                  | 0.00                 | 0.00                |
| 11,000.00           | 90.00           | 180.56      | 6,830.00            | -4,031.66  | -1,648.44  | 4,047.58              | 0.00                  | 0.00                 | 0.00                |
| 11,100.00           | 90.00           | 180.56      | 6,830.00            | -4,131.66  | -1,649.41  | 4,147.58              | 0.00                  | 0.00                 | 0.00                |
| 11,200.00           | 90.00           | 180.56      | 6,830.00            | -4,231.65  | -1,650.38  | 4,247.58              | 0.00                  | 0.00                 | 0.00                |
| 11,300.00           | 90.00           | 180.56      | 6,830.00            | -4,331.65  | -1,651.35  | 4,347.58              | 0.00                  | 0.00                 | 0.00                |
| 11,400.00           | 90.00           | 180.56      | 6,830.00            | -4,431.64  | -1,652.32  | 4,447.58              | 0.00                  | 0.00                 | 0.00                |
| 11,500.00           | 90.00           | 180.56      | 6,830.00            | -4,531.64  | -1,653.30  | 4,547.58              | 0.00                  | 0.00                 | 0.00                |
| 11,600.00           | 90.00           | 180.56      | 6,830.00            | -4,631.63  | -1,654.27  | 4,647.58              | 0.00                  | 0.00                 | 0.00                |
| 11,700.00           | 90.00           | 180.56      | 6,830.00            | -4,731.63  | -1,655.24  | 4,747.58              | 0.00                  | 0.00                 | 0.00                |
| 11,800.00           | 90.00           | 180.56      | 6,830.00            | -4,831.62  | -1,656.21  | 4,847.58              | 0.00                  | 0.00                 | 0.00                |
| 11,900.00           | 90.00           | 180.56      | 6,830.00            | -4,931.62  | -1,657.18  | 4,947.58              | 0.00                  | 0.00                 | 0.00                |
| 12,000.00           | 90.00           | 180.56      | 6,830.00            | -5,031.61  | -1,658.15  | 5,047.58              | 0.00                  | 0.00                 | 0.00                |
| 12,100.00           | 90.00           | 180.56      | 6,830.00            | -5,131.61  | -1,659.13  | 5,147.58              | 0.00                  | 0.00                 | 0.00                |
| 12,200.00           | 90.00           | 180.56      | 6,830.00            | -5,231.61  | -1,660.10  | 5,247.58              | 0.00                  | 0.00                 | 0.00                |
| 12,300.00           | 90.00           | 180.56      | 6,830.00            | -5,331.60  | -1,661.07  | 5,347.58              | 0.00                  | 0.00                 | 0.00                |
| 12,400.00           | 90.00           | 180.56      | 6,830.00            | -5,431.60  | -1,662.04  | 5,447.58              | 0.00                  | 0.00                 | 0.00                |
| 12,500.00           | 90.00           | 180.56      | 6,830.00            | -5,531.59  | -1,663.01  | 5,547.58              | 0.00                  | 0.00                 | 0.00                |
| 12,600.00           | 90.00           | 180.56      | 6,830.00            | -5,631.59  | -1,663.99  | 5,647.58              | 0.00                  | 0.00                 | 0.00                |
| 12,700.00           | 90.00           | 180.56      | 6,830.00            | -5,731.58  | -1,664.96  | 5,747.58              | 0.00                  | 0.00                 | 0.00                |
| 12,800.00           | 90.00           | 180.56      | 6,830.00            | -5,831.58  | -1,665.93  | 5,847.58              | 0.00                  | 0.00                 | 0.00                |
| 12,900.00           | 90.00           | 180.56      | 6,830.00            | -5,931.57  | -1,666.90  | 5,947.58              | 0.00                  | 0.00                 | 0.00                |
| 13,000.00           | 90.00           | 180.56      | 6,830.00            | -6,031.57  | -1,667.87  | 6,047.58              | 0.00                  | 0.00                 | 0.00                |
| 13,100.00           | 90.00           | 180.56      | 6,830.00            | -6,131.56  | -1,668.84  | 6,147.58              | 0.00                  | 0.00                 | 0.00                |
| 13,200.00           | 90.00           | 180.56      | 6,830.00            | -6,231.56  | -1,669.82  | 6,247.58              | 0.00                  | 0.00                 | 0.00                |
| 13,300.00           | 90.00           | 180.56      | 6,830.00            | -6,331.55  | -1,670.79  | 6,347.58              | 0.00                  | 0.00                 | 0.00                |
| 13,400.00           | 90.00           | 180.56      | 6,830.00            | -6,431.55  | -1,671.76  | 6,447.58              | 0.00                  | 0.00                 | 0.00                |
| 13,500.00           | 90.00           | 180.56      | 6,830.00            | -6,531.54  | -1,672.73  | 6,547.58              | 0.00                  | 0.00                 | 0.00                |
| 13,600.00           | 90.00           | 180.56      | 6,830.00            | -6,631.54  | -1,673.70  | 6,647.58              | 0.00                  | 0.00                 | 0.00                |
| 13,700.00           | 90.00           | 180.56      | 6,830.00            | -6,731.53  | -1,674.67  | 6,747.58              | 0.00                  | 0.00                 | 0.00                |
| 13,800.00           | 90.00           | 180.56      | 6,830.00            | -6,831.53  | -1,675.65  | 6,847.58              | 0.00                  | 0.00                 | 0.00                |
| 13,900.00           | 90.00           | 180.56      | 6,830.00            | -6,931.53  | -1,676.62  | 6,947.58              | 0.00                  | 0.00                 | 0.00                |
| 14,000.00           | 90.00           | 180.56      | 6,830.00            | -7,031.52  | -1,677.59  | 7,047.58              | 0.00                  | 0.00                 | 0.00                |
| 14,100.00           | 90.00           | 180.56      | 6,830.00            | -7,131.52  | -1,678.56  | 7,147.58              | 0.00                  | 0.00                 | 0.00                |
| 14,109.84           | 90.00           | 180.56      | 6,830.00            | -7,141.35  | -1,678.66  | 7,157.42              | 0.00                  | 0.00                 | 0.00                |
| TD at 14109.84      |                 |             |                     |            |            |                       |                       |                      |                     |

|                  |                         |                                     |                              |
|------------------|-------------------------|-------------------------------------|------------------------------|
| <b>Database:</b> | Casper District         | <b>Local Co-ordinate Reference:</b> | Well SRC Smith 33-23-26C     |
| <b>Company:</b>  | Synergy Resources Corp. | <b>TVD Reference:</b>               | GL 5075' & KB13' @ 5088.00ft |
| <b>Project:</b>  | Weld County, CO NAD 83  | <b>MD Reference:</b>                | GL 5075' & KB13' @ 5088.00ft |
| <b>Site:</b>     | SRC Smith               | <b>North Reference:</b>             | True                         |
| <b>Well:</b>     | SRC Smith 33-23-26C     | <b>Survey Calculation Method:</b>   | Minimum Curvature            |
| <b>Wellbore:</b> | OH                      |                                     |                              |
| <b>Design:</b>   | Plan 1                  |                                     |                              |

| Design Targets  |           |          |          |           |           |              |              |                  |                   |
|---|-----------|----------|----------|-----------|-----------|--------------|--------------|------------------|-------------------|
| Target Name   | Dip Angle | Dip Dir. | TVD      | +N/-S     | +E/-W     | Northing     | Easting      | Latitude         | Longitude         |
| - hit/miss target   | (°)       | (°)      | (ft)     | (ft)      | (ft)      | (usft)       | (usft)       |                  |                   |
| - Shape   |           |          |          |           |           |              |              |                  |                   |
| 33-23-26C TGT 1   | 0.00      | 0.00     | 6,193.38 | 173.13    | -1,607.58 | 1,544,225.66 | 3,367,656.52 | 40° 49' 10.996 N | 104° 10' 17.918 W |
| - plan hits target center   |           |          |          |           |           |              |              |                  |                   |
| - Point   |           |          |          |           |           |              |              |                  |                   |
| 33-23-26C PBHL  | 0.00      | 0.00     | 6,830.00 | -7,141.35 | -1,678.66 | 1,536,910.95 | 3,367,695.50 | 40° 47' 58.722 N | 104° 10' 18.836 W |
| - plan hits target center   |           |          |          |           |           |              |              |                  |                   |
| - Point   |           |          |          |           |           |              |              |                  |                   |
| 33-23-26C TGT 2   | 0.00      | 0.00     | 6,830.00 | -266.63   | -1,607.05 | 1,543,785.96 | 3,367,663.66 | 40° 49' 6.650 N  | 104° 10' 17.911 W |
| - plan misses target center by 30.14ft at 7240.24ft MD (6801.45 TVD, -274.95 N, -1611.93 E) |           |          |          |           |           |              |              |                  |                   |
| - Point   |           |          |          |           |           |              |              |                  |                   |

| Plan Annotations |                |                   |            |                                  |
|------------------|----------------|-------------------|------------|----------------------------------|
| Measured Depth   | Vertical Depth | Local Coordinates |            | Comment                          |
| (ft)             | (ft)           | +N/-S (ft)        | +E/-W (ft) |                                  |
| 250.00           | 250.00         | 0.00              | 0.00       | Start Build 2.00                 |
| 1,137.97         | 1,123.82       | 14.62             | -135.74    | Start 4405.69 hold at 1137.97 MD |
| 5,543.66         | 5,319.56       | 158.51            | -1,471.84  | Start Drop -2.00                 |
| 6,431.63         | 6,193.38       | 173.13            | -1,607.58  | Start DLS 9.00 TFO 180.56        |
| 7,431.63         | 6,830.00       | -463.46           | -1,613.76  | Start 6678.20 hold at 7431.63 MD |
| 14,109.84        | 6,830.00       | -7,141.35         | -1,678.66  | TD at 14109.84                   |