



March 8, 2006

Mr. Randall Ferguson  
COGCC  
1120 Lincoln St. Ste. 801  
Denver, CO 80203

Re: Map of HWY. 85 & WCR 18.5 area.

Mr. Ferguson:

I have attached two maps and one sketch of the 85 & 18.5 area. On the maps I labeled the Dorothy Mintle property (current issue) as area 1, and the Gary Hladky property (early 2002 issue) as area 2. Area 3 is a best guess, based on landowner complaints during the early 2002 visits of the Hladky property. Please do not hesitate to call, should you have questions or concerns.

Respectfully,

A handwritten signature in dark ink, appearing to read 'P. D. Park'.

Paul D. Park  
Office: 970-378-6372  
Cell: 970-539-1908  
Fax: 970-378-6380  
E-mail: [pdpark@duke-energy.com](mailto:pdpark@duke-energy.com)

DUKE ENERGY FIELD SERVICES  
1324 North 7th Avenue  
Greeley, CO 80631

970 356 9700

303 572 3516 fax



01727379

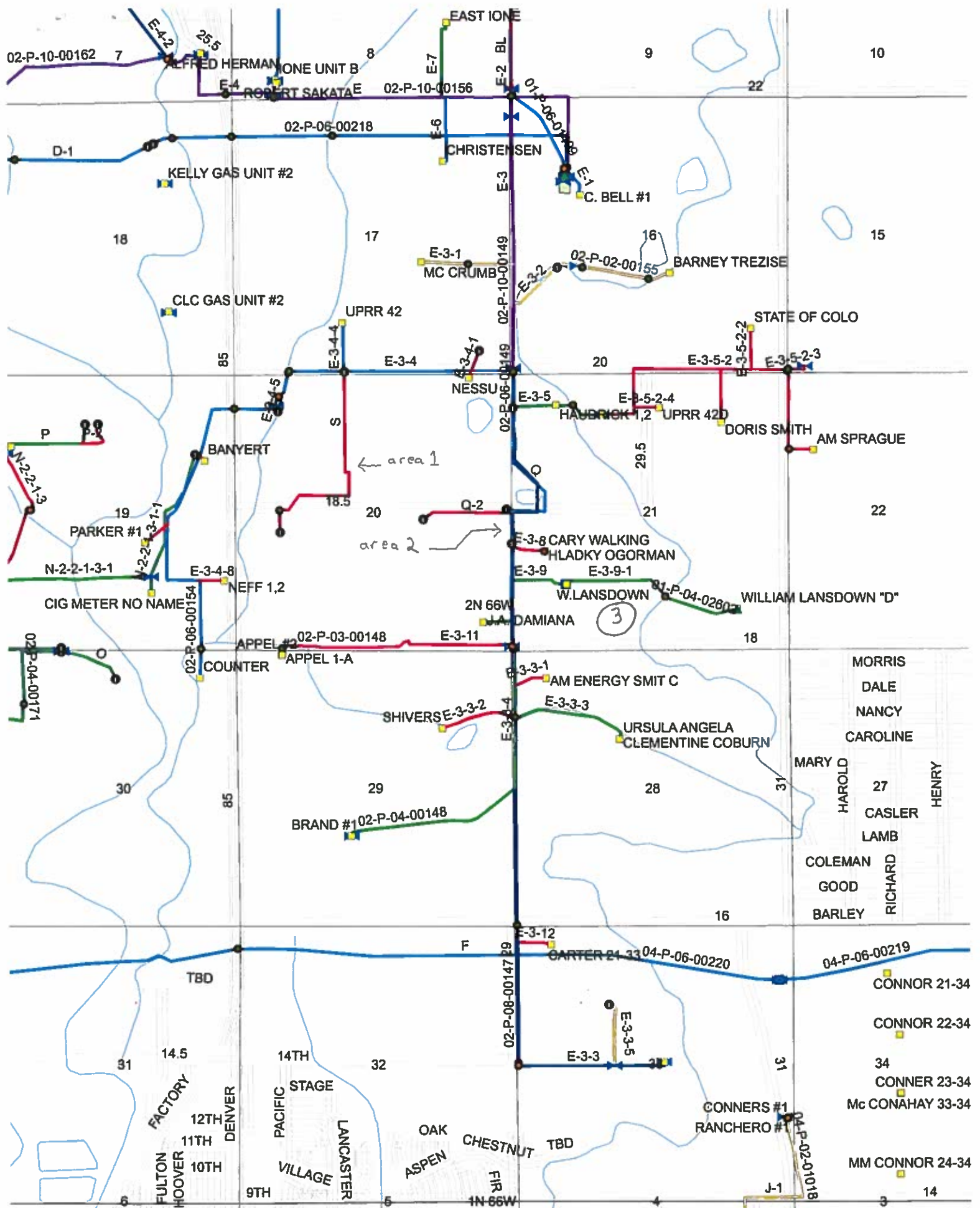

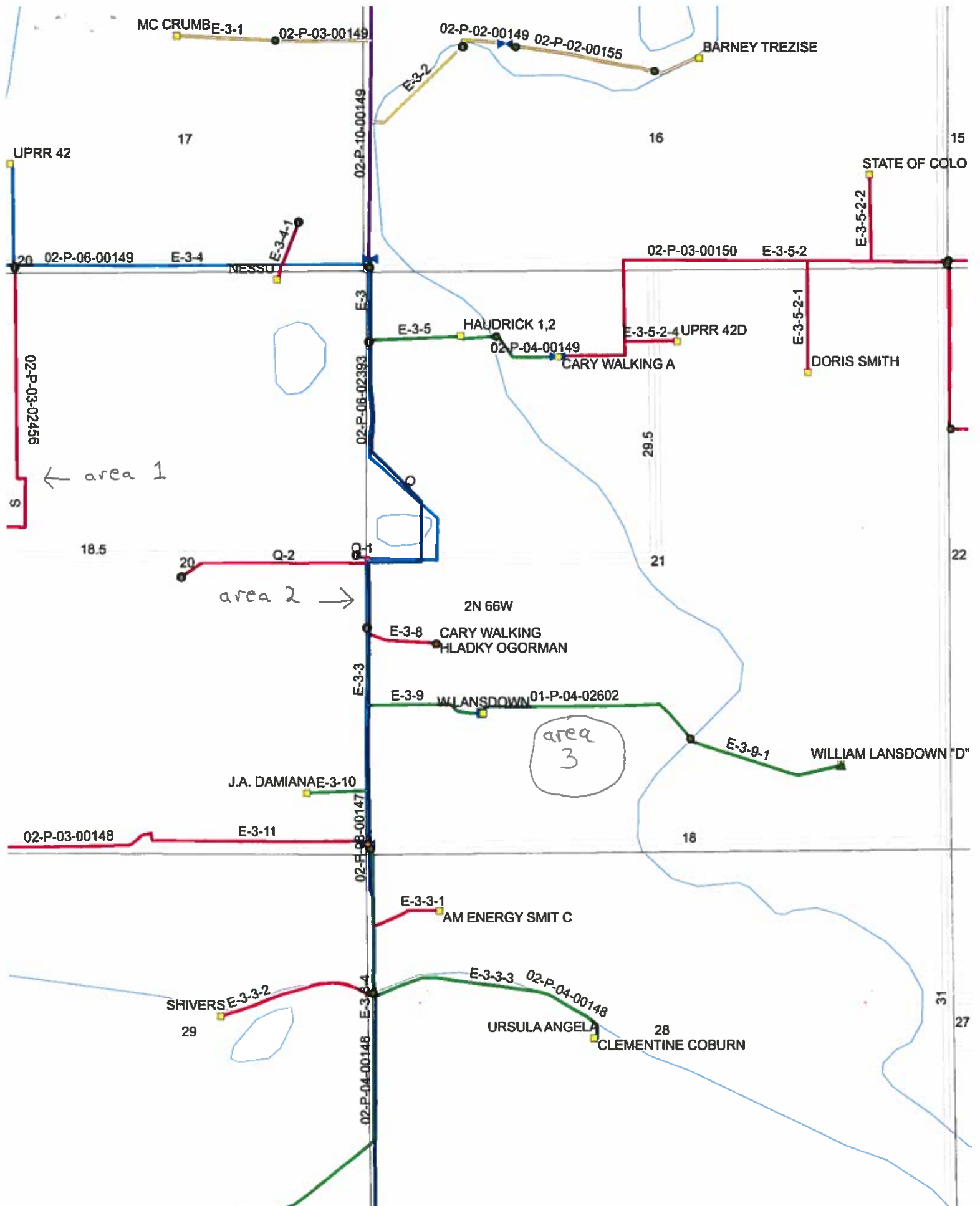

section 21  
SW 9th  
T2N  
R66W

29 1/2

sect 20 18 1/2 sect 21  
sect 20 sect 21

Hwy 85

corn stubble

elec fence

8" line

blue house

well 280 ft deep

leak

prairie  
grass