



Project: Weld County, CO NAD 83
Site: Anschutz Equus Farms 4-62-9_10 CW2 Pad
Well: Anschutz Equus Farms 4-62-9-3225B2
Wellbore: OH
Design: Plan 2

Plan: Plan 2 (Anschutz Equus Farms 4-62-9-3225B2/OH)
Created By: Seth BurstadDate: 1-25-2016



T **M**
Azimuths to True North
Magnetic North: 8.27°

Magnetic Field
Strength: 52611.2snT
Dip Angle: 66.98°
Date: 10/27/2015
Model: BGGM2015

WELL DETAILS: Anschutz Equus Farms 4-62-9-3225B2

PROJECT DETAILS: Weld County, CO NAD 83

Geodetic System: US State Plane 1983
Datum: North American Datum 1983
Ellipsoid: GRS 1980
Zone: Colorado Northern Zone

System Datum: Mean Sea Level
Local North: True

GL 4528' & KB 16' @ 4544.00ft 4528.00
Northing Easting Latitude Longitude
1363700.06 3323826.96 40° 19' 33.369 N 104° 20' 18.690 W

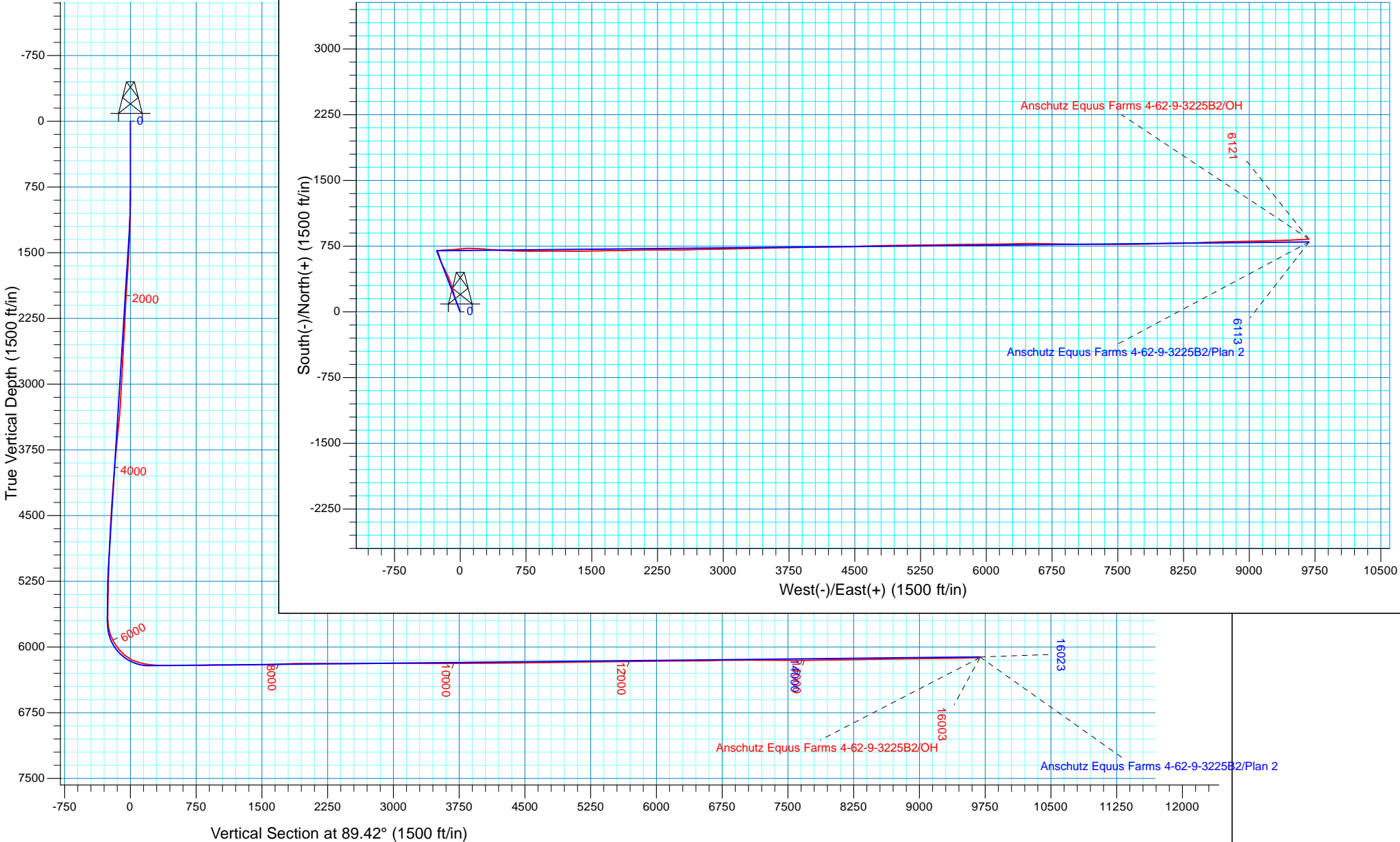



Bill Barrett Corporation

Bill Barrett Corp.

Weld County, CO NAD 83

Anschutz Equus Farms 4-62-9_10 CW2 Pad

Anschutz Equus Farms 4-62-9-3225B2

OH

Design: OH

Standard Survey Report

25 January, 2016



Scientific Drilling

www.scientificdrilling.com



Company:	Bill Barrett Corp.	Local Co-ordinate Reference:	Well Anschutz Equus Farms 4-62-9-3225B2
Project:	Weld County, CO NAD 83	TVD Reference:	GL 4528' & KB 16' @ 4544.00ft
Site:	Anschutz Equus Farms 4-62-9_10 CW2 Pad	MD Reference:	GL 4528' & KB 16' @ 4544.00ft
Well:	Anschutz Equus Farms 4-62-9-3225B2	North Reference:	True
Wellbore:	OH	Survey Calculation Method:	Minimum Curvature
Design:	OH	Database:	Casper District

Project	Weld County, CO NAD 83		
Map System:	US State Plane 1983	System Datum:	Mean Sea Level
Geo Datum:	North American Datum 1983		
Map Zone:	Colorado Northern Zone		

Site	Anschutz Equus Farms 4-62-9_10 CW2 Pad, Site Center : 4-62-9-3340D2				
Site Position:		Northing:	1,363,655.71 usft	Latitude:	40° 19' 32.930 N
From:	Lat/Long	Easting:	3,323,830.61 usft	Longitude:	104° 20' 18.650 W
Position Uncertainty:	0.00 ft	Slot Radius:	13.200 in	Grid Convergence:	0.75 °

Well	Anschutz Equus Farms 4-62-9-3225B2, 2360' FSL 250' FWL Sec 9 T4N R62W					
Well Position	+N/-S	0.00 ft	Northing:	1,363,700.07 usft	Latitude:	40° 19' 33.369 N
	+E/-W	0.00 ft	Easting:	3,323,826.96 usft	Longitude:	104° 20' 18.690 W
Position Uncertainty		0.00 ft	Wellhead Elevation:	0.00 ft	Ground Level:	4,528.00 ft

Wellbore	OH				
Magnetics	Model Name	Sample Date	Declination (°)	Dip Angle (°)	Field Strength (nT)
	BGGM2015	10/27/2015	8.27	66.98	52,611

Design	OH				
Audit Notes:					
Version:	1.0	Phase:	ACTUAL	Tie On Depth:	0.00
Vertical Section:	Depth From (TVD) (ft)	+N/-S (ft)	+E/-W (ft)	Direction (°)	
	0.00	0.00	0.00	89.42	

Survey Program	Date	1/25/2016			
From (ft)	To (ft)	Survey (Wellbore)	Tool Name	Description	
885.00	6,550.00	Survey #1 - Vertical / Curve (OH)	SDI MWD	SDI MWD - Standard ver 1.0.1	
6,683.00	16,003.00	Survey #2 - Lateral (OH)	SDI MWD	SDI MWD - Standard ver 1.0.1	

Survey										
Measured Depth (ft)	Inclination (°)	Azimuth (°)	Vertical Depth (ft)	+N/-S (ft)	+E/-W (ft)	Vertical Section (ft)	Dogleg Rate (°/100ft)	Build Rate (°/100ft)	Turn Rate (°/100ft)	
800.00	0.00	0.00	800.00	0.00	0.00	0.00	0.00	0.00	0.00	
885.00	0.53	263.77	885.00	-0.04	-0.39	-0.39	0.62	0.62	0.00	
First SDI MWD Survey										
976.00	1.23	319.05	975.99	0.65	-1.45	-1.44	1.13	0.77	60.75	
1,067.00	2.64	330.83	1,066.93	3.22	-3.11	-3.08	1.60	1.55	12.95	
1,159.00	3.87	338.56	1,158.79	7.96	-5.28	-5.20	1.42	1.34	8.40	
1,251.00	5.36	343.48	1,250.48	14.97	-7.64	-7.48	1.67	1.62	5.35	
1,342.00	7.12	341.73	1,340.94	24.40	-10.61	-10.36	1.95	1.93	-1.92	
1,434.00	8.27	341.64	1,432.11	36.09	-14.48	-14.12	1.25	1.25	-0.10	
1,525.00	9.32	337.24	1,522.04	49.10	-19.40	-18.90	1.37	1.15	-4.84	

Company:	Bill Barrett Corp.	Local Co-ordinate Reference:	Well Anschutz Equus Farms 4-62-9-3225B2
Project:	Weld County, CO NAD 83	TVD Reference:	GL 4528' & KB 16' @ 4544.00ft
Site:	Anschutz Equus Farms 4-62-9_10 CW2 Pad	MD Reference:	GL 4528' & KB 16' @ 4544.00ft
Well:	Anschutz Equus Farms 4-62-9-3225B2	North Reference:	True
Wellbore:	OH	Survey Calculation Method:	Minimum Curvature
Design:	OH	Database:	Casper District

Survey									
Measured Depth (ft)	Inclination (°)	Azimuth (°)	Vertical Depth (ft)	+N/-S (ft)	+E/-W (ft)	Vertical Section (ft)	Dogleg Rate (°/100ft)	Build Rate (°/100ft)	Turn Rate (°/100ft)
1,617.00	11.26	338.48	1,612.56	64.33	-25.57	-24.92	2.12	2.11	1.35
1,708.00	10.99	338.21	1,701.85	80.65	-32.05	-31.23	0.30	-0.30	-0.30
1,799.00	10.38	340.76	1,791.27	96.44	-37.97	-37.00	0.85	-0.67	2.80
1,891.00	10.55	342.52	1,881.74	112.30	-43.24	-42.10	0.39	0.18	1.91
1,982.00	10.90	341.90	1,971.15	128.42	-48.41	-47.11	0.40	0.38	-0.68
2,074.00	10.02	339.88	2,061.62	144.21	-53.87	-52.40	1.04	-0.96	-2.20
2,166.00	10.64	342.43	2,152.13	159.82	-59.18	-57.56	0.84	0.67	2.77
2,257.00	10.02	342.78	2,241.65	175.39	-64.06	-62.28	0.68	-0.68	0.38
2,349.00	11.34	345.15	2,332.06	191.78	-68.75	-66.81	1.51	1.43	2.58
2,443.00	11.26	346.12	2,424.24	209.62	-73.32	-71.20	0.22	-0.09	1.03
2,538.00	11.52	346.21	2,517.37	227.84	-77.81	-75.50	0.27	0.27	0.09
2,632.00	12.13	346.03	2,609.37	246.54	-82.43	-79.93	0.65	0.65	-0.19
2,726.00	12.13	341.11	2,701.27	265.47	-88.01	-85.32	1.10	0.00	-5.23
2,821.00	10.64	339.18	2,794.40	283.11	-94.36	-91.49	1.62	-1.57	-2.03
2,915.00	9.41	339.62	2,886.97	298.42	-100.12	-97.09	1.31	-1.31	0.47
3,009.00	9.41	342.69	2,979.70	312.96	-105.08	-101.91	0.53	0.00	3.27
3,103.00	9.67	343.40	3,072.40	327.87	-109.62	-106.30	0.30	0.28	0.76
3,197.00	10.38	339.62	3,164.97	343.37	-114.83	-111.35	1.03	0.76	-4.02
3,292.00	10.46	341.20	3,258.40	359.56	-120.59	-116.94	0.31	0.08	1.66
3,387.00	12.75	338.04	3,351.45	377.45	-127.29	-123.46	2.50	2.41	-3.33
3,481.00	14.42	337.07	3,442.82	397.85	-135.73	-131.69	1.79	1.78	-1.03
3,575.00	14.86	336.37	3,533.77	419.67	-145.12	-140.86	0.50	0.47	-0.74
3,669.00	13.37	333.20	3,624.93	440.41	-154.85	-150.39	1.79	-1.59	-3.37
3,764.00	12.75	332.50	3,717.47	459.52	-164.65	-159.99	0.67	-0.65	-0.74
3,858.00	11.70	333.64	3,809.34	477.26	-173.67	-168.83	1.15	-1.12	1.21
3,952.00	10.38	334.43	3,901.60	493.44	-181.55	-176.55	1.41	-1.40	0.84
4,047.00	10.55	333.03	3,995.02	508.91	-189.19	-184.03	0.32	0.18	-1.47
4,141.00	10.82	332.94	4,087.39	524.44	-197.11	-191.79	0.29	0.29	-0.10
4,235.00	10.99	334.87	4,179.69	540.40	-204.93	-199.45	0.43	0.18	2.05
4,330.00	10.11	337.24	4,273.08	556.29	-212.00	-206.36	1.03	-0.93	2.49
4,424.00	10.38	336.81	4,365.58	571.68	-218.53	-212.73	0.30	0.29	-0.46
4,518.00	9.85	340.76	4,458.12	587.06	-224.51	-218.56	0.93	-0.56	4.20
4,612.00	10.02	346.47	4,550.72	602.60	-229.07	-222.96	1.06	0.18	6.07
4,707.00	10.20	344.80	4,644.24	618.75	-233.21	-226.94	0.36	0.19	-1.76
4,801.00	10.73	342.34	4,736.68	635.12	-238.05	-231.61	0.74	0.56	-2.62
4,895.00	9.41	340.76	4,829.23	650.72	-243.24	-236.64	1.43	-1.40	-1.68
4,989.00	7.30	340.85	4,922.23	663.62	-247.73	-241.00	2.24	-2.24	0.10
5,084.00	5.98	340.76	5,016.59	673.99	-251.34	-244.50	1.39	-1.39	-0.09
5,178.00	4.84	339.79	5,110.17	682.34	-254.32	-247.40	1.22	-1.21	-1.03
5,272.00	3.69	329.33	5,203.91	688.66	-257.24	-250.25	1.47	-1.22	-11.13
5,366.00	2.90	330.13	5,297.75	693.32	-259.96	-252.93	0.84	-0.84	0.85
5,460.00	1.85	309.82	5,391.67	696.36	-262.31	-255.25	1.42	-1.12	-21.61
5,555.00	1.41	306.66	5,486.63	698.04	-264.43	-257.35	0.47	-0.46	-3.33

Company:	Bill Barrett Corp.	Local Co-ordinate Reference:	Well Anschutz Equus Farms 4-62-9-3225B2
Project:	Weld County, CO NAD 83	TVD Reference:	GL 4528' & KB 16' @ 4544.00ft
Site:	Anschutz Equus Farms 4-62-9_10 CW2 Pad	MD Reference:	GL 4528' & KB 16' @ 4544.00ft
Well:	Anschutz Equus Farms 4-62-9-3225B2	North Reference:	True
Wellbore:	OH	Survey Calculation Method:	Minimum Curvature
Design:	OH	Database:	Casper District

Survey										
Measured Depth (ft)	Inclination (°)	Azimuth (°)	Vertical Depth (ft)	+N/-S (ft)	+E/-W (ft)	Vertical Section (ft)	Dogleg Rate (°/100ft)	Build Rate (°/100ft)	Turn Rate (°/100ft)	
5,650.00	0.79	193.19	5,581.62	698.10	-265.51	-258.43	1.97	-0.65	-119.44	
5,745.00	0.47	169.82	5,676.61	697.08	-265.60	-258.53	0.43	-0.34	-24.60	
5,838.00	8.71	83.33	5,769.25	697.52	-258.52	-251.45	9.35	8.86	-93.00	
5,933.00	20.40	81.83	5,861.05	700.72	-234.90	-227.80	12.31	12.31	-1.58	
6,027.00	30.60	85.26	5,945.78	705.04	-194.74	-187.59	10.96	10.85	3.65	
6,121.00	38.60	89.31	6,023.10	707.37	-141.48	-134.31	8.85	8.51	4.31	
6,216.00	49.33	85.97	6,091.39	710.27	-75.71	-68.51	11.55	11.29	-3.52	
6,310.00	64.72	82.45	6,142.41	718.41	2.47	9.74	16.67	16.37	-3.74	
6,405.00	74.22	88.69	6,175.72	725.12	91.03	98.36	11.73	10.00	6.57	
6,499.00	80.20	93.17	6,196.53	723.59	182.61	189.93	7.88	6.36	4.77	
6,550.00	84.45	94.95	6,203.34	720.01	233.02	240.29	9.02	8.33	3.49	
Last SDI MWD Curve Survey										
6,683.00	89.96	94.40	6,209.82	709.19	365.36	372.53	4.16	4.14	-0.41	
First SDI MWD Lateral Survey										
6,778.00	90.75	93.35	6,209.23	702.77	460.14	467.23	1.38	0.83	-1.11	
6,873.00	90.13	91.59	6,208.50	698.67	555.05	562.09	1.96	-0.65	-1.85	
6,967.00	90.40	92.56	6,208.07	695.27	648.98	655.99	1.07	0.29	1.03	
7,062.00	90.92	90.18	6,206.97	693.00	743.94	750.92	2.56	0.55	-2.51	
7,156.00	90.48	89.66	6,205.82	693.13	837.94	844.91	0.72	-0.47	-0.55	
7,250.00	90.13	89.13	6,205.32	694.12	931.93	938.91	0.68	-0.37	-0.56	
7,344.00	90.31	90.01	6,204.96	694.83	1,025.93	1,032.91	0.96	0.19	0.94	
7,438.00	90.66	91.33	6,204.17	693.73	1,119.91	1,126.88	1.45	0.37	1.40	
7,533.00	90.57	89.57	6,203.15	692.98	1,214.90	1,221.85	1.85	-0.09	-1.85	
7,628.00	90.04	90.01	6,202.64	693.33	1,309.90	1,316.85	0.73	-0.56	0.46	
7,722.00	89.96	89.22	6,202.64	693.96	1,403.90	1,410.85	0.84	-0.09	-0.84	
7,816.00	91.28	88.87	6,201.62	695.53	1,497.87	1,504.84	1.45	1.40	-0.37	
7,911.00	91.80	88.87	6,199.07	697.40	1,592.82	1,599.80	0.55	0.55	0.00	
8,005.00	92.95	89.13	6,195.18	699.04	1,686.72	1,693.71	1.25	1.22	0.28	
8,099.00	92.15	89.39	6,190.99	700.25	1,780.62	1,787.62	0.89	-0.85	0.28	
8,193.00	90.92	89.04	6,188.48	701.54	1,874.58	1,881.58	1.36	-1.31	-0.37	
8,287.00	89.16	88.25	6,188.41	703.76	1,968.55	1,975.57	2.05	-1.87	-0.84	
8,381.00	91.10	89.13	6,188.20	705.91	2,062.52	2,069.56	2.27	2.06	0.94	
8,476.00	90.04	89.39	6,187.25	707.14	2,157.50	2,164.55	1.15	-1.12	0.27	
8,570.00	90.04	89.92	6,187.19	707.70	2,251.50	2,258.55	0.56	0.00	0.56	
8,665.00	89.87	90.80	6,187.26	707.11	2,346.50	2,353.54	0.94	-0.18	0.93	
8,759.00	89.43	89.74	6,187.84	706.66	2,440.49	2,447.52	1.22	-0.47	-1.13	
8,853.00	89.87	88.95	6,188.41	707.74	2,534.49	2,541.52	0.96	0.47	-0.84	
8,947.00	89.52	88.34	6,188.91	709.96	2,628.46	2,635.51	0.75	-0.37	-0.65	
9,041.00	90.92	87.99	6,188.55	712.97	2,722.41	2,729.48	1.54	1.49	-0.37	
9,136.00	91.36	89.13	6,186.66	715.36	2,817.36	2,824.45	1.29	0.46	1.20	
9,231.00	90.75	89.13	6,184.91	716.80	2,912.33	2,919.43	0.64	-0.64	0.00	
9,324.00	90.04	89.31	6,184.27	718.07	3,005.32	3,012.43	0.79	-0.76	0.19	
9,419.00	90.48	89.48	6,183.84	719.07	3,100.31	3,107.43	0.50	0.46	0.18	
9,513.00	89.25	88.43	6,184.06	720.78	3,194.29	3,201.42	1.72	-1.31	-1.12	

Company:	Bill Barrett Corp.	Local Co-ordinate Reference:	Well Anschutz Equus Farms 4-62-9-3225B2
Project:	Weld County, CO NAD 83	TVD Reference:	GL 4528' & KB 16' @ 4544.00ft
Site:	Anschutz Equus Farms 4-62-9_10 CW2 Pad	MD Reference:	GL 4528' & KB 16' @ 4544.00ft
Well:	Anschutz Equus Farms 4-62-9-3225B2	North Reference:	True
Wellbore:	OH	Survey Calculation Method:	Minimum Curvature
Design:	OH	Database:	Casper District

Survey									
Measured Depth (ft)	Inclination (°)	Azimuth (°)	Vertical Depth (ft)	+N/-S (ft)	+E/-W (ft)	Vertical Section (ft)	Dogleg Rate (°/100ft)	Build Rate (°/100ft)	Turn Rate (°/100ft)
9,608.00	89.08	88.34	6,185.44	723.46	3,289.24	3,296.40	0.20	-0.18	-0.09
9,702.00	89.52	88.51	6,186.59	726.04	3,383.20	3,390.38	0.50	0.47	0.18
9,797.00	89.78	88.78	6,187.17	728.29	3,478.17	3,485.37	0.39	0.27	0.28
9,891.00	90.48	88.78	6,186.96	730.29	3,572.15	3,579.36	0.74	0.74	0.00
9,986.00	90.81	89.31	6,185.89	731.88	3,667.13	3,674.35	0.66	0.35	0.56
10,081.00	89.60	88.16	6,185.55	733.97	3,762.10	3,769.34	1.76	-1.27	-1.21
10,172.00	91.01	88.78	6,185.07	736.40	3,853.07	3,860.32	1.69	1.55	0.68
10,264.00	90.22	88.69	6,184.08	738.43	3,945.04	3,952.31	0.86	-0.86	-0.10
10,356.00	89.77	88.85	6,184.09	740.41	4,037.02	4,044.30	0.52	-0.49	0.17
10,447.00	90.48	89.22	6,183.89	741.94	4,128.00	4,135.30	0.88	0.78	0.41
10,539.00	91.36	89.74	6,182.41	742.78	4,219.99	4,227.29	1.11	0.96	0.57
10,630.00	90.66	89.48	6,180.81	743.39	4,310.97	4,318.27	0.82	-0.77	-0.29
10,721.00	90.92	89.22	6,179.55	744.43	4,401.95	4,409.26	0.40	0.29	-0.29
10,813.00	89.43	87.72	6,179.27	746.88	4,493.92	4,501.25	2.30	-1.62	-1.63
10,904.00	90.57	88.16	6,179.27	750.15	4,584.86	4,592.21	1.34	1.25	0.48
10,995.00	90.84	88.69	6,178.15	752.66	4,675.81	4,683.19	0.65	0.30	0.58
11,087.00	89.96	88.16	6,177.51	755.18	4,767.78	4,775.18	1.12	-0.96	-0.58
11,179.00	90.92	88.78	6,176.80	757.64	4,859.74	4,867.16	1.24	1.04	0.67
11,270.00	91.63	89.66	6,174.78	758.88	4,950.71	4,958.13	1.24	0.78	0.97
11,362.00	91.89	89.31	6,171.95	759.71	5,042.66	5,050.09	0.47	0.28	-0.38
11,454.00	90.75	89.57	6,169.83	760.60	5,134.63	5,142.06	1.27	-1.24	0.28
11,545.00	90.34	88.94	6,168.97	761.79	5,225.62	5,233.06	0.83	-0.45	-0.69
11,636.00	90.48	88.78	6,168.32	763.60	5,316.60	5,324.05	0.23	0.15	-0.18
11,727.00	90.48	88.87	6,167.55	765.46	5,407.57	5,415.04	0.10	0.00	0.10
11,819.00	90.48	89.39	6,166.78	766.86	5,499.56	5,507.04	0.57	0.00	0.57
11,910.00	90.40	89.22	6,166.08	767.96	5,590.55	5,598.04	0.21	-0.09	-0.19
12,002.00	90.84	89.83	6,165.09	768.73	5,682.54	5,690.03	0.82	0.48	0.66
12,094.00	91.19	89.22	6,163.46	769.49	5,774.52	5,782.02	0.76	0.38	-0.66
12,185.00	91.71	89.22	6,161.16	770.73	5,865.48	5,872.99	0.57	0.57	0.00
12,277.00	90.31	89.66	6,159.53	771.63	5,957.46	5,964.97	1.60	-1.52	0.48
12,369.00	90.66	89.66	6,158.76	772.17	6,049.46	6,056.96	0.38	0.38	0.00
12,461.00	90.13	89.22	6,158.12	773.07	6,141.45	6,148.96	0.75	-0.58	-0.48
12,552.00	90.22	88.78	6,157.84	774.66	6,232.44	6,239.96	0.49	0.10	-0.48
12,644.00	90.40	88.16	6,157.35	777.12	6,324.40	6,331.94	0.70	0.20	-0.67
12,735.00	89.78	88.43	6,157.20	779.82	6,415.36	6,422.93	0.74	-0.68	0.30
12,827.00	90.66	90.62	6,156.85	780.59	6,507.35	6,514.92	2.57	0.96	2.38
12,918.00	91.28	90.89	6,155.31	779.39	6,598.33	6,605.88	0.74	0.68	0.30
13,010.00	92.15	91.15	6,152.56	777.75	6,690.27	6,697.80	0.99	0.95	0.28
13,101.00	90.92	90.71	6,150.12	776.27	6,781.23	6,788.74	1.44	-1.35	-0.48
13,193.00	90.13	90.71	6,149.27	775.13	6,873.21	6,880.71	0.86	-0.86	0.00
13,284.00	90.48	91.33	6,148.79	773.51	6,964.20	6,971.67	0.78	0.38	0.68
13,376.00	89.78	90.54	6,148.58	772.01	7,056.18	7,063.64	1.15	-0.76	-0.86
13,467.00	89.52	90.10	6,149.14	771.51	7,147.18	7,154.62	0.56	-0.29	-0.48

Company:	Bill Barrett Corp.	Local Co-ordinate Reference:	Well Anschutz Equus Farms 4-62-9-3225B2
Project:	Weld County, CO NAD 83	TVD Reference:	GL 4528' & KB 16' @ 4544.00ft
Site:	Anschutz Equus Farms 4-62-9_10 CW2 Pad	MD Reference:	GL 4528' & KB 16' @ 4544.00ft
Well:	Anschutz Equus Farms 4-62-9-3225B2	North Reference:	True
Wellbore:	OH	Survey Calculation Method:	Minimum Curvature
Design:	OH	Database:	Casper District

Survey									
Measured Depth (ft)	Inclination (°)	Azimuth (°)	Vertical Depth (ft)	+N/-S (ft)	+E/-W (ft)	Vertical Section (ft)	Dogleg Rate (°/100ft)	Build Rate (°/100ft)	Turn Rate (°/100ft)
13,558.00	89.25	90.54	6,150.11	771.00	7,238.17	7,245.61	0.57	-0.30	0.48
13,650.00	89.34	90.36	6,151.25	770.27	7,330.16	7,337.59	0.22	0.10	-0.20
13,742.00	89.16	89.83	6,152.45	770.12	7,422.16	7,429.57	0.61	-0.20	-0.58
13,833.00	90.22	89.57	6,152.94	770.60	7,513.15	7,520.57	1.20	1.16	-0.29
13,925.00	91.45	89.74	6,151.60	771.15	7,605.14	7,612.55	1.35	1.34	0.18
14,016.00	90.48	88.87	6,150.07	772.26	7,696.12	7,703.54	1.43	-1.07	-0.96
14,107.00	90.66	89.31	6,149.16	773.70	7,787.10	7,794.53	0.52	0.20	0.48
14,199.00	90.92	87.37	6,147.90	776.37	7,879.05	7,886.50	2.13	0.28	-2.11
14,290.00	90.40	88.43	6,146.85	779.70	7,969.98	7,977.46	1.30	-0.57	1.16
14,382.00	90.57	88.34	6,146.07	782.29	8,061.94	8,069.45	0.21	0.18	-0.10
14,473.00	91.19	89.66	6,144.67	783.88	8,152.91	8,160.43	1.60	0.68	1.45
14,564.00	91.10	89.13	6,142.85	784.84	8,243.89	8,251.41	0.59	-0.10	-0.58
14,656.00	91.36	88.07	6,140.88	787.09	8,335.84	8,343.38	1.19	0.28	-1.15
14,748.00	90.22	87.90	6,139.61	790.32	8,427.77	8,435.34	1.25	-1.24	-0.18
14,839.00	90.40	87.90	6,139.12	793.66	8,518.71	8,526.31	0.20	0.20	0.00
14,931.00	90.31	87.37	6,138.55	797.45	8,610.63	8,618.26	0.58	-0.10	-0.58
15,023.00	90.74	89.54	6,137.70	799.93	8,702.59	8,710.24	2.40	0.47	2.36
15,114.00	91.28	89.13	6,136.10	800.99	8,793.56	8,801.22	0.75	0.59	-0.45
15,206.00	91.45	88.69	6,133.91	802.74	8,885.52	8,893.19	0.51	0.18	-0.48
15,298.00	91.19	88.51	6,131.79	804.99	8,977.47	8,985.16	0.34	-0.28	-0.20
15,392.00	91.19	87.37	6,129.84	808.37	9,071.39	9,079.11	1.21	0.00	-1.21
15,486.00	90.13	89.13	6,128.75	811.24	9,165.33	9,173.07	2.19	-1.13	1.87
15,581.00	90.31	88.78	6,128.39	812.97	9,260.32	9,268.07	0.41	0.19	-0.37
15,675.00	90.74	88.49	6,127.53	815.21	9,354.28	9,362.06	0.55	0.46	-0.31
15,770.00	91.01	87.55	6,126.08	818.49	9,449.22	9,457.02	1.03	0.28	-0.99
15,864.00	91.01	87.28	6,124.42	822.73	9,543.11	9,550.94	0.29	0.00	-0.29
15,945.00	91.45	86.33	6,122.68	827.24	9,623.96	9,631.84	1.29	0.54	-1.17
Last SDI MWD Survey									
16,003.00	91.45	86.33	6,121.21	830.95	9,681.82	9,689.74	0.00	0.00	0.00
Projection to TD									

Design Annotations				
Measured Depth (ft)	Vertical Depth (ft)	Local Coordinates		Comment
		+N/-S (ft)	+E/-W (ft)	
885.00	885.00	-0.04	-0.39	First SDI MWD Survey
6,550.00	6,203.34	720.01	233.02	Last SDI MWD Curve Survey
6,683.00	6,209.82	709.19	365.36	First SDI MWD Lateral Survey
15,945.00	6,122.68	827.24	9,623.96	Last SDI MWD Survey
16,003.00	6,121.21	830.95	9,681.82	Projection to TD

Checked By: _____	Approved By: _____	Date: _____
-------------------	--------------------	-------------