

# PROPOSED PAD CONTOURS RAEL WELL PAD

SECTION: 27  
TOWNSHIP: 1N  
RANGE: 66W

CONTOUR INTERVAL=1'

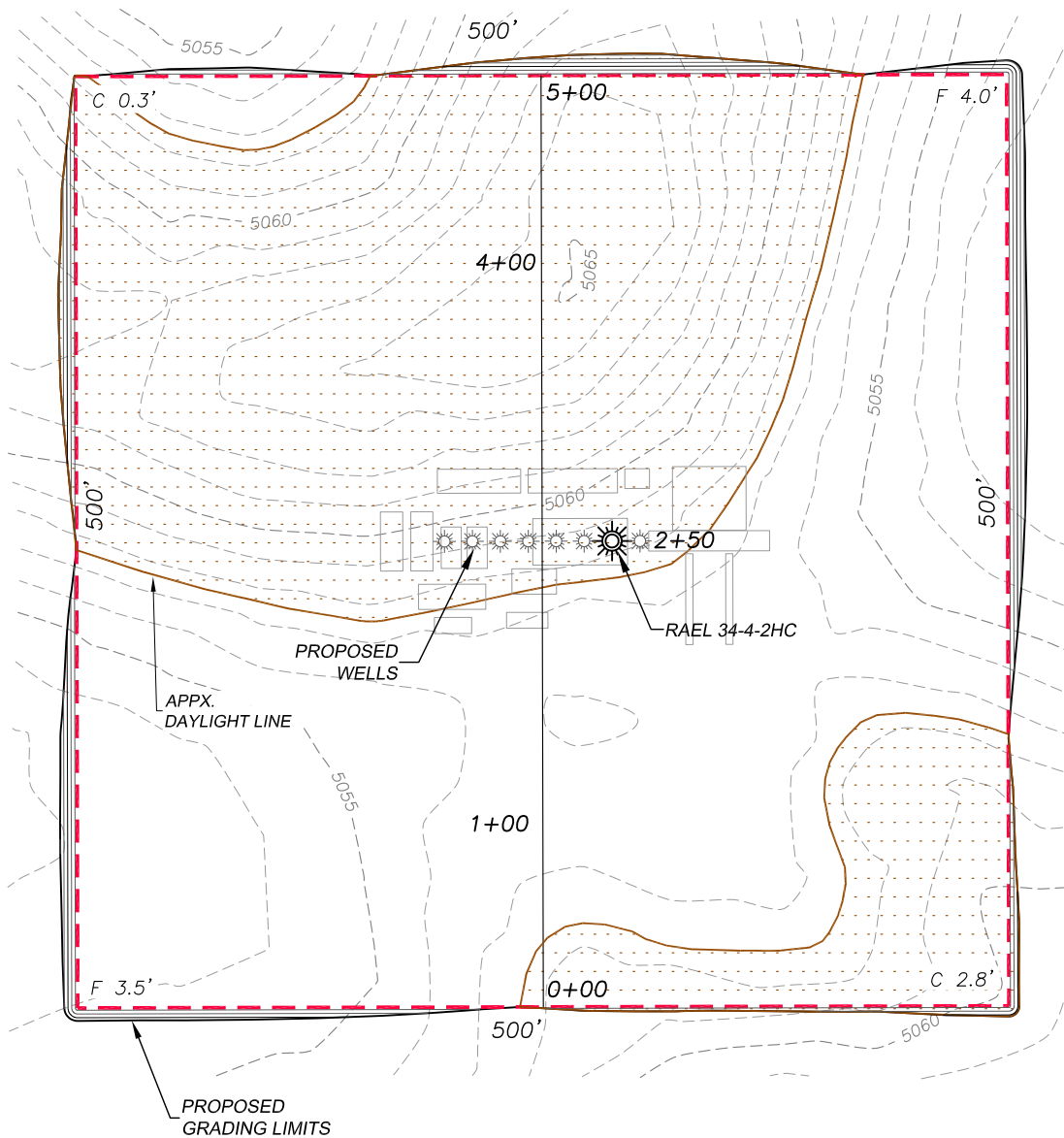

## PROPOSED PAD

Top of pad elevation: 5057.6'  
Cut slope ratio: 2.0  
Fill slope ratio: 2.0  
Cut Swell Factor: 1.00  
Fill Shrink Factor: 1.00

## PAD EARTHWORK VOLUMES

Total cut: 14932± C.Y.  
Total fill: 10082± C.Y.  
Balance Export: 4850± C.Y.  
(6" Topsoil)  
Area: 6.0 Acres



AREA OF  
PROPOSED CUT

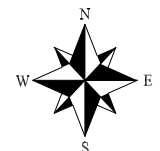

SCALE: 1" = 100'

# PROPOSED PAD CROSS SECTIONS

## RAEL WELL PAD

SECTION: 27  
TOWNSHIP: 1N  
RANGE: 66W

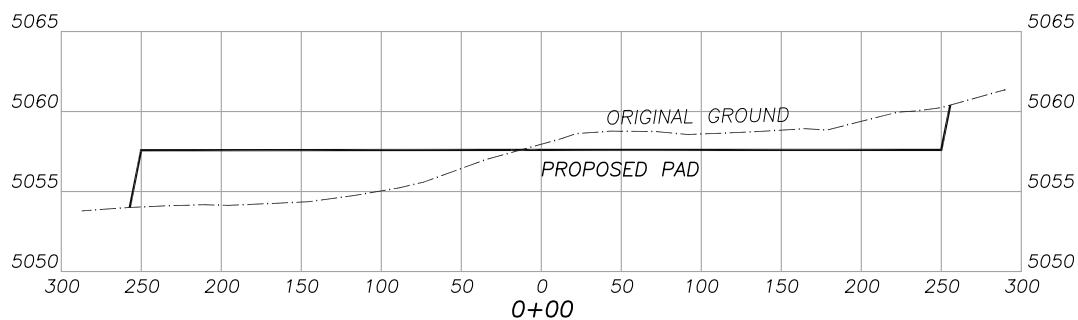
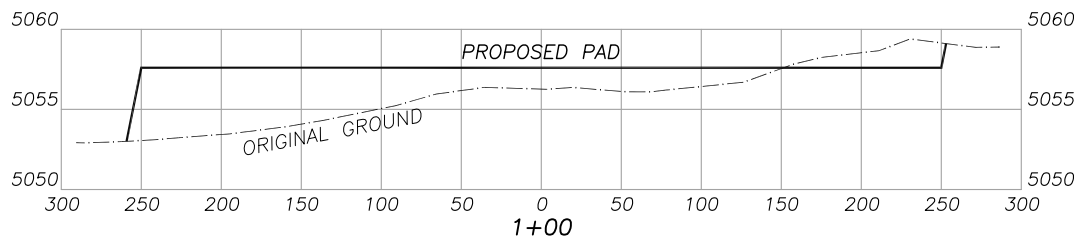
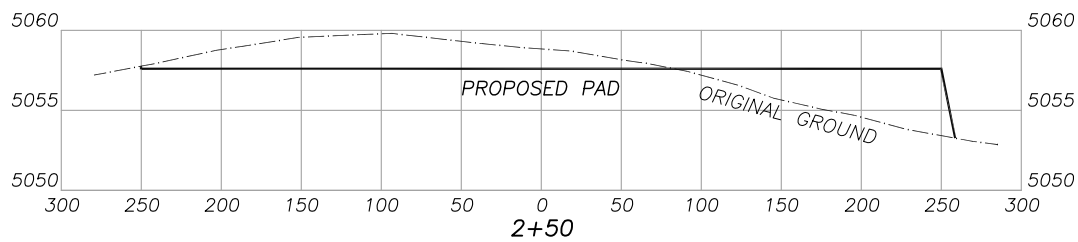
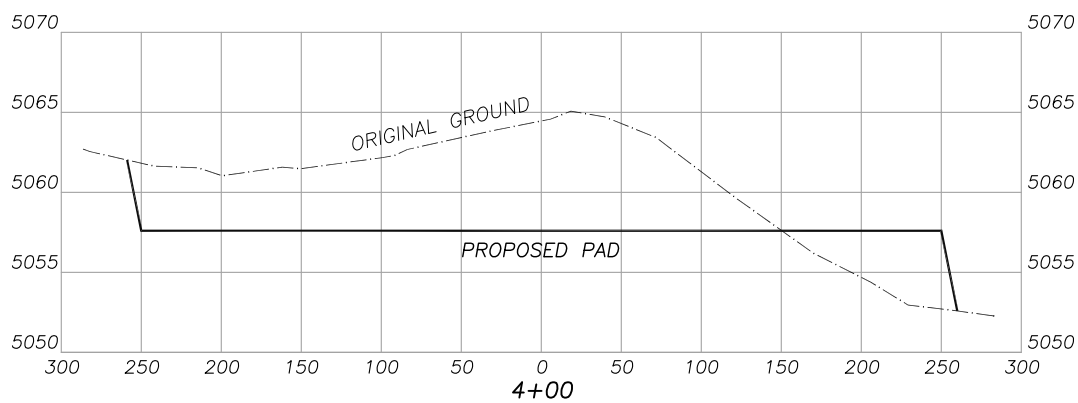
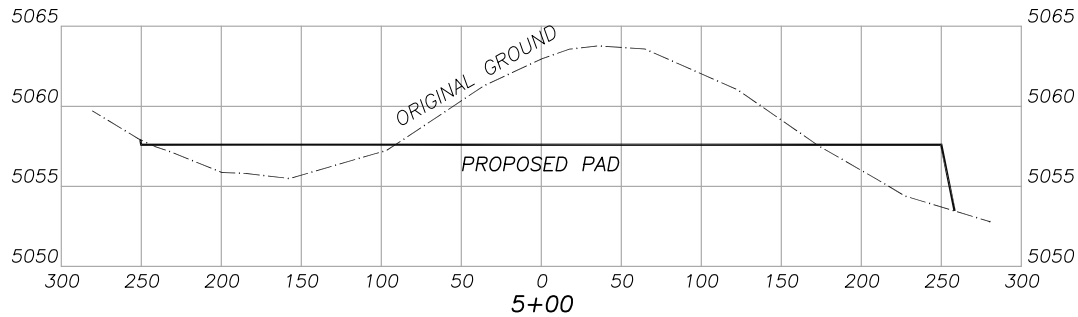

Horizontal Scale 50  
Vertical Scale 5