

DALEY LAND SURVEYING, INC. PARKER, CO. 80134 303 953 9841
LOCATION DRAWING – RAEI PRODUCTION FACILITY PAD

SECTION: 27
TOWNSHIP: 1N
RANGE: 66W

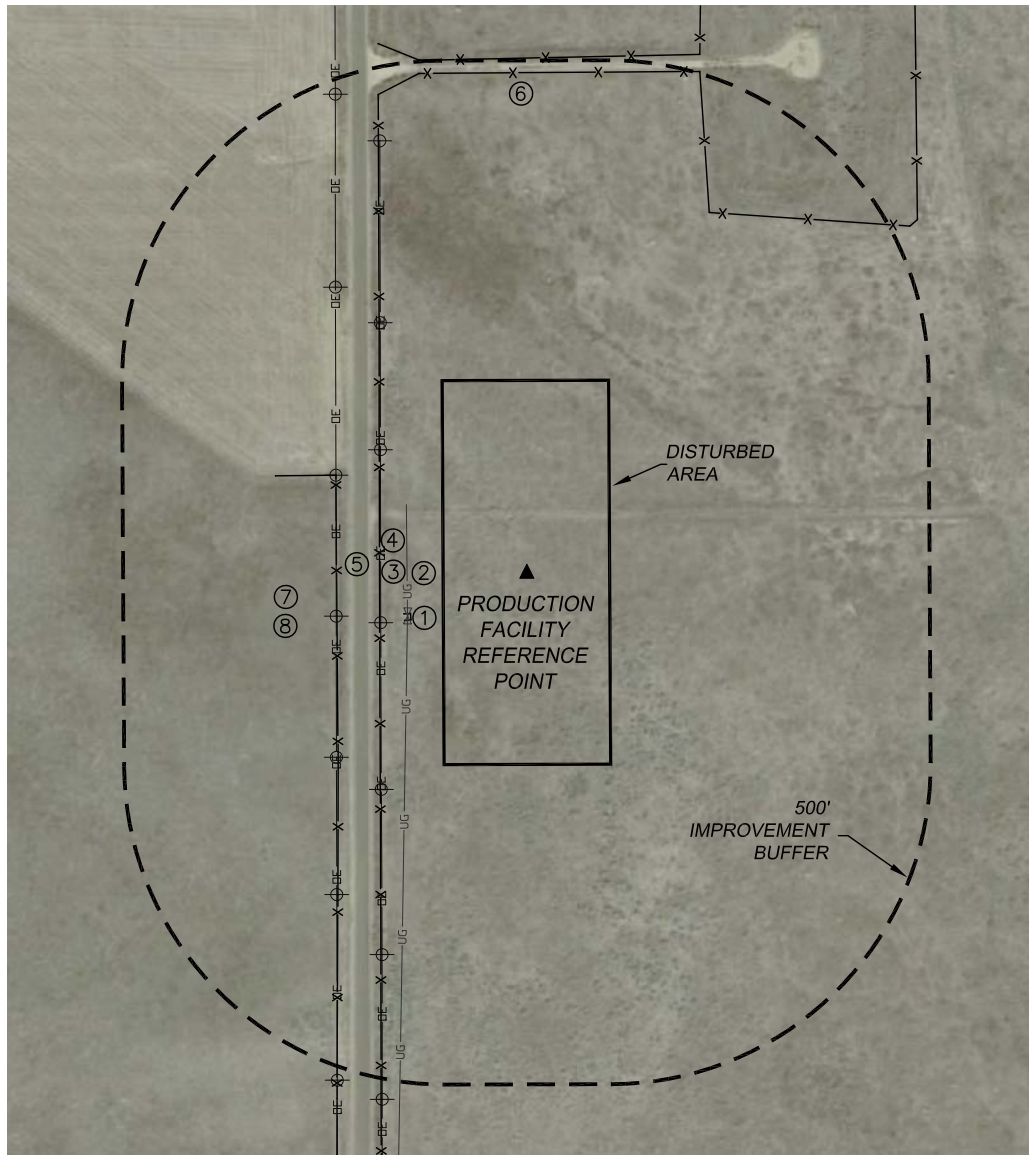

RAEL PRODUCTION FACILITY
REFERENCE POINT

NAD 83 LATITUDE AND LONGITUDE

SURFACE LOCATION:

LATITUDE: N40.01824°
LONGITUDE: W104.77177°
ELEV: 5051'
PDOP: 1.3
QTR/QTR: SW4/SW4
FOOTAGE: 1195' FSL
262' FWL
INST. OPERATOR: TREVOR DALEY
FIELD DATE: 2/8/2016

NEAREST CULTURAL ITEMS:

(AS MEASURED FROM THE NEAREST EDGE OF
PRODUCTION CLOSEST TO THE REFERENCED
CULTURAL ITEM).

BUILDING: 1445'± SW
BUILDING UNIT: 1009'± SW
HIGH OCC. BLD. UNIT: 5280'+
DES. OUTSIDE ACTIVITY AREA: 5280'+
PUBLIC ROAD: 121'± W
ABOVE GRND UTILITY: 98'± W
RAILROAD: 5280'+
PROP. LINE: 132'± W

IMPROVEMENTS:

(MEASURED FROM THE PRODUCTION
FACILITY REFERENCE POINT).

1. GAS VALVE: 200'± SW
2. GAS LINE: 185'± W
3. O.H. UTILITY: 228'± W
298'± W
4. WIRE FENCE: 230'± W
297'± W
630'± NE
5. COUNTY ROAD: 250'± W
6. WELL ACC. RD.: 793'± N

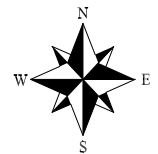

0 300
SCALE: 1" = 300'