



Physical Address: 34834 Annie Cir.  
Mail to: Box 2372, Elizabeth, CO 80107  
Ph. 303-243-0037  
[www.franesurveying.com](http://www.franesurveying.com)

# Site Layout BOYD FARMS 41-28

Frane Surveying of Elizabeth, Colorado, in accordance with a request from **True Oil LLC.**, has determined the location of **BOYD FARMS 41-28** to be **695 feet FNL**, and **726 feet FEL** (90° off Section lines) of Section **28**, Township **6s**, Range **54w** of the 6th Principal Meridian, **Lincoln County**, Colorado.

**Date:** Staked on 02/18/16 drawn on 02/19/16.

**Re:** Staked by Elijah Frane  
**Drawn:** Drawn by Andre Schafer

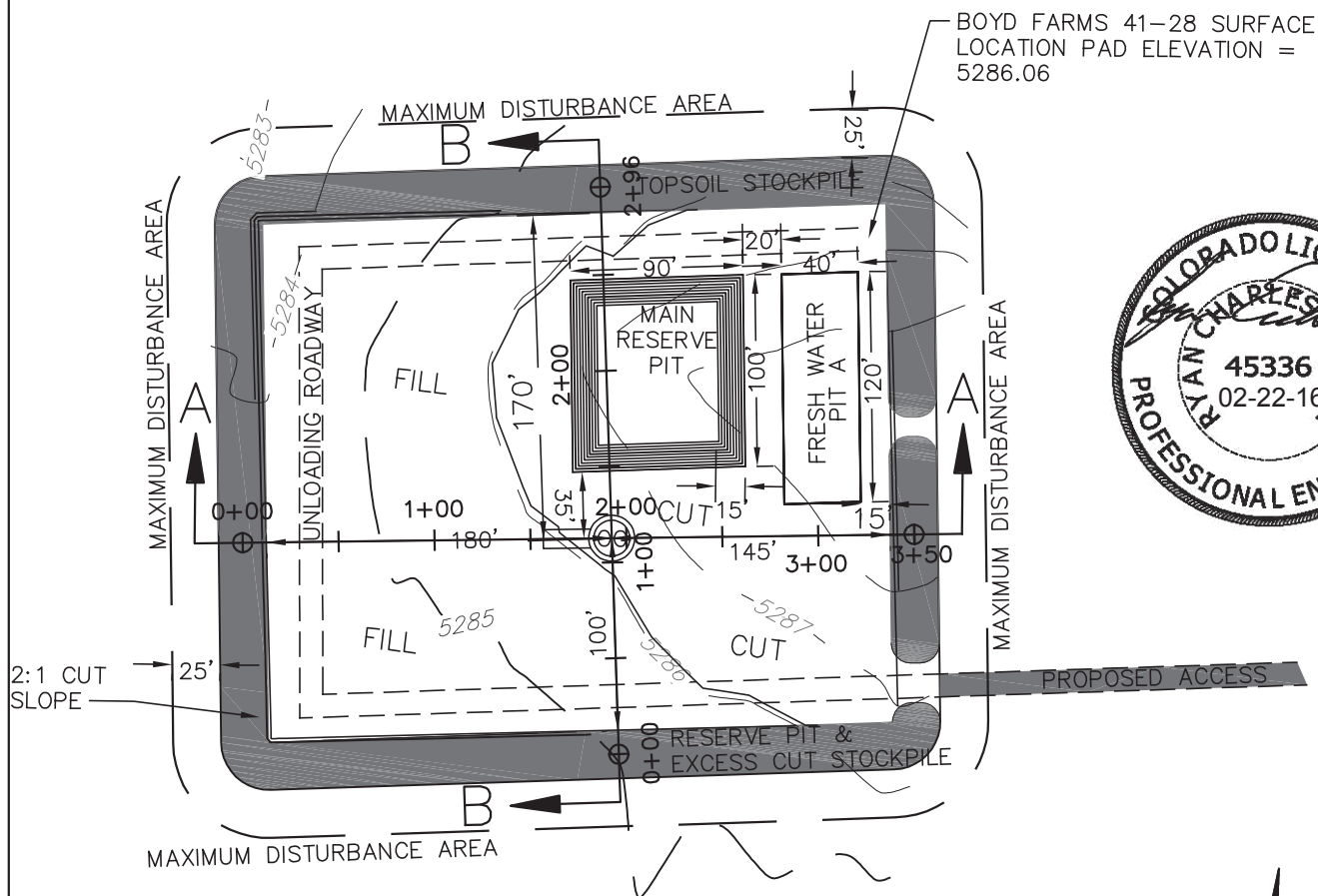

## EARTHWORK VOLUME SUMMARY (CY)

	CUT	FILL	5% COMPACTION	EXCESS
6" TOPSOIL	1625			
PAD	264.34	1790.4		
MAIN RESERVE PIT	2389.39			
FRESH WATER PIT A	1375.5			
TOTAL	5654.23	1790.4		3863.8

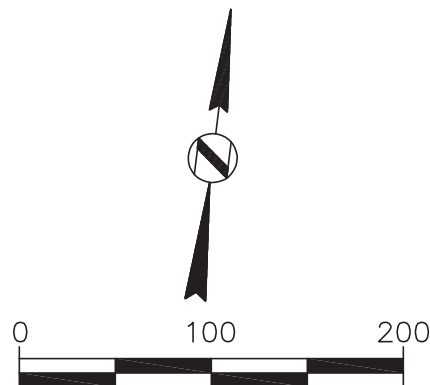

SCALE : 1" = 100'