

PROJECT DETAILS: Weld County, CO NAD 83

Geodetic System: US State Plane 1983
Datum: North American Datum 1983
Ellipsoid: GRS 1980
Zone: Colorado Northern Zone
System Datum: Mean Sea Level
Local North: True

Project: Weld County, CO NAD 83
Site: Anschutz Equus Farms 3-62-4.5 CE2 Pad
Well: Anschutz Equus Farms 03-62-04-4033B2
Wellbore: OH
Design: Plan #1



Azimuths to True North
Magnetic North: 8.22°

Magnetic Field
Strength: 52545.3snT
Dip Angle: 66.91°
Date: 2/10/2016
Model: BGGM2015

SECTION DETAILS

MD	Inc	Azi	TVD	+N/-S	+E/-W	Dleg	TFace	VSect
0.00	0.00	0.00	0.00	0.00	0.00	0.00	0.00	0.00
800.00	0.00	0.00	800.00	0.00	0.00	0.00	0.00	0.00
1300.29	10.01	127.77	1297.75	-26.69	34.44	2.00	127.77	-33.88
2990.50	10.01	127.77	2962.25	-206.55	266.59	0.00	0.00	-262.25
3490.79	0.00	0.00	3460.00	-233.24	301.03	2.00	180.00	-296.13
5716.33	0.00	0.00	5685.54	-233.24	301.03	0.00	0.00	-296.13
6464.34	89.76	270.17	6163.00	-231.79	-174.44	12.00	270.17	179.21
16067.42	89.76	270.17	6203.00	-202.53	-9777.40	0.00	0.00	9779.49

Plan: Plan #1 (Anschutz Equus Farms 03-62-04-4033B2/OH)

Created By: rscott Date: 18:26, February 15 2016

WELL DETAILS: Anschutz Equus Farms 03-62-04-4033B2

GL 4613 & @ 4613.00ft 4613.00
+N/-S +E/-W Northing Easting Latitude Longitude
0.00 0.00 1337782.91 3329197.79 40° 15' 16.571 N 104° 19' 13.800 W

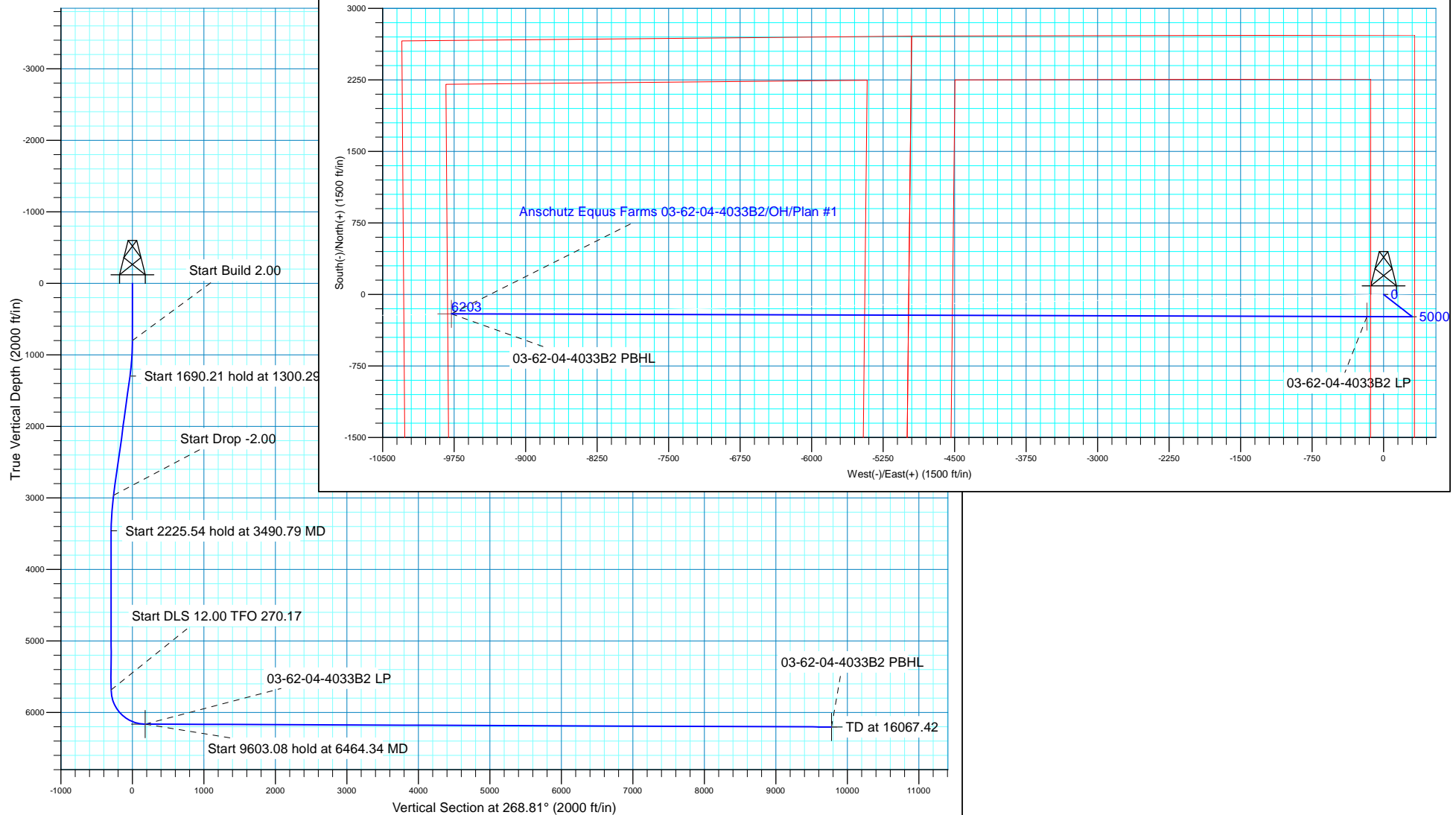



Bill Barrett Corp.

Weld County, CO NAD 83

Anschutz Equus Farms 3-62-4_5 CE2 Pad

Anschutz Equus Farms 03-62-04-4033B2

OH

Plan: Plan #1

Standard Planning Report

15 February, 2016



Database:	Casper District	Local Co-ordinate Reference:	Well Anschutz Equus Farms 03-62-04-4033B2
Company:	Bill Barrett Corp.	TVD Reference:	GL 4613 & @ 4613.00ft
Project:	Weld County, CO NAD 83	MD Reference:	GL 4613 & @ 4613.00ft
Site:	Anschutz Equus Farms 3-62-4_5 CE2 Pad	North Reference:	True
Well:	Anschutz Equus Farms 03-62-04-4033B2	Survey Calculation Method:	Minimum Curvature
Wellbore:	OH		
Design:	Plan #1		

Project	Weld County, CO NAD 83		
Map System:	US State Plane 1983	System Datum:	Mean Sea Level
Geo Datum:	North American Datum 1983		
Map Zone:	Colorado Northern Zone		

Site	Anschutz Equus Farms 3-62-4_5 CE2 Pad, SECTION 4, T3N, R62W, 6TH P.M.			
Site Position:		Northing:	1,337,767.63 usft	Latitude: 40° 15' 16.420 N
From:	Lat/Long	Easting:	3,329,198.00 usft	Longitude: 104° 19' 13.800 W
Position Uncertainty:	0.00 ft	Slot Radius:	13.200 in	Grid Convergence: 0.76 °

Well	Anschutz Equus Farms 03-62-04-4033B2, 2505 FSL 325 FEL			
Well Position	+N/-S	15.28 ft	Northing:	1,337,782.91 usft
	+E/-W	0.00 ft	Easting:	3,329,197.80 usft
Position Uncertainty		0.00 ft	Wellhead Elevation:	0.00 ft
			Ground Level:	4,613.00 ft

Wellbore	OH				
Magnetics	Model Name	Sample Date	Declination (°)	Dip Angle (°)	Field Strength (nT)
	BGGM2015	2/10/2016	8.22	66.91	52,545

Design	Plan #1			
Audit Notes:				
Version:	Phase:	PLAN	Tie On Depth:	0.00
Vertical Section:	Depth From (TVD) (ft)	+N/-S (ft)	+E/-W (ft)	Direction (°)
	0.00	0.00	0.00	268.81

Plan Sections										
Measured Depth (ft)	Inclination (°)	Azimuth (°)	Vertical Depth (ft)	+N/-S (ft)	+E/-W (ft)	Dogleg Rate (°/100ft)	Build Rate (°/100ft)	Turn Rate (°/100ft)	TFO (°)	Target
0.00	0.00	0.00	0.00	0.00	0.00	0.00	0.00	0.00	0.00	
800.00	0.00	0.00	800.00	0.00	0.00	0.00	0.00	0.00	0.00	
1,300.29	10.01	127.77	1,297.75	-26.69	34.44	2.00	2.00	0.00	127.77	
2,990.50	10.01	127.77	2,962.25	-206.55	266.59	0.00	0.00	0.00	0.00	
3,490.79	0.00	0.00	3,460.00	-233.24	301.03	2.00	-2.00	0.00	180.00	
5,716.33	0.00	0.00	5,685.54	-233.24	301.03	0.00	0.00	0.00	0.00	
6,464.34	89.76	270.17	6,163.00	-231.79	-174.44	12.00	12.00	-12.01	270.17	
16,067.42	89.76	270.17	6,203.00	-202.53	-9,777.40	0.00	0.00	0.00	0.00	03-62-04-4033B2 PBI

Database:	Casper District	Local Co-ordinate Reference:	Well Anschutz Equus Farms 03-62-04-4033B2
Company:	Bill Barrett Corp.	TVD Reference:	GL 4613 & @ 4613.00ft
Project:	Weld County, CO NAD 83	MD Reference:	GL 4613 & @ 4613.00ft
Site:	Anschutz Equus Farms 3-62-4_5 CE2 Pad	North Reference:	True
Well:	Anschutz Equus Farms 03-62-04-4033B2	Survey Calculation Method:	Minimum Curvature
Wellbore:	OH		
Design:	Plan #1		

Planned Survey										
Measured Depth (ft)	Inclination (°)	Azimuth (°)	Vertical Depth (ft)	+N/-S (ft)	+E/-W (ft)	Vertical Section (ft)	Dogleg Rate (°/100ft)	Build Rate (°/100ft)	Turn Rate (°/100ft)	
0.00	0.00	0.00	0.00	0.00	0.00	0.00	0.00	0.00	0.00	
100.00	0.00	0.00	100.00	0.00	0.00	0.00	0.00	0.00	0.00	
200.00	0.00	0.00	200.00	0.00	0.00	0.00	0.00	0.00	0.00	
300.00	0.00	0.00	300.00	0.00	0.00	0.00	0.00	0.00	0.00	
400.00	0.00	0.00	400.00	0.00	0.00	0.00	0.00	0.00	0.00	
500.00	0.00	0.00	500.00	0.00	0.00	0.00	0.00	0.00	0.00	
600.00	0.00	0.00	600.00	0.00	0.00	0.00	0.00	0.00	0.00	
700.00	0.00	0.00	700.00	0.00	0.00	0.00	0.00	0.00	0.00	
800.00	0.00	0.00	800.00	0.00	0.00	0.00	0.00	0.00	0.00	
Start Build 2.00										
900.00	2.00	127.77	899.98	-1.07	1.38	-1.36	2.00	2.00	0.00	
1,000.00	4.00	127.77	999.84	-4.27	5.52	-5.43	2.00	2.00	0.00	
1,100.00	6.00	127.77	1,099.45	-9.61	12.41	-12.20	2.00	2.00	0.00	
1,200.00	8.00	127.77	1,198.70	-17.08	22.04	-21.68	2.00	2.00	0.00	
1,300.00	10.00	127.77	1,297.47	-26.66	34.40	-33.84	2.00	2.00	0.00	
1,300.29	10.01	127.77	1,297.75	-26.69	34.44	-33.88	2.00	2.00	0.00	
Start 1690.21 hold at 1300.29 MD										
1,400.00	10.01	127.77	1,395.94	-37.30	48.14	-47.36	0.00	0.00	0.00	
1,500.00	10.01	127.77	1,494.42	-47.94	61.87	-60.87	0.00	0.00	0.00	
1,600.00	10.01	127.77	1,592.90	-58.58	75.61	-74.38	0.00	0.00	0.00	
1,700.00	10.01	127.77	1,691.38	-69.22	89.34	-87.89	0.00	0.00	0.00	
1,800.00	10.01	127.77	1,789.86	-79.86	103.08	-101.40	0.00	0.00	0.00	
1,900.00	10.01	127.77	1,888.34	-90.51	116.81	-114.91	0.00	0.00	0.00	
2,000.00	10.01	127.77	1,986.82	-101.15	130.55	-128.42	0.00	0.00	0.00	
2,100.00	10.01	127.77	2,085.30	-111.79	144.28	-141.93	0.00	0.00	0.00	
2,200.00	10.01	127.77	2,183.78	-122.43	158.02	-155.45	0.00	0.00	0.00	
2,300.00	10.01	127.77	2,282.26	-133.07	171.75	-168.96	0.00	0.00	0.00	
2,400.00	10.01	127.77	2,380.73	-143.71	185.48	-182.47	0.00	0.00	0.00	
2,500.00	10.01	127.77	2,479.21	-154.36	199.22	-195.98	0.00	0.00	0.00	
2,600.00	10.01	127.77	2,577.69	-165.00	212.95	-209.49	0.00	0.00	0.00	
2,700.00	10.01	127.77	2,676.17	-175.64	226.69	-223.00	0.00	0.00	0.00	
2,800.00	10.01	127.77	2,774.65	-186.28	240.42	-236.51	0.00	0.00	0.00	
2,900.00	10.01	127.77	2,873.13	-196.92	254.16	-250.02	0.00	0.00	0.00	
2,990.50	10.01	127.77	2,962.25	-206.55	266.59	-262.25	0.00	0.00	0.00	
Start Drop -2.00										
3,000.00	9.82	127.77	2,971.61	-207.55	267.88	-263.52	2.00	-2.00	0.00	
3,100.00	7.82	127.77	3,070.43	-216.94	279.99	-275.44	2.00	-2.00	0.00	
3,200.00	5.82	127.77	3,169.71	-224.21	289.37	-284.67	2.00	-2.00	0.00	
3,300.00	3.82	127.77	3,269.36	-229.35	296.01	-291.20	2.00	-2.00	0.00	
3,400.00	1.82	127.77	3,369.23	-232.36	299.89	-295.02	2.00	-2.00	0.00	
3,490.79	0.00	0.00	3,460.00	-233.24	301.03	-296.13	2.00	-2.00	0.00	
Start 2225.54 hold at 3490.79 MD										
3,500.00	0.00	0.00	3,469.21	-233.24	301.03	-296.13	0.00	0.00	0.00	
3,600.00	0.00	0.00	3,569.21	-233.24	301.03	-296.13	0.00	0.00	0.00	
3,700.00	0.00	0.00	3,669.21	-233.24	301.03	-296.13	0.00	0.00	0.00	
3,800.00	0.00	0.00	3,769.21	-233.24	301.03	-296.13	0.00	0.00	0.00	
3,900.00	0.00	0.00	3,869.21	-233.24	301.03	-296.13	0.00	0.00	0.00	
4,000.00	0.00	0.00	3,969.21	-233.24	301.03	-296.13	0.00	0.00	0.00	
4,100.00	0.00	0.00	4,069.21	-233.24	301.03	-296.13	0.00	0.00	0.00	
4,200.00	0.00	0.00	4,169.21	-233.24	301.03	-296.13	0.00	0.00	0.00	
4,300.00	0.00	0.00	4,269.21	-233.24	301.03	-296.13	0.00	0.00	0.00	
4,400.00	0.00	0.00	4,369.21	-233.24	301.03	-296.13	0.00	0.00	0.00	
4,500.00	0.00	0.00	4,469.21	-233.24	301.03	-296.13	0.00	0.00	0.00	

Database:	Casper District	Local Co-ordinate Reference:	Well Anschutz Equus Farms 03-62-04-4033B2
Company:	Bill Barrett Corp.	TVD Reference:	GL 4613 & @ 4613.00ft
Project:	Weld County, CO NAD 83	MD Reference:	GL 4613 & @ 4613.00ft
Site:	Anschutz Equus Farms 3-62-4_5 CE2 Pad	North Reference:	True
Well:	Anschutz Equus Farms 03-62-04-4033B2	Survey Calculation Method:	Minimum Curvature
Wellbore:	OH		
Design:	Plan #1		

Planned Survey									
Measured Depth (ft)	Inclination (°)	Azimuth (°)	Vertical Depth (ft)	+N/-S (ft)	+E/-W (ft)	Vertical Section (ft)	Dogleg Rate (°/100ft)	Build Rate (°/100ft)	Turn Rate (°/100ft)
4,600.00	0.00	0.00	4,569.21	-233.24	301.03	-296.13	0.00	0.00	0.00
4,700.00	0.00	0.00	4,669.21	-233.24	301.03	-296.13	0.00	0.00	0.00
4,800.00	0.00	0.00	4,769.21	-233.24	301.03	-296.13	0.00	0.00	0.00
4,900.00	0.00	0.00	4,869.21	-233.24	301.03	-296.13	0.00	0.00	0.00
5,000.00	0.00	0.00	4,969.21	-233.24	301.03	-296.13	0.00	0.00	0.00
5,100.00	0.00	0.00	5,069.21	-233.24	301.03	-296.13	0.00	0.00	0.00
5,200.00	0.00	0.00	5,169.21	-233.24	301.03	-296.13	0.00	0.00	0.00
5,300.00	0.00	0.00	5,269.21	-233.24	301.03	-296.13	0.00	0.00	0.00
5,400.00	0.00	0.00	5,369.21	-233.24	301.03	-296.13	0.00	0.00	0.00
5,500.00	0.00	0.00	5,469.21	-233.24	301.03	-296.13	0.00	0.00	0.00
5,600.00	0.00	0.00	5,569.21	-233.24	301.03	-296.13	0.00	0.00	0.00
5,700.00	0.00	0.00	5,669.21	-233.24	301.03	-296.13	0.00	0.00	0.00
5,716.33	0.00	0.00	5,685.54	-233.24	301.03	-296.13	0.00	0.00	0.00
Start DLS 12.00 TFO 270.17									
5,800.00	10.04	270.17	5,768.79	-233.22	293.72	-288.82	12.00	12.00	0.00
5,900.00	22.04	270.17	5,864.72	-233.13	266.14	-261.25	12.00	12.00	0.00
6,000.00	34.04	270.17	5,952.82	-232.99	219.21	-214.34	12.00	12.00	0.00
6,100.00	46.04	270.17	6,029.24	-232.80	155.00	-150.14	12.00	12.00	0.00
6,200.00	58.04	270.17	6,090.63	-232.56	76.29	-71.46	12.00	12.00	0.00
6,300.00	70.04	270.17	6,134.33	-232.28	-13.45	18.26	12.00	12.00	0.00
6,400.00	82.04	270.17	6,158.41	-231.99	-110.32	115.10	12.00	12.00	0.00
6,464.34	89.76	270.17	6,163.00	-231.79	-174.44	179.21	12.00	12.00	0.00
Start 9603.08 hold at 6464.34 MD - 03-62-04-4033B2 LP									
6,500.00	89.76	270.17	6,163.15	-231.68	-210.11	214.86	0.00	0.00	0.00
6,600.00	89.76	270.17	6,163.57	-231.38	-310.11	314.83	0.00	0.00	0.00
6,700.00	89.76	270.17	6,163.98	-231.07	-410.10	414.80	0.00	0.00	0.00
6,800.00	89.76	270.17	6,164.40	-230.77	-510.10	514.77	0.00	0.00	0.00
6,900.00	89.76	270.17	6,164.82	-230.46	-610.10	614.74	0.00	0.00	0.00
7,000.00	89.76	270.17	6,165.23	-230.16	-710.10	714.71	0.00	0.00	0.00
7,100.00	89.76	270.17	6,165.65	-229.85	-810.10	814.69	0.00	0.00	0.00
7,200.00	89.76	270.17	6,166.07	-229.55	-910.10	914.66	0.00	0.00	0.00
7,300.00	89.76	270.17	6,166.48	-229.25	-1,010.10	1,014.63	0.00	0.00	0.00
7,400.00	89.76	270.17	6,166.90	-228.94	-1,110.09	1,114.60	0.00	0.00	0.00
7,500.00	89.76	270.17	6,167.31	-228.64	-1,210.09	1,214.57	0.00	0.00	0.00
7,600.00	89.76	270.17	6,167.73	-228.33	-1,310.09	1,314.54	0.00	0.00	0.00
7,700.00	89.76	270.17	6,168.15	-228.03	-1,410.09	1,414.51	0.00	0.00	0.00
7,800.00	89.76	270.17	6,168.56	-227.72	-1,510.09	1,514.48	0.00	0.00	0.00
7,900.00	89.76	270.17	6,168.98	-227.42	-1,610.09	1,614.45	0.00	0.00	0.00
8,000.00	89.76	270.17	6,169.40	-227.11	-1,710.09	1,714.42	0.00	0.00	0.00
8,100.00	89.76	270.17	6,169.81	-226.81	-1,810.09	1,814.39	0.00	0.00	0.00
8,200.00	89.76	270.17	6,170.23	-226.50	-1,910.08	1,914.37	0.00	0.00	0.00
8,300.00	89.76	270.17	6,170.65	-226.20	-2,010.08	2,014.34	0.00	0.00	0.00
8,400.00	89.76	270.17	6,171.06	-225.89	-2,110.08	2,114.31	0.00	0.00	0.00
8,500.00	89.76	270.17	6,171.48	-225.59	-2,210.08	2,214.28	0.00	0.00	0.00
8,600.00	89.76	270.17	6,171.90	-225.28	-2,310.08	2,314.25	0.00	0.00	0.00
8,700.00	89.76	270.17	6,172.31	-224.98	-2,410.08	2,414.22	0.00	0.00	0.00
8,800.00	89.76	270.17	6,172.73	-224.68	-2,510.08	2,514.19	0.00	0.00	0.00
8,900.00	89.76	270.17	6,173.15	-224.37	-2,610.07	2,614.16	0.00	0.00	0.00
9,000.00	89.76	270.17	6,173.56	-224.07	-2,710.07	2,714.13	0.00	0.00	0.00
9,100.00	89.76	270.17	6,173.98	-223.76	-2,810.07	2,814.10	0.00	0.00	0.00
9,200.00	89.76	270.17	6,174.40	-223.46	-2,910.07	2,914.07	0.00	0.00	0.00
9,300.00	89.76	270.17	6,174.81	-223.15	-3,010.07	3,014.05	0.00	0.00	0.00
9,400.00	89.76	270.17	6,175.23	-222.85	-3,110.07	3,114.02	0.00	0.00	0.00

Database:	Casper District	Local Co-ordinate Reference:	Well Anschutz Equus Farms 03-62-04-4033B2
Company:	Bill Barrett Corp.	TVD Reference:	GL 4613 & @ 4613.00ft
Project:	Weld County, CO NAD 83	MD Reference:	GL 4613 & @ 4613.00ft
Site:	Anschutz Equus Farms 3-62-4_5 CE2 Pad	North Reference:	True
Well:	Anschutz Equus Farms 03-62-04-4033B2	Survey Calculation Method:	Minimum Curvature
Wellbore:	OH		
Design:	Plan #1		

Planned Survey									
Measured Depth (ft)	Inclination (°)	Azimuth (°)	Vertical Depth (ft)	+N/-S (ft)	+E/-W (ft)	Vertical Section (ft)	Dogleg Rate (°/100ft)	Build Rate (°/100ft)	Turn Rate (°/100ft)
9,500.00	89.76	270.17	6,175.65	-222.54	-3,210.07	3,213.99	0.00	0.00	0.00
9,600.00	89.76	270.17	6,176.06	-222.24	-3,310.07	3,313.96	0.00	0.00	0.00
9,700.00	89.76	270.17	6,176.48	-221.93	-3,410.06	3,413.93	0.00	0.00	0.00
9,800.00	89.76	270.17	6,176.89	-221.63	-3,510.06	3,513.90	0.00	0.00	0.00
9,900.00	89.76	270.17	6,177.31	-221.32	-3,610.06	3,613.87	0.00	0.00	0.00
10,000.00	89.76	270.17	6,177.73	-221.02	-3,710.06	3,713.84	0.00	0.00	0.00
10,100.00	89.76	270.17	6,178.14	-220.71	-3,810.06	3,813.81	0.00	0.00	0.00
10,200.00	89.76	270.17	6,178.56	-220.41	-3,910.06	3,913.78	0.00	0.00	0.00
10,300.00	89.76	270.17	6,178.98	-220.11	-4,010.06	4,013.75	0.00	0.00	0.00
10,400.00	89.76	270.17	6,179.39	-219.80	-4,110.05	4,113.73	0.00	0.00	0.00
10,500.00	89.76	270.17	6,179.81	-219.50	-4,210.05	4,213.70	0.00	0.00	0.00
10,600.00	89.76	270.17	6,180.23	-219.19	-4,310.05	4,313.67	0.00	0.00	0.00
10,700.00	89.76	270.17	6,180.64	-218.89	-4,410.05	4,413.64	0.00	0.00	0.00
10,800.00	89.76	270.17	6,181.06	-218.58	-4,510.05	4,513.61	0.00	0.00	0.00
10,900.00	89.76	270.17	6,181.48	-218.28	-4,610.05	4,613.58	0.00	0.00	0.00
11,000.00	89.76	270.17	6,181.89	-217.97	-4,710.05	4,713.55	0.00	0.00	0.00
11,100.00	89.76	270.17	6,182.31	-217.67	-4,810.05	4,813.52	0.00	0.00	0.00
11,200.00	89.76	270.17	6,182.73	-217.36	-4,910.04	4,913.49	0.00	0.00	0.00
11,300.00	89.76	270.17	6,183.14	-217.06	-5,010.04	5,013.46	0.00	0.00	0.00
11,400.00	89.76	270.17	6,183.56	-216.75	-5,110.04	5,113.43	0.00	0.00	0.00
11,500.00	89.76	270.17	6,183.98	-216.45	-5,210.04	5,213.41	0.00	0.00	0.00
11,600.00	89.76	270.17	6,184.39	-216.15	-5,310.04	5,313.38	0.00	0.00	0.00
11,700.00	89.76	270.17	6,184.81	-215.84	-5,410.04	5,413.35	0.00	0.00	0.00
11,800.00	89.76	270.17	6,185.23	-215.54	-5,510.04	5,513.32	0.00	0.00	0.00
11,900.00	89.76	270.17	6,185.64	-215.23	-5,610.03	5,613.29	0.00	0.00	0.00
12,000.00	89.76	270.17	6,186.06	-214.93	-5,710.03	5,713.26	0.00	0.00	0.00
12,100.00	89.76	270.17	6,186.47	-214.62	-5,810.03	5,813.23	0.00	0.00	0.00
12,200.00	89.76	270.17	6,186.89	-214.32	-5,910.03	5,913.20	0.00	0.00	0.00
12,300.00	89.76	270.17	6,187.31	-214.01	-6,010.03	6,013.17	0.00	0.00	0.00
12,400.00	89.76	270.17	6,187.72	-213.71	-6,110.03	6,113.14	0.00	0.00	0.00
12,500.00	89.76	270.17	6,188.14	-213.40	-6,210.03	6,213.11	0.00	0.00	0.00
12,600.00	89.76	270.17	6,188.56	-213.10	-6,310.03	6,313.09	0.00	0.00	0.00
12,700.00	89.76	270.17	6,188.97	-212.79	-6,410.02	6,413.06	0.00	0.00	0.00
12,800.00	89.76	270.17	6,189.39	-212.49	-6,510.02	6,513.03	0.00	0.00	0.00
12,900.00	89.76	270.17	6,189.81	-212.18	-6,610.02	6,613.00	0.00	0.00	0.00
13,000.00	89.76	270.17	6,190.22	-211.88	-6,710.02	6,712.97	0.00	0.00	0.00
13,100.00	89.76	270.17	6,190.64	-211.58	-6,810.02	6,812.94	0.00	0.00	0.00
13,200.00	89.76	270.17	6,191.06	-211.27	-6,910.02	6,912.91	0.00	0.00	0.00
13,300.00	89.76	270.17	6,191.47	-210.97	-7,010.02	7,012.88	0.00	0.00	0.00
13,400.00	89.76	270.17	6,191.89	-210.66	-7,110.01	7,112.85	0.00	0.00	0.00
13,500.00	89.76	270.17	6,192.31	-210.36	-7,210.01	7,212.82	0.00	0.00	0.00
13,600.00	89.76	270.17	6,192.72	-210.05	-7,310.01	7,312.79	0.00	0.00	0.00
13,700.00	89.76	270.17	6,193.14	-209.75	-7,410.01	7,412.77	0.00	0.00	0.00
13,800.00	89.76	270.17	6,193.56	-209.44	-7,510.01	7,512.74	0.00	0.00	0.00
13,900.00	89.76	270.17	6,193.97	-209.14	-7,610.01	7,612.71	0.00	0.00	0.00
14,000.00	89.76	270.17	6,194.39	-208.83	-7,710.01	7,712.68	0.00	0.00	0.00
14,100.00	89.76	270.17	6,194.81	-208.53	-7,810.01	7,812.65	0.00	0.00	0.00
14,200.00	89.76	270.17	6,195.22	-208.22	-7,910.00	7,912.62	0.00	0.00	0.00
14,300.00	89.76	270.17	6,195.64	-207.92	-8,010.00	8,012.59	0.00	0.00	0.00
14,400.00	89.76	270.17	6,196.05	-207.61	-8,110.00	8,112.56	0.00	0.00	0.00
14,500.00	89.76	270.17	6,196.47	-207.31	-8,210.00	8,212.53	0.00	0.00	0.00
14,600.00	89.76	270.17	6,196.89	-207.01	-8,310.00	8,312.50	0.00	0.00	0.00
14,700.00	89.76	270.17	6,197.30	-206.70	-8,410.00	8,412.47	0.00	0.00	0.00

Database:	Casper District	Local Co-ordinate Reference:	Well Anschutz Equus Farms 03-62-04-4033B2
Company:	Bill Barrett Corp.	TVD Reference:	GL 4613 & @ 4613.00ft
Project:	Weld County, CO NAD 83	MD Reference:	GL 4613 & @ 4613.00ft
Site:	Anschutz Equus Farms 3-62-4_5 CE2 Pad	North Reference:	True
Well:	Anschutz Equus Farms 03-62-04-4033B2	Survey Calculation Method:	Minimum Curvature
Wellbore:	OH		
Design:	Plan #1		

Planned Survey										
Measured Depth (ft)	Inclination (°)	Azimuth (°)	Vertical Depth (ft)	+N/-S (ft)	+E/-W (ft)	Vertical Section (ft)	Dogleg Rate (°/100ft)	Build Rate (°/100ft)	Turn Rate (°/100ft)	
14,800.00	89.76	270.17	6,197.72	-206.40	-8,510.00	8,512.45	0.00	0.00	0.00	
14,900.00	89.76	270.17	6,198.14	-206.09	-8,609.99	8,612.42	0.00	0.00	0.00	
15,000.00	89.76	270.17	6,198.55	-205.79	-8,709.99	8,712.39	0.00	0.00	0.00	
15,100.00	89.76	270.17	6,198.97	-205.48	-8,809.99	8,812.36	0.00	0.00	0.00	
15,200.00	89.76	270.17	6,199.39	-205.18	-8,909.99	8,912.33	0.00	0.00	0.00	
15,300.00	89.76	270.17	6,199.80	-204.87	-9,009.99	9,012.30	0.00	0.00	0.00	
15,400.00	89.76	270.17	6,200.22	-204.57	-9,109.99	9,112.27	0.00	0.00	0.00	
15,500.00	89.76	270.17	6,200.64	-204.26	-9,209.99	9,212.24	0.00	0.00	0.00	
15,600.00	89.76	270.17	6,201.05	-203.96	-9,309.99	9,312.21	0.00	0.00	0.00	
15,700.00	89.76	270.17	6,201.47	-203.65	-9,409.98	9,412.18	0.00	0.00	0.00	
15,800.00	89.76	270.17	6,201.89	-203.35	-9,509.98	9,512.15	0.00	0.00	0.00	
15,900.00	89.76	270.17	6,202.30	-203.04	-9,609.98	9,612.13	0.00	0.00	0.00	
16,000.00	89.76	270.17	6,202.72	-202.74	-9,709.98	9,712.10	0.00	0.00	0.00	
16,067.42	89.76	270.17	6,203.00	-202.53	-9,777.40	9,779.49	0.00	0.00	0.00	
TD at 16067.42 - 03-62-04-4033B2 PBHL										

Design Targets										
Target Name	Dip Angle (°)	Dip Dir. (°)	TVD (ft)	+N/-S (ft)	+E/-W (ft)	Northing (usft)	Easting (usft)	Latitude	Longitude	
03-62-04-4033B2 LP - hit/miss target - Shape - Point	0.00	0.00	6,163.00	-231.79	-174.44	1,337,548.83	3,329,026.45	40° 15' 14.280 N	104° 19' 16.050 W	
03-62-04-4033B2 PBHL - plan hits target center - Point	0.00	0.00	6,203.00	-202.53	-9,777.40	1,337,450.35	3,319,423.98	40° 15' 14.550 N	104° 21' 19.910 W	

Plan Annotations					
Measured Depth (ft)	Vertical Depth (ft)	Local Coordinates			
		+N/-S (ft)	+E/-W (ft)	Comment	
800.00	800.00	0.00	0.00	Start Build 2.00	
1,300.29	1,297.75	-26.69	34.44	Start 1690.21 hold at 1300.29 MD	
2,990.50	2,962.25	-206.55	266.59	Start Drop -2.00	
3,490.79	3,460.00	-233.24	301.03	Start 2225.54 hold at 3490.79 MD	
5,716.33	5,685.54	-233.24	301.03	Start DLS 12.00 TFO 270.17	
6,464.34	6,163.00	-231.79	-174.44	Start 9603.08 hold at 6464.34 MD	
16,067.42	6,203.00	-202.53	-9,777.40	TD at 16067.42	