



Lat40°, Inc. 6250 W. 10th Street, Unit 2, Greeley, CO 970-515-5294

HYDROLOGY MAP

NILES MILLER 3N66W20Y PAD

SECTION: 20
TOWNSHIP: 3N
RANGE: 66W
6TH. P.M.
WELD COUNTY, CO

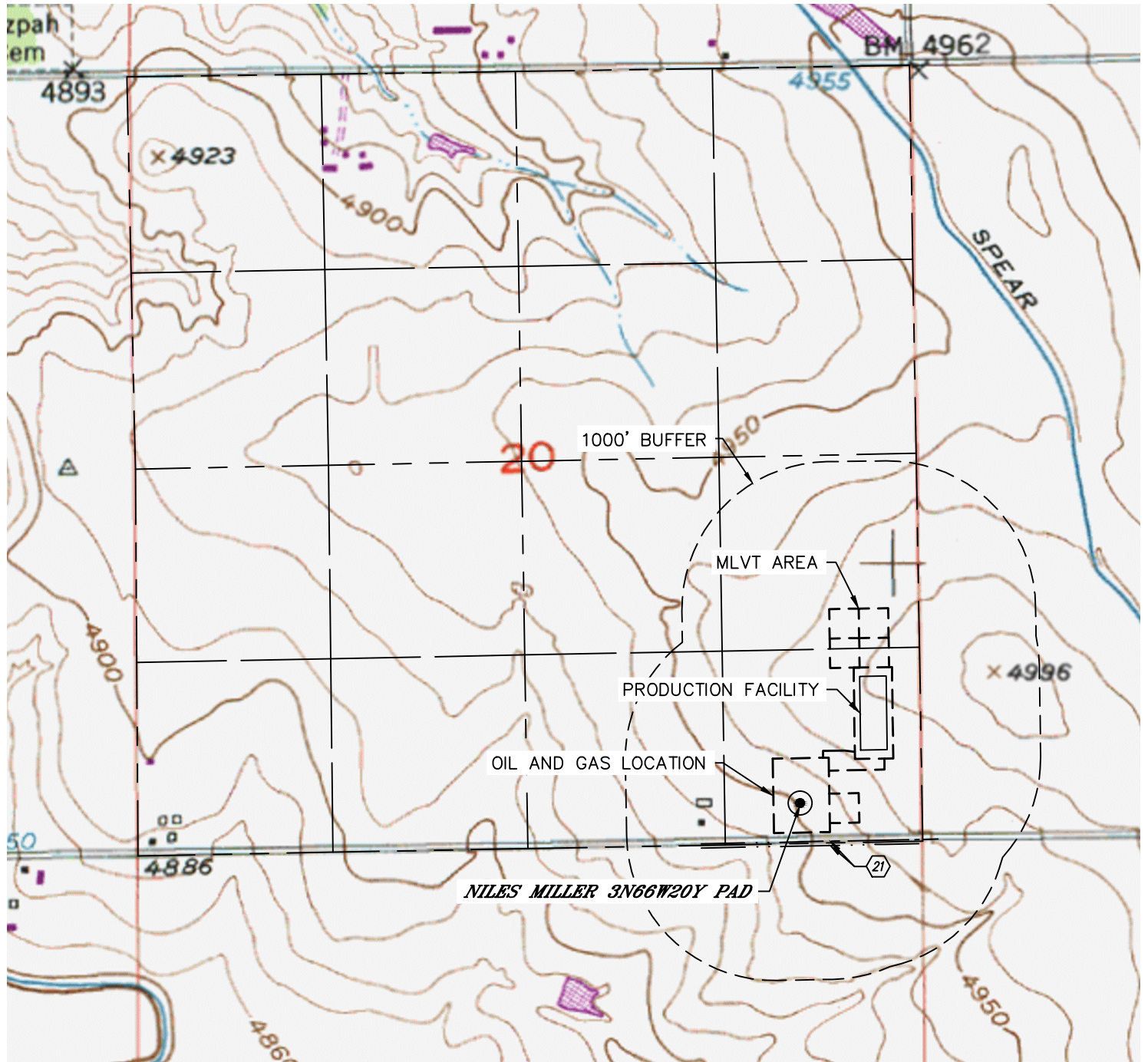

DISTANCES MEASURED FROM THE EDGE OF THE OIL AND GAS LOCATION.

②1 BORROW DITCH 63' & 91' S

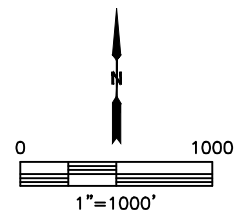

NEAREST DOWN GRADIENT SURFACE WATER: BORROW DITCH 63' S

DATE: 11/09/2015
PROJECT#: 2015104