

PROJECT DETAILS: Weld County, CO NAD 83

Geodetic System: US State Plane 1983
 Datum: North American Datum 1983
 Ellipsoid: GRS 1980
 Zone: Colorado Northern Zone
 System Datum: Mean Sea Level
 Local North: True

Project: Weld County, CO NAD 83
 Site: Anschutz Equus Farms 3-62-4_5 NENE Pad
 Well: Anschutz Equus Farms 03-62-04-0916C2
 Wellbore: OH
 Design: Plan #1



Azimuths to True North
 Magnetic North: 8.22°

Magnetic Field
 Strength: 52547.6snT
 Dip Angle: 66.92°
 Date: 2/11/2016
 Model: BGGM2015

SECTION DETAILS

MD	Inc	Azi	TVD	+N/-S	+E/-W	Dleg	TFace	VSect
0.00	0.00	0.00	0.00	0.00	0.00	0.00	0.00	0.00
800.00	0.00	0.00	800.00	0.00	0.00	0.00	0.00	0.00
1299.82	10.00	149.25	1297.29	-37.38	22.24	2.00	149.25	-20.23
3893.62	10.00	149.25	3851.71	-424.32	252.44	0.00	0.00	-229.64
4393.44	0.00	0.00	4349.00	-461.70	274.68	2.00	180.00	-249.87
5805.98	0.00	0.00	5761.54	-461.70	274.68	0.00	0.00	-249.87
6553.99	89.76	269.67	6239.00	-464.45	-200.79	12.00	269.67	225.08
16169.76	89.76	269.67	6279.00	-520.15	-9816.31	0.00	0.00	9830.09

Plan: Plan #1 (Anschutz Equus Farms 03-62-04-0916C2/OH)

Created By: rscott Date: 19:41, February 15 2016

WELL DETAILS: Anschutz Equus Farms 03-62-04-0916C2

GL 4613 @ 4613.00ft (Original Well Elev) 4613.00
 Northing Easting Latitude Longitude
 0.00 0.00 1339671.21 3329199.81 40° 15' 35.229 N 104° 19' 13.450 W

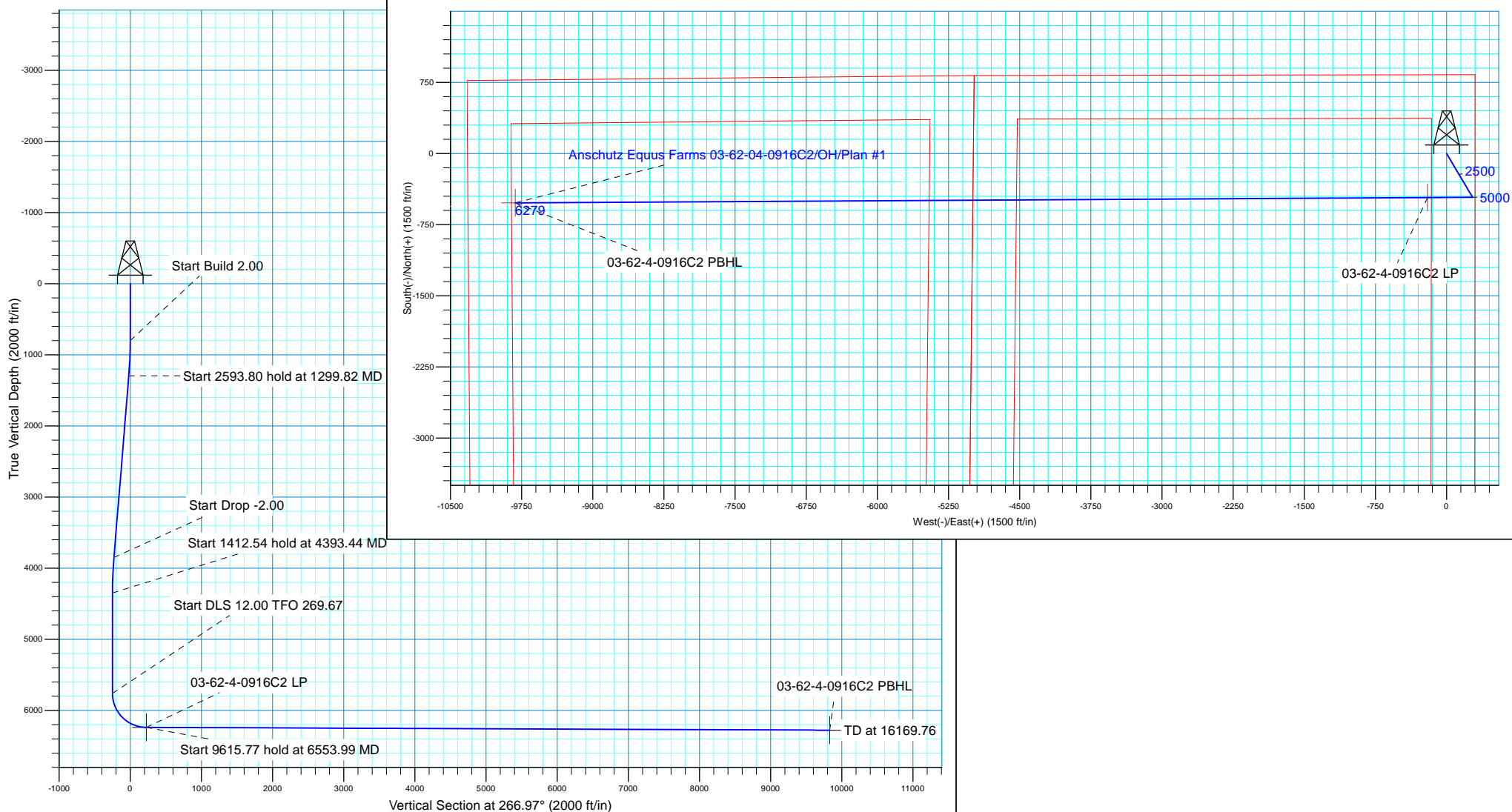



Bill Barrett Corp.

Weld County, CO NAD 83

Anschutz Equus Farms 3-62-4_5 NENE Pad

Anschutz Equus Farms 03-62-04-0916C2

OH

Plan: Plan #1

Standard Planning Report

15 February, 2016



Database:	Casper District	Local Co-ordinate Reference:	Well Anschutz Equus Farms 03-62-04-0916C2
Company:	Bill Barrett Corp.	TVD Reference:	GL 4613 @ 4613.00ft (Original Well Elev)
Project:	Weld County, CO NAD 83	MD Reference:	GL 4613 @ 4613.00ft (Original Well Elev)
Site:	Anschutz Equus Farms 3-62-4_5 NENE Pad	North Reference:	True
Well:	Anschutz Equus Farms 03-62-04-0916C2	Survey Calculation Method:	Minimum Curvature
Wellbore:	OH		
Design:	Plan #1		

Project	Weld County, CO NAD 83		
Map System:	US State Plane 1983	System Datum:	Mean Sea Level
Geo Datum:	North American Datum 1983		
Map Zone:	Colorado Northern Zone		

Site	Anschutz Equus Farms 3-62-4_5 NENE Pad, SECTION 4, T3N, R62W, 6th P.M.			
Site Position:		Northing:	1,339,656.09 usft	Latitude: 40° 15' 35.080 N
From:	Lat/Long	Easting:	3,329,200.02 usft	Longitude: 104° 19' 13.450 W
Position Uncertainty:	0.00 ft	Slot Radius:	13.200 in	Grid Convergence: 0.76 °

Well	Anschutz Equus Farms 03-62-04-0916C2, 831 FNL 300 FEL			
Well Position	+N/-S	15.13 ft	Northing:	1,339,671.21 usft
	+E/-W	0.00 ft	Easting:	3,329,199.81 usft
Position Uncertainty		0.00 ft	Wellhead Elevation:	0.00 ft
			Ground Level:	4,613.00 ft

Wellbore	OH				
Magnetics	Model Name	Sample Date	Declination (°)	Dip Angle (°)	Field Strength (nT)
	BGGM2015	2/11/2016	8.22	66.92	52,548

Design	Plan #1			
Audit Notes:				
Version:	Phase:	PLAN	Tie On Depth:	0.00
Vertical Section:	Depth From (TVD) (ft)	+N/-S (ft)	+E/-W (ft)	Direction (°)
	0.00	0.00	0.00	266.97

Plan Sections										
Measured Depth (ft)	Inclination (°)	Azimuth (°)	Vertical Depth (ft)	+N/-S (ft)	+E/-W (ft)	Dogleg Rate (°/100ft)	Build Rate (°/100ft)	Turn Rate (°/100ft)	TFO (°)	Target
0.00	0.00	0.00	0.00	0.00	0.00	0.00	0.00	0.00	0.00	
800.00	0.00	0.00	800.00	0.00	0.00	0.00	0.00	0.00	0.00	
1,299.82	10.00	149.25	1,297.29	-37.38	22.24	2.00	2.00	0.00	149.25	
3,893.62	10.00	149.25	3,851.71	-424.32	252.44	0.00	0.00	0.00	0.00	
4,393.44	0.00	0.00	4,349.00	-461.70	274.68	2.00	-2.00	0.00	180.00	
5,805.98	0.00	0.00	5,761.54	-461.70	274.68	0.00	0.00	0.00	0.00	
6,553.99	89.76	269.67	6,239.00	-464.45	-200.79	12.00	12.00	-12.08	269.67	
16,169.76	89.76	269.67	6,279.00	-520.15	-9,816.31	0.00	0.00	0.00	0.00	03-62-4-0916C2 PBH

Database:	Casper District	Local Co-ordinate Reference:	Well Anschutz Equus Farms 03-62-04-0916C2
Company:	Bill Barrett Corp.	TVD Reference:	GL 4613 @ 4613.00ft (Original Well Elev)
Project:	Weld County, CO NAD 83	MD Reference:	GL 4613 @ 4613.00ft (Original Well Elev)
Site:	Anschutz Equus Farms 3-62-4_5 NENE Pad	North Reference:	True
Well:	Anschutz Equus Farms 03-62-04-0916C2	Survey Calculation Method:	Minimum Curvature
Wellbore:	OH		
Design:	Plan #1		

Planned Survey									
Measured Depth (ft)	Inclination (°)	Azimuth (°)	Vertical Depth (ft)	+N/-S (ft)	+E/-W (ft)	Vertical Section (ft)	Dogleg Rate (°/100ft)	Build Rate (°/100ft)	Turn Rate (°/100ft)
0.00	0.00	0.00	0.00	0.00	0.00	0.00	0.00	0.00	0.00
100.00	0.00	0.00	100.00	0.00	0.00	0.00	0.00	0.00	0.00
200.00	0.00	0.00	200.00	0.00	0.00	0.00	0.00	0.00	0.00
300.00	0.00	0.00	300.00	0.00	0.00	0.00	0.00	0.00	0.00
400.00	0.00	0.00	400.00	0.00	0.00	0.00	0.00	0.00	0.00
500.00	0.00	0.00	500.00	0.00	0.00	0.00	0.00	0.00	0.00
600.00	0.00	0.00	600.00	0.00	0.00	0.00	0.00	0.00	0.00
700.00	0.00	0.00	700.00	0.00	0.00	0.00	0.00	0.00	0.00
800.00	0.00	0.00	800.00	0.00	0.00	0.00	0.00	0.00	0.00
Start Build 2.00									
900.00	2.00	149.25	899.98	-1.50	0.89	-0.81	2.00	2.00	0.00
1,000.00	4.00	149.25	999.84	-6.00	3.57	-3.25	2.00	2.00	0.00
1,100.00	6.00	149.25	1,099.45	-13.49	8.02	-7.30	2.00	2.00	0.00
1,200.00	8.00	149.25	1,198.70	-23.96	14.25	-12.97	2.00	2.00	0.00
1,299.82	10.00	149.25	1,297.29	-37.38	22.24	-20.23	2.00	2.00	0.00
Start 2593.80 hold at 1299.82 MD									
1,300.00	10.00	149.25	1,297.47	-37.40	22.25	-20.24	0.00	0.00	0.00
1,400.00	10.00	149.25	1,395.95	-52.32	31.13	-28.32	0.00	0.00	0.00
1,500.00	10.00	149.25	1,494.43	-67.24	40.00	-36.39	0.00	0.00	0.00
1,600.00	10.00	149.25	1,592.91	-82.16	48.88	-44.46	0.00	0.00	0.00
1,700.00	10.00	149.25	1,691.39	-97.08	57.75	-52.54	0.00	0.00	0.00
1,800.00	10.00	149.25	1,789.87	-111.99	66.63	-60.61	0.00	0.00	0.00
1,900.00	10.00	149.25	1,888.36	-126.91	75.50	-68.68	0.00	0.00	0.00
2,000.00	10.00	149.25	1,986.84	-141.83	84.38	-76.76	0.00	0.00	0.00
2,100.00	10.00	149.25	2,085.32	-156.75	93.25	-84.83	0.00	0.00	0.00
2,200.00	10.00	149.25	2,183.80	-171.67	102.13	-92.90	0.00	0.00	0.00
2,300.00	10.00	149.25	2,282.28	-186.58	111.01	-100.98	0.00	0.00	0.00
2,400.00	10.00	149.25	2,380.77	-201.50	119.88	-109.05	0.00	0.00	0.00
2,500.00	10.00	149.25	2,479.25	-216.42	128.76	-117.12	0.00	0.00	0.00
2,600.00	10.00	149.25	2,577.73	-231.34	137.63	-125.20	0.00	0.00	0.00
2,700.00	10.00	149.25	2,676.21	-246.26	146.51	-133.27	0.00	0.00	0.00
2,800.00	10.00	149.25	2,774.69	-261.18	155.38	-141.35	0.00	0.00	0.00
2,900.00	10.00	149.25	2,873.18	-276.09	164.26	-149.42	0.00	0.00	0.00
3,000.00	10.00	149.25	2,971.66	-291.01	173.13	-157.49	0.00	0.00	0.00
3,100.00	10.00	149.25	3,070.14	-305.93	182.01	-165.57	0.00	0.00	0.00
3,200.00	10.00	149.25	3,168.62	-320.85	190.88	-173.64	0.00	0.00	0.00
3,300.00	10.00	149.25	3,267.10	-335.77	199.76	-181.71	0.00	0.00	0.00
3,400.00	10.00	149.25	3,365.58	-350.68	208.63	-189.79	0.00	0.00	0.00
3,500.00	10.00	149.25	3,464.07	-365.60	217.51	-197.86	0.00	0.00	0.00
3,600.00	10.00	149.25	3,562.55	-380.52	226.38	-205.93	0.00	0.00	0.00
3,700.00	10.00	149.25	3,661.03	-395.44	235.26	-214.01	0.00	0.00	0.00
3,800.00	10.00	149.25	3,759.51	-410.36	244.13	-222.08	0.00	0.00	0.00
3,893.62	10.00	149.25	3,851.71	-424.32	252.44	-229.64	0.00	0.00	0.00
Start Drop -2.00									
3,900.00	9.87	149.25	3,858.00	-425.27	253.01	-230.15	2.00	-2.00	0.00
4,000.00	7.87	149.25	3,956.79	-438.52	260.89	-237.32	2.00	-2.00	0.00
4,100.00	5.87	149.25	4,056.07	-448.80	267.00	-242.88	2.00	-2.00	0.00
4,200.00	3.87	149.25	4,155.71	-456.09	271.34	-246.83	2.00	-2.00	0.00
4,300.00	1.87	149.25	4,255.58	-460.39	273.90	-249.16	2.00	-2.00	0.00
4,393.44	0.00	0.00	4,349.00	-461.70	274.68	-249.87	2.00	-2.00	0.00
Start 1412.54 hold at 4393.44 MD									
4,400.00	0.00	0.00	4,355.56	-461.70	274.68	-249.87	0.00	0.00	0.00
4,500.00	0.00	0.00	4,455.56	-461.70	274.68	-249.87	0.00	0.00	0.00

Database:	Casper District	Local Co-ordinate Reference:	Well Anschutz Equus Farms 03-62-04-0916C2
Company:	Bill Barrett Corp.	TVD Reference:	GL 4613 @ 4613.00ft (Original Well Elev)
Project:	Weld County, CO NAD 83	MD Reference:	GL 4613 @ 4613.00ft (Original Well Elev)
Site:	Anschutz Equus Farms 3-62-4_5 NENE Pad	North Reference:	True
Well:	Anschutz Equus Farms 03-62-04-0916C2	Survey Calculation Method:	Minimum Curvature
Wellbore:	OH		
Design:	Plan #1		

Planned Survey									
Measured Depth (ft)	Inclination (°)	Azimuth (°)	Vertical Depth (ft)	+N/-S (ft)	+E/-W (ft)	Vertical Section (ft)	Dogleg Rate (°/100ft)	Build Rate (°/100ft)	Turn Rate (°/100ft)
4,600.00	0.00	0.00	4,555.56	-461.70	274.68	-249.87	0.00	0.00	0.00
4,700.00	0.00	0.00	4,655.56	-461.70	274.68	-249.87	0.00	0.00	0.00
4,800.00	0.00	0.00	4,755.56	-461.70	274.68	-249.87	0.00	0.00	0.00
4,900.00	0.00	0.00	4,855.56	-461.70	274.68	-249.87	0.00	0.00	0.00
5,000.00	0.00	0.00	4,955.56	-461.70	274.68	-249.87	0.00	0.00	0.00
5,100.00	0.00	0.00	5,055.56	-461.70	274.68	-249.87	0.00	0.00	0.00
5,200.00	0.00	0.00	5,155.56	-461.70	274.68	-249.87	0.00	0.00	0.00
5,300.00	0.00	0.00	5,255.56	-461.70	274.68	-249.87	0.00	0.00	0.00
5,400.00	0.00	0.00	5,355.56	-461.70	274.68	-249.87	0.00	0.00	0.00
5,500.00	0.00	0.00	5,455.56	-461.70	274.68	-249.87	0.00	0.00	0.00
5,600.00	0.00	0.00	5,555.56	-461.70	274.68	-249.87	0.00	0.00	0.00
5,700.00	0.00	0.00	5,655.56	-461.70	274.68	-249.87	0.00	0.00	0.00
5,800.00	0.00	0.00	5,755.56	-461.70	274.68	-249.87	0.00	0.00	0.00
5,805.98	0.00	0.00	5,761.54	-461.70	274.68	-249.87	0.00	0.00	0.00
Start DLS 12.00 TFO 269.67									
5,900.00	11.28	269.67	5,854.95	-461.75	265.45	-240.65	12.00	12.00	0.00
6,000.00	23.28	269.67	5,950.26	-461.93	235.80	-211.03	12.00	12.00	0.00
6,100.00	35.28	269.67	6,037.33	-462.21	186.98	-162.26	12.00	12.00	0.00
6,200.00	47.28	269.67	6,112.34	-462.59	121.12	-96.48	12.00	12.00	0.00
6,300.00	59.28	269.67	6,172.01	-463.05	41.11	-16.55	12.00	12.00	0.00
6,400.00	71.28	269.67	6,213.75	-463.58	-49.56	74.02	12.00	12.00	0.00
6,500.00	83.28	269.67	6,235.73	-464.14	-146.92	171.28	12.00	12.00	0.00
6,554.00	89.76	269.67	6,239.00	-464.45	-200.79	225.08	12.00	12.00	0.00
Start 9615.77 hold at 6553.99 MD - 03-62-4-0916C2 LP									
6,600.00	89.76	269.67	6,239.19	-464.72	-246.79	271.04	0.00	0.00	0.00
6,700.00	89.76	269.67	6,239.61	-465.30	-346.79	370.93	0.00	0.00	0.00
6,800.00	89.76	269.67	6,240.02	-465.88	-446.79	470.81	0.00	0.00	0.00
6,900.00	89.76	269.67	6,240.44	-466.46	-546.79	570.70	0.00	0.00	0.00
7,000.00	89.76	269.67	6,240.86	-467.04	-646.78	670.59	0.00	0.00	0.00
7,100.00	89.76	269.67	6,241.27	-467.62	-746.78	770.48	0.00	0.00	0.00
7,200.00	89.76	269.67	6,241.69	-468.20	-846.78	870.37	0.00	0.00	0.00
7,300.00	89.76	269.67	6,242.10	-468.77	-946.78	970.25	0.00	0.00	0.00
7,400.00	89.76	269.67	6,242.52	-469.35	-1,046.77	1,070.14	0.00	0.00	0.00
7,500.00	89.76	269.67	6,242.94	-469.93	-1,146.77	1,170.03	0.00	0.00	0.00
7,600.00	89.76	269.67	6,243.35	-470.51	-1,246.77	1,269.92	0.00	0.00	0.00
7,700.00	89.76	269.67	6,243.77	-471.09	-1,346.77	1,369.81	0.00	0.00	0.00
7,800.00	89.76	269.67	6,244.18	-471.67	-1,446.76	1,469.69	0.00	0.00	0.00
7,900.00	89.76	269.67	6,244.60	-472.25	-1,546.76	1,569.58	0.00	0.00	0.00
8,000.00	89.76	269.67	6,245.02	-472.83	-1,646.76	1,669.47	0.00	0.00	0.00
8,100.00	89.76	269.67	6,245.43	-473.41	-1,746.76	1,769.36	0.00	0.00	0.00
8,200.00	89.76	269.67	6,245.85	-473.99	-1,846.75	1,869.25	0.00	0.00	0.00
8,300.00	89.76	269.67	6,246.26	-474.57	-1,946.75	1,969.13	0.00	0.00	0.00
8,400.00	89.76	269.67	6,246.68	-475.15	-2,046.75	2,069.02	0.00	0.00	0.00
8,500.00	89.76	269.67	6,247.10	-475.72	-2,146.75	2,168.91	0.00	0.00	0.00
8,600.00	89.76	269.67	6,247.51	-476.30	-2,246.74	2,268.80	0.00	0.00	0.00
8,700.00	89.76	269.67	6,247.93	-476.88	-2,346.74	2,368.69	0.00	0.00	0.00
8,800.00	89.76	269.67	6,248.34	-477.46	-2,446.74	2,468.57	0.00	0.00	0.00
8,900.00	89.76	269.67	6,248.76	-478.04	-2,546.74	2,568.46	0.00	0.00	0.00
9,000.00	89.76	269.67	6,249.18	-478.62	-2,646.73	2,668.35	0.00	0.00	0.00
9,100.00	89.76	269.67	6,249.59	-479.20	-2,746.73	2,768.24	0.00	0.00	0.00
9,200.00	89.76	269.67	6,250.01	-479.78	-2,846.73	2,868.13	0.00	0.00	0.00
9,300.00	89.76	269.67	6,250.42	-480.36	-2,946.73	2,968.01	0.00	0.00	0.00
9,400.00	89.76	269.67	6,250.84	-480.94	-3,046.72	3,067.90	0.00	0.00	0.00

Database:	Casper District	Local Co-ordinate Reference:	Well Anschutz Equus Farms 03-62-04-0916C2
Company:	Bill Barrett Corp.	TVD Reference:	GL 4613 @ 4613.00ft (Original Well Elev)
Project:	Weld County, CO NAD 83	MD Reference:	GL 4613 @ 4613.00ft (Original Well Elev)
Site:	Anschutz Equus Farms 3-62-4_5 NENE Pad	North Reference:	True
Well:	Anschutz Equus Farms 03-62-04-0916C2	Survey Calculation Method:	Minimum Curvature
Wellbore:	OH		
Design:	Plan #1		

Planned Survey									
Measured Depth (ft)	Inclination (°)	Azimuth (°)	Vertical Depth (ft)	+N/-S (ft)	+E/-W (ft)	Vertical Section (ft)	Dogleg Rate (°/100ft)	Build Rate (°/100ft)	Turn Rate (°/100ft)
9,500.00	89.76	269.67	6,251.26	-481.52	-3,146.72	3,167.79	0.00	0.00	0.00
9,600.00	89.76	269.67	6,251.67	-482.10	-3,246.72	3,267.68	0.00	0.00	0.00
9,700.00	89.76	269.67	6,252.09	-482.67	-3,346.72	3,367.57	0.00	0.00	0.00
9,800.00	89.76	269.67	6,252.50	-483.25	-3,446.71	3,467.45	0.00	0.00	0.00
9,900.00	89.76	269.67	6,252.92	-483.83	-3,546.71	3,567.34	0.00	0.00	0.00
10,000.00	89.76	269.67	6,253.34	-484.41	-3,646.71	3,667.23	0.00	0.00	0.00
10,100.00	89.76	269.67	6,253.75	-484.99	-3,746.71	3,767.12	0.00	0.00	0.00
10,200.00	89.76	269.67	6,254.17	-485.57	-3,846.70	3,867.01	0.00	0.00	0.00
10,300.00	89.76	269.67	6,254.58	-486.15	-3,946.70	3,966.89	0.00	0.00	0.00
10,400.00	89.76	269.67	6,255.00	-486.73	-4,046.70	4,066.78	0.00	0.00	0.00
10,500.00	89.76	269.67	6,255.42	-487.31	-4,146.70	4,166.67	0.00	0.00	0.00
10,600.00	89.76	269.67	6,255.83	-487.89	-4,246.69	4,266.56	0.00	0.00	0.00
10,700.00	89.76	269.67	6,256.25	-488.47	-4,346.69	4,366.45	0.00	0.00	0.00
10,800.00	89.76	269.67	6,256.66	-489.05	-4,446.69	4,466.33	0.00	0.00	0.00
10,900.00	89.76	269.67	6,257.08	-489.62	-4,546.69	4,566.22	0.00	0.00	0.00
11,000.00	89.76	269.67	6,257.50	-490.20	-4,646.68	4,666.11	0.00	0.00	0.00
11,100.00	89.76	269.67	6,257.91	-490.78	-4,746.68	4,766.00	0.00	0.00	0.00
11,200.00	89.76	269.67	6,258.33	-491.36	-4,846.68	4,865.89	0.00	0.00	0.00
11,300.00	89.76	269.67	6,258.74	-491.94	-4,946.68	4,965.78	0.00	0.00	0.00
11,400.00	89.76	269.67	6,259.16	-492.52	-5,046.67	5,065.66	0.00	0.00	0.00
11,500.00	89.76	269.67	6,259.58	-493.10	-5,146.67	5,165.55	0.00	0.00	0.00
11,600.00	89.76	269.67	6,259.99	-493.68	-5,246.67	5,265.44	0.00	0.00	0.00
11,700.00	89.76	269.67	6,260.41	-494.26	-5,346.67	5,365.33	0.00	0.00	0.00
11,800.00	89.76	269.67	6,260.82	-494.84	-5,446.66	5,465.22	0.00	0.00	0.00
11,900.00	89.76	269.67	6,261.24	-495.42	-5,546.66	5,565.10	0.00	0.00	0.00
12,000.00	89.76	269.67	6,261.65	-496.00	-5,646.66	5,664.99	0.00	0.00	0.00
12,100.00	89.76	269.67	6,262.07	-496.57	-5,746.66	5,764.88	0.00	0.00	0.00
12,200.00	89.76	269.67	6,262.49	-497.15	-5,846.65	5,864.77	0.00	0.00	0.00
12,300.00	89.76	269.67	6,262.90	-497.73	-5,946.65	5,964.66	0.00	0.00	0.00
12,400.00	89.76	269.67	6,263.32	-498.31	-6,046.65	6,064.54	0.00	0.00	0.00
12,500.00	89.76	269.67	6,263.73	-498.89	-6,146.64	6,164.43	0.00	0.00	0.00
12,600.00	89.76	269.67	6,264.15	-499.47	-6,246.64	6,264.32	0.00	0.00	0.00
12,700.00	89.76	269.67	6,264.57	-500.05	-6,346.64	6,364.21	0.00	0.00	0.00
12,800.00	89.76	269.67	6,264.98	-500.63	-6,446.64	6,464.10	0.00	0.00	0.00
12,900.00	89.76	269.67	6,265.40	-501.21	-6,546.63	6,563.98	0.00	0.00	0.00
13,000.00	89.76	269.67	6,265.81	-501.79	-6,646.63	6,663.87	0.00	0.00	0.00
13,100.00	89.76	269.67	6,266.23	-502.37	-6,746.63	6,763.76	0.00	0.00	0.00
13,200.00	89.76	269.67	6,266.65	-502.95	-6,846.63	6,863.65	0.00	0.00	0.00
13,300.00	89.76	269.67	6,267.06	-503.52	-6,946.62	6,963.54	0.00	0.00	0.00
13,400.00	89.76	269.67	6,267.48	-504.10	-7,046.62	7,063.42	0.00	0.00	0.00
13,500.00	89.76	269.67	6,267.89	-504.68	-7,146.62	7,163.31	0.00	0.00	0.00
13,600.00	89.76	269.67	6,268.31	-505.26	-7,246.62	7,263.20	0.00	0.00	0.00
13,700.00	89.76	269.67	6,268.73	-505.84	-7,346.61	7,363.09	0.00	0.00	0.00
13,800.00	89.76	269.67	6,269.14	-506.42	-7,446.61	7,462.98	0.00	0.00	0.00
13,900.00	89.76	269.67	6,269.56	-507.00	-7,546.61	7,562.86	0.00	0.00	0.00
14,000.00	89.76	269.67	6,269.97	-507.58	-7,646.61	7,662.75	0.00	0.00	0.00
14,100.00	89.76	269.67	6,270.39	-508.16	-7,746.60	7,762.64	0.00	0.00	0.00
14,200.00	89.76	269.67	6,270.81	-508.74	-7,846.60	7,862.53	0.00	0.00	0.00
14,300.00	89.76	269.67	6,271.22	-509.32	-7,946.60	7,962.42	0.00	0.00	0.00
14,400.00	89.76	269.67	6,271.64	-509.90	-8,046.60	8,062.30	0.00	0.00	0.00
14,500.00	89.76	269.67	6,272.05	-510.47	-8,146.59	8,162.19	0.00	0.00	0.00
14,600.00	89.76	269.67	6,272.47	-511.05	-8,246.59	8,262.08	0.00	0.00	0.00
14,700.00	89.76	269.67	6,272.89	-511.63	-8,346.59	8,361.97	0.00	0.00	0.00

Database:	Casper District	Local Co-ordinate Reference:	Well Anschutz Equus Farms 03-62-04-0916C2
Company:	Bill Barrett Corp.	TVD Reference:	GL 4613 @ 4613.00ft (Original Well Elev)
Project:	Weld County, CO NAD 83	MD Reference:	GL 4613 @ 4613.00ft (Original Well Elev)
Site:	Anschutz Equus Farms 3-62-4_5 NENE Pad	North Reference:	True
Well:	Anschutz Equus Farms 03-62-04-0916C2	Survey Calculation Method:	Minimum Curvature
Wellbore:	OH		
Design:	Plan #1		

Planned Survey										
Measured Depth (ft)	Inclination (°)	Azimuth (°)	Vertical Depth (ft)	+N/-S (ft)	+E/-W (ft)	Vertical Section (ft)	Dogleg Rate (°/100ft)	Build Rate (°/100ft)	Turn Rate (°/100ft)	
14,800.00	89.76	269.67	6,273.30	-512.21	-8,446.59	8,461.86	0.00	0.00	0.00	
14,900.00	89.76	269.67	6,273.72	-512.79	-8,546.58	8,561.74	0.00	0.00	0.00	
15,000.00	89.76	269.67	6,274.13	-513.37	-8,646.58	8,661.63	0.00	0.00	0.00	
15,100.00	89.76	269.67	6,274.55	-513.95	-8,746.58	8,761.52	0.00	0.00	0.00	
15,200.00	89.76	269.67	6,274.97	-514.53	-8,846.58	8,861.41	0.00	0.00	0.00	
15,300.00	89.76	269.67	6,275.38	-515.11	-8,946.57	8,961.30	0.00	0.00	0.00	
15,400.00	89.76	269.67	6,275.80	-515.69	-9,046.57	9,061.18	0.00	0.00	0.00	
15,500.00	89.76	269.67	6,276.21	-516.27	-9,146.57	9,161.07	0.00	0.00	0.00	
15,600.00	89.76	269.67	6,276.63	-516.85	-9,246.57	9,260.96	0.00	0.00	0.00	
15,700.00	89.76	269.67	6,277.05	-517.43	-9,346.56	9,360.85	0.00	0.00	0.00	
15,800.00	89.76	269.67	6,277.46	-518.00	-9,446.56	9,460.74	0.00	0.00	0.00	
15,900.00	89.76	269.67	6,277.88	-518.58	-9,546.56	9,560.62	0.00	0.00	0.00	
16,000.00	89.76	269.67	6,278.29	-519.16	-9,646.56	9,660.51	0.00	0.00	0.00	
16,100.00	89.76	269.67	6,278.71	-519.74	-9,746.55	9,760.40	0.00	0.00	0.00	
16,169.76	89.76	269.67	6,279.00	-520.15	-9,816.31	9,830.09	0.00	0.00	0.00	
TD at 16169.76 - 03-62-4-0916C2 PBHL										

Design Targets										
Target Name	Dip Angle (°)	Dip Dir. (°)	TVD (ft)	+N/-S (ft)	+E/-W (ft)	Northing (usft)	Easting (usft)	Latitude	Longitude	
03-62-4-0916C2 LP - hit/miss target - Shape - Point	0.00	0.00	6,239.00	-464.45	-200.79	1,339,204.13	3,329,005.22	40° 15' 30.640 N	104° 19' 16.040 W	
03-62-4-0916C2 PBHL - plan hits target center - Point	0.00	0.00	6,279.00	-520.15	-9,816.31	1,339,020.53	3,319,391.31	40° 15' 30.070 N	104° 21' 20.070 W	

Plan Annotations					
Measured Depth (ft)	Vertical Depth (ft)	Local Coordinates			
		+N/-S (ft)	+E/-W (ft)	Comment	
800.00	800.00	0.00	0.00	Start Build 2.00	
1,299.82	1,297.29	-37.38	22.24	Start 2593.80 hold at 1299.82 MD	
3,893.62	3,851.71	-424.32	252.44	Start Drop -2.00	
4,393.44	4,349.00	-461.70	274.68	Start 1412.54 hold at 4393.44 MD	
5,805.98	5,761.54	-461.70	274.68	Start DLS 12.00 TFO 269.67	
6,553.99	6,239.00	-464.45	-200.79	Start 9615.77 hold at 6553.99 MD	
16,169.76	6,279.00	-520.15	-9,816.31	TD at 16169.76	