

- Layers
- Buffer 1
 - O&G Facilities
 - Wells
 - Well Name
 - Well API #
 - Pits
 - Active
 - Closed
 - Unknown
 - Permits
 - Pending Permits
 - Pending2As (Diamond)
 - Well Status
 - COGCC Data
 - O&G Locations
 - Directionals
 - COGCC Rules
 - O&G Fields
 - Seismic Permits
 - Environmental
 - Sample Sites
 - Roads & RRs
 - Water Resources
 - Floodplains
 - SecTwpRng
 - Wildlife CPW
 - State Lands
 - Indian Lands
 - BLM Lands
 - Surface Lands
 - Places
 - Countries_Zoom
 - CityPolygons
 - Surface Owner
 - Special Projects
 - Soil Surveys
 - Geology
 - Topos24K
 - 1990sAerials
 - 2005Aerials
 - 2011Aerials
 - 2013Aerials
 - Flood 2013

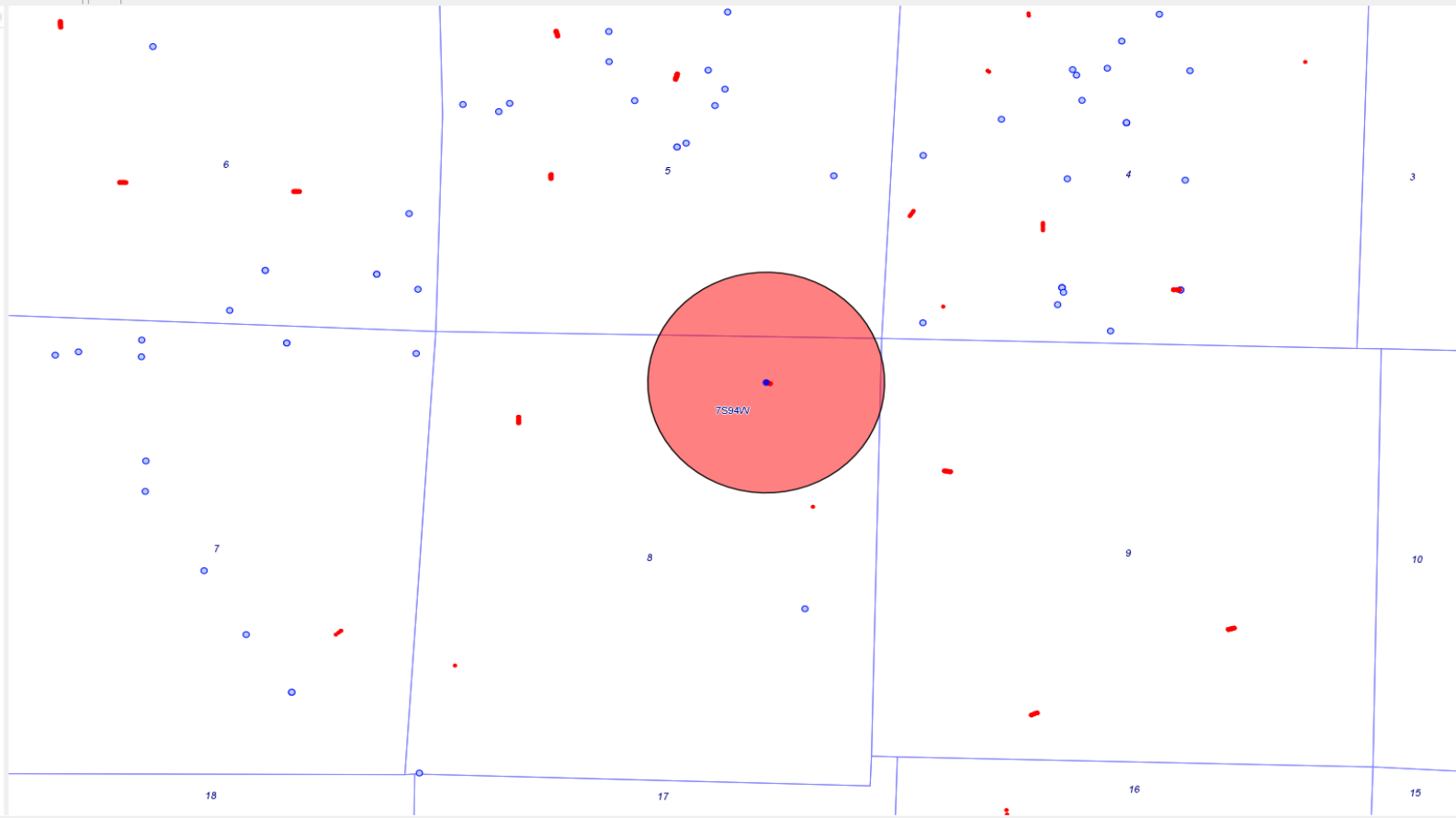

Note: If some of the tool buttons are not functioning, please see the [Compatibility View](#) document.

- MAPGUIDE HELP**
- [Disclaimer](#)
 - [Map Layer Info](#)
 - [Map Tools](#)
 - [Other Browsers](#)
 - [FAQs](#)
 - [GIS Contacts](#)

This window is also used for some of the map functions, such as redlining and measure distance. When these functions are requested, this window will be replaced by the requested function window. click the

button above to return to this menu.