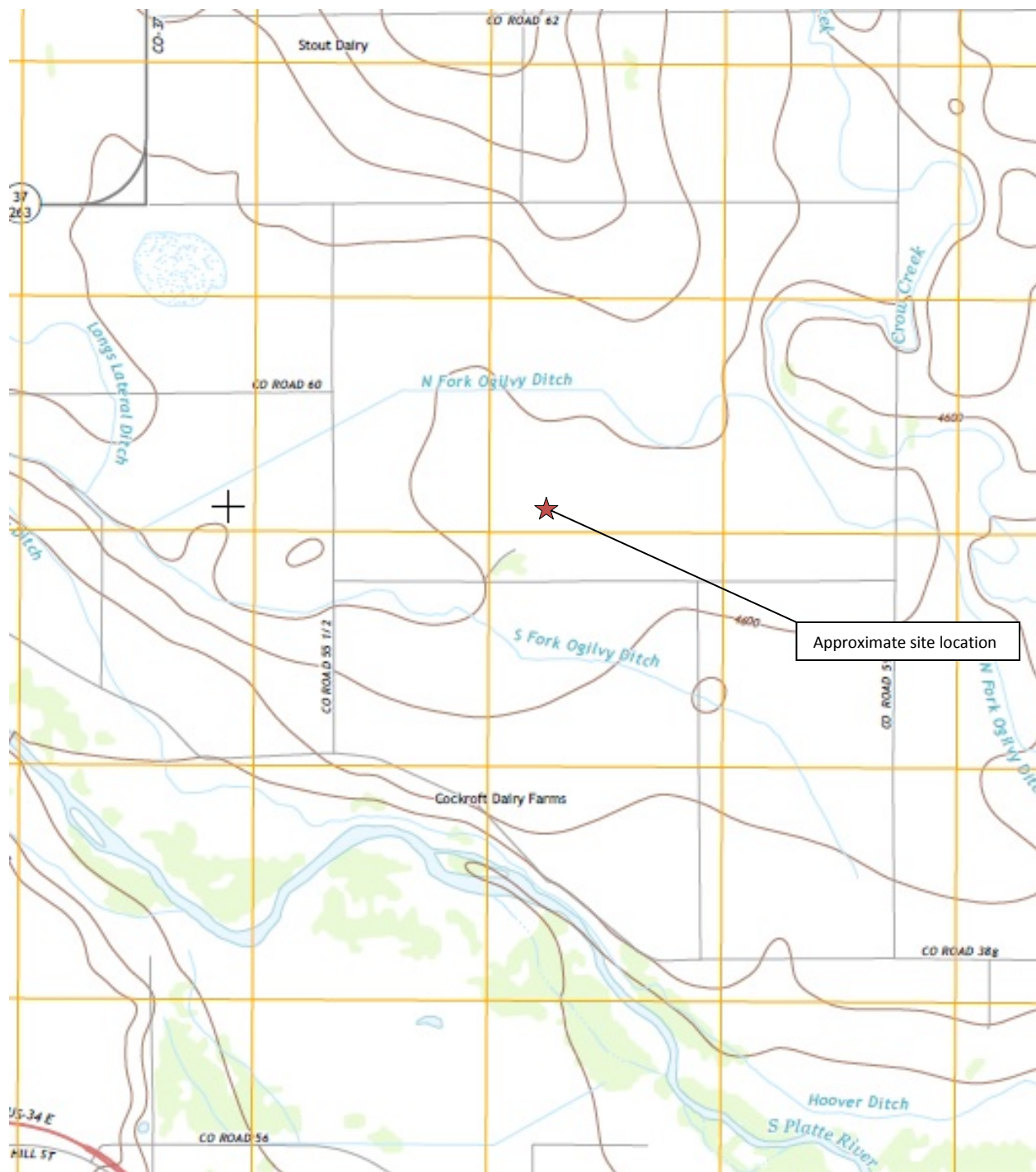

**TABLE 1**  
**SOIL ANALYTICAL RESULTS SUMMARY**  
**TREBOR B #11-3,4,19 & #11-5,6, #11-18, #11-20, #11-21**  
**WATER VAULT REMOVAL**  
**40.416807 / -104.523381**  
**C-NW¼ SEC.11 T5N R64W 6PM**

API # 05-123-13814, 05-123-13497, 05-123-26659, 05-123-13498, 05-123-13817, 05-123-30730, 05-123-30731, 05-123-30729

Sample Location (Latitude/Longitude)	Date	Approximate Depth (feet)	Benzene (mg/kg)	Toluene (mg/kg)	Ethylbenzene (mg/kg)	Total Xylenes (mg/kg)	Naphthalene (mg/kg)	TPH-GRO (mg/kg)	TPH-DRO (mg/kg)	Specific Conductance (mmhos/cm)	pH (pH units)	SAR
<b>COGCC Table 910-1 Regulatory Limits (mg/kg)</b>			<b>0.17</b>	<b>85</b>	<b>100</b>	<b>175</b>	<b>23</b>	<b>500</b>		<b>&lt;4</b>	<b>6 to 9</b>	<b>&lt;12<sup>5</sup></b>
SS-04 @ 2.5' (40.417094867 / -104.523395383)	03/13/15	2.5	<0.002	<0.002	<0.002	<0.002	<0.007	<0.200	<50.0	0.0625	8.69	0.07
SS-05 @ 5' (40.417091461 / -104.523373644)	03/13/15	5	<0.002	0.002	<0.002	0.014	<0.007	0.306	<50.0	NA	NA	NA
SS-08 @ 3' (40.417054494 / -104.523350395)	03/13/15	3	<0.002	0.002	<0.002	0.017	<0.007	0.547	<50.0	0.0629	8.82	0.35
SS-10 @ 5' (40.41706306 / -104.523375609)	03/13/15	5	<0.002	<0.002	<0.002	<0.002	<0.007	<0.200	<50.0	NA	NA	NA
SS-11 @ 3' (40.416826513 / -104.523384959)	03/13/15	3	<0.002	0.003	<0.002	0.005	<0.007	<0.200	<50.0	0.0889	8.56	0.94
SS-15 @ 6.5' (40.416813095 / -104.523390015)	03/13/15	6.5	0.140	<0.050	0.152	<0.050	0.265	67.2	402	NA	NA	NA
COGCC = Colorado Oil and Gas Conservation Commission mg/kg = milligrams per kilogram mmhos/cm = millimhos per centimeter NA = Not Analyzed TPH-GRO = Total Petroleum Hydrocarbons - Gasoline Range Organics TPH-DRO = Total Petroleum Hydrocarbons - Diesel Range Organics SAR = Sodium Adsorption Ratio Values presented with a less than symbol (<) did not contain concentrations at or above the laboratory reporting limit.												





#### Topographic Site Location Map

Trebor B #11-3,4,19 , #11-5,6, #11-18, #11-20, #11-21.

Water Vault Removal

40.416807 / -104.523381

C- NW¼ SEC.11 T5N R64W 6PM

Weld County, Colorado

API # 05-123-13814, 05-123-13497, 05-123-26659, 05-123-13498, 05-123-13817,  
05-123-30730, 05-123-30731, 05-123-30729



Source: USGS 7.5 Minute Topographic  
Map: Kersey, CO  
Quadrangle 2013

**Figure 1**



**EAGLE**  
ENVIRONMENTAL  
CONSULTING, INC.



# LEGEND

- TREBOR B #11-3,4,19, #11-5,6, #11-18, #11-20, #11-21 TANK BATTERY
- APPROXIMATE LOCATION OF WATER VAULT REMOVAL 1
- APPROXIMATE LOCATION OF WATER VAULT REMOVAL 2
- APPROXIMATE LOCATION OF WATER VAULT REMOVAL 3

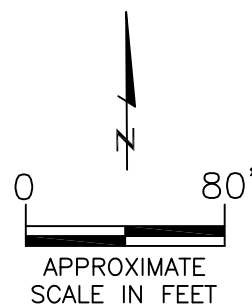

## AERIAL SITE LOCATION MAP

TREBOR B #11-3,4,19 & #11-5,6,#11-18,#11-20,#11-21  
 40.416807 / -104.523381  
 C-NW1/4 SEC.11 T5N R64W 6PM  
 WELD COUNTY, COLORADO  
 API # 05-123-13814, 05-123-13497, 05-123-26659,  
 05-123-13498, 05-123-13817, 05-123-30730,  
 05-123-30731, 05-123-30729

DATE:  
03/13/15

FIG. NO.  
2

DRAWN BY:  
AMN



**EAGLE**  
 ENVIRONMENTAL  
 CONSULTING, INC.  
 4101 INCA STREET, DENVER, CO 80211  
 Ph: 303-433-0479 • F: 303-325-5449





# LEGEND

- APPROXIMATE VAULT REMOVAL 1 BOUNDARIES
- APPROXIMATE VAULT REMOVAL 2 BOUNDARIES
- APPROXIMATE VAULT REMOVAL 3 BOUNDARIES
- SS-01 APPROXIMATE LOCATION OF SOIL SAMPLES FIELD ANALYZED WITH PHOTOIONIZATION DETECTOR (PID)
- SS-02 APPROXIMATE LOCATION OF SOIL SAMPLES SUBMITTED FOR LABORATORY ANALYSIS

## PARAMETERS

SOIL SAMPLE LOCATION
DATE
DEPTH (FEET)
B = BENZENE (mg/kg)
T = TOLUENE (mg/kg)
E = ETHYLBENZENE (mg/kg)
X = TOTAL XYLENES (mg/kg)
N = NAPHTHALENE (mg/kg)
G = TPH-GRO (mg/kg)
D = TPH-DRO (mg/kg)

mg/kg = MILLIGRAMS PER KILOGRAM

TPH-GRO = TOTAL PETROLEUM HYDROCARBONS - GASOLINE RANGE ORGANICS

TPH-DRO = TOTAL PETROLEUM HYDROCARBONS - DIESEL RANGE ORGANICS

NOTE: VALUES PRESENTED WITH A LESS THAN SYMBOL (<) DID NOT CONTAIN CONCENTRATIONS AT OR ABOVE LABORATORY DETECTION LIMITS

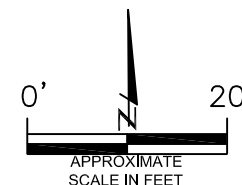

## SOIL ANALYTICAL MAP

TREBOR B #11-3,4,19, #11-5,6, #11-18, #11-20, #11-21  
WATER VAULT REMOVAL  
40.416807 / -104.523381  
C-NW1/4 SEC.11 T5N R64W 6PM  
WELD COUNTY, COLORADO  
API # 05-123-13814, 05-123-13497, 05-123-26659, 05-123-13498, 05-123-13817, 05-123-30730, 05-123-30731, 05-123-30729

DATE: 03/16/15

FIG. NO. 3

DRAWN BY: amn

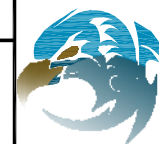

**EAGLE**  
ENVIRONMENTAL  
CONSULTING, INC.  
4101 INCA STREET, DENVER, CO 80211  
Ph: 303-433-0479 • F: 303-325-5449



March 16, 2015

Eagle Environmental Consulting, Inc.

Martin C Eckert III

4101 Inca Street

Denver

CO 80211

**Project Name - Noble - Trebor B  
11-18&11-20&11-21&11-3,4,19&11-**

**Project Number - [none]**

Attached are your analytical results for Noble - Trebor B 11-18&11-20&11-21&11-3,4,19&11-5 received by Origins Laboratory, Inc. March 13, 2015. This project is associated with Origins project number X503169-01.

The analytical results in the following report were analyzed under the guidelines of EPA Methods. These methods are identified as follows; "SW" are defined in SW-846, "EPA" are defined in 40CFR part 136 and "SM" are defined in the most current revision of Standard Methods For the Examination of Water and Wastewater.

The analytical results apply specifically to the samples and analyses specified per the attached Chain of Custody. As such, this report shall not be reproduced except in full, without the written approval of Origin's laboratory.

Unless otherwise noted, the analytical results for all soil samples are reported on a wet weight basis. All analytical analyses were performed under NELAP guidelines unless noted by a data qualifier.

Any holding time exceedances, deviations from the method specifications or deviations from Origins Laboratory's Standard Operating Procedures are outlined in the case narrative.

Thank you for selecting Origins for your analytical needs. Please contact us with any questions concerning this report, or if we can help with anything at all.

Origins Laboratory, Inc.  
303.433.1322  
o-squad@oelabinc.com



1725 Elk Place, Denver, CO 80211 | Phone: 303.433.1322 | Fax: 303.265.9645

Eagle Environmental Consulting, Inc.

4101 Inca Street

Denver CO 80211

Martin C Eckert III

Project Number: [none]

Project: Noble - Trebor B  
11-18&11-20&11-21&11-3,4,19&11-5

## CROSS REFERENCE REPORT

Sample ID	Laboratory ID	Matrix	Date Sampled	Date Received
SS-04 @ 2.5'	X503169-01	Soil	March 13, 2015 16:05	03/13/2015 17:44
SS-05 @ 5'	X503169-02	Soil	March 13, 2015 16:10	03/13/2015 17:44
SS-08 @ 3'	X503169-03	Soil	March 13, 2015 15:45	03/13/2015 17:44
SS-10 @ 5'	X503169-04	Soil	March 13, 2015 15:55	03/13/2015 17:44
SS-11 @ 3'	X503169-05	Soil	March 13, 2015 15:10	03/13/2015 17:44
SS-15 @ 6.5'	X503169-06	Soil	March 13, 2015 15:40	03/13/2015 17:44

Origins Laboratory, Inc.



*The results in this report apply to the samples analyzed in accordance with the chain of custody document. This analytical report must be reproduced in its entirety.*





Eagle Environmental Consulting, Inc.

4101 Inca Street

Denver

CO

80211

Martin C Eckert III

Project Number: [none]

Project: Noble - Trebor B

11-18&11-20&11-21&11-3,4,19&11-5

Origins Laboratory

F-012207-01-R1  
Effective Date: 01/09/12

## Sample Receipt Checklist

Origins Work Order: XS03169

Client: Eagle

Client Project ID: Trebor B 11-18+11-20

Checklist Completed by: Jeff Smith

Shipped Via: HTD  
(UPS, FedEx, Hand Delivered, Pick-up, etc.)

Date/time completed: 3/17/15

Airbill #: NA

Matrix(s) Received: (Check all that apply): ☒ Soil/Solid ☐ Water ☐ Other: \_\_\_\_\_

Cooler Number/Temperature: 1 / 1 °C 1 / 1 °C 1 / 1 °C (Describe)

Thermometer ID: TL03

Requirement Description	Yes	No	N/A	Comments (if any)
If samples require cooling, was the temperature between 0°C to ≤ 6°C <sup>(1)</sup> ?				
Is there ice present (document if blue ice is used)	X			
Are custody seals present on cooler? (if so, document in comments if they are signed and dated, broken or intact)		X		
Are custody seals present on each sample container? (if so, document in comments if they are signed and dated, broken or intact)		X		
Were all samples received intact <sup>(1)</sup> ?	X			
Was adequate sample volume provided <sup>(1)</sup> ?	X			
Are short holding time analytes or samples with HTs due within 48 hours present <sup>(1)</sup> ?				
Is a chain-of-custody (COC) present and filled out completely <sup>(1)</sup> ?	X			
Does the COC agree with the number and type of sample bottles received <sup>(1)</sup> ?	X			
Do the sample IDs on the bottle labels match the COC <sup>(1)</sup> ?	X			
Is the COC properly relinquished by the client with date and time recorded <sup>(1)</sup> ?	X			
For volatiles in water – is there headspace (> ¼ inch bubble) present? If yes, contact client and note in narrative.			X	
Are samples preserved that require preservation and was it checked <sup>(1)</sup> ? (note ID of confirmation instrument used in comments) / (preservation is not confirmed for subcontracted analyses in order to insure sample integrity)/pH <2 for samples preserved with HNO <sub>3</sub> , HCL, H <sub>2</sub> SO <sub>4</sub> / (pH >10 for samples preserved with NaAsO <sub>2</sub> +NaOH, ZnAc+NaOH)			X	
Additional Comments (if any):				

<sup>(1)</sup> If NO, then contact the client before proceeding with analysis and note date/time and person contacted as well as the corrective action to in the additional comments (above) and the case narrative.

Reviewed by (Project Manager)

Date/Time Reviewed

Origins Laboratory, Inc.

*Jeff Pellegrini*

The results in this report apply to the samples analyzed in accordance with the chain of custody document. This analytical report must be reproduced in its entirety.



Eagle Environmental Consulting, Inc.

4101 Inca Street

Denver CO 80211

Martin C Eckert III

Project Number: [none]

Project: Noble - Trebor B  
11-18&11-20&11-21&11-3,4,19&11-5

SS-04 @ 2.5'

3/13/2015 4:05:00PM

Analyte	Result	Reporting Limit	Units	Dilution	Batch	Prepared	Analyzed	Notes
---------	--------	-----------------	-------	----------	-------	----------	----------	-------

Origins Laboratory, Inc.  
X503169-01 (Soil)

## Diesel Range Organics (DRO/TEPH) by EPA 8015C

Diesel (C10-C28)	ND	50.0	mg/kg	1	5C13014	03/13/2015	03/14/2015
------------------	----	------	-------	---	---------	------------	------------

Surrogate: o-Terphenyl	80.7 %	59-131			"	"	"
------------------------	--------	--------	--	--	---	---	---

## GBTEX + Napthalene by 8260C

Gasoline Range Hydrocarbons	ND	0.200	mg/kg	1	5C13013	03/13/2015	03/14/2015
-----------------------------	----	-------	-------	---	---------	------------	------------

Benzene	ND	0.002	"	"	"	"	"
---------	----	-------	---	---	---	---	---

Toluene	ND	0.002	"	"	"	"	"
---------	----	-------	---	---	---	---	---

Ethylbenzene	ND	0.002	"	"	"	"	"
--------------	----	-------	---	---	---	---	---

Xylenes, total	ND	0.002	"	"	"	"	"
----------------	----	-------	---	---	---	---	---

Naphthalene	ND	0.007	"	"	"	"	"
-------------	----	-------	---	---	---	---	---

Surrogate: 1,2-Dichloroethane-d4	107 %	70-130			"	"	"
----------------------------------	-------	--------	--	--	---	---	---

Surrogate: Toluene-d8	101 %	70-130			"	"	"
-----------------------	-------	--------	--	--	---	---	---

Surrogate: 4-Bromofluorobenzene	102 %	70-130			"	"	"
---------------------------------	-------	--------	--	--	---	---	---

## pH in Soil by EPA 9045D

pH	8.69		pH Units	1	5C13007	03/13/2015	03/13/2015
----	------	--	----------	---	---------	------------	------------

## SAR Metals by Metals by SW-846 6010C

Calcium	12800	70.9	mg/kg	1	963805	03/16/2015	03/16/2015
---------	-------	------	-------	---	--------	------------	------------

Magnesium	386000	35500	"	5	"	"	"
-----------	--------	-------	---	---	---	---	---

Origins Laboratory, Inc.



The results in this report apply to the samples analyzed in accordance with the chain of custody document. This analytical report must be reproduced in its entirety.

Eagle Environmental Consulting, Inc.

4101 Inca Street

Denver CO 80211

Martin C Eckert III

Project Number: [none]

Project: Noble - Trebor B  
11-18&11-20&11-21&11-3,4,19&11-5

SS-04 @ 2.5'

3/13/2015 4:05:00PM

Analyte	Result	Reporting Limit	Units	Dilution	Batch	Prepared	Analyzed	Notes
---------	--------	--------------------	-------	----------	-------	----------	----------	-------

## XENCO

X503169-01 (Soil)

### SAR Metals by Metals by SW-846 6010C

Sodium	190	70.9	mg/kg	1	963805	03/16/2015	03/16/2015
--------	-----	------	-------	---	--------	------------	------------

### Sodium Absorption Ratio

Sodium Absorption Ratio	0.07			1	963808	"	03/16/2015
-------------------------	------	--	--	---	--------	---	------------

### Specific Conductance by Modified 9050A

Specific Conductance (EC)	0.0625		mmhos/cm	1	5C13008	03/13/2015	03/13/2015
---------------------------	--------	--	----------	---	---------	------------	------------

Origins Laboratory, Inc.



The results in this report apply to the samples analyzed in accordance with the chain of custody document. This analytical report must be reproduced in its entirety.

Eagle Environmental Consulting, Inc.  
4101 Inca Street  
Denver CO 80211

Martin C Eckert III  
Project Number: [none]  
Project: Noble - Trebor B  
11-18&11-20&11-21&11-3,4,19&11-5

SS-05 @ 5'  
3/13/2015 4:10:00PM

Analyte	Result	Reporting Limit	Units	Dilution	Batch	Prepared	Analyzed	Notes
---------	--------	-----------------	-------	----------	-------	----------	----------	-------

Origins Laboratory, Inc.  
X503169-02 (Soil)

## Diesel Range Organics (DRO/TEPH) by EPA 8015C

Diesel (C10-C28)	ND	50.0	mg/kg	1	5C13014	03/13/2015	03/14/2015
------------------	----	------	-------	---	---------	------------	------------

Surrogate: o-Terphenyl	70.7 %	59-131			"	"	"
------------------------	--------	--------	--	--	---	---	---

## GBTEX + Napthalene by 8260C

Gasoline Range Hydrocarbons	0.306	0.200	mg/kg	1	5C13013	03/13/2015	03/14/2015
Benzene	ND	0.002	"	"	"	"	"
Toluene	0.002	0.002	"	"	"	"	"
Ethylbenzene	ND	0.002	"	"	"	"	"
Xylenes, total	0.014	0.002	"	"	"	"	"
Naphthalene	ND	0.007	"	"	"	"	"

Surrogate: 1,2-Dichloroethane-d4	110 %	70-130			"	"	"
Surrogate: Toluene-d8	106 %	70-130			"	"	"
Surrogate: 4-Bromofluorobenzene	104 %	70-130			"	"	"

Origins Laboratory, Inc.



The results in this report apply to the samples analyzed in accordance with the chain of custody document. This analytical report must be reproduced in its entirety.



Eagle Environmental Consulting, Inc.  
4101 Inca Street  
Denver CO 80211

Martin C Eckert III  
Project Number: [none]  
Project: Noble - Trebor B  
11-18&11-20&11-21&11-3,4,19&11-5

SS-08 @ 3'  
3/13/2015 3:45:00PM

Analyte	Result	Reporting Limit	Units	Dilution	Batch	Prepared	Analyzed	Notes
---------	--------	-----------------	-------	----------	-------	----------	----------	-------

Origins Laboratory, Inc.  
X503169-03 (Soil)

## Diesel Range Organics (DRO/TEPH) by EPA 8015C

Diesel (C10-C28)	ND	50.0	mg/kg	1	5C13014	03/13/2015	03/14/2015
------------------	----	------	-------	---	---------	------------	------------

Surrogate: o-Terphenyl	68.4 %	59-131			"	"	"
------------------------	--------	--------	--	--	---	---	---

## GBTEX + Napthalene by 8260C

Gasoline Range Hydrocarbons	0.547	0.200	mg/kg	1	5C13013	03/13/2015	03/14/2015
Benzene	ND	0.002	"	"	"	"	"
Toluene	0.002	0.002	"	"	"	"	"
Ethylbenzene	ND	0.002	"	"	"	"	"
Xylenes, total	0.017	0.002	"	"	"	"	"
Napthalene	ND	0.007	"	"	"	"	"

Surrogate: 1,2-Dichloroethane-d4	109 %	70-130			"	"	"
Surrogate: Toluene-d8	99.8 %	70-130			"	"	"
Surrogate: 4-Bromofluorobenzene	95.5 %	70-130			"	"	"

## pH in Soil by EPA 9045D

pH	8.82		pH Units	1	5C13007	03/13/2015	03/13/2015
----	------	--	----------	---	---------	------------	------------

## SAR Metals by Metals by SW-846 6010C

Calcium	8990	90.9	mg/kg	1	963805	03/16/2015	03/16/2015
Magnesium	2900	90.9	"	"	"	"	"

Origins Laboratory, Inc.



The results in this report apply to the samples analyzed in accordance with the chain of custody document. This analytical report must be reproduced in its entirety.

Eagle Environmental Consulting, Inc.

4101 Inca Street

Denver CO 80211

Martin C Eckert III

Project Number: [none]

Project: Noble - Trebor B  
11-18&11-20&11-21&11-3,4,19&11-5

SS-08 @ 3'

3/13/2015 3:45:00PM

Analyte	Result	Reporting Limit	Units	Dilution	Batch	Prepared	Analyzed	Notes
---------	--------	--------------------	-------	----------	-------	----------	----------	-------

## XENCO

X503169-03 (Soil)

### SAR Metals by Metals by SW-846 6010C

Sodium	149	90.9	mg/kg	1	963805	03/16/2015	03/16/2015
--------	-----	------	-------	---	--------	------------	------------

### Sodium Absorption Ratio

Sodium Absorption Ratio	0.35			1	963808	"	03/16/2015
-------------------------	------	--	--	---	--------	---	------------

### Specific Conductance by Modified 9050A

Specific Conductance (EC)	0.0629		mmhos/cm	1	5C13008	03/13/2015	03/13/2015
---------------------------	--------	--	----------	---	---------	------------	------------

Origins Laboratory, Inc.



The results in this report apply to the samples analyzed in accordance with the chain of custody document. This analytical report must be reproduced in its entirety.

Eagle Environmental Consulting, Inc.  
4101 Inca Street  
Denver CO 80211

Martin C Eckert III  
Project Number: [none]  
Project: Noble - Trebor B  
11-18&11-20&11-21&11-3,4,19&11-5

SS-10 @ 5'  
3/13/2015 3:55:00PM

Analyte	Result	Reporting Limit	Units	Dilution	Batch	Prepared	Analyzed	Notes
---------	--------	-----------------	-------	----------	-------	----------	----------	-------

Origins Laboratory, Inc.  
X503169-04 (Soil)

## Diesel Range Organics (DRO/TEPH) by EPA 8015C

Diesel (C10-C28)	ND	50.0	mg/kg	1	5C13014	03/13/2015	03/14/2015
------------------	----	------	-------	---	---------	------------	------------

Surrogate: o-Terphenyl	69.0 %	59-131			"	"	"
------------------------	--------	--------	--	--	---	---	---

## GBTEX + Napthalene by 8260C

Gasoline Range Hydrocarbons	ND	0.200	mg/kg	1	5C13013	03/13/2015	03/14/2015
Benzene	ND	0.002	"	"	"	"	"
Toluene	ND	0.002	"	"	"	"	"
Ethylbenzene	ND	0.002	"	"	"	"	"
Xylenes, total	ND	0.002	"	"	"	"	"
Naphthalene	ND	0.007	"	"	"	"	"

Surrogate: 1,2-Dichloroethane-d4	105 %	70-130			"	"	"
Surrogate: Toluene-d8	99.7 %	70-130			"	"	"
Surrogate: 4-Bromofluorobenzene	104 %	70-130			"	"	"

Origins Laboratory, Inc.



The results in this report apply to the samples analyzed in accordance with the chain of custody document. This analytical report must be reproduced in its entirety.



Eagle Environmental Consulting, Inc.  
4101 Inca Street  
Denver CO 80211

Martin C Eckert III  
Project Number: [none]  
Project: Noble - Trebor B  
11-18&11-20&11-21&11-3,4,19&11-5

SS-11 @ 3'  
3/13/2015 3:10:00PM

Analyte	Result	Reporting Limit	Units	Dilution	Batch	Prepared	Analyzed	Notes
---------	--------	-----------------	-------	----------	-------	----------	----------	-------

Origins Laboratory, Inc.  
X503169-05 (Soil)

## Diesel Range Organics (DRO/TEPH) by EPA 8015C

Diesel (C10-C28)	ND	50.0	mg/kg	1	5C13014	03/13/2015	03/14/2015
------------------	----	------	-------	---	---------	------------	------------

Surrogate: o-Terphenyl	61.1 %	59-131			"	"	"
------------------------	--------	--------	--	--	---	---	---

## GBTEX + Napthalene by 8260C

Gasoline Range Hydrocarbons	ND	0.200	mg/kg	1	5C13013	03/13/2015	03/14/2015
Benzene	ND	0.002	"	"	"	"	"
Toluene	0.003	0.002	"	"	"	"	"
Ethylbenzene	ND	0.002	"	"	"	"	"
Xylenes, total	0.005	0.002	"	"	"	"	"
Naphthalene	ND	0.007	"	"	"	"	"

Surrogate: 1,2-Dichloroethane-d4	108 %	70-130			"	"	"
Surrogate: Toluene-d8	90.9 %	70-130			"	"	"
Surrogate: 4-Bromofluorobenzene	106 %	70-130			"	"	"

## pH in Soil by EPA 9045D

pH	8.56		pH Units	1	5C13007	03/13/2015	03/13/2015
----	------	--	----------	---	---------	------------	------------

## SAR Metals by Metals by SW-846 6010C

Calcium	8630	87	mg/kg	1	963805	03/16/2015	03/16/2015
Magnesium	2540	87	"	"	"	"	"

Origins Laboratory, Inc.



The results in this report apply to the samples analyzed in accordance with the chain of custody document. This analytical report must be reproduced in its entirety.

Eagle Environmental Consulting, Inc.

4101 Inca Street

Denver CO 80211

Martin C Eckert III

Project Number: [none]

Project: Noble - Trebor B  
11-18&11-20&11-21&11-3,4,19&11-5

SS-11 @ 3'

3/13/2015 3:10:00PM

Analyte	Result	Reporting Limit	Units	Dilution	Batch	Prepared	Analyzed	Notes
---------	--------	--------------------	-------	----------	-------	----------	----------	-------

**XENCO**

**X503169-05 (Soil)**

### SAR Metals by Metals by SW-846 6010C

Sodium	387	87	mg/kg	1	963805	03/16/2015	03/16/2015
--------	-----	----	-------	---	--------	------------	------------

### Sodium Absorption Ratio

Sodium Absorption Ratio	0.94			1	963808	"	03/16/2015
-------------------------	------	--	--	---	--------	---	------------

### Specific Conductance by Modified 9050A

Specific Conductance (EC)	0.0889		mmhos/cm	1	5C13008	03/13/2015	03/13/2015
---------------------------	--------	--	----------	---	---------	------------	------------

Origins Laboratory, Inc.



The results in this report apply to the samples analyzed in accordance with the chain of custody document. This analytical report must be reproduced in its entirety.

Eagle Environmental Consulting, Inc.  
4101 Inca Street  
Denver CO 80211

Martin C Eckert III  
Project Number: [none]  
Project: Noble - Trebor B  
11-18&11-20&11-21&11-3,4,19&11-5

SS-15 @ 6.5'  
3/13/2015 3:40:00PM

Analyte	Result	Reporting Limit	Units	Dilution	Batch	Prepared	Analyzed	Notes
---------	--------	-----------------	-------	----------	-------	----------	----------	-------

Origins Laboratory, Inc.  
X503169-06 (Soil)

## Diesel Range Organics (DRO/TEPH) by EPA 8015C

Diesel (C10-C28)	402	50.0	mg/kg	1	5C13014	03/13/2015	03/14/2015
------------------	-----	------	-------	---	---------	------------	------------

Surrogate: o-Terphenyl	79.5 %	59-131			"	"	"
------------------------	--------	--------	--	--	---	---	---

## GBTEX + Napthalene by 8260C

Gasoline Range Hydrocarbons	67.2	5.00	mg/kg	25	5C13013	03/13/2015	03/14/2015
Benzene	0.140	0.050	"	"	"	"	"
Toluene	ND	0.050	"	"	"	"	"
Ethylbenzene	0.152	0.050	"	"	"	"	"
Xylenes, total	ND	0.050	"	"	"	"	"
Napthalene	0.265	0.175	"	"	"	"	"

Surrogate: 1,2-Dichloroethane-d4	105 %	70-130			"	"	"
Surrogate: Toluene-d8	99.5 %	70-130			"	"	"
Surrogate: 4-Bromofluorobenzene	102 %	70-130			"	"	"

Origins Laboratory, Inc.



The results in this report apply to the samples analyzed in accordance with the chain of custody document. This analytical report must be reproduced in its entirety.



Eagle Environmental Consulting, Inc.

4101 Inca Street

Denver CO 80211

Martin C Eckert III

Project Number: [none]

Project: Noble - Trebor B  
11-18&11-20&11-21&11-3,4,19&11-5

**Volatile Organic Compounds by GC/MS SW846 8260C - Quality Control**  
**Origins Laboratory, Inc.**

Analyte	Result	Reporting Limit	Units	Spike Level	Source Result	%REC	%REC Limits	RPD	RPD Limit	Notes
---------	--------	-----------------	-------	-------------	---------------	------	-------------	-----	-----------	-------

**Batch 5C13013 - EPA 5030 (soil)**

**Blank (5C13013-BLK1)**

Prepared: 03/13/2015 Analyzed: 03/14/2015

Gasoline Range Hydrocarbons	ND	0.200	mg/kg							
Benzene	ND	0.002	"							
Toluene	ND	0.002	"							
Ethylbenzene	ND	0.002	"							
Xylenes, total	ND	0.002	"							
Naphthalene	ND	0.007	"							
Surrogate: 1,2-Dichloroethane-d4	62		ug/kg	62.5		99.6	70-130			
Surrogate: Toluene-d8	60		"	62.5		96.4	70-130			
Surrogate: 4-Bromofluorobenzene	67		"	62.5		107	70-130			

Origins Laboratory, Inc.



The results in this report apply to the samples analyzed in accordance with the chain of custody document. This analytical report must be reproduced in its entirety.

Eagle Environmental Consulting, Inc.

4101 Inca Street

Denver CO 80211

Martin C Eckert III

Project Number: [none]

Project: Noble - Trebor B  
11-18&11-20&11-21&11-3,4,19&11-5

**Volatile Organic Compounds by GC/MS SW846 8260C - Quality Control**  
**Origins Laboratory, Inc.**

Analyte	Result	Reporting Limit	Units	Spike Level	Source Result	%REC	%REC Limits	RPD	RPD Limit	Notes
<b>Batch 5C13013 - EPA 5030 (soil)</b>										
<b>LCS (5C13013-BS1)</b>					Prepared: 03/13/2015 Analyzed: 03/14/2015					
Benzene	0.091	0.002	mg/kg	0.100		90.9	70-130			
Toluene	0.097	0.002	"	0.100		97.4	70-130			
Ethylbenzene	0.098	0.002	"	0.100		97.6	70-130			
m,p-Xylene	0.200	0.004	"	0.200		100	70-130			
o-Xylene	0.100	0.002	"	0.100		100	70-130			
Naphthalene	0.118	0.007	"	0.100		118	70-130			
Surrogate: 1,2-Dichloroethane-d4	61		ug/kg	62.5		98.3	70-130			
Surrogate: Toluene-d8	63		"	62.5		101	70-130			
Surrogate: 4-Bromofluorobenzene	64		"	62.5		102	70-130			

Origins Laboratory, Inc.



The results in this report apply to the samples analyzed in accordance with the chain of custody document. This analytical report must be reproduced in its entirety.

Eagle Environmental Consulting, Inc.  
4101 Inca Street  
Denver CO 80211

Martin C Eckert III  
Project Number: [none]  
Project: Noble - Trebor B  
11-18&11-20&11-21&11-3,4,19&11-5

**Volatile Organic Compounds by GC/MS SW846 8260C - Quality Control**  
**Origins Laboratory, Inc.**

Analyte	Result	Reporting Limit	Units	Spike Level	Source Result	%REC	%REC Limits	RPD	RPD Limit	Notes
<b>Batch 5C13013 - EPA 5030 (soil)</b>										
<b>Matrix Spike (5C13013-MS1)</b>		<b>Source: X503168-01</b>			Prepared: 03/13/2015	Analyzed: 03/14/2015				<b>QM-07</b>
Benzene	0.033	0.002	mg/kg	0.100	ND	32.5	70-130			
Toluene	0.032	0.002	"	0.100	ND	32.0	70-130			
Ethylbenzene	0.034	0.002	"	0.100	ND	34.4	70-130			
m,p-Xylene	0.073	0.004	"	0.200	ND	36.5	70-130			
o-Xylene	0.037	0.002	"	0.100	ND	37.2	70-130			
Naphthalene	0.037	0.007	"	0.100	0.001	35.6	70-130			
Surrogate: 1,2-Dichloroethane-d4	73		ug/kg	62.5		116	70-130			
Surrogate: Toluene-d8	62		"	62.5		99.9	70-130			
Surrogate: 4-Bromofluorobenzene	62		"	62.5		99.6	70-130			

Origins Laboratory, Inc.



The results in this report apply to the samples analyzed in accordance with the chain of custody document. This analytical report must be reproduced in its entirety.



Eagle Environmental Consulting, Inc.  
4101 Inca Street  
Denver CO 80211

Martin C Eckert III  
Project Number: [none]  
Project: Noble - Trebor B  
11-18&11-20&11-21&11-3,4,19&11-5

**Volatile Organic Compounds by GC/MS SW846 8260C - Quality Control**  
**Origins Laboratory, Inc.**

Analyte	Result	Reporting Limit	Units	Spike Level	Source Result	%REC	%REC Limits	RPD	RPD Limit	Notes
<b>Batch 5C13013 - EPA 5030 (soil)</b>										
<b>Matrix Spike Dup (5C13013-MSD1)</b>		<b>Source: X503168-01</b>			Prepared: 03/13/2015	Analyzed: 03/14/2015				<b>QM-07</b>
Benzene	0.075	0.002	mg/kg	0.100	ND	75.0	70-130	78.9	20	
Toluene	0.075	0.002	"	0.100	ND	74.6	70-130	79.8	20	
Ethylbenzene	0.073	0.002	"	0.100	ND	73.1	70-130	72.1	20	
m,p-Xylene	0.154	0.004	"	0.200	ND	76.8	70-130	71.0	20	
o-Xylene	0.076	0.002	"	0.100	ND	76.4	70-130	69.0	20	
Naphthalene	0.083	0.007	"	0.100	0.001	81.6	70-130	76.9	20	
Surrogate: 1,2-Dichloroethane-d4	74		ug/kg	62.5		118	70-130			
Surrogate: Toluene-d8	64		"	62.5		103	70-130			
Surrogate: 4-Bromofluorobenzene	67		"	62.5		107	70-130			

Origins Laboratory, Inc.



The results in this report apply to the samples analyzed in accordance with the chain of custody document. This analytical report must be reproduced in its entirety.

Eagle Environmental Consulting, Inc.  
4101 Inca Street  
Denver CO 80211

Martin C Eckert III  
Project Number: [none]  
Project: Noble - Trebor B  
11-18&11-20&11-21&11-3,4,19&11-5

**Volatile Organic Compounds by GC/MS SW846 8260C - Quality Control**  
**Origins Laboratory, Inc.**

Analyte	Result	Reporting Limit	Units	Spike Level	Source Result	%REC	%REC Limits	RPD	RPD Limit	Notes
---------	--------	-----------------	-------	-------------	---------------	------	-------------	-----	-----------	-------

**Extractable Petroleum Hydrocarbons by 8015C - Quality Control**  
**Origins Laboratory, Inc.**

Analyte	Result	Reporting Limit	Units	Spike Level	Source Result	%REC	%REC Limits	RPD	RPD Limit	Notes
---------	--------	-----------------	-------	-------------	---------------	------	-------------	-----	-----------	-------

**Batch 5C13014 - EPA 3580**

**Blank (5C13014-BLK1)**

Prepared: 03/13/2015 Analyzed: 03/13/2015

Diesel (C10-C28) ND 50.0 mg/kg

Surrogate: o-Terphenyl 36 " 50.0 72.8 59-131

**LCS (5C13014-BS1)**

Prepared: 03/13/2015 Analyzed: 03/13/2015

Diesel (C10-C28) 808 50.0 mg/kg 1000 80.8 64-121

Surrogate: o-Terphenyl 42 " 50.0 84.0 59-131

**Matrix Spike (5C13014-MS1)**

**Source: X503169-01**

Prepared: 03/13/2015 Analyzed: 03/13/2015

Diesel (C10-C28) 925 50.0 mg/kg 1000 21.9 90.3 53-125

Surrogate: o-Terphenyl 39 " 50.0 77.1 59-131

**Matrix Spike Dup (5C13014-MSD1)**

**Source: X503169-01**

Prepared: 03/13/2015 Analyzed: 03/13/2015

Diesel (C10-C28) 806 50.0 mg/kg 1000 21.9 78.4 53-125 13.7 20

Surrogate: o-Terphenyl 36 " 50.0 72.3 59-131

Origins Laboratory, Inc.



The results in this report apply to the samples analyzed in accordance with the chain of custody document. This analytical report must be reproduced in its entirety.

Eagle Environmental Consulting, Inc.  
4101 Inca Street  
Denver CO 80211

Martin C Eckert III  
Project Number: [none]  
Project: Noble - Trebor B  
11-18&11-20&11-21&11-3,4,19&11-5

## Classical Chemistry Parameters - Quality Control Origins Laboratory, Inc.

Analyte	Result	Reporting Limit	Units	Spike Level	Source Result	%REC	%REC Limits	RPD	RPD Limit	Notes
<b>Batch 5C13007 - NO PREP</b>										
<b>Duplicate (5C13007-DUP1)</b>		<b>Source: X503131-01</b>			Prepared: 03/13/2015 Analyzed: 03/13/2015					
pH	9.40		pH Units		9.35			0.533	25	
<b>Batch 5C13008 - NO PREP</b>										
<b>Blank (5C13008-BLK1)</b>		Prepared: 03/13/2015 Analyzed: 03/13/2015								
Specific Conductance (EC)	0.00240		mmhos/cm							
<b>Duplicate (5C13008-DUP1)</b>		<b>Source: X503131-01</b>			Prepared: 03/13/2015 Analyzed: 03/13/2015					
Specific Conductance (EC)	1.58		mmhos/cm		1.58			0.569	25	

Origins Laboratory, Inc.



The results in this report apply to the samples analyzed in accordance with the chain of custody document. This analytical report must be reproduced in its entirety.

Eagle Environmental Consulting, Inc.  
4101 Inca Street  
Denver CO 80211

Martin C Eckert III  
Project Number: [none]  
Project: Noble - Trebor B  
11-18&11-20&11-21&11-3,4,19&11-5

## SAR Metals by Metals by SW-846 6010C - Quality Control XENCO

Analyte	Result	Reporting Limit	Units	Spike Level	Source Result	%REC	%REC Limits	RPD	RPD Limit	Notes
<b>Batch 963805 - SW3050B</b>										
<b>MS (504020-001 S)</b>		<b>Source: 504020-001 S</b>			Prepared: 03/16/2015 Analyzed: 03/16/2015					
Sodium	1070	90.1	mg/kg	811	190	109	75-125		20	
Calcium	13700	90.1	"	811	12800	111	75-125		20	
Magnesium	4380	90.1	"	811	3400	121	75-125		20	
<b>MSD (504020-001 SD)</b>		<b>Source: 504020-001 SD</b>			Prepared: 03/16/2015 Analyzed: 03/16/2015					
Magnesium	4390	99	mg/kg	891	3400	111	75-125	0	20	
Sodium	1150	99	"	891	190	108	75-125	7	20	
Calcium	13600	99	"	891	12800	90	75-125	1	20	
<b>LCS (689774-1-BKS)</b>		<b>Source: 689774-1-BKS</b>			Prepared: 03/16/2015 Analyzed: 03/16/2015					
Magnesium	899	100	mg/kg	900	<1.22	100	75-125		20	
Calcium	903	100	"	900	0.94	100	75-125		20	
Sodium	868	100	"	900	<0.260	96	75-125		20	
<b>BLANK (689774-1-BLK)</b>		<b>Source: 689774-1-BLK</b>			Prepared: 03/16/2015 Analyzed: 03/16/2015					
Magnesium	ND	100	mg/kg	900			-		20	
Sodium	ND	100	"	900			-		20	
Calcium	0.94	100	"	900			-		20	J
<b>LCSD (689774-1-BSD)</b>		<b>Source: 689774-1-BSD</b>			Prepared: 03/16/2015 Analyzed: 03/16/2015					
Magnesium	893	100	mg/kg	900	<1.22	99	75-125	1	20	
Sodium	863	100	"	900	<0.260	96	75-125	1	20	
Calcium	900	100	"	900	0.94	100	75-125	0	20	

Origins Laboratory, Inc.



The results in this report apply to the samples analyzed in accordance with the chain of custody document. This analytical report must be reproduced in its entirety.



Eagle Environmental Consulting, Inc.

4101 Inca Street

Denver CO 80211

Martin C Eckert III

Project Number: [none]

Project: Noble - Trebor B  
11-18&11-20&11-21&11-3,4,19&11-5

## Notes and Definitions

QM-07 The spike recovery was outside acceptance limits for the MS and/or MSD. The batch was accepted based on acceptable LCS recovery.

J detected between the MDL and PQL

D [Undefined]

ND Analyte NOT DETECTED at or above the reporting limit

RPD Relative Percent Difference

All soil results are reported at a wet weight basis.

Origins Laboratory, Inc.



*The results in this report apply to the samples analyzed in accordance with the chain of custody document. This analytical report must be reproduced in its entirety.*

Jen Pellegrini For Noelle Doyle Mathis, President