

1/21/16

C:\Usra\awelch\Dropbox\CAD Files\Gregory pod layout.dwg

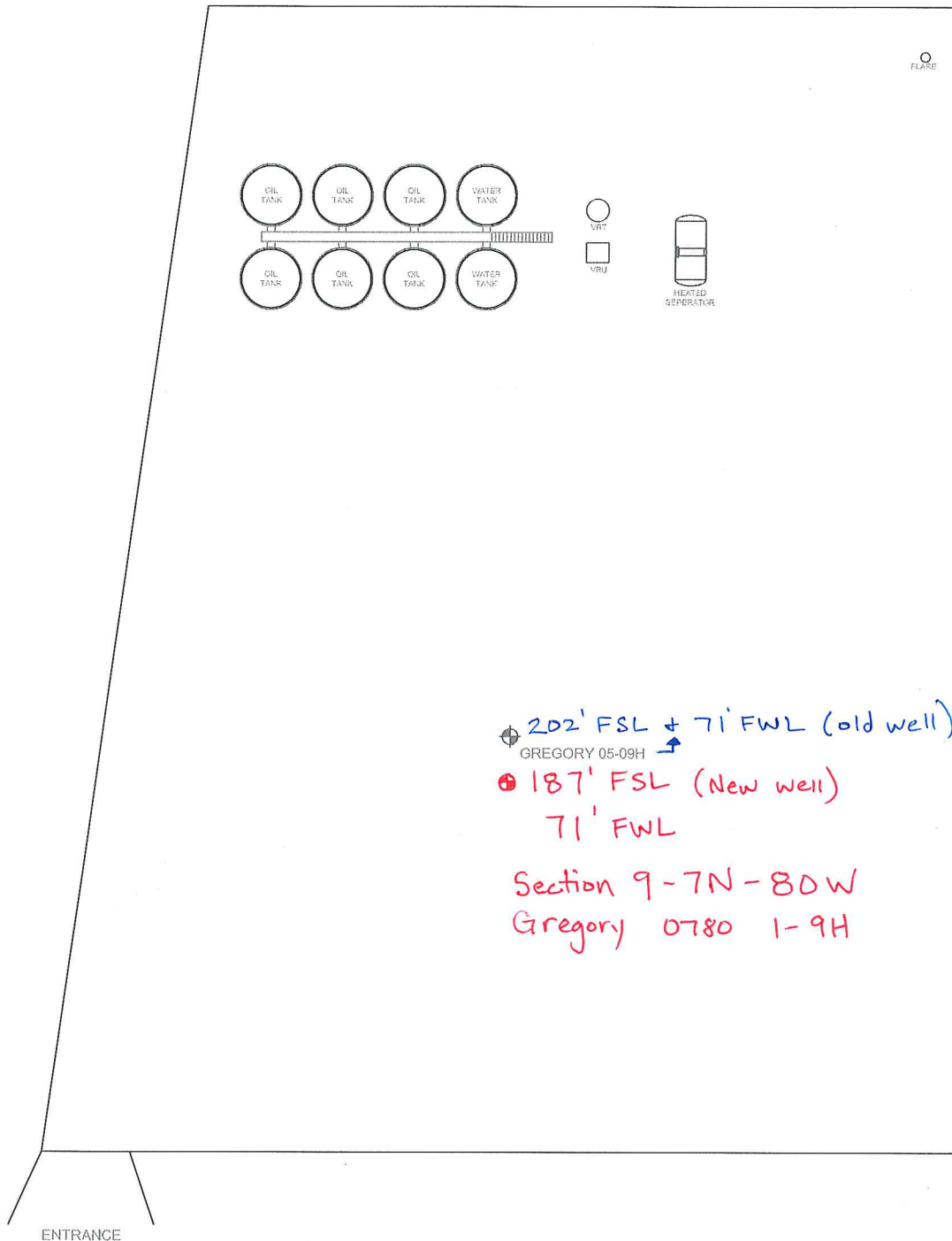

|                         |  |        |  |   |  |  |   |  |  |  |  |  |  |  |  |  |  |  |  |  |  |  |  |  |  |  |  |  |  |  |  |  |  |  |  |  |  |  |  |  |  |  |  |  |  |  |  |  |
|-------------------------|--|--------|--|---|--|--|---|--|--|--|--|--|--|--|--|--|--|--|--|--|--|--|--|--|--|--|--|--|--|--|--|--|--|--|--|--|--|--|--|--|--|--|--|--|--|--|--|--|
| GREGORY 0780 1-9H       |  |        |  | Prop. By: _____<br>Drawn by: _____<br>Engineer: _____<br>Location: _____<br>Scale: _____  |  |  | REVISIONS<br>Revision    Date    Drawn    Chk'd    Eng. |  |  |  |  |  |  |  |  |  |  |  |  |  |  |  |  |  |  |  |  |  |  |  |  |  |  |  |  |  |  |  |  |  |  |  |  |  |  |  |  |  |
| Seq. No.    Dt.    Rev. |  | NOTES: |  | <table border="1"> <tr><td> </td><td> </td><td> </td><td> </td><td> </td></tr> <tr><td> </td><td> </td><td> </td><td> </td><td> </td></tr> <tr><td> </td><td> </td><td> </td><td> </td><td> </td></tr> <tr><td> </td><td> </td><td> </td><td> </td><td> </td></tr> <tr><td> </td><td> </td><td> </td><td> </td><td> </td></tr> <tr><td> </td><td> </td><td> </td><td> </td><td> </td></tr> <tr><td> </td><td> </td><td> </td><td> </td><td> </td></tr> <tr><td> </td><td> </td><td> </td><td> </td><td> </td></tr> </table> |  |  |   |  |  |  |  |  |  |  |  |  |  |  |  |  |  |  |  |  |  |  |  |  |  |  |  |  |  |  |  |  |  |  |  |  |  |  |  |  |  |  |  |  |
|                         |  |        |  |   |  |  |   |  |  |  |  |  |  |  |  |  |  |  |  |  |  |  |  |  |  |  |  |  |  |  |  |  |  |  |  |  |  |  |  |  |  |  |  |  |  |  |  |  |
|                         |  |        |  |   |  |  |   |  |  |  |  |  |  |  |  |  |  |  |  |  |  |  |  |  |  |  |  |  |  |  |  |  |  |  |  |  |  |  |  |  |  |  |  |  |  |  |  |  |
|                         |  |        |  |   |  |  |   |  |  |  |  |  |  |  |  |  |  |  |  |  |  |  |  |  |  |  |  |  |  |  |  |  |  |  |  |  |  |  |  |  |  |  |  |  |  |  |  |  |
|                         |  |        |  |   |  |  |   |  |  |  |  |  |  |  |  |  |  |  |  |  |  |  |  |  |  |  |  |  |  |  |  |  |  |  |  |  |  |  |  |  |  |  |  |  |  |  |  |  |
|                         |  |        |  |   |  |  |   |  |  |  |  |  |  |  |  |  |  |  |  |  |  |  |  |  |  |  |  |  |  |  |  |  |  |  |  |  |  |  |  |  |  |  |  |  |  |  |  |  |
|                         |  |        |  |   |  |  |   |  |  |  |  |  |  |  |  |  |  |  |  |  |  |  |  |  |  |  |  |  |  |  |  |  |  |  |  |  |  |  |  |  |  |  |  |  |  |  |  |  |
|                         |  |        |  |   |  |  |   |  |  |  |  |  |  |  |  |  |  |  |  |  |  |  |  |  |  |  |  |  |  |  |  |  |  |  |  |  |  |  |  |  |  |  |  |  |  |  |  |  |
|                         |  |        |  |   |  |  |   |  |  |  |  |  |  |  |  |  |  |  |  |  |  |  |  |  |  |  |  |  |  |  |  |  |  |  |  |  |  |  |  |  |  |  |  |  |  |  |  |  |

1/21/16 10:14 AM

Updated Plat 1/21/16

T7N, R80W, 6th P.M.

GLO Brass Cap 1939

Elev. = 8091'

N=1462619.36, E=2753447.58

S89°57'48"E 5301.59' (Meas.)

GREGORY 0780 1-9H

Target Bottom Hole

300' FNL, 350' FWL

N=1462319.14, E=2753792.52

Monument  
not found

9

GLO Brass Cap 1939

N=1459848.95, E=2753400.45

GREGORY 0780 1-9H

Landing Point Location

965' FSL, 350' FWL

N=1458052.88, E=2753721.34

GREGORY 0780 1-9H

Surface Location Elev. Ungraded

Ground= 8118' 187' FSL, 71' FWL

202' FSL, 71' FWL Old well

Alum. Cap 2008

PLS 17492

N=1457081.47, East=2753355.52

S89°01'04"W 5321.21' (Meas.)

Monument  
not found

LEGEND

FOUND CORNER  
PROPOSED WELL  
PROPOSED BHL/LPL

NAD 83 (SURFACE LOCATION)

PDOP = 1.398

NAD 83 (LANDING POINT LOCATION)

LATITUDE=40.587373°N  
LONGITUDE=106.386737°W

NAD 83 (TARGET BOTTOM HOLE)

LATITUDE=40.5990855°N  
LONGITUDE=106.386634°W

NORTH PARK ENGINEERING &  
CONSULTING, INC.

P.O. BOX 395  
WALDEN, CO 80480  
(970) 723-3725

DATE OF FIELD WORK: SEPT 12, 2013 DRAWING COMPLETION: NOV. 15, 2015  
SURVEYED BY: RAS  
DRAWN BY: TAT/TKH  
CHECKED BY: RRM

GLO Brass  
Cap 1939

N=1462615.97

E=2758749.16

EE3 LLC

Well location, GREGORY 0780 1-9H located as shown in the SW1/4SW1/4 of Section 9, T7N, R80W, 6th P.M., Jackson County, Colorado.

BASIS OF BEARINGS:

US STATE PLANE 1983

CO NORTH 0501 GRID

BASIS OF ELEVATION

SPOT ELEVATION AT THE NW CORNER OF SECTION 9, T7N, R80W, 6th PM, TAKEN FROM THE COALMONT QUADRANGLE, USGS 7.5 MIN QUAD (TOPOGRAPHIC MAP) WITH SAID ELEVATION MARKED AS BEING 8091 FEET.

Monument  
not found

GRAPHIC SCALE 1"=1000'



1000 0 1000



I, RANDALL R. MILLER, BEING A REGISTERED LAND SURVEYOR IN THE STATE OF COLORADO, DO HEREBY CERTIFY THAT THE PLAT HEREIN IS ACCURATE TO THE BEST OF MY KNOWLEDGE.

DATED THIS \_\_\_\_ DAY OF \_\_\_\_

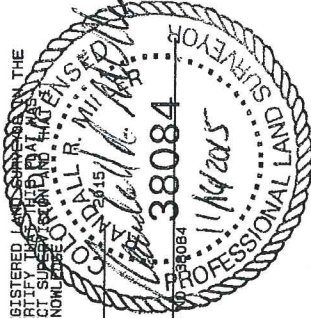

RANDALL R. MILLER, COLORADO PLS NO. 38084

GLO Brass Cap 1939

N=1457172.68

E=2758675.95