

NOTES:

- ALL BEARINGS ARE GRID BASED UPON THE COLORADO STATE PLANE COORDINATE SYSTEM, NORTH ZONE, NAD83(2011) DERIVED FROM POST-PROCESSED STATIC GPS OBSERVATIONS.
- DISTANCES ARE ON GRID
- VERTICAL DATUM IS NAVD88 BASED UPON GPS OBSERVATIONS
- PDOP VALUE EQUALS 1.2.
- GPS OPERATOR: MIKE JOHNSON.
- UNDISTURBED GROUND ELEVATION AT WELLHEAD = 4677.2'
- ALL SECTION LENGTHS ARE MEASURED DISTANCES UNLESS NOTED BY (R), RECORD BEARING AND DISTANCE.
- NEAREST CULTURAL DISTANCES
 - BUILDINGS: 5280' +
 - BUILDING UNIT: 5280' +
 - HIGH OCCUPANCY BUILDING UNIT: 5280' +
 - DESIGNATED OUTSIDE ACTIVITY AREA: 5280' +
 - PUBLIC ROAD: 5280' +
 - ABOVE GROUND UTILITY: 5280' +
 - RAILROAD: 5280' +
 - PROPERTY LINE: 390' +/-

3	NAD 83		STATE PLANE COORDINATES	
41-44-28HNB	LATITUDE	LONGITUDE	NORTHING	EASTING
SURFACE	40.37907	104.32108	1383119	3328433
TARGET 1	40.37654	104.32177	1382194	3328253
BOTTOM HOLE	40.36472	104.32171	1377891	3328326

CERTIFICATE OF SURVEYOR:

I, DAVID A. FEHRINGER OF LANDER, WYOMING HEREBY CERTIFY THAT THIS WELL LOCATION CERTIFICATE WAS PREPARED FROM NOTES TAKEN DURING AN ACTUAL SURVEY ON JANUARY 08, 2016; AND THAT IT CORRECTLY SHOWS THE DRILLING LOCATION OF BONANZA CREEK ENERGY, INC., ANTELOPE 41-44-28HNB AS STAKED DURING SAID SURVEY. THIS MAP DOES NOT REPRESENT A BOUNDARY SURVEY OR AN IMPROVEMENT LOCATION PLAT AND SHOULD NOT BE USED FOR THE ESTABLISHMENT OF BOUNDARY LINES.

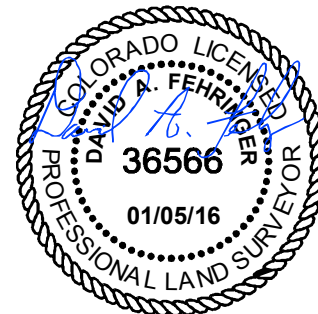

WILLIAM H. SMITH & ASSOCIATES, Inc.
155 N. 1st Street
Lander, WY 82520
Phone: 307-335-5646

Drawn By: MAM
Job No.:
Checked By: DAF
Date: 01/05/16
Revision: 1 1/10/16 SECTION LINE CHANGE

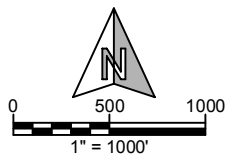

IF BAR LENGTH DOES NOT EQUAL 1"(ONE INCH), THIS PAGE WAS NOT PLOTTED TO THE INTENDED SCALE

LOCATION CERTIFICATE

ANTELOPE
41-44-28HNB
SE $\frac{1}{4}$ SE $\frac{1}{4}$, SECTION 21,
T.5N., R.62W., 6th PM
WELD COUNTY, COLORADO



410 17th Street
Denver, CO 80202
(720) 440-6100

SHEET

1

OF

2

3.25" AC LS7242
LAT 40.37790°N
LONG 104.33819°W

NOTE: UNDER COLORADO LAW, YOU
MUST COMMENCE ANY LEGAL ACTION
BASED ON ANY DEFECT IN THIS
CERTIFICATE WITHIN THREE YEARS
AFTER DEFECT IS DISCOVERED. IN NO
EVENT MAY ANY ACTION BASED UPON
ANY DEFECT IN THIS SURVEY BE
COMMENCED MORE THAN TEN YEARS
AFTER DATE OF THIS CERTIFICATE
SHOWN HEREON. (13-80105 C.R.S.)

5177.50'
S88°50'47"W

SURFACE LOCATION

416

S11°01'00"W
942.39'

3.25" AC LS7242
LAT 40.37800°N
LONG 104.31960°W

TARGET 1
531'FNL, 604'FEL

4304.03'
S00°58'15"E

N00°56'11"W
2654.63'

T.5N R.62W
28

3" AC LS4845
LAT 40.37072°N
LONG 104.31958°W

5275.73'
S00°35'16"E

N00°55'32"W
2654.27'

BOTTOM HOLE LOCATION
470'FSL, 601'FEL

3.25" AC LS7242
LAT 40.36342°N
LONG 104.33824°W

5209.02'
S89°12'49"W

3" AC LS4845
LAT 40.36343°N
LONG 104.31955°W

NOTES:

- ALL BEARINGS ARE GRID BASED UPON THE COLORADO STATE PLANE COORDINATE SYSTEM, NORTH ZONE, NAD83(2011) DERIVED FROM POST-PROCESSED STATIC GPS OBSERVATIONS.
- DISTANCES ARE ON GRID
- VERTICAL DATUM IS NAVD88 BASED UPON GPS OBSERVATIONS
- PDOP VALUE EQUALS 1.2.
- GPS OPERATOR: MIKE JOHNSON.
- UNDISTURBED GROUND ELEVATION AT WELLHEAD = 4677.2'
- ALL SECTION LENGTHS ARE MEASURED DISTANCES UNLESS NOTED BY (R), RECORD BEARING AND DISTANCE.
- NEAREST CULTURAL DISTANCES
BUILDINGS: 5280' +
BUILDING UNIT: 5280' +
HIGH OCCUPANCY BUILDING UNIT: 5280' +
DESIGNATED OUTSIDE ACTIVITY AREA: 5280' +
PUBLIC ROAD: 5280' +
ABOVE GROUND UTILITY: 5280' +
RAILROAD: 5280' +
PROPERTY LINE: 390' +/-

CERTIFICATE OF SURVEYOR:

I, DAVID A. FEHRINGER OF LANDER, WYOMING HEREBY CERTIFY THAT THIS WELL LOCATION CERTIFICATE WAS PREPARED FROM NOTES TAKEN DURING AN ACTUAL SURVEY ON JANUARY 08, 2016; AND THAT IT CORRECTLY SHOWS THE DRILLING LOCATION OF BONANZA CREEK ENERGY, INC., ANTELOPE 41-44-28HNB AS STAKED DURING SAID SURVEY. THIS MAP DOES NOT REPRESENT A BOUNDARY SURVEY OR AN IMPROVEMENT LOCATION PLAT AND SHOULD NOT BE USED FOR THE ESTABLISHMENT OF BOUNDARY LINES.

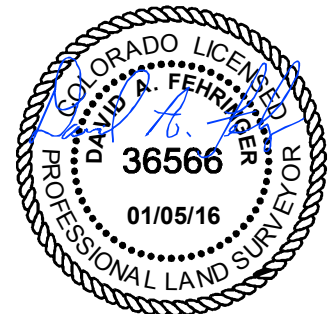

3	NAD 83		STATE PLANE COORDINATES	
41-44-28HNB	LATITUDE	LONGITUDE	NORTHING	EASTING
SURFACE	40.37907	104.32108	1383119	3328433
TARGET 1	40.37654	104.32177	1382194	3328253
BOTTOM HOLE	40.36472	104.32171	1377891	3328326



**WILLIAM H. SMITH &
ASSOCIATES, Inc.**
155 N. 1st Street
Lander, WY 82520
Phone: 307-335-5646

Drawn By: MAM
Job No.:
Checked By: DAF
Date: 01/05/16
Revision: 1 1/10/16 SECTION CHANGE

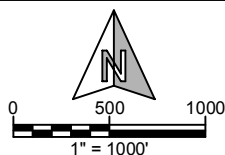

IF BAR LENGTH DOES NOT EQUAL
1"(ONE INCH), THIS PAGE WAS NOT
PLOT TO THE INTENDED SCALE

LOCATION CERTIFICATE

ANTELOPE
41-44-28HNB
BOTTOM HOLE
SE¼ SE¼, SECTION 28,
T.5N., R.62W., 6th PM
WELD COUNTY, COLORADO



410 17th Street
Denver, CO 80202
(720) 440-6100

SHEET

2

OF

2