

**BMC B
Looking North**



**BMC B
Looking East**



**BMC B
Looking West**



**BMC B
Looking South**

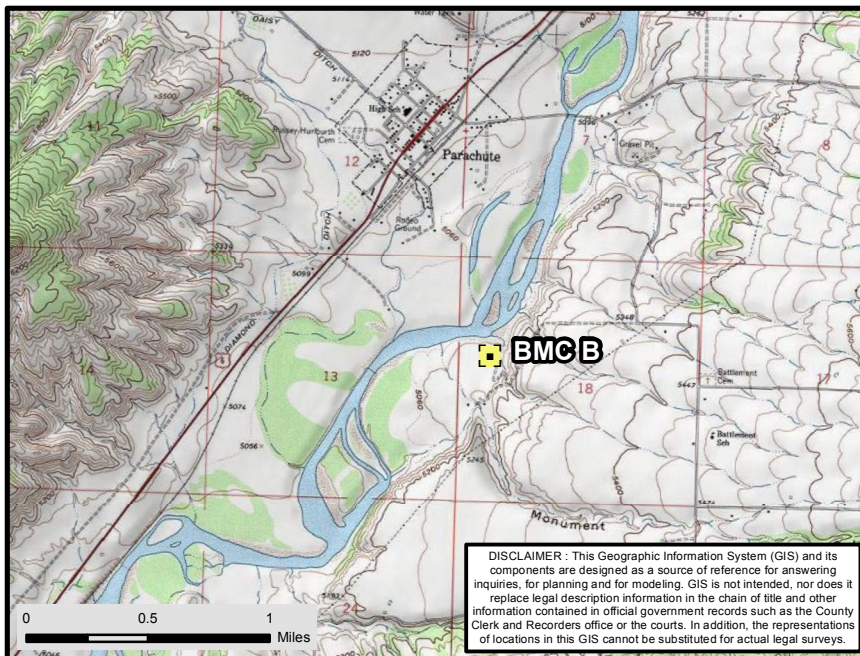

Form 2A - Attachment B
Four Color Photographs
BMC B

39.43885 -108.04658
Section 18, Township 7 South, Range 95 West

Note: Color photographs show the proposed BMC B pad in the four cardinal directions as noted.



Author: M. Spinelli

Revision: 0

Date: 10/2/2014