

WHITING OIL & GAS CORP.

CONSTRUCTION LAYOUT FOR

HORSETAIL 18 PIT

SECTION 18, T10N, R57W, 6th P.M.

646' FSL 1873' FEL

FIGURE #1

SCALE: 1" = 100'

DATE: 12-05-13

DRAWN BY: J.S.

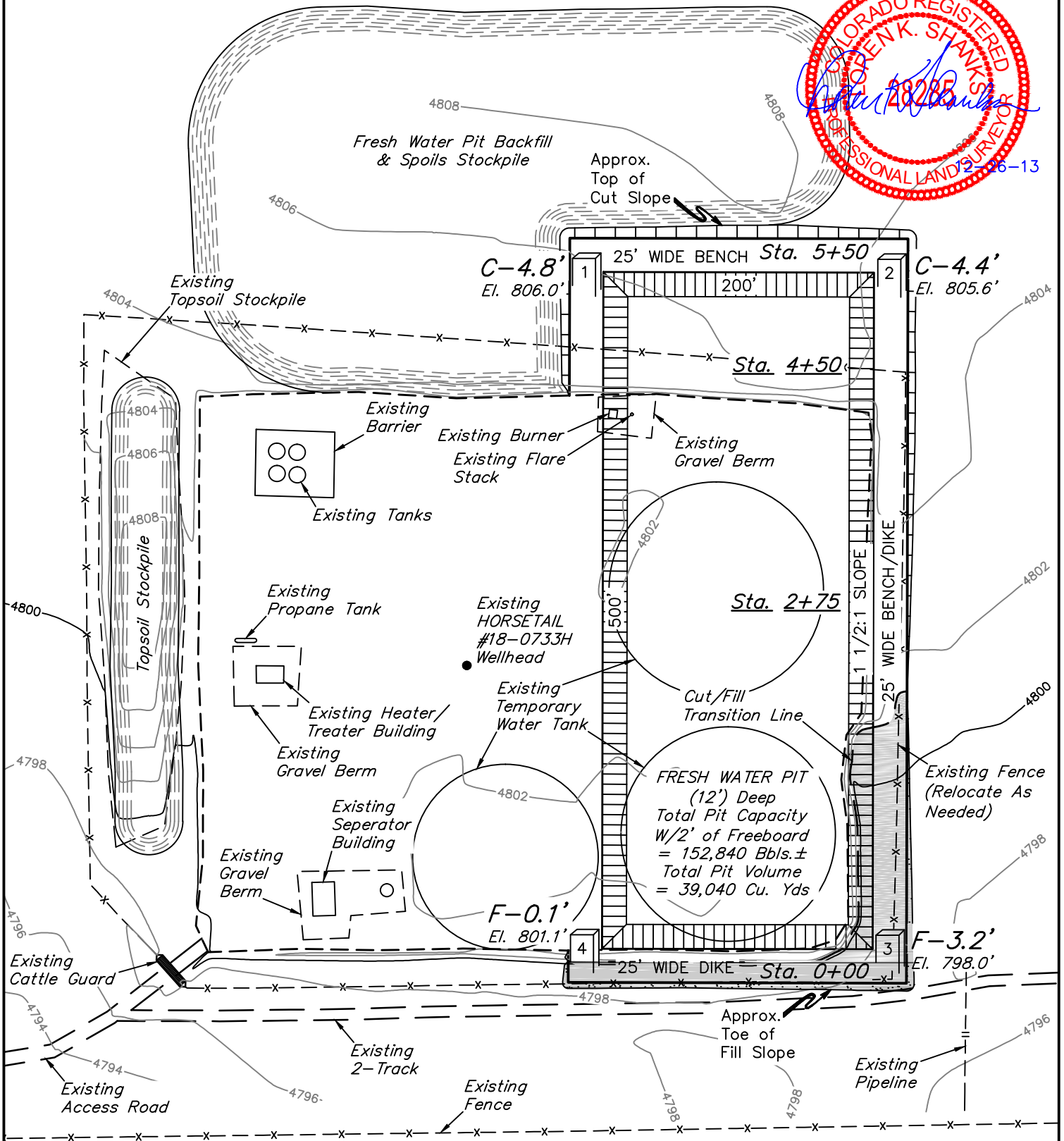
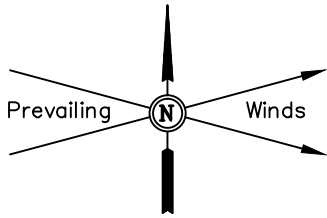

Elev. Ungraded Ground At CORNER 1 Loc. Stake = 4806.0'
FINISHED GRADE ELEV. AT CORNER 1 LOC. STAKE = 4801.2'

UINTAH ENGINEERING & LAND SURVEYING
85 So. 200 East * Vernal, Utah 84078 * (435) 789-1017

1" = 40'
 X-Section Scale
 1" = 100'
 DATE: 12-05-13
 DRAWN BY: J.S.

WHITING OIL & GAS CORP.
CONSTRUCTION LAYOUT CROSS SECTIONS FOR
HORSETAIL 18 PIT
SECTION 18, T10N, R57W, 6th P.M.
646' FSL 1873' FEL

FIGURE #2

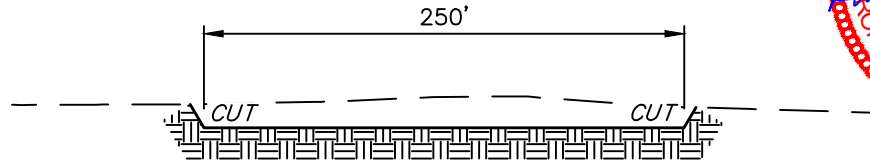

Sta. 5+50

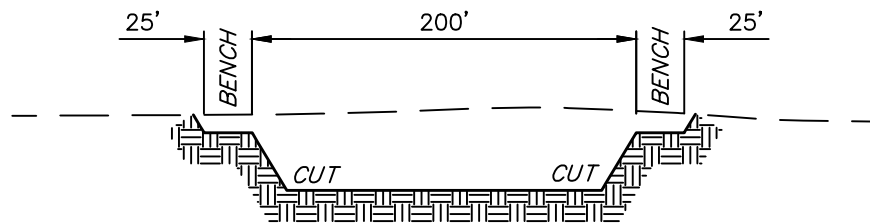

Sta. 4+50

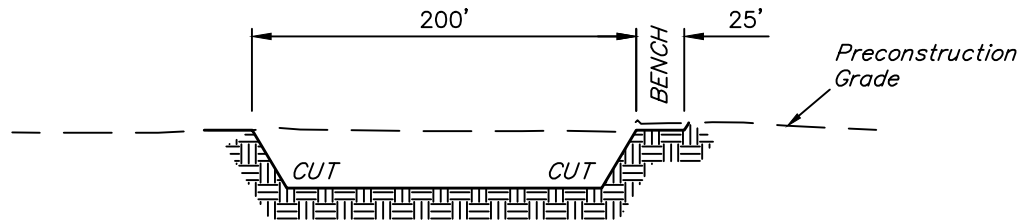

Sta. 2+75

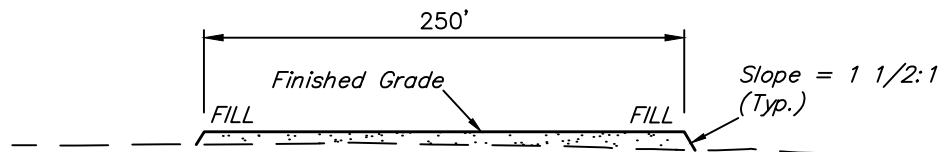

Sta. 0+00

APPROXIMATE ACREAGE
 EXISTING WELL SITE DISTURBANCE = ± 6.488 ACRES
 NEW CONSTRUCTION DISTURBANCE = ± 2.920 ACRES
 TOTAL SITE DISTURBANCE = ± 9.408 ACRES

* NOTE:
 FILL QUANTITY INCLUDES
 5% FOR COMPACTION

APPROXIMATE YARDAGES

(6") Topsoil Stripping = 1,070 Cu. Yds.
 (New Construction Only)
 Remaining Location = 43,450 Cu. Yds.
TOTAL CUT = 44,520 CU. YDS.
FILL = 1,230 CU. YDS.

EXCESS MATERIAL = 43,290 Cu. Yds.
 Topsoil & Pit Backfill = 40,110 Cu. Yds.
 (Pit Volume)
 EXCESS UNBALANCE = 3,180 Cu. Yds.
 (After Interim Rehabilitation)

UINTAH ENGINEERING & LAND SURVEYING
 85 So. 200 East * Vernal, Utah 84078 * (435) 789-1017