

Bayswater Exploration & Production, LLC

Well Name: **Carlson G-15-16HN**

Surface Location: Carlson 15-D Pad Sec.15-T5N-R65W
North American Datum 1983 , US State Plane 1983 , Colorado Northern Zone

Ground Elevation: 4621.0

+N/-S	+E/-W	Northing	Easting	Latitude	Longitude	Slot
0.0	0.0	1391065.16	3239187.13	40.403696	-104.641131	
RKB - 22.5' WELL @ 4643.5ft (RKB - 22.5')						

FINAL SURVEY

Projected Bottom Hole Location
14774'MD 6932'TVD 504'S & 7908'W of SHL
90.8 degree Incl @ 269.8 degree AZM

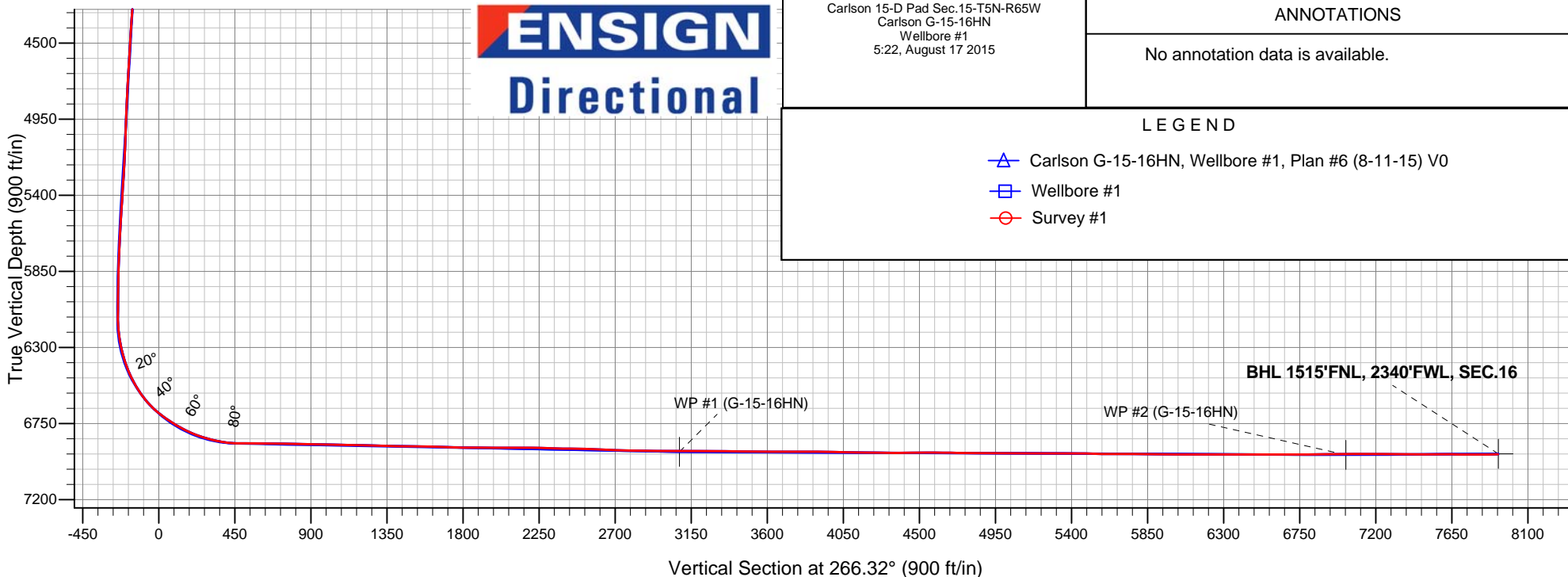
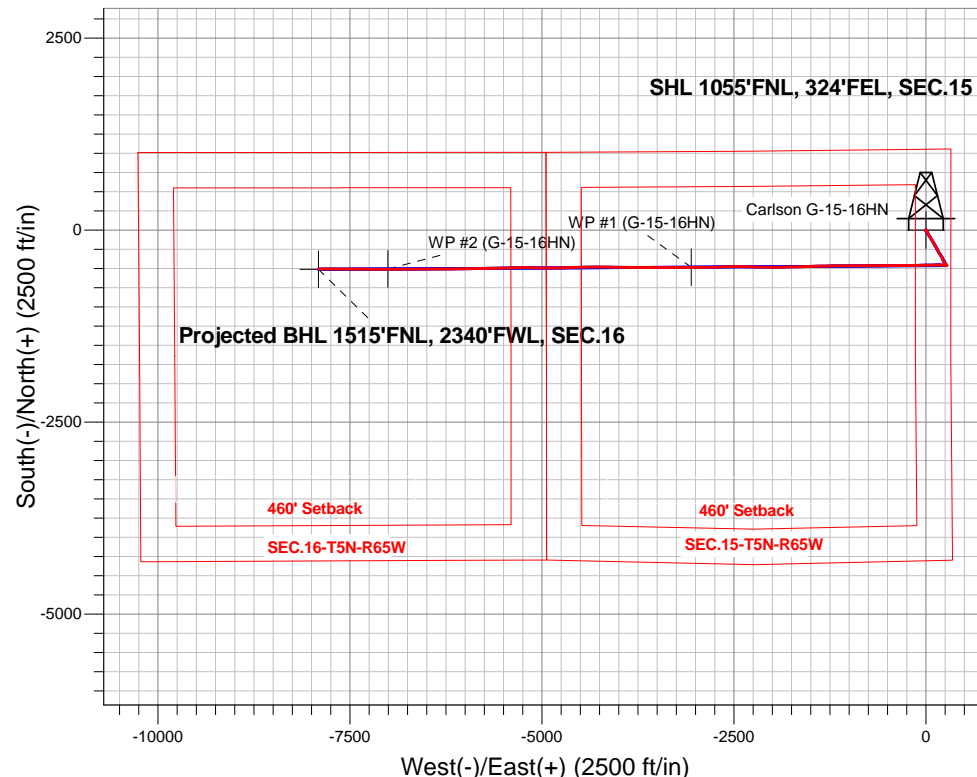



Bayswater Exploration & Production, LLC

SEC.15-T5N-R65W

Carlson 15-D Pad Sec.15-T5N-R65W

Carlson G-15-16HN

Wellbore #1

Survey: Survey #1

Standard Survey Report

17 August, 2015



BAYSWATER
EXPLORATION & PRODUCTION, LLC

Company:	Bayswater Exploration & Production, LLC	Local Co-ordinate Reference:	Well Carlson G-15-16HN
Project:	SEC.15-T5N-R65W	TVD Reference:	WELL @ 4643.5ft (RKB - 22.5')
Site:	Carlson 15-D Pad Sec.15-T5N-R65W	MD Reference:	WELL @ 4643.5ft (RKB - 22.5')
Well:	Carlson G-15-16HN	North Reference:	True
Wellbore:	Wellbore #1	Survey Calculation Method:	Minimum Curvature
Design:	Wellbore #1	Database:	EDMNEW

Project	SEC.15-T5N-R65W, Weld County, Colorado		
Map System:	US State Plane 1983	System Datum:	Mean Sea Level
Geo Datum:	North American Datum 1983		Using Well Reference Point
Map Zone:	Colorado Northern Zone		Using geodetic scale factor

Site	Carlson 15-D Pad Sec.15-T5N-R65W		
Site Position:		Northing:	1,391,065.32 ft
From:	Lat/Long	Easting:	3,239,277.09 ft
Position Uncertainty:	0.0 ft	Slot Radius:	"
		Latitude:	40.403694
		Longitude:	-104.640808
		Grid Convergence:	0.56 °

Well	Carlson G-15-16HN		
Well Position	+N/-S	0.0 ft	Northing:
	+E/-W	0.0 ft	Easting:
Position Uncertainty	0.0 ft	Wellhead Elevation:	ft
		Latitude:	40.403696
		Longitude:	-104.641131
		Ground Level:	4,621.0 ft

Wellbore	Wellbore #1		
Magnetics	Model Name	Sample Date	Declination (°)
	IGRF2010	7/8/2015	8.25
			Dip Angle (°)
			66.93
			Field Strength (nT)
			52,720

Design	Wellbore #1		
Audit Notes:			
Version:	1.0	Phase:	ACTUAL
		Tie On Depth:	0.0
Vertical Section:	Depth From (TVD) (ft)	+N/-S (ft)	+E/-W (ft)
	0.0	0.0	0.0
			Direction (°)
			266.32

Survey Program	Date	8/17/2015		
From (ft)	To (ft)	Survey (Wellbore)	Tool Name	Description
160.0	14,774.0	Survey #1 (Wellbore #1)	MWD	MWD - Standard

Survey										
Measured Depth (ft)	Inclination (°)	Azimuth (°)	Vertical Depth (ft)	+N/-S (ft)	+E/-W (ft)	Vertical Section (ft)	Dogleg Rate (°/100ft)	Build Rate (°/100ft)	Turn Rate (°/100ft)	
0.0	0.00	0.00	0.0	0.0	0.0	0.0	0.00	0.00	0.00	
1.0	0.01	180.20	1.0	0.0	0.0	0.0	0.81	0.81	0.00	
SHL 1055'FNL, 324'FEL, SEC.15										
160.0	1.30	180.20	160.0	-1.8	0.0	0.1	0.81	0.81	0.00	
253.0	1.10	189.80	253.0	-3.7	-0.2	0.4	0.30	-0.22	10.32	
345.0	1.10	185.10	344.9	-5.5	-0.4	0.7	0.10	0.00	-5.11	
437.0	0.60	121.10	436.9	-6.6	-0.1	0.5	1.08	-0.54	-69.57	
529.0	0.60	37.60	528.9	-6.5	0.6	-0.2	0.87	0.00	-90.76	
621.0	1.10	0.90	620.9	-5.2	1.0	-0.6	0.78	0.54	-39.89	
713.0	1.00	8.80	712.9	-3.6	1.1	-0.9	0.19	-0.11	8.59	
795.0	1.10	349.60	794.9	-2.1	1.1	-0.9	0.44	0.12	-23.41	
876.0	0.90	349.40	875.9	-0.7	0.8	-0.8	0.25	-0.25	-0.25	
924.0	0.40	342.60	923.9	-0.2	0.7	-0.7	1.05	-1.04	-14.17	

Company:	Bayswater Exploration & Production, LLC	Local Co-ordinate Reference:	Well Carlson G-15-16HN
Project:	SEC.15-T5N-R65W	TVD Reference:	WELL @ 4643.5ft (RKB - 22.5')
Site:	Carlson 15-D Pad Sec.15-T5N-R65W	MD Reference:	WELL @ 4643.5ft (RKB - 22.5')
Well:	Carlson G-15-16HN	North Reference:	True
Wellbore:	Wellbore #1	Survey Calculation Method:	Minimum Curvature
Design:	Wellbore #1	Database:	EDMNEW

Survey

Measured Depth (ft)	Inclination (°)	Azimuth (°)	Vertical Depth (ft)	+N/-S (ft)	+E/-W (ft)	Vertical Section (ft)	Dogleg Rate (°/100ft)	Build Rate (°/100ft)	Turn Rate (°/100ft)
1,019.0	0.70	355.90	1,018.9	0.7	0.5	-0.6	0.34	0.32	14.00
1,115.0	0.40	4.70	1,114.9	1.7	0.5	-0.6	0.32	-0.31	9.17
1,207.0	0.70	15.60	1,206.9	2.5	0.7	-0.9	0.34	0.33	11.85
1,299.0	0.40	341.70	1,298.9	3.4	0.8	-1.0	0.47	-0.33	-36.85
1,391.0	0.40	9.10	1,390.9	4.0	0.7	-1.0	0.21	0.00	29.78
1,483.0	0.60	160.10	1,482.9	3.9	0.9	-1.2	1.05	0.22	164.13
1,575.0	1.80	168.20	1,574.8	2.0	1.4	-1.5	1.31	1.30	8.80
1,668.0	3.10	157.70	1,667.8	-1.8	2.6	-2.5	1.47	1.40	-11.29
1,760.0	4.10	147.10	1,759.6	-6.8	5.4	-4.9	1.30	1.09	-11.52
1,852.0	5.70	146.80	1,851.2	-13.4	9.7	-8.8	1.74	1.74	-0.33
1,944.0	6.40	146.60	1,942.7	-21.5	15.0	-13.6	0.76	0.76	-0.22
2,036.0	7.10	151.20	2,034.1	-30.8	20.5	-18.5	0.96	0.76	5.00
2,128.0	8.30	150.50	2,125.3	-41.5	26.5	-23.8	1.31	1.30	-0.76
2,220.0	7.90	149.10	2,216.3	-52.8	33.1	-29.6	0.48	-0.43	-1.52
2,312.0	9.00	154.50	2,307.3	-64.7	39.4	-35.2	1.47	1.20	5.87
2,404.0	9.40	150.60	2,398.2	-77.7	46.2	-41.1	0.80	0.43	-4.24
2,496.0	9.00	146.90	2,489.0	-90.3	53.8	-47.9	0.78	-0.43	-4.02
2,592.0	9.10	150.30	2,583.8	-103.2	61.7	-54.9	0.57	0.10	3.54
2,687.0	9.30	144.80	2,677.6	-116.0	69.8	-62.2	0.95	0.21	-5.79
2,782.0	9.30	153.10	2,771.3	-129.1	77.7	-69.3	1.41	0.00	8.74
2,878.0	8.90	148.00	2,866.1	-142.3	85.2	-75.9	0.94	-0.42	-5.31
2,973.0	8.60	149.20	2,960.0	-154.6	92.7	-82.6	0.37	-0.32	1.26
3,068.0	7.90	145.20	3,054.0	-166.1	100.1	-89.2	0.95	-0.74	-4.21
3,163.0	7.10	152.70	3,148.2	-176.7	106.5	-94.9	1.33	-0.84	7.89
3,259.0	7.50	150.80	3,243.4	-187.4	112.3	-100.0	0.49	0.42	-1.98
3,354.0	6.80	148.70	3,337.7	-197.6	118.2	-105.3	0.79	-0.74	-2.21
3,449.0	6.20	150.80	3,432.1	-206.9	123.6	-110.1	0.68	-0.63	2.21
3,544.0	6.90	148.90	3,526.5	-216.3	129.1	-114.9	0.77	0.74	-2.00
3,639.0	6.60	150.50	3,620.8	-225.9	134.7	-119.9	0.37	-0.32	1.68
3,735.0	7.50	154.90	3,716.1	-236.4	140.1	-124.6	1.09	0.94	4.58
3,830.0	8.10	156.10	3,810.2	-248.1	145.4	-129.2	0.65	0.63	1.26
3,925.0	8.20	154.50	3,904.2	-260.4	151.1	-134.0	0.26	0.11	-1.68
4,020.0	7.20	154.00	3,998.4	-271.8	156.6	-138.8	1.05	-1.05	-0.53
4,115.0	7.60	146.80	4,092.6	-282.4	162.6	-144.2	1.06	0.42	-7.58
4,211.0	6.90	147.60	4,187.8	-292.6	169.2	-150.1	0.74	-0.73	0.83
4,306.0	7.60	147.80	4,282.1	-302.8	175.6	-155.8	0.74	0.74	0.21
4,401.0	7.00	146.90	4,376.3	-312.9	182.1	-161.7	0.64	-0.63	-0.95
4,496.0	6.40	144.10	4,470.6	-322.1	188.4	-167.3	0.72	-0.63	-2.95
4,591.0	7.10	146.60	4,565.0	-331.2	194.7	-173.1	0.80	0.74	2.63
4,687.0	7.50	149.40	4,660.2	-341.6	201.2	-178.8	0.56	0.42	2.92
4,782.0	7.40	150.50	4,754.4	-352.3	207.3	-184.3	0.18	-0.11	1.16
4,876.0	6.70	155.60	4,847.7	-362.5	212.6	-188.9	1.00	-0.74	5.43
4,971.0	8.30	159.90	4,941.9	-374.0	217.2	-192.8	1.78	1.68	4.53
5,067.0	7.00	158.40	5,037.0	-386.0	221.8	-196.6	1.37	-1.35	-1.56
5,162.0	6.90	159.20	5,131.3	-396.7	225.9	-200.0	0.15	-0.11	0.84
5,257.0	7.50	153.60	5,225.6	-407.6	230.7	-204.1	0.97	0.63	-5.89
5,352.0	8.60	146.20	5,319.6	-419.0	237.4	-210.1	1.59	1.16	-7.79
5,447.0	6.60	147.80	5,413.8	-429.5	244.3	-216.2	2.12	-2.11	1.68
5,542.0	6.80	142.50	5,508.1	-438.6	250.6	-222.0	0.68	0.21	-5.58
5,637.0	5.10	135.90	5,602.6	-446.1	257.0	-227.8	1.93	-1.79	-6.95
5,733.0	3.70	132.90	5,698.3	-451.3	262.2	-232.7	1.48	-1.46	-3.13
5,828.0	3.10	132.70	5,793.2	-455.1	266.3	-236.6	0.63	-0.63	-0.21
5,923.0	1.00	108.10	5,888.1	-457.1	269.0	-239.1	2.35	-2.21	-25.89
6,018.0	0.70	90.20	5,983.1	-457.4	270.4	-240.5	0.42	-0.32	-18.84

Company:	Bayswater Exploration & Production, LLC	Local Co-ordinate Reference:	Well Carlson G-15-16HN
Project:	SEC.15-T5N-R65W	TVD Reference:	WELL @ 4643.5ft (RKB - 22.5')
Site:	Carlson 15-D Pad Sec.15-T5N-R65W	MD Reference:	WELL @ 4643.5ft (RKB - 22.5')
Well:	Carlson G-15-16HN	North Reference:	True
Wellbore:	Wellbore #1	Survey Calculation Method:	Minimum Curvature
Design:	Wellbore #1	Database:	EDMNEW

Survey

Measured Depth (ft)	Inclination (°)	Azimuth (°)	Vertical Depth (ft)	+N/-S (ft)	+E/-W (ft)	Vertical Section (ft)	Dogleg Rate (°/100ft)	Build Rate (°/100ft)	Turn Rate (°/100ft)
6,113.0	0.60	85.40	6,078.1	-457.3	271.5	-241.6	0.12	-0.11	-5.05
6,161.0	0.30	354.20	6,126.1	-457.2	271.7	-241.8	1.41	-0.63	-190.00
6,209.0	3.70	281.80	6,174.1	-456.8	270.2	-240.3	7.54	7.08	-150.83
6,257.0	7.30	278.10	6,221.8	-456.0	265.6	-235.8	7.53	7.50	-7.71
6,304.0	10.60	274.60	6,268.3	-455.2	258.4	-228.6	7.11	7.02	-7.45
6,352.0	13.40	273.30	6,315.2	-454.6	248.4	-218.7	5.86	5.83	-2.71
6,399.0	15.80	272.80	6,360.7	-453.9	236.6	-207.0	5.11	5.11	-1.06
6,447.0	19.70	271.60	6,406.4	-453.4	222.0	-192.4	8.16	8.13	-2.50
6,494.0	24.00	271.60	6,450.0	-452.9	204.5	-175.0	9.15	9.15	0.00
6,542.0	27.30	270.90	6,493.3	-452.5	183.7	-154.3	6.90	6.88	-1.46
6,590.0	31.30	270.50	6,535.1	-452.2	160.2	-130.9	8.34	8.33	-0.83
6,638.0	33.90	268.90	6,575.6	-452.3	134.4	-105.1	5.71	5.42	-3.33
6,685.0	39.90	268.80	6,613.1	-452.9	106.2	-76.9	12.77	12.77	-0.21
6,733.0	45.50	269.50	6,648.4	-453.4	73.6	-44.4	11.71	11.67	1.46
6,780.0	49.80	269.80	6,680.0	-453.6	38.9	-9.7	9.16	9.15	0.64
6,828.0	53.60	268.20	6,709.8	-454.2	1.3	27.9	8.34	7.92	-3.33
6,875.0	56.60	267.20	6,736.7	-455.8	-37.2	66.4	6.62	6.38	-2.13
6,923.0	59.70	268.20	6,762.0	-457.4	-78.0	107.2	6.70	6.46	2.08
6,970.0	62.60	268.80	6,784.7	-458.5	-119.1	148.3	6.27	6.17	1.28
7,018.0	66.10	269.50	6,805.4	-459.1	-162.4	191.5	7.41	7.29	1.46
7,066.0	70.70	270.00	6,823.1	-459.3	-207.0	236.0	9.63	9.58	1.04
7,114.0	74.30	270.30	6,837.5	-459.2	-252.8	281.7	7.52	7.50	0.63
7,161.0	77.10	270.20	6,849.2	-459.0	-298.3	327.1	5.96	5.96	-0.21
7,209.0	79.90	269.60	6,858.7	-459.1	-345.3	374.1	5.96	5.83	-1.25
7,267.0	85.90	268.60	6,865.9	-460.0	-402.9	431.5	10.49	10.34	-1.72
7,300.7	88.82	268.35	6,867.4	-460.9	-436.5	465.2	8.71	8.68	-0.76
LPL 1520'FNL & 760'FEL, SEC.15									
7,320.0	90.50	268.20	6,867.5	-461.5	-455.8	484.5	8.71	8.68	-0.75
7,414.0	89.00	270.50	6,868.0	-462.5	-549.8	578.3	2.92	-1.60	2.45
7,508.0	89.70	271.00	6,869.0	-461.3	-643.8	672.0	0.92	0.74	0.53
7,603.0	89.20	269.30	6,869.9	-461.1	-738.8	766.8	1.87	-0.53	-1.79
7,697.0	88.50	269.30	6,871.8	-462.2	-832.7	860.7	0.74	-0.74	0.00
7,792.0	89.20	268.80	6,873.7	-463.8	-927.7	955.5	0.91	0.74	-0.53
7,886.0	88.90	269.80	6,875.3	-464.9	-1,021.7	1,049.4	1.11	-0.32	1.06
7,980.0	88.40	270.30	6,877.5	-464.9	-1,115.7	1,143.2	0.75	-0.53	0.53
8,074.0	88.50	270.00	6,880.0	-464.6	-1,209.6	1,236.9	0.34	0.11	-0.32
8,168.0	88.90	269.10	6,882.2	-465.3	-1,303.6	1,330.8	1.05	0.43	-0.96
8,262.0	89.00	268.80	6,883.9	-467.1	-1,397.6	1,424.6	0.34	0.11	-0.32
8,357.0	89.30	267.40	6,885.3	-470.2	-1,492.5	1,519.6	1.51	0.32	-1.47
8,450.0	88.50	269.10	6,887.1	-473.1	-1,585.4	1,612.5	2.02	-0.86	1.83
8,542.0	87.80	268.10	6,890.1	-475.3	-1,677.4	1,704.4	1.33	-0.76	-1.09
8,634.0	89.40	268.40	6,892.3	-478.1	-1,769.3	1,796.3	1.77	1.74	0.33
8,725.0	90.00	268.80	6,892.8	-480.3	-1,860.3	1,887.2	0.79	0.66	0.44
8,816.0	89.70	270.00	6,893.0	-481.3	-1,951.2	1,978.1	1.36	-0.33	1.32
8,908.0	90.40	269.80	6,892.9	-481.5	-2,043.2	2,069.9	0.79	0.76	-0.22
8,999.0	89.50	271.60	6,893.0	-480.3	-2,134.2	2,160.7	2.21	-0.99	1.98
9,091.0	88.50	271.20	6,894.6	-478.1	-2,226.2	2,252.3	1.17	-1.09	-0.43
9,183.0	88.30	270.70	6,897.2	-476.6	-2,318.1	2,343.9	0.59	-0.22	-0.54
9,275.0	89.30	271.20	6,899.1	-475.0	-2,410.1	2,435.6	1.22	1.09	0.54
9,366.0	88.40	269.60	6,901.0	-474.4	-2,501.1	2,526.4	2.02	-0.99	-1.76
9,458.0	87.80	268.90	6,904.0	-475.6	-2,593.0	2,618.2	1.00	-0.65	-0.76
9,549.0	87.90	268.20	6,907.4	-477.9	-2,683.9	2,709.1	0.78	0.11	-0.77
9,641.0	88.60	268.80	6,910.2	-480.3	-2,775.9	2,801.0	1.00	0.76	0.65
9,733.0	89.50	268.80	6,911.8	-482.2	-2,867.8	2,892.9	0.98	0.98	0.00

Company:	Bayswater Exploration & Production, LLC	Local Co-ordinate Reference:	Well Carlson G-15-16HN
Project:	SEC.15-T5N-R65W	TVD Reference:	WELL @ 4643.5ft (RKB - 22.5')
Site:	Carlson 15-D Pad Sec.15-T5N-R65W	MD Reference:	WELL @ 4643.5ft (RKB - 22.5')
Well:	Carlson G-15-16HN	North Reference:	True
Wellbore:	Wellbore #1	Survey Calculation Method:	Minimum Curvature
Design:	Wellbore #1	Database:	EDMNEW

Survey

Measured Depth (ft)	Inclination (°)	Azimuth (°)	Vertical Depth (ft)	+N/-S (ft)	+E/-W (ft)	Vertical Section (ft)	Dogleg Rate (°/100ft)	Build Rate (°/100ft)	Turn Rate (°/100ft)
9,824.0	90.10	269.50	6,912.1	-483.6	-2,958.8	2,983.7	1.01	0.66	0.77
9,916.0	88.80	269.10	6,913.0	-484.7	-3,050.8	3,075.6	1.48	-1.41	-0.43
9,921.0	88.90	269.15	6,913.1	-484.8	-3,055.8	3,080.6	2.19	1.96	0.98
WP #1 (G-15-16HN)									
10,008.0	90.60	270.00	6,913.4	-485.4	-3,142.8	3,167.5	2.19	1.96	0.98
10,100.0	89.60	270.20	6,913.3	-485.3	-3,234.8	3,259.3	1.11	-1.09	0.22
10,191.0	89.40	270.00	6,914.1	-485.1	-3,325.8	3,350.1	0.31	-0.22	-0.22
10,282.0	89.40	269.60	6,915.0	-485.4	-3,416.8	3,440.9	0.44	0.00	-0.44
10,374.0	89.30	269.30	6,916.1	-486.3	-3,508.8	3,532.7	0.34	-0.11	-0.33
10,466.0	89.60	270.50	6,917.0	-486.5	-3,600.8	3,624.6	1.34	0.33	1.30
10,558.0	90.10	270.20	6,917.2	-485.9	-3,692.8	3,716.3	0.63	0.54	-0.33
10,650.0	90.20	270.70	6,917.0	-485.2	-3,784.8	3,808.1	0.55	0.11	0.54
10,741.0	89.80	271.00	6,917.0	-483.8	-3,875.7	3,898.8	0.55	-0.44	0.33
10,833.0	88.30	270.70	6,918.5	-482.5	-3,967.7	3,990.5	1.66	-1.63	-0.33
10,924.0	88.80	270.70	6,920.8	-481.4	-4,058.7	4,081.2	0.55	0.55	0.00
11,016.0	89.60	271.20	6,922.1	-479.8	-4,150.7	4,172.9	1.03	0.87	0.54
11,108.0	89.20	269.50	6,923.0	-479.3	-4,242.7	4,264.7	1.90	-0.43	-1.85
11,199.0	90.10	268.90	6,923.6	-480.6	-4,333.6	4,355.5	1.19	0.99	-0.66
11,294.0	90.60	268.80	6,923.0	-482.5	-4,428.6	4,450.4	0.54	0.53	-0.11
11,388.0	90.40	269.60	6,922.2	-483.8	-4,522.6	4,544.3	0.88	-0.21	0.85
11,482.0	88.90	269.50	6,922.8	-484.5	-4,616.6	4,638.2	1.60	-1.60	-0.11
11,576.0	90.00	268.80	6,923.7	-485.9	-4,710.6	4,732.0	1.39	1.17	-0.74
11,671.0	89.10	267.50	6,924.4	-489.0	-4,805.5	4,827.0	1.66	-0.95	-1.37
11,765.0	90.10	268.10	6,925.1	-492.6	-4,899.5	4,921.0	1.24	1.06	0.64
11,859.0	89.40	270.90	6,925.5	-493.4	-4,993.4	5,014.8	3.07	-0.74	2.98
11,953.0	89.50	272.60	6,926.4	-490.5	-5,087.4	5,108.4	1.81	0.11	1.81
12,048.0	89.60	270.90	6,927.1	-487.6	-5,182.3	5,202.9	1.79	0.11	-1.79
12,142.0	90.70	268.90	6,926.9	-487.8	-5,276.3	5,296.8	2.43	1.17	-2.13
12,236.0	90.00	268.40	6,926.3	-490.0	-5,370.3	5,390.7	0.92	-0.74	-0.53
12,330.0	88.30	268.20	6,927.7	-492.8	-5,464.2	5,484.6	1.82	-1.81	-0.21
12,424.0	88.80	269.50	6,930.1	-494.7	-5,558.2	5,578.5	1.48	0.53	1.38
12,519.0	90.70	269.60	6,930.5	-495.4	-5,653.2	5,673.3	2.00	2.00	0.11
12,613.0	89.30	270.20	6,930.5	-495.6	-5,747.2	5,767.1	1.62	-1.49	0.64
12,707.0	89.70	268.90	6,931.3	-496.3	-5,841.2	5,861.0	1.45	0.43	-1.38
12,801.0	89.40	267.90	6,932.0	-499.0	-5,935.1	5,954.9	1.11	-0.32	-1.06
12,896.0	89.60	268.80	6,932.9	-501.7	-6,030.1	6,049.9	0.97	0.21	0.95
12,990.0	90.00	269.10	6,933.2	-503.4	-6,124.1	6,143.8	0.53	0.43	0.32
13,084.0	90.40	270.20	6,932.9	-504.0	-6,218.1	6,237.6	1.25	0.43	1.17
13,178.0	89.90	269.50	6,932.6	-504.2	-6,312.1	6,331.4	0.92	-0.53	-0.74
13,272.0	90.00	268.60	6,932.7	-505.8	-6,406.1	6,425.3	0.96	0.11	-0.96
13,366.0	90.00	268.80	6,932.7	-507.9	-6,500.0	6,519.2	0.21	0.00	0.21
13,460.0	90.00	268.80	6,932.7	-509.9	-6,594.0	6,613.1	0.00	0.00	0.00
13,554.0	90.00	269.30	6,932.7	-511.5	-6,688.0	6,707.0	0.53	0.00	0.53
13,648.0	90.00	271.90	6,932.7	-510.5	-6,782.0	6,800.8	2.77	0.00	2.77
13,742.0	90.80	270.70	6,932.1	-508.3	-6,876.0	6,894.4	1.53	0.85	-1.28
13,836.0	90.40	271.40	6,931.1	-506.6	-6,969.9	6,988.1	0.86	-0.43	0.74
13,871.8	90.21	270.99	6,930.9	-505.9	-7,005.7	7,023.7	1.27	-0.53	-1.16
WP #2 (G-15-16HN)									
13,931.0	89.90	270.30	6,930.8	-505.2	-7,064.9	7,082.8	1.27	-0.53	-1.16
14,025.0	90.70	269.80	6,930.3	-505.1	-7,158.9	7,176.6	1.00	0.85	-0.53
14,119.0	89.80	270.30	6,929.9	-505.0	-7,252.9	7,270.4	1.10	-0.96	0.53
14,213.0	88.80	270.90	6,931.1	-504.1	-7,346.9	7,364.1	1.24	-1.06	0.64
14,308.0	89.30	270.20	6,932.6	-503.1	-7,441.9	7,458.8	0.91	0.53	-0.74
14,402.0	91.40	269.80	6,932.1	-503.1	-7,535.9	7,552.6	2.27	2.23	-0.43

Company:	Bayswater Exploration & Production, LLC	Local Co-ordinate Reference:	Well Carlson G-15-16HN
Project:	SEC.15-T5N-R65W	TVD Reference:	WELL @ 4643.5ft (RKB - 22.5')
Site:	Carlson 15-D Pad Sec.15-T5N-R65W	MD Reference:	WELL @ 4643.5ft (RKB - 22.5')
Well:	Carlson G-15-16HN	North Reference:	True
Wellbore:	Wellbore #1	Survey Calculation Method:	Minimum Curvature
Design:	Wellbore #1	Database:	EDMNEW

Survey

Measured Depth (ft)	Inclination (°)	Azimuth (°)	Vertical Depth (ft)	+N/-S (ft)	+E/-W (ft)	Vertical Section (ft)	Dogleg Rate (°/100ft)	Build Rate (°/100ft)	Turn Rate (°/100ft)
14,496.0	88.50	269.80	6,932.2	-503.5	-7,629.9	7,646.4	3.09	-3.09	0.00
14,590.0	90.00	270.20	6,933.4	-503.5	-7,723.9	7,740.2	1.65	1.60	0.43
14,684.0	90.50	270.00	6,933.0	-503.3	-7,817.9	7,834.0	0.57	0.53	-0.21
14,719.0	90.80	269.80	6,932.6	-503.4	-7,852.8	7,869.0	1.03	0.86	-0.57
14,774.0	90.80	269.80	6,931.8	-503.6	-7,907.8	7,923.9	0.00	0.00	0.00
BHL 1520'FNL, 2339'FWL, SEC.16									

Design Targets

Target Name - hit/miss target - Shape	Dip Angle (°)	Dip Dir. (°)	TVD (ft)	+N/-S (ft)	+E/-W (ft)	Northing (ft)	Easting (ft)	Latitude	Longitude
SHL 1055'FNL, 324'FI - survey hits target center - Point	0.00	0.00	1.0	0.0	0.0	1,391,065.18	3,239,187.13	40.403696	-104.641131
WP #1 (G-15-16HN) - survey misses target center by 5.8ft at 9921.0ft MD (6913.1 TVD, -484.8 N, -3055.8 E) - Point	0.00	0.00	6,917.5	-481.1	-3,055.8	1,390,554.51	3,236,136.26	40.402375	-104.652103
BHL 1520'FNL, 2339'I - survey misses target center by 5.5ft at 14774.0ft MD (6931.8 TVD, -503.6 N, -7907.8 E) - Point	0.00	0.00	6,929.5	-508.4	-7,909.2	1,390,480.22	3,231,283.56	40.402297	-104.669529
WP #2 (G-15-16HN) - survey misses target center by 5.3ft at 13871.8ft MD (6930.9 TVD, -505.9 N, -7005.7 E) - Point	0.00	0.00	6,935.5	-503.3	-7,005.7	1,390,494.06	3,232,186.93	40.402312	-104.666285

Checked By: _____ Approved By: _____ Date: _____