



Project: Weld County, CO NAD 83
Site: Anschutz State 5-62-22_23 SWNW Pad
Well: Anschutz State 5-62-22-3225B2
Wellbore: OH
Design: Plan 2



T M
Azimuths to True North
Magnetic North: 8.28°

Magnetic Field
Strength: 52655.0snT
Dip Angle: 67.03°
Date: 9/16/2015
Model: BGGM2015

WELL DETAILS: Anschutz State 5-62-22-3225B2

PROJECT DETAILS: Weld County, CO NAD 83

Geodetic System: US State Plane 1983
Datum: North American Datum 1983
Ellipsoid: GRS 1980
Zone: Colorado Northern Zone

System Datum: Mean Sea Level
Local North: True

GL 4719' & KB 16' @ 4735.00ft (Cade 24) 4719.00
Northing Easting Latitude Longitude
1386010.22 3329201.75 40° 23' 13.120 N 104° 19' 5.459 W

Plan: Plan 2 (Anschutz State 5-62-22-3225B2/OH)
Created By: Seth Burstad Date: 7-26-15

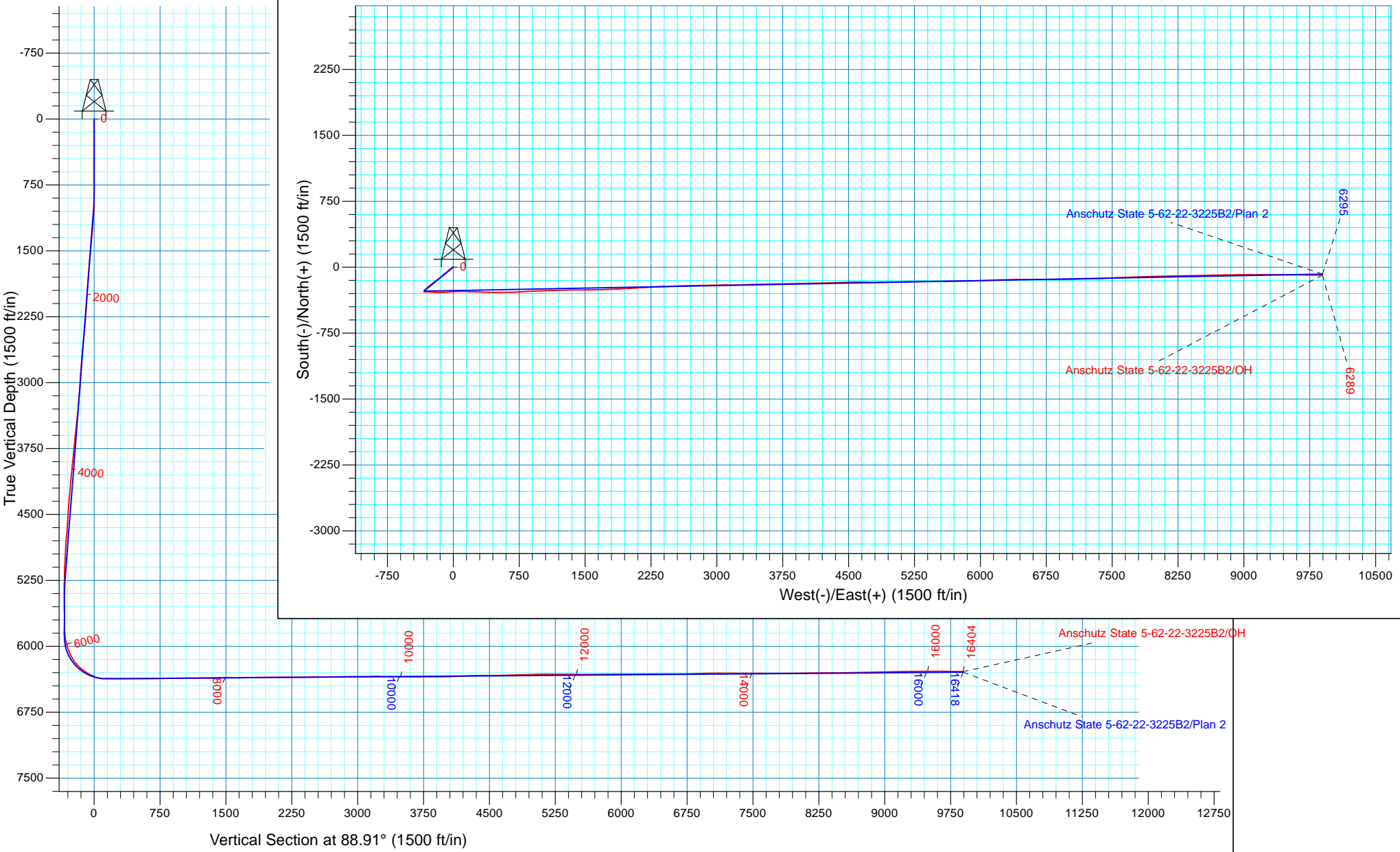



Bill Barrett Corporation

Bill Barrett Corp.

Weld County, CO NAD 83

Anschutz State 5-62-22_23 SWNW Pad

Anschutz State 5-62-22-3225B2

OH

Design: OH

Standard Survey Report

19 October, 2015



Scientific Drilling

www.scientificdrilling.com



Company:	Bill Barrett Corp.	Local Co-ordinate Reference:	Well Anschutz State 5-62-22-3225B2
Project:	Weld County, CO NAD 83	TVD Reference:	GL 4719' & KB 16' @ 4735.00ft (Cade 24)
Site:	Anschutz State 5-62-22_23 SWNW Pad	MD Reference:	GL 4719' & KB 16' @ 4735.00ft (Cade 24)
Well:	Anschutz State 5-62-22-3225B2	North Reference:	True
Wellbore:	OH	Survey Calculation Method:	Minimum Curvature
Design:	OH	Database:	Casper District

Project	Weld County, CO NAD 83		
Map System:	US State Plane 1983	System Datum:	Mean Sea Level
Geo Datum:	North American Datum 1983		
Map Zone:	Colorado Northern Zone		

Site		Anschutz State 5-62-22_23 SWNW Pad			
Site Position:		Northing:	1,386,054.73 usft	Latitude:	40° 23' 13.560 N
From:	Lat/Long	Easting:	3,329,201.72 usft	Longitude:	104° 19' 5.452 W
Position Uncertainty:	0.00 ft	Slot Radius:	13.200 in	Grid Convergence:	0.76 °

Well	Anschutz State 5-62-22-3225B2, 2045' FNL 350' FWL Sec 22 T5N R62W					
Well Position	+N/-S	0.00 ft	Northing:	1,386,010.23 usft	Latitude:	40° 23' 13.120 N
	+E/-W	0.00 ft	Easting:	3,329,201.76 usft	Longitude:	104° 19' 5.459 W
Position Uncertainty		0.00 ft	Wellhead Elevation:	0.00 ft	Ground Level:	4,719.00 ft

Wellbore	OH				
Magnetics	Model Name	Sample Date	Declination (°)	Dip Angle (°)	Field Strength (nT)
	BGGM2015	9/16/2015	8.28	67.03	52,655

Design	OH				
Audit Notes:					
Version:	1.0	Phase:	ACTUAL	Tie On Depth:	0.00
Vertical Section:	Depth From (TVD) (ft)	+N/-S (ft)	+E/-W (ft)	Direction (°)	
	0.00	0.00	0.00	88.91	

Survey Program	Date	10/19/2015			
From (ft)	To (ft)	Survey (Wellbore)	Tool Name	Description	
800.00	6,620.00	Survey #1 - Vertical / Curve (OH)	SDI MWD	SDI MWD - Standard ver 1.0.1	
6,694.00	16,404.00	Survey #2 - Lateral (OH)	SDI MWD	SDI MWD - Standard ver 1.0.1	

Survey										
Measured Depth (ft)	Inclination (°)	Azimuth (°)	Vertical Depth (ft)	+N/-S (ft)	+E/-W (ft)	Vertical Section (ft)	Dogleg Rate (°/100ft)	Build Rate (°/100ft)	Turn Rate (°/100ft)	
0.00	0.00	0.00	0.00	0.00	0.00	0.00	0.00	0.00	0.00	
800.00	0.00	0.00	800.00	0.00	0.00	0.00	0.00	0.00	0.00	
Casing Assumed Vertical										
886.00	0.80	18.01	886.00	0.57	0.19	0.20	0.93	0.93	0.00	
First SDI MWD Survey										
978.00	1.20	279.56	977.99	1.34	-0.57	-0.54	1.67	0.43	-107.01	
1,070.00	3.39	252.27	1,069.91	0.67	-4.11	-4.09	2.60	2.38	-29.66	
1,161.00	5.32	245.41	1,160.64	-1.90	-10.51	-10.54	2.19	2.12	-7.54	
1,253.00	6.30	230.94	1,252.18	-6.86	-18.31	-18.43	1.91	1.07	-15.73	

Company:	Bill Barrett Corp.	Local Co-ordinate Reference:	Well Anschutz State 5-62-22-3225B2
Project:	Weld County, CO NAD 83	TVD Reference:	GL 4719' & KB 16' @ 4735.00ft (Cade 24)
Site:	Anschutz State 5-62-22_23 SWNW Pad	MD Reference:	GL 4719' & KB 16' @ 4735.00ft (Cade 24)
Well:	Anschutz State 5-62-22-3225B2	North Reference:	True
Wellbore:	OH	Survey Calculation Method:	Minimum Curvature
Design:	OH	Database:	Casper District

Survey									
Measured Depth (ft)	Inclination (°)	Azimuth (°)	Vertical Depth (ft)	+N/-S (ft)	+E/-W (ft)	Vertical Section (ft)	Dogleg Rate (°/100ft)	Build Rate (°/100ft)	Turn Rate (°/100ft)
1,344.00	6.98	231.08	1,342.56	-13.48	-26.48	-26.74	0.75	0.75	0.15
1,436.00	6.70	228.90	1,433.91	-20.52	-34.88	-35.26	0.42	-0.30	-2.37
1,527.00	7.13	223.92	1,524.25	-28.08	-42.80	-43.32	0.81	0.47	-5.47
1,619.00	6.81	229.32	1,615.57	-35.74	-50.89	-51.56	0.79	-0.35	5.87
1,711.00	5.49	229.70	1,707.04	-42.15	-58.39	-59.18	1.44	-1.43	0.41
1,803.00	4.96	226.51	1,798.66	-47.73	-64.63	-65.52	0.66	-0.58	-3.47
1,894.00	6.09	234.21	1,889.23	-53.26	-71.40	-72.40	1.48	1.24	8.46
1,986.00	5.38	229.28	1,980.77	-58.93	-78.63	-79.73	0.94	-0.77	-5.36
2,077.00	3.90	221.97	2,071.47	-64.01	-83.93	-85.13	1.75	-1.63	-8.03
2,169.00	5.05	230.00	2,163.19	-68.94	-89.12	-90.42	1.42	1.25	8.73
2,260.00	5.31	235.66	2,253.82	-73.89	-95.67	-97.06	0.63	0.29	6.22
2,352.00	6.17	244.17	2,345.36	-78.45	-103.63	-105.11	1.31	0.93	9.25
2,446.00	7.31	231.52	2,438.71	-84.37	-112.86	-114.45	1.98	1.21	-13.46
2,541.00	6.68	231.37	2,533.01	-91.58	-121.91	-123.63	0.66	-0.66	-0.16
2,636.00	6.37	225.87	2,627.39	-98.70	-130.01	-131.86	0.73	-0.33	-5.79
2,730.00	6.18	226.96	2,720.83	-105.78	-137.45	-139.44	0.24	-0.20	1.16
2,825.00	5.79	227.92	2,815.31	-112.48	-144.74	-146.86	0.42	-0.41	1.01
2,919.00	5.69	221.66	2,908.84	-119.14	-151.36	-153.60	0.67	-0.11	-6.66
3,014.00	4.53	223.34	3,003.46	-125.39	-157.07	-159.42	1.23	-1.22	1.77
3,108.00	5.20	239.67	3,097.13	-130.24	-163.29	-165.74	1.63	0.71	17.37
3,202.00	6.53	232.59	3,190.63	-135.64	-171.21	-173.76	1.61	1.41	-7.53
3,297.00	5.75	235.23	3,285.09	-141.64	-179.41	-182.08	0.87	-0.82	2.78
3,392.00	6.49	235.18	3,379.55	-147.42	-187.73	-190.50	0.78	0.78	-0.05
3,486.00	6.78	232.99	3,472.92	-153.79	-196.52	-199.41	0.41	0.31	-2.33
3,581.00	7.68	232.11	3,567.16	-161.06	-206.01	-209.04	0.95	0.95	-0.93
3,675.00	8.19	233.41	3,660.26	-168.91	-216.34	-219.52	0.58	0.54	1.38
3,769.00	8.42	237.27	3,753.27	-176.62	-227.51	-230.83	0.64	0.24	4.11
3,864.00	7.53	230.78	3,847.36	-184.32	-238.18	-241.65	1.33	-0.94	-6.83
3,959.00	6.81	230.62	3,941.61	-191.83	-247.36	-250.96	0.76	-0.76	-0.17
4,054.00	6.11	228.12	4,036.01	-198.78	-255.48	-259.21	0.79	-0.74	-2.63
4,148.00	5.43	232.13	4,129.53	-204.85	-262.71	-266.56	0.84	-0.72	4.27
4,242.00	5.60	230.54	4,223.10	-210.49	-269.76	-273.72	0.24	0.18	-1.69
4,337.00	5.54	234.24	4,317.65	-216.12	-277.06	-281.13	0.38	-0.06	3.89
4,432.00	6.42	231.99	4,412.13	-222.07	-284.97	-289.14	0.96	0.93	-2.37
4,526.00	5.24	229.30	4,505.64	-228.11	-292.37	-296.65	1.29	-1.26	-2.86
4,620.00	4.93	225.85	4,599.27	-233.72	-298.52	-302.91	0.46	-0.33	-3.67
4,714.00	6.41	230.12	4,692.81	-239.90	-305.44	-309.95	1.64	1.57	4.54
4,809.00	5.66	226.74	4,787.29	-246.51	-312.92	-317.56	0.87	-0.79	-3.56
4,905.00	5.35	224.99	4,882.84	-252.92	-319.54	-324.29	0.37	-0.32	-1.82
4,999.00	4.37	216.46	4,976.50	-258.90	-324.76	-329.63	1.29	-1.04	-9.07
5,094.00	3.46	220.80	5,071.28	-263.98	-328.79	-333.75	1.01	-0.96	4.57
5,188.00	3.07	217.40	5,165.13	-268.12	-332.17	-337.21	0.46	-0.41	-3.62
5,283.00	2.85	198.90	5,260.01	-272.38	-334.48	-339.60	1.03	-0.23	-19.47

Company:	Bill Barrett Corp.	Local Co-ordinate Reference:	Well Anschutz State 5-62-22-3225B2
Project:	Weld County, CO NAD 83	TVD Reference:	GL 4719' & KB 16' @ 4735.00ft (Cade 24)
Site:	Anschutz State 5-62-22_23 SWNW Pad	MD Reference:	GL 4719' & KB 16' @ 4735.00ft (Cade 24)
Well:	Anschutz State 5-62-22-3225B2	North Reference:	True
Wellbore:	OH	Survey Calculation Method:	Minimum Curvature
Design:	OH	Database:	Casper District

Survey									
Measured Depth (ft)	Inclination (°)	Azimuth (°)	Vertical Depth (ft)	+N/-S (ft)	+E/-W (ft)	Vertical Section (ft)	Dogleg Rate (°/100ft)	Build Rate (°/100ft)	Turn Rate (°/100ft)
5,377.00	0.61	172.69	5,353.96	-275.09	-335.17	-340.35	2.47	-2.38	-27.88
5,472.00	0.51	157.00	5,448.95	-275.98	-334.94	-340.13	0.19	-0.11	-16.52
5,567.00	0.77	145.74	5,543.95	-276.90	-334.42	-339.63	0.30	0.27	-11.85
5,660.00	0.83	116.13	5,636.94	-277.71	-333.46	-338.68	0.44	0.06	-31.84
5,755.00	1.11	120.39	5,731.92	-278.48	-332.05	-337.29	0.30	0.29	4.48
5,849.00	1.54	139.84	5,825.90	-279.90	-330.45	-335.72	0.66	0.46	20.69
5,944.00	9.91	94.42	5,920.36	-281.51	-321.46	-326.76	9.36	8.81	-47.81
6,039.00	18.49	91.65	6,012.38	-282.58	-298.21	-303.53	9.06	9.03	-2.92
6,133.00	24.33	91.15	6,099.85	-283.40	-263.92	-269.26	6.22	6.21	-0.53
6,227.00	37.52	92.67	6,180.31	-285.13	-215.75	-221.14	14.06	14.03	1.62
6,321.00	49.22	91.95	6,248.52	-287.68	-151.36	-156.81	12.46	12.45	-0.77
6,416.00	58.24	84.00	6,304.73	-284.67	-75.01	-80.42	11.64	9.49	-8.37
6,511.00	69.34	86.20	6,346.62	-277.48	9.77	4.49	11.87	11.68	2.32
6,605.00	84.78	91.50	6,367.62	-275.78	101.06	95.79	17.31	16.43	5.64
6,620.00	87.45	92.19	6,368.64	-276.26	116.01	110.74	18.38	17.80	4.60
Last SDI MWD Curve Survey									
6,694.00	91.01	91.42	6,369.63	-278.59	189.96	184.62	4.92	4.81	-1.04
First SDI MWD Lateral Survey									
6,789.00	91.01	92.23	6,367.96	-281.62	284.90	279.49	0.85	0.00	0.85
6,883.00	90.57	92.16	6,366.66	-285.22	378.82	373.32	0.47	-0.47	-0.07
6,978.00	89.73	88.54	6,366.41	-285.80	473.80	468.28	3.91	-0.88	-3.81
7,072.00	90.07	90.25	6,366.58	-284.81	567.79	562.27	1.85	0.36	1.82
7,166.00	90.27	89.07	6,366.30	-284.25	661.79	656.26	1.27	0.21	-1.26
7,260.00	90.64	87.27	6,365.55	-281.25	755.73	750.24	1.95	0.39	-1.91
7,355.00	90.60	86.72	6,364.52	-276.27	850.59	845.18	0.58	-0.04	-0.58
7,449.00	90.87	88.07	6,363.32	-271.99	944.49	939.14	1.46	0.29	1.44
7,544.00	89.66	87.08	6,362.88	-267.97	1,039.40	1,034.11	1.65	-1.27	-1.04
7,638.00	90.27	88.36	6,362.94	-264.24	1,133.32	1,128.09	1.51	0.65	1.36
7,732.00	90.60	88.64	6,362.22	-261.77	1,227.29	1,222.08	0.46	0.35	0.30
7,827.00	90.91	88.96	6,360.97	-259.79	1,322.26	1,317.08	0.47	0.33	0.34
7,921.00	90.47	89.73	6,359.84	-258.71	1,416.24	1,411.06	0.94	-0.47	0.82
8,016.00	90.64	90.52	6,358.92	-258.92	1,511.24	1,506.04	0.85	0.18	0.83
8,111.00	91.51	88.99	6,357.14	-258.51	1,606.22	1,601.01	1.85	0.92	-1.61
8,206.00	91.04	87.47	6,355.02	-255.58	1,701.14	1,695.97	1.67	-0.49	-1.60
8,301.00	90.34	87.23	6,353.88	-251.19	1,796.03	1,790.93	0.78	-0.74	-0.25
8,394.00	90.47	87.69	6,353.22	-247.07	1,888.94	1,883.90	0.51	0.14	0.49
8,489.00	89.77	87.00	6,353.02	-242.66	1,983.84	1,978.86	1.03	-0.74	-0.73
8,583.00	88.89	86.74	6,354.12	-237.53	2,077.69	2,072.80	0.98	-0.94	-0.28
8,678.00	91.44	87.45	6,353.85	-232.72	2,172.56	2,167.74	2.79	2.68	0.75
8,772.00	90.00	86.87	6,352.67	-228.06	2,266.43	2,261.68	1.65	-1.53	-0.62
8,866.00	91.24	87.57	6,351.65	-223.50	2,360.31	2,355.64	1.51	1.32	0.74
8,960.00	90.27	85.84	6,350.41	-218.10	2,454.15	2,449.55	2.11	-1.03	-1.84
9,055.00	90.23	87.70	6,350.00	-212.75	2,548.99	2,544.48	1.96	-0.04	1.96
9,150.00	90.57	90.16	6,349.33	-210.97	2,643.96	2,639.47	2.61	0.36	2.59

Company:	Bill Barrett Corp.	Local Co-ordinate Reference:	Well Anschutz State 5-62-22-3225B2
Project:	Weld County, CO NAD 83	TVD Reference:	GL 4719' & KB 16' @ 4735.00ft (Cade 24)
Site:	Anschutz State 5-62-22_23 SWNW Pad	MD Reference:	GL 4719' & KB 16' @ 4735.00ft (Cade 24)
Well:	Anschutz State 5-62-22-3225B2	North Reference:	True
Wellbore:	OH	Survey Calculation Method:	Minimum Curvature
Design:	OH	Database:	Casper District

Survey										
Measured Depth (ft)	Inclination (°)	Azimuth (°)	Vertical Depth (ft)	+N/-S (ft)	+E/-W (ft)	Vertical Section (ft)	Dogleg Rate (°/100ft)	Build Rate (°/100ft)	Turn Rate (°/100ft)	
9,244.00	90.84	89.16	6,348.18	-210.42	2,737.95	2,733.46	1.10	0.29	-1.06	
9,339.00	90.77	88.90	6,346.84	-208.81	2,832.93	2,828.45	0.28	-0.07	-0.27	
9,433.00	91.01	87.84	6,345.38	-206.13	2,926.88	2,922.43	1.16	0.26	-1.13	
9,528.00	90.07	89.38	6,344.49	-203.83	3,021.84	3,017.42	1.90	-0.99	1.62	
9,623.00	91.62	89.78	6,343.09	-203.13	3,116.83	3,112.40	1.69	1.63	0.42	
9,717.00	89.13	88.97	6,342.47	-202.11	3,210.81	3,206.39	2.79	-2.65	-0.86	
9,812.00	88.79	87.94	6,344.19	-199.55	3,305.76	3,301.37	1.14	-0.36	-1.08	
9,907.00	88.69	88.68	6,346.28	-196.75	3,400.70	3,396.34	0.79	-0.11	0.78	
10,001.00	89.80	88.86	6,347.52	-194.73	3,494.66	3,490.33	1.20	1.18	0.19	
10,095.00	89.36	88.69	6,348.21	-192.72	3,588.64	3,584.32	0.50	-0.47	-0.18	
10,190.00	90.24	88.65	6,348.54	-190.51	3,683.61	3,679.32	0.93	0.93	-0.04	
10,284.00	90.54	88.58	6,347.90	-188.24	3,777.58	3,773.32	0.33	0.32	-0.07	
10,379.00	89.97	89.40	6,347.48	-186.57	3,872.57	3,868.32	1.05	-0.60	0.86	
10,471.00	90.57	89.63	6,347.05	-185.79	3,964.56	3,960.31	0.70	0.65	0.25	
10,562.00	92.05	89.08	6,344.97	-184.77	4,055.53	4,051.28	1.73	1.63	-0.60	
10,653.00	92.32	89.02	6,341.50	-183.26	4,146.45	4,142.21	0.30	0.30	-0.07	
10,745.00	92.90	88.68	6,337.31	-181.41	4,238.34	4,234.12	0.73	0.63	-0.37	
10,837.00	91.14	87.13	6,334.06	-178.05	4,330.21	4,326.04	2.55	-1.91	-1.68	
10,929.00	89.90	87.97	6,333.23	-174.12	4,422.12	4,418.01	1.63	-1.35	0.91	
11,020.00	90.07	88.13	6,333.25	-171.02	4,513.07	4,509.00	0.26	0.19	0.18	
11,111.00	91.51	90.50	6,332.00	-169.94	4,604.04	4,599.98	3.05	1.58	2.60	
11,203.00	91.92	90.80	6,329.25	-170.98	4,696.00	4,691.89	0.55	0.45	0.33	
11,295.00	92.08	90.17	6,326.03	-171.76	4,787.94	4,783.80	0.71	0.17	-0.68	
11,386.00	91.14	89.61	6,323.48	-171.58	4,878.90	4,874.75	1.20	-1.03	-0.62	
11,478.00	91.21	88.92	6,321.59	-170.40	4,970.87	4,966.73	0.75	0.08	-0.75	
11,569.00	91.68	88.83	6,319.30	-168.62	5,061.82	5,057.70	0.53	0.52	-0.10	
11,661.00	89.80	89.20	6,318.11	-167.03	5,153.80	5,149.69	2.08	-2.04	0.40	
11,753.00	89.09	87.89	6,319.00	-164.70	5,245.76	5,241.68	1.62	-0.77	-1.42	
11,844.00	89.87	89.65	6,319.83	-162.75	5,336.73	5,332.67	2.12	0.86	1.93	
11,936.00	90.03	89.79	6,319.91	-162.30	5,428.73	5,424.66	0.23	0.17	0.15	
12,028.00	89.06	89.32	6,320.64	-161.58	5,520.73	5,516.65	1.17	-1.05	-0.51	
12,119.00	90.40	89.23	6,321.07	-160.43	5,611.71	5,607.65	1.48	1.47	-0.10	
12,211.00	90.80	89.93	6,320.10	-159.76	5,703.71	5,699.64	0.88	0.43	0.76	
12,302.00	90.37	89.78	6,319.17	-159.53	5,794.70	5,790.62	0.50	-0.47	-0.16	
12,394.00	90.70	88.42	6,318.31	-158.08	5,886.68	5,882.61	1.52	0.36	-1.48	
12,485.00	90.37	88.29	6,317.46	-155.47	5,977.64	5,973.60	0.39	-0.36	-0.14	
12,577.00	90.44	87.47	6,316.81	-152.07	6,069.58	6,065.59	0.89	0.08	-0.89	
12,668.00	90.64	86.14	6,315.96	-146.99	6,160.43	6,156.52	1.48	0.22	-1.46	
12,759.00	90.30	88.32	6,315.21	-142.60	6,251.31	6,247.47	2.42	-0.37	2.40	
12,851.00	89.66	89.99	6,315.24	-141.24	6,343.30	6,339.47	1.94	-0.70	1.82	
12,943.00	89.46	90.01	6,315.95	-141.24	6,435.30	6,431.45	0.22	-0.22	0.02	
13,035.00	90.17	89.65	6,316.24	-140.97	6,527.30	6,523.43	0.87	0.77	-0.39	
13,126.00	90.47	89.44	6,315.74	-140.24	6,618.29	6,614.43	0.40	0.33	-0.23	

Company:	Bill Barrett Corp.	Local Co-ordinate Reference:	Well Anschutz State 5-62-22-3225B2
Project:	Weld County, CO NAD 83	TVD Reference:	GL 4719' & KB 16' @ 4735.00ft (Cade 24)
Site:	Anschutz State 5-62-22_23 SWNW Pad	MD Reference:	GL 4719' & KB 16' @ 4735.00ft (Cade 24)
Well:	Anschutz State 5-62-22-3225B2	North Reference:	True
Wellbore:	OH	Survey Calculation Method:	Minimum Curvature
Design:	OH	Database:	Casper District

Survey									
Measured Depth (ft)	Inclination (°)	Azimuth (°)	Vertical Depth (ft)	+N/-S (ft)	+E/-W (ft)	Vertical Section (ft)	Dogleg Rate (°/100ft)	Build Rate (°/100ft)	Turn Rate (°/100ft)
13,218.00	90.07	88.86	6,315.30	-138.88	6,710.28	6,706.42	0.77	-0.43	-0.63
13,310.00	92.24	89.99	6,313.45	-137.96	6,802.25	6,798.39	2.66	2.36	1.23
13,401.00	91.81	89.56	6,310.23	-137.60	6,893.19	6,889.33	0.67	-0.47	-0.47
13,493.00	91.28	89.61	6,307.75	-136.93	6,985.15	6,981.29	0.58	-0.58	0.05
13,585.00	90.64	88.82	6,306.21	-135.67	7,077.13	7,073.27	1.11	-0.70	-0.86
13,676.00	89.36	88.51	6,306.21	-133.55	7,168.11	7,164.27	1.45	-1.41	-0.34
13,768.00	89.19	88.47	6,307.38	-131.13	7,260.07	7,256.26	0.19	-0.18	-0.04
13,860.00	90.17	88.00	6,307.89	-128.29	7,352.02	7,348.25	1.18	1.07	-0.51
13,952.00	90.47	88.24	6,307.38	-125.28	7,443.97	7,440.24	0.42	0.33	0.26
14,043.00	89.93	87.25	6,307.06	-121.70	7,534.90	7,531.22	1.24	-0.59	-1.09
14,135.00	90.20	87.92	6,306.95	-117.82	7,626.81	7,623.19	0.79	0.29	0.73
14,227.00	89.03	87.47	6,307.57	-114.12	7,718.74	7,715.17	1.36	-1.27	-0.49
14,319.00	89.87	87.43	6,308.45	-110.03	7,810.64	7,807.13	0.91	0.91	-0.04
14,410.00	91.27	88.08	6,307.55	-106.46	7,901.56	7,898.11	1.70	1.54	0.71
14,501.00	90.40	88.04	6,306.22	-103.38	7,992.50	7,989.09	0.96	-0.96	-0.04
14,593.00	90.94	89.55	6,305.15	-101.45	8,084.47	8,081.08	1.74	0.59	1.64
14,684.00	90.84	89.56	6,303.73	-100.74	8,175.46	8,172.06	0.11	-0.11	0.01
14,775.00	90.57	89.45	6,302.61	-99.95	8,266.45	8,263.05	0.32	-0.30	-0.12
14,867.00	89.97	88.71	6,302.18	-98.48	8,358.43	8,355.05	1.04	-0.65	-0.80
14,959.00	91.27	88.66	6,301.19	-96.37	8,450.40	8,447.04	1.41	1.41	-0.05
15,051.00	90.97	88.88	6,299.39	-94.39	8,542.36	8,539.02	0.40	-0.33	0.24
15,142.00	89.93	87.95	6,298.67	-91.87	8,633.32	8,630.01	1.53	-1.14	-1.02
15,234.00	90.37	88.75	6,298.43	-89.23	8,725.28	8,722.01	0.99	0.48	0.87
15,326.00	91.14	89.66	6,297.22	-87.95	8,817.26	8,813.99	1.30	0.84	0.99
15,417.00	91.37	89.15	6,295.23	-87.00	8,908.24	8,904.97	0.61	0.25	-0.56
15,509.00	91.11	89.28	6,293.23	-85.74	9,000.21	8,996.95	0.32	-0.28	0.14
15,600.00	91.44	89.42	6,291.21	-84.71	9,091.18	9,087.92	0.39	0.36	0.15
15,695.00	92.99	90.88	6,287.54	-84.96	9,186.10	9,182.82	2.24	1.63	1.54
15,790.00	90.50	90.64	6,284.65	-86.22	9,281.04	9,277.72	2.63	-2.62	-0.25
15,885.00	90.44	90.34	6,283.87	-87.03	9,376.03	9,372.68	0.32	-0.06	-0.32
15,980.00	90.03	90.33	6,283.48	-87.59	9,471.03	9,467.65	0.43	-0.43	-0.01
16,075.00	89.29	90.50	6,284.04	-88.28	9,566.03	9,562.62	0.80	-0.78	0.18
16,169.00	89.19	90.22	6,285.29	-88.87	9,660.02	9,656.58	0.32	-0.11	-0.30
16,264.00	89.19	90.36	6,286.63	-89.35	9,755.01	9,751.54	0.15	0.00	0.15
16,345.00	88.99	89.87	6,287.92	-89.51	9,835.99	9,832.51	0.65	-0.25	-0.60
Last SDI MWD Survey									
16,404.00	88.99	89.87	6,288.96	-89.38	9,894.99	9,891.49	0.00	0.00	0.00
Projection to TD									

Company:	Bill Barrett Corp.	Local Co-ordinate Reference:	Well Anschutz State 5-62-22-3225B2
Project:	Weld County, CO NAD 83	TVD Reference:	GL 4719' & KB 16' @ 4735.00ft (Cade 24)
Site:	Anschutz State 5-62-22_23 SWNW Pad	MD Reference:	GL 4719' & KB 16' @ 4735.00ft (Cade 24)
Well:	Anschutz State 5-62-22-3225B2	North Reference:	True
Wellbore:	OH	Survey Calculation Method:	Minimum Curvature
Design:	OH	Database:	Casper District

Design Annotations				
Measured Depth (ft)	Vertical Depth (ft)	Local Coordinates		Comment
		+N/-S (ft)	+E/-W (ft)	
800.00	800.00	0.00	0.00	Casing Assumed Vertical
886.00	886.00	0.57	0.19	First SDI MWD Survey
6,620.00	6,368.64	-276.26	116.01	Last SDI MWD Curve Survey
6,694.00	6,369.63	-278.59	189.96	First SDI MWD Lateral Survey
16,345.00	6,287.92	-89.51	9,835.99	Last SDI MWD Survey
16,404.00	6,288.96	-89.38	9,894.99	Projection to TD

Checked By: _____	Approved By: _____	Date: _____
-------------------	--------------------	-------------