

PROJECT DETAILS: Weld County, CO NAD 83

Geodetic System: US State Plane 1983
 Datum: North American Datum 1983
 Ellipsoid: GRS 1980
 Zone: Colorado Northern Zone
 System Datum: Mean Sea Level
 Local North: True

Project: Weld County, CO NAD 83
 Site: Anschutz State Fed 5-62-27_34 NENW Pad
 Well: Anschutz State Fed 5-62-27-0362B2
 Wellbore: OH
 Design: Plan 1



Azinuths to True North
 Magnetic North: 8.26°

Magnetic Field
 Strength: 52634.2snT
 Dip Angle: 67.02°
 Date: 11/10/2015
 Model: BGGM2015

Plan: Plan 1 (Anschutz State Fed 5-62-27-0362B2/OH)

Created By: Seth Burstad Date: 11-11-2015

SECTION DETAILS

MD	Inc	Azi	TVD	+N/-S	+E/-W	Dleg	TFace	VSect
0.00	0.00	0.00	0.00	0.00	0.00	0.00	0.00	0.00
800.00	0.00	0.00	800.00	0.00	0.00	0.00	0.00	0.00
1013.92	4.28	33.32	1013.72	6.67	4.39	2.00	33.32	-6.66
5298.42	4.28	33.32	5286.28	273.76	179.96	0.00	0.00	-273.19
5512.34	0.00	0.00	5500.00	280.43	184.35	2.00	180.00	-279.85
5854.88	0.00	0.00	5842.54	280.43	184.35	0.00	0.00	-279.85
6606.37	90.18	179.82	6320.00	-198.53	185.83	12.00	179.82	199.11
16202.35	90.18	179.82	6290.00	-9794.41	215.45	0.00	0.00	9795.04

WELL DETAILS: Anschutz State Fed 5-62-27-0362B2

		GL 4683' & KB 16' @ 4699.00ft		4683.00	Longitude
+N/-S	+E/-W	Northing	Easting	Latitude	
0.00	0.00	1382482.12	3330702.10	40° 22' 38.060 N	104° 18' 46.681 W

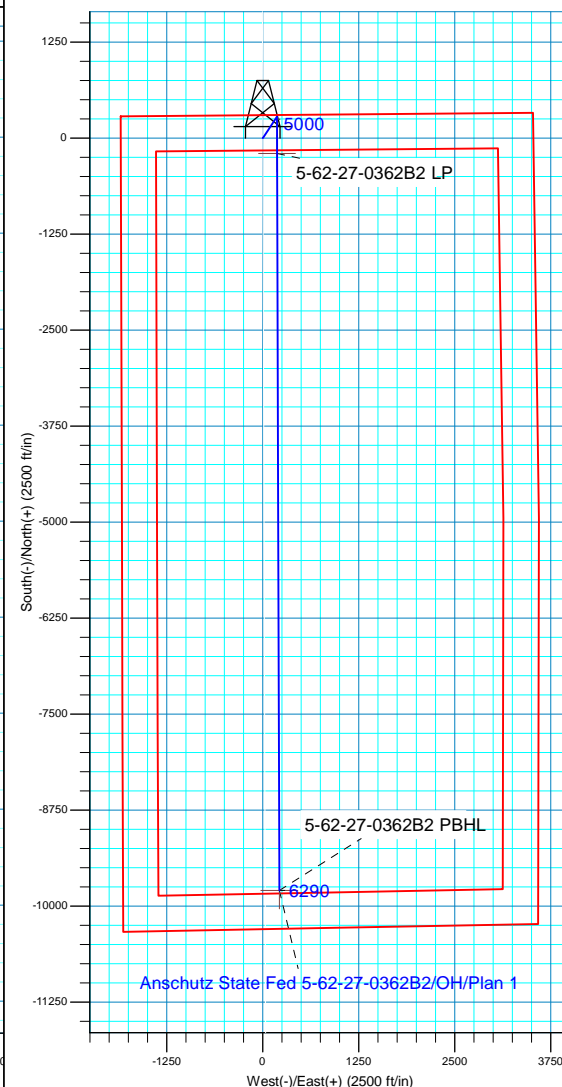
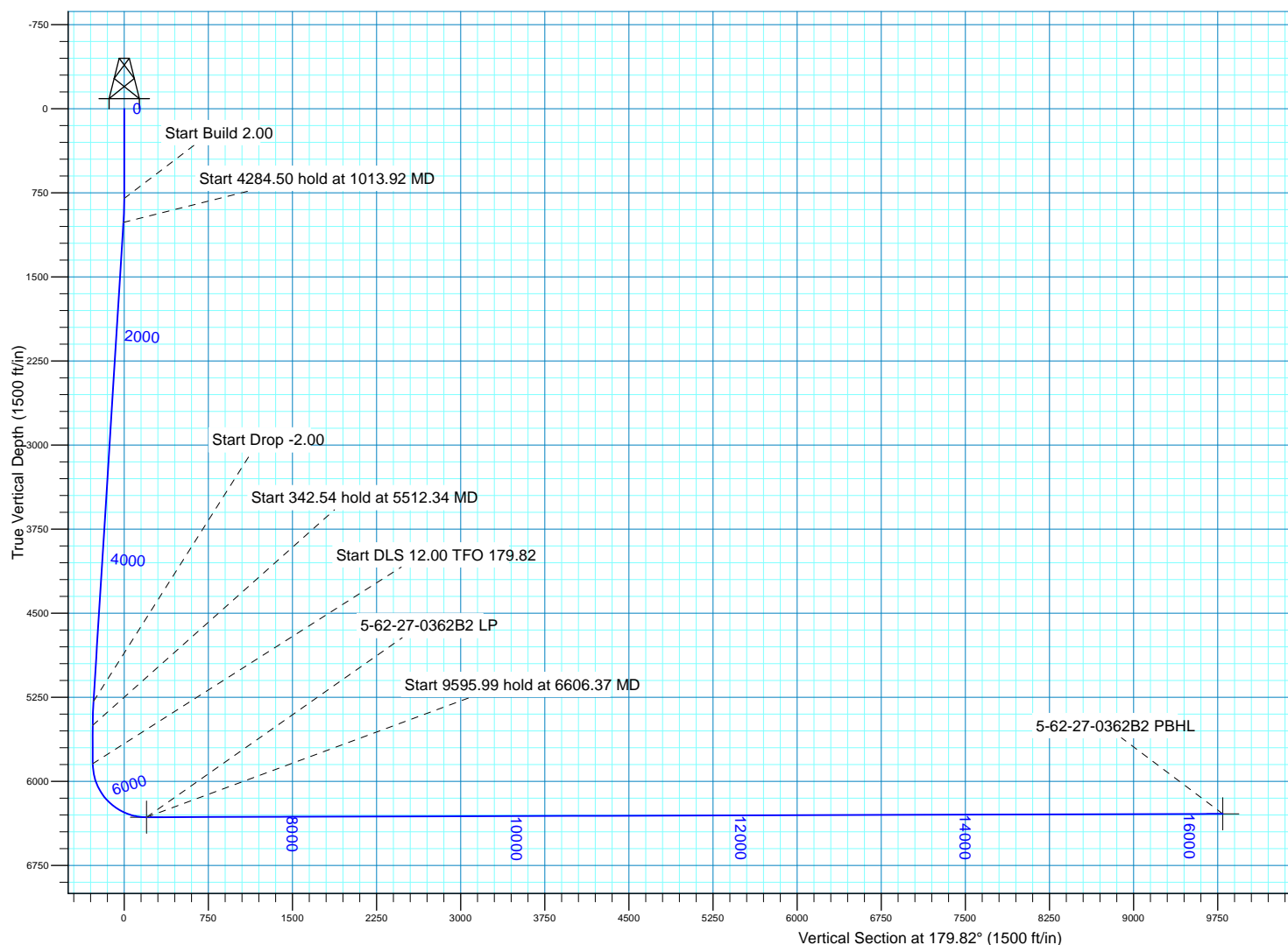



Bill Barrett Corp.

Weld County, CO NAD 83

Anschutz State Fed 5-62-27_34 NENW Pad

Anschutz State Fed 5-62-27-0362B2

OH

Plan: Plan 1

Standard Planning Report

11 November, 2015



Database:	Casper District	Local Co-ordinate Reference:	Well Anschutz State Fed 5-62-27-0362B2
Company:	Bill Barrett Corp.	TVD Reference:	GL 4683' & KB 16' @ 4699.00ft
Project:	Weld County, CO NAD 83	MD Reference:	GL 4683' & KB 16' @ 4699.00ft
Site:	Anschutz State Fed 5-62-27_34 NENW Pad	North Reference:	True
Well:	Anschutz State Fed 5-62-27-0362B2	Survey Calculation Method:	Minimum Curvature
Wellbore:	OH		
Design:	Plan 1		

Project	Weld County, CO NAD 83		
Map System:	US State Plane 1983	System Datum:	Mean Sea Level
Geo Datum:	North American Datum 1983		
Map Zone:	Colorado Northern Zone		

Site	Anschutz State Fed 5-62-27_34 NENW Pad, Site Center : 5-62-27-0461C2			
Site Position:		Northing:	1,382,482.33 usft	Latitude: 40° 22' 38.060 N
From:	Lat/Long	Easting:	3,330,716.87 usft	Longitude: 104° 18' 46.490 W
Position Uncertainty:	0.00 ft	Slot Radius:	13.200 in	Grid Convergence: 0.77 °

Well	Anschutz State Fed 5-62-27-0362B2, 300' FNL 1850' FWL Sec 27 T5N R62W			
Well Position	+N/-S	-0.02 ft	Northing:	1,382,482.11 usft
	+E/-W	-14.77 ft	Easting:	3,330,702.11 usft
Position Uncertainty		0.00 ft	Wellhead Elevation:	0.00 ft
			Ground Level:	4,683.00 ft

Wellbore	OH				
Magnetics	Model Name	Sample Date	Declination (°)	Dip Angle (°)	Field Strength (nT)
	BGGM2015	11/10/2015	8.26	67.02	52,634

Design	Plan 1			
Audit Notes:				
Version:	Phase:	PLAN	Tie On Depth:	0.00
Vertical Section:	Depth From (TVD) (ft)	+N/-S (ft)	+E/-W (ft)	Direction (°)
	0.00	0.00	0.00	179.82

Plan Sections										
Measured Depth (ft)	Inclination (°)	Azimuth (°)	Vertical Depth (ft)	+N/-S (ft)	+E/-W (ft)	Dogleg Rate (°/100ft)	Build Rate (°/100ft)	Turn Rate (°/100ft)	TFO (°)	Target
0.00	0.00	0.00	0.00	0.00	0.00	0.00	0.00	0.00	0.00	
800.00	0.00	0.00	800.00	0.00	0.00	0.00	0.00	0.00	0.00	
1,013.92	4.28	33.32	1,013.72	6.67	4.39	2.00	2.00	0.00	33.32	
5,298.42	4.28	33.32	5,286.28	273.76	179.96	0.00	0.00	0.00	0.00	
5,512.34	0.00	0.00	5,500.00	280.43	184.35	2.00	-2.00	0.00	180.00	
5,854.88	0.00	0.00	5,842.54	280.43	184.35	0.00	0.00	0.00	0.00	
6,606.37	90.18	179.82	6,320.00	-198.53	185.83	12.00	12.00	23.93	179.82	
16,202.35	90.18	179.82	6,290.00	-9,794.41	215.45	0.00	0.00	0.00	0.00	5-62-27-0362B2 PBH

Database:	Casper District	Local Co-ordinate Reference:	Well Anschutz State Fed 5-62-27-0362B2
Company:	Bill Barrett Corp.	TVD Reference:	GL 4683' & KB 16' @ 4699.00ft
Project:	Weld County, CO NAD 83	MD Reference:	GL 4683' & KB 16' @ 4699.00ft
Site:	Anschutz State Fed 5-62-27_34 NENW Pad	North Reference:	True
Well:	Anschutz State Fed 5-62-27-0362B2	Survey Calculation Method:	Minimum Curvature
Wellbore:	OH		
Design:	Plan 1		

Planned Survey									
Measured Depth (ft)	Inclination (°)	Azimuth (°)	Vertical Depth (ft)	+N/-S (ft)	+E/-W (ft)	Vertical Section (ft)	Dogleg Rate (°/100ft)	Build Rate (°/100ft)	Turn Rate (°/100ft)
0.00	0.00	0.00	0.00	0.00	0.00	0.00	0.00	0.00	0.00
100.00	0.00	0.00	100.00	0.00	0.00	0.00	0.00	0.00	0.00
200.00	0.00	0.00	200.00	0.00	0.00	0.00	0.00	0.00	0.00
300.00	0.00	0.00	300.00	0.00	0.00	0.00	0.00	0.00	0.00
400.00	0.00	0.00	400.00	0.00	0.00	0.00	0.00	0.00	0.00
500.00	0.00	0.00	500.00	0.00	0.00	0.00	0.00	0.00	0.00
600.00	0.00	0.00	600.00	0.00	0.00	0.00	0.00	0.00	0.00
700.00	0.00	0.00	700.00	0.00	0.00	0.00	0.00	0.00	0.00
800.00	0.00	0.00	800.00	0.00	0.00	0.00	0.00	0.00	0.00
Start Build 2.00									
900.00	2.00	33.32	899.98	1.46	0.96	-1.46	2.00	2.00	0.00
1,000.00	4.00	33.32	999.84	5.83	3.83	-5.82	2.00	2.00	0.00
1,013.92	4.28	33.32	1,013.72	6.67	4.39	-6.66	2.00	2.00	0.00
Start 4284.50 hold at 1013.92 MD									
1,100.00	4.28	33.32	1,099.56	12.04	7.91	-12.01	0.00	0.00	0.00
1,200.00	4.28	33.32	1,199.28	18.27	12.01	-18.23	0.00	0.00	0.00
1,300.00	4.28	33.32	1,299.00	24.50	16.11	-24.45	0.00	0.00	0.00
1,400.00	4.28	33.32	1,398.73	30.74	20.21	-30.67	0.00	0.00	0.00
1,500.00	4.28	33.32	1,498.45	36.97	24.30	-36.90	0.00	0.00	0.00
1,600.00	4.28	33.32	1,598.17	43.21	28.40	-43.12	0.00	0.00	0.00
1,700.00	4.28	33.32	1,697.89	49.44	32.50	-49.34	0.00	0.00	0.00
1,800.00	4.28	33.32	1,797.61	55.67	36.60	-55.56	0.00	0.00	0.00
1,900.00	4.28	33.32	1,897.33	61.91	40.70	-61.78	0.00	0.00	0.00
2,000.00	4.28	33.32	1,997.05	68.14	44.80	-68.00	0.00	0.00	0.00
2,100.00	4.28	33.32	2,096.77	74.38	48.89	-74.22	0.00	0.00	0.00
2,200.00	4.28	33.32	2,196.50	80.61	52.99	-80.44	0.00	0.00	0.00
2,300.00	4.28	33.32	2,296.22	86.84	57.09	-86.66	0.00	0.00	0.00
2,400.00	4.28	33.32	2,395.94	93.08	61.19	-92.88	0.00	0.00	0.00
2,500.00	4.28	33.32	2,495.66	99.31	65.29	-99.10	0.00	0.00	0.00
2,600.00	4.28	33.32	2,595.38	105.54	69.38	-105.33	0.00	0.00	0.00
2,700.00	4.28	33.32	2,695.10	111.78	73.48	-111.55	0.00	0.00	0.00
2,800.00	4.28	33.32	2,794.82	118.01	77.58	-117.77	0.00	0.00	0.00
2,900.00	4.28	33.32	2,894.55	124.25	81.68	-123.99	0.00	0.00	0.00
3,000.00	4.28	33.32	2,994.27	130.48	85.78	-130.21	0.00	0.00	0.00
3,100.00	4.28	33.32	3,093.99	136.71	89.87	-136.43	0.00	0.00	0.00
3,200.00	4.28	33.32	3,193.71	142.95	93.97	-142.65	0.00	0.00	0.00
3,300.00	4.28	33.32	3,293.43	149.18	98.07	-148.87	0.00	0.00	0.00
3,400.00	4.28	33.32	3,393.15	155.42	102.17	-155.09	0.00	0.00	0.00
3,500.00	4.28	33.32	3,492.87	161.65	106.27	-161.31	0.00	0.00	0.00
3,600.00	4.28	33.32	3,592.59	167.88	110.36	-167.54	0.00	0.00	0.00
3,700.00	4.28	33.32	3,692.32	174.12	114.46	-173.76	0.00	0.00	0.00
3,800.00	4.28	33.32	3,792.04	180.35	118.56	-179.98	0.00	0.00	0.00
3,900.00	4.28	33.32	3,891.76	186.58	122.66	-186.20	0.00	0.00	0.00
4,000.00	4.28	33.32	3,991.48	192.82	126.76	-192.42	0.00	0.00	0.00
4,100.00	4.28	33.32	4,091.20	199.05	130.85	-198.64	0.00	0.00	0.00
4,200.00	4.28	33.32	4,190.92	205.29	134.95	-204.86	0.00	0.00	0.00
4,300.00	4.28	33.32	4,290.64	211.52	139.05	-211.08	0.00	0.00	0.00
4,400.00	4.28	33.32	4,390.37	217.75	143.15	-217.30	0.00	0.00	0.00
4,500.00	4.28	33.32	4,490.09	223.99	147.25	-223.52	0.00	0.00	0.00
4,600.00	4.28	33.32	4,589.81	230.22	151.34	-229.74	0.00	0.00	0.00
4,700.00	4.28	33.32	4,689.53	236.45	155.44	-235.97	0.00	0.00	0.00
4,709.50	4.28	33.32	4,699.00	237.05	155.83	-236.56	0.00	0.00	0.00
BASE OF FOX HILLS									

Database:	Casper District	Local Co-ordinate Reference:	Well Anschutz State Fed 5-62-27-0362B2
Company:	Bill Barrett Corp.	TVD Reference:	GL 4683' & KB 16' @ 4699.00ft
Project:	Weld County, CO NAD 83	MD Reference:	GL 4683' & KB 16' @ 4699.00ft
Site:	Anschutz State Fed 5-62-27_34 NENW Pad	North Reference:	True
Well:	Anschutz State Fed 5-62-27-0362B2	Survey Calculation Method:	Minimum Curvature
Wellbore:	OH		
Design:	Plan 1		

Planned Survey									
Measured Depth (ft)	Inclination (°)	Azimuth (°)	Vertical Depth (ft)	+N/-S (ft)	+E/-W (ft)	Vertical Section (ft)	Dogleg Rate (°/100ft)	Build Rate (°/100ft)	Turn Rate (°/100ft)
4,800.00	4.28	33.32	4,789.25	242.69	159.54	-242.19	0.00	0.00	0.00
4,900.00	4.28	33.32	4,888.97	248.92	163.64	-248.41	0.00	0.00	0.00
5,000.00	4.28	33.32	4,988.69	255.16	167.74	-254.63	0.00	0.00	0.00
5,100.00	4.28	33.32	5,088.42	261.39	171.83	-260.85	0.00	0.00	0.00
5,200.00	4.28	33.32	5,188.14	267.62	175.93	-267.07	0.00	0.00	0.00
5,220.92	4.28	33.32	5,209.00	268.93	176.79	-268.37	0.00	0.00	0.00
SHANNON									
5,298.42	4.28	33.32	5,286.28	273.76	179.96	-273.19	0.00	0.00	0.00
Start Drop -2.00									
5,300.00	4.25	33.32	5,287.86	273.86	180.03	-273.29	2.00	-2.00	0.00
5,400.00	2.25	33.32	5,387.69	278.59	183.14	-278.01	2.00	-2.00	0.00
5,500.00	0.25	33.32	5,487.66	280.41	184.34	-279.83	2.00	-2.00	0.00
5,512.34	0.00	0.00	5,500.00	280.43	184.35	-279.85	2.00	-2.00	0.00
Start 342.54 hold at 5512.34 MD									
5,600.00	0.00	0.00	5,587.66	280.43	184.35	-279.85	0.00	0.00	0.00
5,700.00	0.00	0.00	5,687.66	280.43	184.35	-279.85	0.00	0.00	0.00
5,800.00	0.00	0.00	5,787.66	280.43	184.35	-279.85	0.00	0.00	0.00
5,854.88	0.00	0.00	5,842.54	280.43	184.35	-279.85	0.00	0.00	0.00
Start DLS 12.00 TFO 179.82									
5,900.00	5.41	179.82	5,887.60	278.30	184.36	-277.72	12.00	12.00	0.00
6,000.00	17.41	179.82	5,985.44	258.54	184.42	-257.96	12.00	12.00	0.00
6,096.52	29.00	179.82	6,074.00	220.58	184.53	-220.00	12.00	12.00	0.00
SHARON SPRINGS									
6,100.00	29.41	179.82	6,077.04	218.88	184.54	-218.30	12.00	12.00	0.00
6,200.00	41.41	179.82	6,158.39	161.04	184.72	-160.45	12.00	12.00	0.00
6,221.24	43.96	179.82	6,174.00	146.63	184.76	-146.05	12.00	12.00	0.00
NIOBRARA									
6,300.00	53.41	179.82	6,225.93	87.54	184.95	-86.96	12.00	12.00	0.00
6,400.00	65.41	179.82	6,276.72	1.61	185.21	-1.03	12.00	12.00	0.00
6,423.59	68.25	179.82	6,286.00	-20.07	185.28	20.65	12.00	12.00	0.00
TOP B CHALK TARGET									
6,434.71	69.58	179.82	6,290.00	-30.44	185.31	31.03	12.00	12.00	0.00
TD (HORIZONTAL)									
6,500.00	77.41	179.82	6,308.53	-93.00	185.50	93.58	12.00	12.00	0.00
6,600.00	89.41	179.82	6,319.98	-192.16	185.81	192.74	12.00	12.00	0.00
6,602.73	89.74	179.82	6,320.00	-194.89	185.82	195.47	12.00	12.00	0.00
LANDING POINT									
6,606.37	90.18	179.82	6,320.00	-198.53	185.83	199.11	12.00	12.00	0.00
Start 9595.99 hold at 6606.37 MD									
6,700.00	90.18	179.82	6,319.71	-292.15	186.12	292.74	0.00	0.00	0.00
6,800.00	90.18	179.82	6,319.40	-392.15	186.43	392.74	0.00	0.00	0.00
6,900.00	90.18	179.82	6,319.08	-492.15	186.73	492.74	0.00	0.00	0.00
7,000.00	90.18	179.82	6,318.77	-592.15	187.04	592.74	0.00	0.00	0.00
7,100.00	90.18	179.82	6,318.46	-692.15	187.35	692.74	0.00	0.00	0.00
7,200.00	90.18	179.82	6,318.15	-792.15	187.66	792.74	0.00	0.00	0.00
7,300.00	90.18	179.82	6,317.83	-892.15	187.97	892.74	0.00	0.00	0.00
7,400.00	90.18	179.82	6,317.52	-992.15	188.28	992.73	0.00	0.00	0.00
7,500.00	90.18	179.82	6,317.21	-1,092.15	188.59	1,092.73	0.00	0.00	0.00
7,600.00	90.18	179.82	6,316.90	-1,192.15	188.90	1,192.73	0.00	0.00	0.00
7,700.00	90.18	179.82	6,316.58	-1,292.15	189.20	1,292.73	0.00	0.00	0.00
7,800.00	90.18	179.82	6,316.27	-1,392.14	189.51	1,392.73	0.00	0.00	0.00
7,900.00	90.18	179.82	6,315.96	-1,492.14	189.82	1,492.73	0.00	0.00	0.00
8,000.00	90.18	179.82	6,315.65	-1,592.14	190.13	1,592.73	0.00	0.00	0.00

Database:	Casper District	Local Co-ordinate Reference:	Well Anschutz State Fed 5-62-27-0362B2
Company:	Bill Barrett Corp.	TVD Reference:	GL 4683' & KB 16' @ 4699.00ft
Project:	Weld County, CO NAD 83	MD Reference:	GL 4683' & KB 16' @ 4699.00ft
Site:	Anschutz State Fed 5-62-27_34 NENW Pad	North Reference:	True
Well:	Anschutz State Fed 5-62-27-0362B2	Survey Calculation Method:	Minimum Curvature
Wellbore:	OH		
Design:	Plan 1		

Planned Survey										
Measured Depth (ft)	Inclination (°)	Azimuth (°)	Vertical Depth (ft)	+N/-S (ft)	+E/-W (ft)	Vertical Section (ft)	Dogleg Rate (°/100ft)	Build Rate (°/100ft)	Turn Rate (°/100ft)	
8,100.00	90.18	179.82	6,315.33	-1,692.14	190.44	1,692.73	0.00	0.00	0.00	
8,200.00	90.18	179.82	6,315.02	-1,792.14	190.75	1,792.73	0.00	0.00	0.00	
8,300.00	90.18	179.82	6,314.71	-1,892.14	191.06	1,892.73	0.00	0.00	0.00	
8,400.00	90.18	179.82	6,314.39	-1,992.14	191.36	1,992.73	0.00	0.00	0.00	
8,500.00	90.18	179.82	6,314.08	-2,092.14	191.67	2,092.73	0.00	0.00	0.00	
8,600.00	90.18	179.82	6,313.77	-2,192.14	191.98	2,192.73	0.00	0.00	0.00	
8,700.00	90.18	179.82	6,313.46	-2,292.14	192.29	2,292.73	0.00	0.00	0.00	
8,800.00	90.18	179.82	6,313.14	-2,392.13	192.60	2,392.73	0.00	0.00	0.00	
8,900.00	90.18	179.82	6,312.83	-2,492.13	192.91	2,492.73	0.00	0.00	0.00	
9,000.00	90.18	179.82	6,312.52	-2,592.13	193.22	2,592.73	0.00	0.00	0.00	
9,100.00	90.18	179.82	6,312.21	-2,692.13	193.52	2,692.73	0.00	0.00	0.00	
9,200.00	90.18	179.82	6,311.89	-2,792.13	193.83	2,792.73	0.00	0.00	0.00	
9,300.00	90.18	179.82	6,311.58	-2,892.13	194.14	2,892.73	0.00	0.00	0.00	
9,400.00	90.18	179.82	6,311.27	-2,992.13	194.45	2,992.73	0.00	0.00	0.00	
9,500.00	90.18	179.82	6,310.96	-3,092.13	194.76	3,092.72	0.00	0.00	0.00	
9,600.00	90.18	179.82	6,310.64	-3,192.13	195.07	3,192.72	0.00	0.00	0.00	
9,700.00	90.18	179.82	6,310.33	-3,292.13	195.38	3,292.72	0.00	0.00	0.00	
9,800.00	90.18	179.82	6,310.02	-3,392.13	195.69	3,392.72	0.00	0.00	0.00	
9,900.00	90.18	179.82	6,309.70	-3,492.12	195.99	3,492.72	0.00	0.00	0.00	
10,000.00	90.18	179.82	6,309.39	-3,592.12	196.30	3,592.72	0.00	0.00	0.00	
10,100.00	90.18	179.82	6,309.08	-3,692.12	196.61	3,692.72	0.00	0.00	0.00	
10,200.00	90.18	179.82	6,308.77	-3,792.12	196.92	3,792.72	0.00	0.00	0.00	
10,300.00	90.18	179.82	6,308.45	-3,892.12	197.23	3,892.72	0.00	0.00	0.00	
10,400.00	90.18	179.82	6,308.14	-3,992.12	197.54	3,992.72	0.00	0.00	0.00	
10,500.00	90.18	179.82	6,307.83	-4,092.12	197.85	4,092.72	0.00	0.00	0.00	
10,600.00	90.18	179.82	6,307.52	-4,192.12	198.15	4,192.72	0.00	0.00	0.00	
10,700.00	90.18	179.82	6,307.20	-4,292.12	198.46	4,292.72	0.00	0.00	0.00	
10,800.00	90.18	179.82	6,306.89	-4,392.12	198.77	4,392.72	0.00	0.00	0.00	
10,900.00	90.18	179.82	6,306.58	-4,492.11	199.08	4,492.72	0.00	0.00	0.00	
11,000.00	90.18	179.82	6,306.27	-4,592.11	199.39	4,592.72	0.00	0.00	0.00	
11,100.00	90.18	179.82	6,305.95	-4,692.11	199.70	4,692.72	0.00	0.00	0.00	
11,200.00	90.18	179.82	6,305.64	-4,792.11	200.01	4,792.72	0.00	0.00	0.00	
11,300.00	90.18	179.82	6,305.33	-4,892.11	200.32	4,892.72	0.00	0.00	0.00	
11,400.00	90.18	179.82	6,305.02	-4,992.11	200.62	4,992.72	0.00	0.00	0.00	
11,500.00	90.18	179.82	6,304.70	-5,092.11	200.93	5,092.71	0.00	0.00	0.00	
11,600.00	90.18	179.82	6,304.39	-5,192.11	201.24	5,192.71	0.00	0.00	0.00	
11,700.00	90.18	179.82	6,304.08	-5,292.11	201.55	5,292.71	0.00	0.00	0.00	
11,800.00	90.18	179.82	6,303.76	-5,392.11	201.86	5,392.71	0.00	0.00	0.00	
11,900.00	90.18	179.82	6,303.45	-5,492.10	202.17	5,492.71	0.00	0.00	0.00	
12,000.00	90.18	179.82	6,303.14	-5,592.10	202.48	5,592.71	0.00	0.00	0.00	
12,100.00	90.18	179.82	6,302.83	-5,692.10	202.78	5,692.71	0.00	0.00	0.00	
12,200.00	90.18	179.82	6,302.51	-5,792.10	203.09	5,792.71	0.00	0.00	0.00	
12,300.00	90.18	179.82	6,302.20	-5,892.10	203.40	5,892.71	0.00	0.00	0.00	
12,400.00	90.18	179.82	6,301.89	-5,992.10	203.71	5,992.71	0.00	0.00	0.00	
12,500.00	90.18	179.82	6,301.58	-6,092.10	204.02	6,092.71	0.00	0.00	0.00	
12,600.00	90.18	179.82	6,301.26	-6,192.10	204.33	6,192.71	0.00	0.00	0.00	
12,700.00	90.18	179.82	6,300.95	-6,292.10	204.64	6,292.71	0.00	0.00	0.00	
12,800.00	90.18	179.82	6,300.64	-6,392.10	204.95	6,392.71	0.00	0.00	0.00	
12,900.00	90.18	179.82	6,300.33	-6,492.10	205.25	6,492.71	0.00	0.00	0.00	
13,000.00	90.18	179.82	6,300.01	-6,592.09	205.56	6,592.71	0.00	0.00	0.00	
13,100.00	90.18	179.82	6,299.70	-6,692.09	205.87	6,692.71	0.00	0.00	0.00	
13,200.00	90.18	179.82	6,299.39	-6,792.09	206.18	6,792.71	0.00	0.00	0.00	
13,300.00	90.18	179.82	6,299.07	-6,892.09	206.49	6,892.71	0.00	0.00	0.00	
13,400.00	90.18	179.82	6,298.76	-6,992.09	206.80	6,992.71	0.00	0.00	0.00	

Database:	Casper District	Local Co-ordinate Reference:	Well Anschutz State Fed 5-62-27-0362B2
Company:	Bill Barrett Corp.	TVD Reference:	GL 4683' & KB 16' @ 4699.00ft
Project:	Weld County, CO NAD 83	MD Reference:	GL 4683' & KB 16' @ 4699.00ft
Site:	Anschutz State Fed 5-62-27_34 NENW Pad	North Reference:	True
Well:	Anschutz State Fed 5-62-27-0362B2	Survey Calculation Method:	Minimum Curvature
Wellbore:	OH		
Design:	Plan 1		

Planned Survey									
Measured Depth (ft)	Inclination (°)	Azimuth (°)	Vertical Depth (ft)	+N/-S (ft)	+E/-W (ft)	Vertical Section (ft)	Dogleg Rate (°/100ft)	Build Rate (°/100ft)	Turn Rate (°/100ft)
13,500.00	90.18	179.82	6,298.45	-7,092.09	207.11	7,092.71	0.00	0.00	0.00
13,600.00	90.18	179.82	6,298.14	-7,192.09	207.41	7,192.70	0.00	0.00	0.00
13,700.00	90.18	179.82	6,297.82	-7,292.09	207.72	7,292.70	0.00	0.00	0.00
13,800.00	90.18	179.82	6,297.51	-7,392.09	208.03	7,392.70	0.00	0.00	0.00
13,900.00	90.18	179.82	6,297.20	-7,492.09	208.34	7,492.70	0.00	0.00	0.00
14,000.00	90.18	179.82	6,296.89	-7,592.08	208.65	7,592.70	0.00	0.00	0.00
14,100.00	90.18	179.82	6,296.57	-7,692.08	208.96	7,692.70	0.00	0.00	0.00
14,200.00	90.18	179.82	6,296.26	-7,792.08	209.27	7,792.70	0.00	0.00	0.00
14,300.00	90.18	179.82	6,295.95	-7,892.08	209.57	7,892.70	0.00	0.00	0.00
14,400.00	90.18	179.82	6,295.64	-7,992.08	209.88	7,992.70	0.00	0.00	0.00
14,500.00	90.18	179.82	6,295.32	-8,092.08	210.19	8,092.70	0.00	0.00	0.00
14,600.00	90.18	179.82	6,295.01	-8,192.08	210.50	8,192.70	0.00	0.00	0.00
14,700.00	90.18	179.82	6,294.70	-8,292.08	210.81	8,292.70	0.00	0.00	0.00
14,800.00	90.18	179.82	6,294.38	-8,392.08	211.12	8,392.70	0.00	0.00	0.00
14,900.00	90.18	179.82	6,294.07	-8,492.08	211.43	8,492.70	0.00	0.00	0.00
15,000.00	90.18	179.82	6,293.76	-8,592.08	211.74	8,592.70	0.00	0.00	0.00
15,100.00	90.18	179.82	6,293.45	-8,692.07	212.04	8,692.70	0.00	0.00	0.00
15,200.00	90.18	179.82	6,293.13	-8,792.07	212.35	8,792.70	0.00	0.00	0.00
15,300.00	90.18	179.82	6,292.82	-8,892.07	212.66	8,892.70	0.00	0.00	0.00
15,400.00	90.18	179.82	6,292.51	-8,992.07	212.97	8,992.70	0.00	0.00	0.00
15,500.00	90.18	179.82	6,292.20	-9,092.07	213.28	9,092.70	0.00	0.00	0.00
15,600.00	90.18	179.82	6,291.88	-9,192.07	213.59	9,192.69	0.00	0.00	0.00
15,700.00	90.18	179.82	6,291.57	-9,292.07	213.90	9,292.69	0.00	0.00	0.00
15,800.00	90.18	179.82	6,291.26	-9,392.07	214.20	9,392.69	0.00	0.00	0.00
15,900.00	90.18	179.82	6,290.95	-9,492.07	214.51	9,492.69	0.00	0.00	0.00
16,000.00	90.18	179.82	6,290.63	-9,592.07	214.82	9,592.69	0.00	0.00	0.00
16,100.00	90.18	179.82	6,290.32	-9,692.06	215.13	9,692.69	0.00	0.00	0.00
16,200.00	90.18	179.82	6,290.01	-9,792.06	215.44	9,792.69	0.00	0.00	0.00
16,202.35	90.18	179.82	6,290.00	-9,794.41	215.45	9,795.04	0.00	0.00	0.00
TD at 16202.36									

Design Targets									
Target Name	Dip Angle (°)	Dip Dir. (°)	TVD (ft)	+N/-S (ft)	+E/-W (ft)	Northing (usft)	Easting (usft)	Latitude	Longitude
5-62-27-0362B2 PBHL - hit/miss target - Shape - Point	0.00	0.00	6,290.00	-9,794.41	215.45	1,372,691.48	3,331,048.64	40° 21' 1.271 N	104° 18' 43.898 W
5-62-27-0362B2 LP - plan hits target center - Point	0.00	0.00	6,320.00	-198.52	185.83	1,382,286.10	3,330,890.58	40° 22' 36.098 N	104° 18' 44.280 W

Database:	Casper District	Local Co-ordinate Reference:	Well Anschutz State Fed 5-62-27-0362B2
Company:	Bill Barrett Corp.	TVD Reference:	GL 4683' & KB 16' @ 4699.00ft
Project:	Weld County, CO NAD 83	MD Reference:	GL 4683' & KB 16' @ 4699.00ft
Site:	Anschutz State Fed 5-62-27_34 NENW Pad	North Reference:	True
Well:	Anschutz State Fed 5-62-27-0362B2	Survey Calculation Method:	Minimum Curvature
Wellbore:	OH		
Design:	Plan 1		

Formations					
Measured Depth (ft)	Vertical Depth (ft)	Name	Lithology	Dip (°)	Dip Direction (°)
4,709.50	4,699.00	BASE OF FOX HILLS		0.00	
5,220.92	5,209.00	SHANNON		0.00	
6,096.52	6,074.00	SHARON SPRINGS		0.00	
6,221.24	6,174.00	NIOBRARA		0.00	
6,423.59	6,286.00	TOP B CHALK TARGET		0.00	
6,434.71	6,290.00	TD (HORIZONTAL)		0.00	
6,602.73	6,320.00	LANDING POINT		0.00	

Plan Annotations					
Measured Depth (ft)	Vertical Depth (ft)	Local Coordinates			
		+N/-S (ft)	+E/-W (ft)	Comment	
800.00	800.00	0.00	0.00	Start Build 2.00	
1,013.92	1,013.72	6.67	4.39	Start 4284.50 hold at 1013.92 MD	
5,298.42	5,286.28	273.76	179.96	Start Drop -2.00	
5,512.34	5,500.00	280.43	184.35	Start 342.54 hold at 5512.34 MD	
5,854.88	5,842.54	280.43	184.35	Start DLS 12.00 TFO 179.82	
6,606.37	6,320.00	-198.53	185.83	Start 9595.99 hold at 6606.37 MD	
16,202.35	6,290.00	-9,794.41	215.45	TD at 16202.36	